

STRETCHABLE CONTROLLER

User Manual (M100 plus)

Application Instruction:

1. The product support Direct-Play mode, Connect & Play, Easy to operate, No activation, No APP Needed; (Android 6.0 or above, iOS11.0 or above)
2. Support playing games on BT enabled Android/ iOS Smartphones/ Tablets/ Smart TV ;
3. Designed with telescopic phone stand, support hold mobile phone up to 6.2 inches;
4. Ergonomic structure, comfortable hand feeling

★ Due to the mobile phone system problems, individual mobile phones may not support this device (e.g. the mobile phones of the Media Tek platform can not support it).

★ Due to the official game platform software upgrade or source code changes and other not resist factors caused of some games can not be played or connected with our gamepad. Our company has no responsibility, we reserves the right of final interpretation for this.

Instruction for key function:

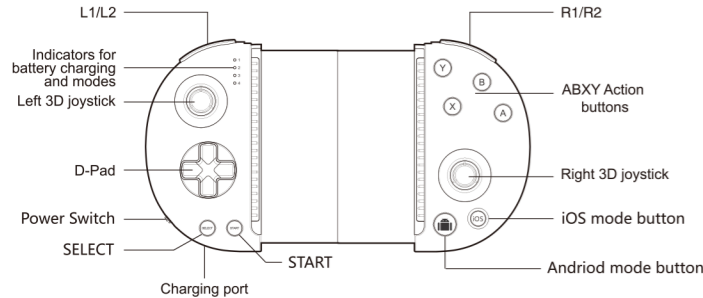

Characteristic parameters:

1. Size: L163*W86.8*H36mm;
2. Weight: 126.8 ± 5g;
3. Working voltage: DC3.7V;
4. Working current: <15mA;
5. Static current: <15uA;
6. Continuous gameplay time: >15H;
7. Input voltage/current: DC5V/500mA;
8. Charging time: about 3 hours;
9. Bluetooth 4.0 transmission distance: ≤ 8M;
10. Battery capacity: 400mAh;
11. Standby time: up to 30days once fully charged;

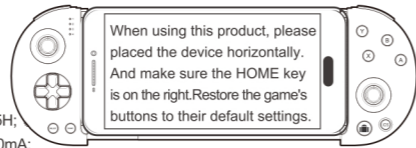

Operation instructions:

Direct Play Mode (Android V3):

Turn on the power switch, press the button 2 seconds to enter Direct Play Mode (Android V3) .At the time,the LED1 indicator flashes quickly,the search "M100 plus" on Android phone/tablet bluetooth and pair,LED1 indicator will be always on after connected successfully.If you connected before,press the button directly,LED1 indicator will flash slowly,automatically reconnect.

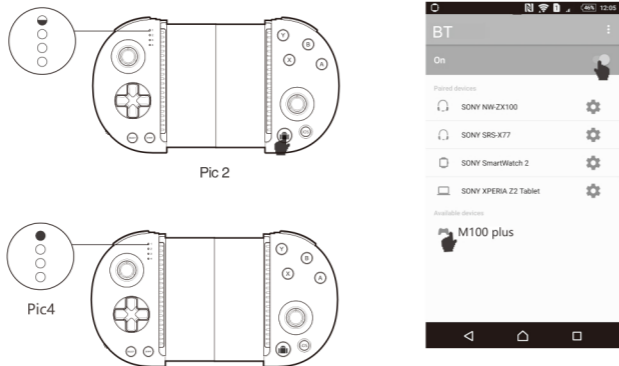

Direct Play Mode (IOS V3):

Turn on the power switch, press the button 2 seconds to enter Direct Play Mode (Android V3) .At the time,the LED2 indicator flashes quickly,the search "M100 plus" on Android phone/tablet bluetooth and pair,LED2 indicator will be always on after connected successfully.If you connected before,press the button directly,LED2 indicator will flash slowly,automatically reconnect.

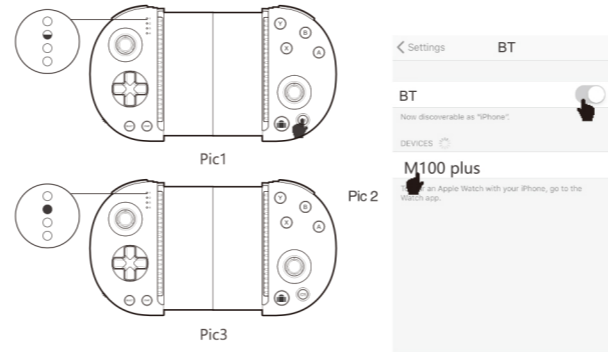

Mapping game buttons for direct play mode (Android/IOS):

Check the default operation instructions at "www.ipega.hk". If you need to reset the game buttons, please download and install "ShootingPlus V3" APP from APP Store/ Google Play Store, remap the game buttons in the APP and adjust the button position! This product default game is "PUBG Mobile" !



ShootingPlus V3

Android Standard Mode:

Press and hold X+ buttons for 2 seconds to enter Android Standard Mode. At this time, the LED3 indicator flashes quickly, then search " M100 plus " on Android phone/tablet/smart TV bluetooth and pair, LED3 indicator will be always on after connected successfully! If you connected before, press the button directly, LED3 indicator will flash slowly, automatically reconnect!

You can directly play simulator games, or you can download the Gamepad enabled games from Google Play Store. Below are the recommend games for reference: Fortnite/ Implosion/ Dead Trigger/ Dead Effect/ CS Portable

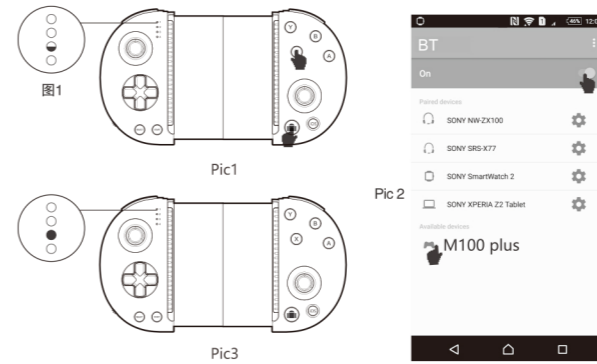

Charging/sleep/wake up/off function of Gamepad:

1. Charging function:
 - a. When the power is low, the LED4 indicator flashes quickly;
 - b. When charging, the indicator below USB port will be always on;
 - c. When fully charged, the indicator below USB port will be turn off;
2. Sleep / wake up / off function:
 - a. The gamepad will automatically turn off if no operation within 5 minutes.
 - b. When you need to restart, you need to press the mode button to wake up then you can reconnect;

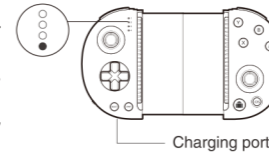

c. When the gamepad is turned on, press and hold the button for 3 seconds, the product will be turned off, and all the LED indicators will turn off;

Notes:

1. Please do not store this product in wet or high-temperature areas.
2. Don't knap, beat, drub, pierce, or try to decompose this product, to avoid unnecessary damage to the product.
3. The product has built-in batteries, and please don't discard them together with the garbages.
4. Don't charge the controller in a place near the fire or other heat source.
5. Non professional personnel should not disassemble the product, otherwise it will not be covered in the after-sales warranty service.

Accessories List

