

X100AC - 100cc Air Cooled Engine

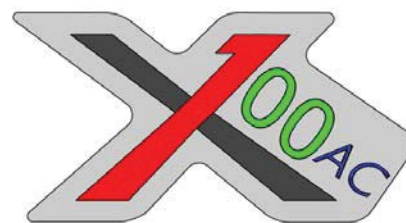

TECHNICAL CHARACTERISTICS

MOTOR	2-STROKE
COOLING	AIR
DISPLACEMENT	100 cc
STROKE	54.05 mm
MAX. BORE	48.53 mm
INLET SYSTEM	REED VALVE
CARBURETOR	TILLOTSON/TRYTON 24mm
STARTER	ELECTRIC
CLUTCH TYPE	CENTRIFUGAL DRY
SELETTRA IGNITION (Adjustable)	ANALOGUE 2 POLES



Right Side Photo



Front Photo



Left Side Photo



Back Side Photo



CRANKCASE - RIGHT SIDE

MATERIAL = ALUMINUM

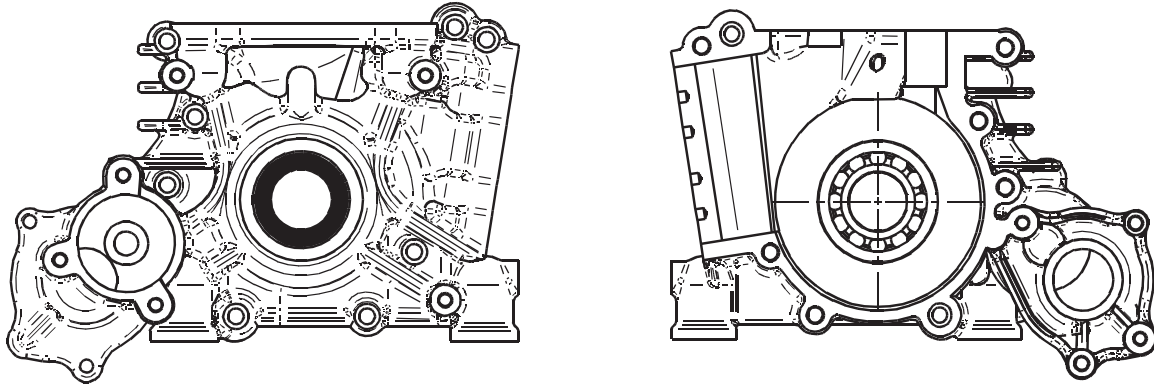

TEFLON DOUBLE LIPPED SEAL - 40x25x7

CRANKCASE - LEFT SIDE

MATERIAL = ALUMINUM

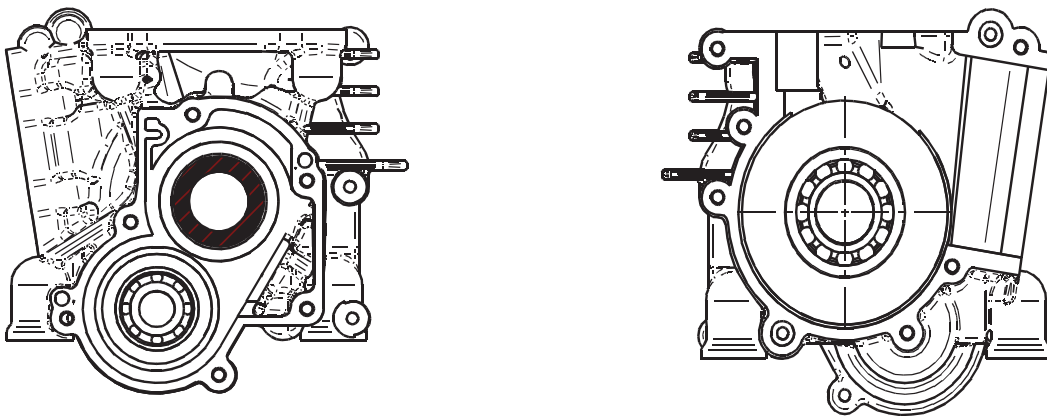

BEARING 6202 C4 WITH POLYAMIDE CAGE
TEFLON DOUBLE LIPPED SEAL - 40x25x7
(*Optional Roller Bearing Upgrade Available)

BASE

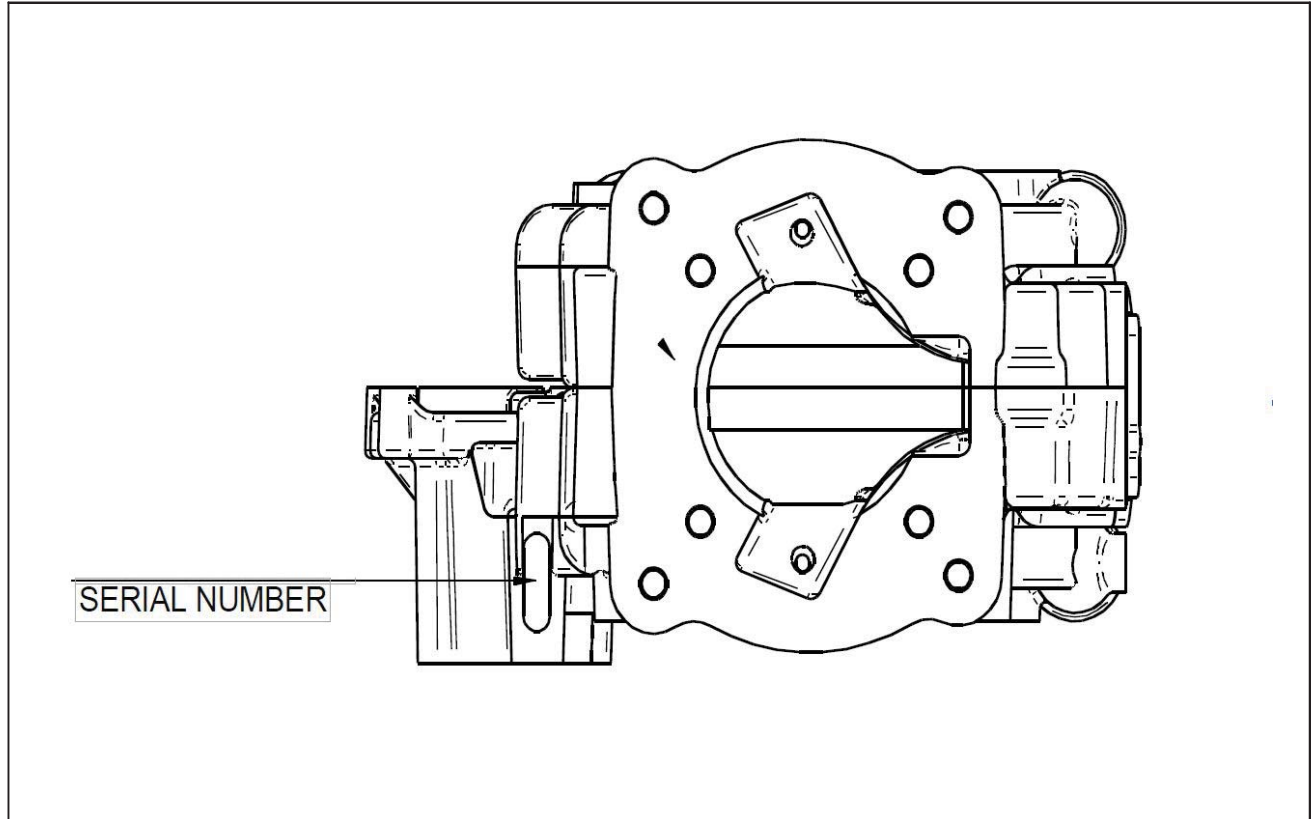

HEAD

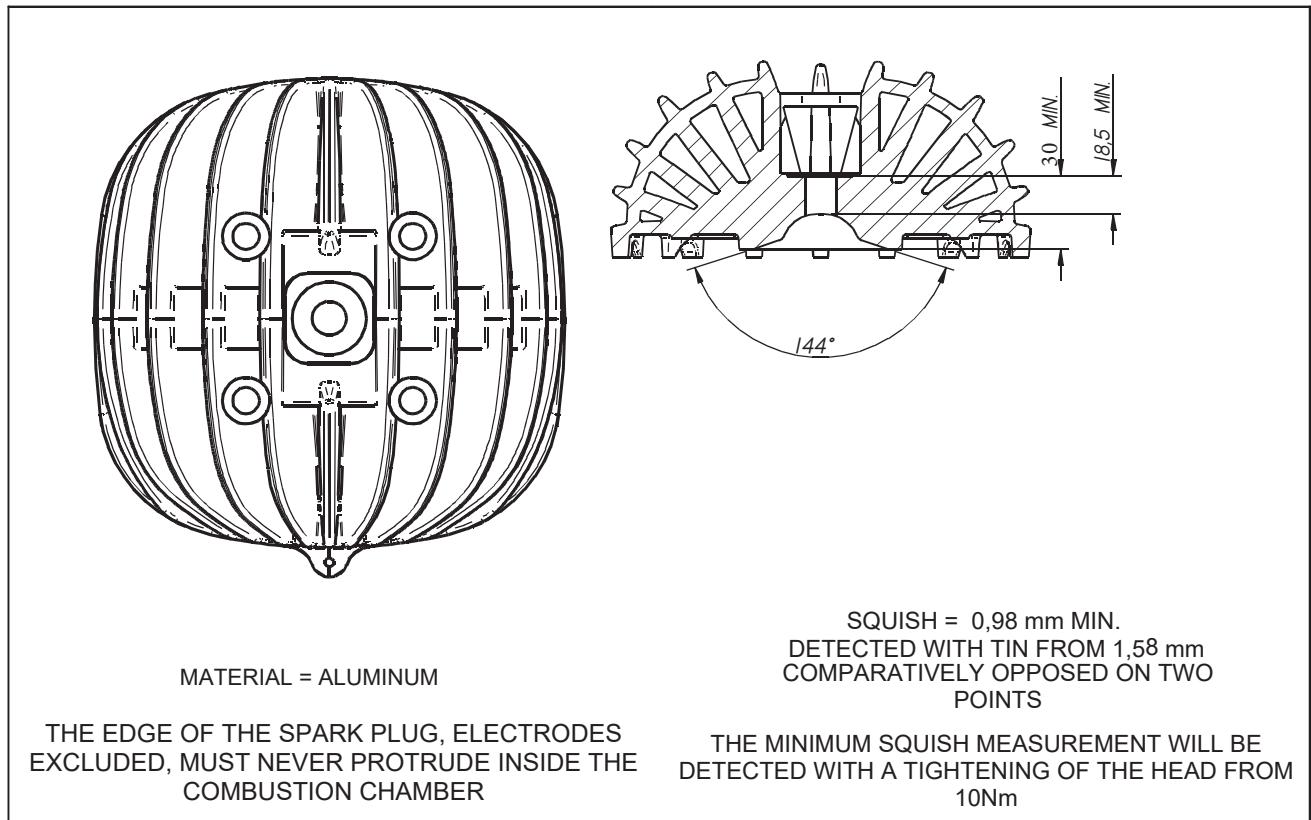

CYLINDER

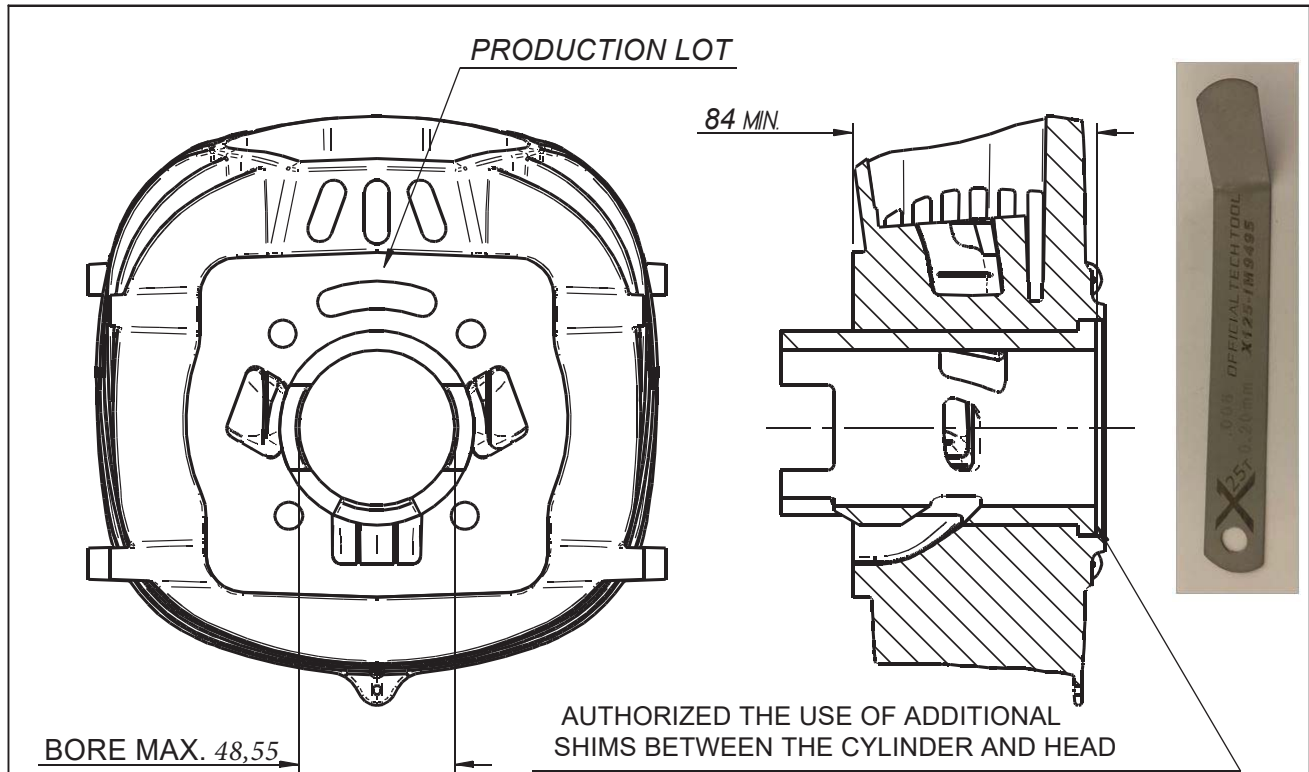

THE CYLINDER BASE GASKET MUST BE TREATED PAPER

Port Timing to be measured with official X125T Port Timing Tool X125-IM9495

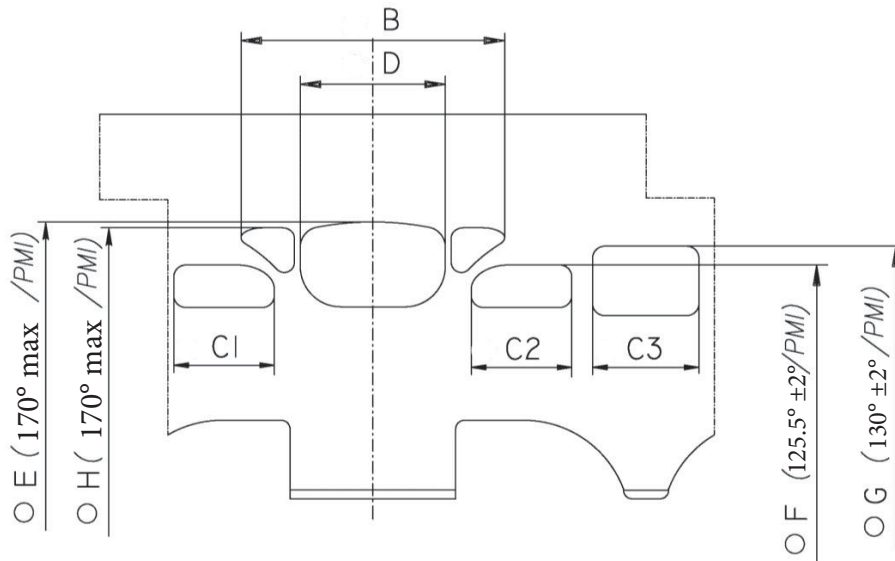

B	≤ 48.2 mm
C1 = C2	≤ 28 mm
C3	≤ 30 mm
D	≤ 34 mm
E	170° max
F	125.5° ±2°
G	130° ±2°
H	170° max

ANGULAR READING BY INSERTING A 0,4mm GAUGE

CYLINDER MATERIAL = ALUMINUM

CRANKSHAFT

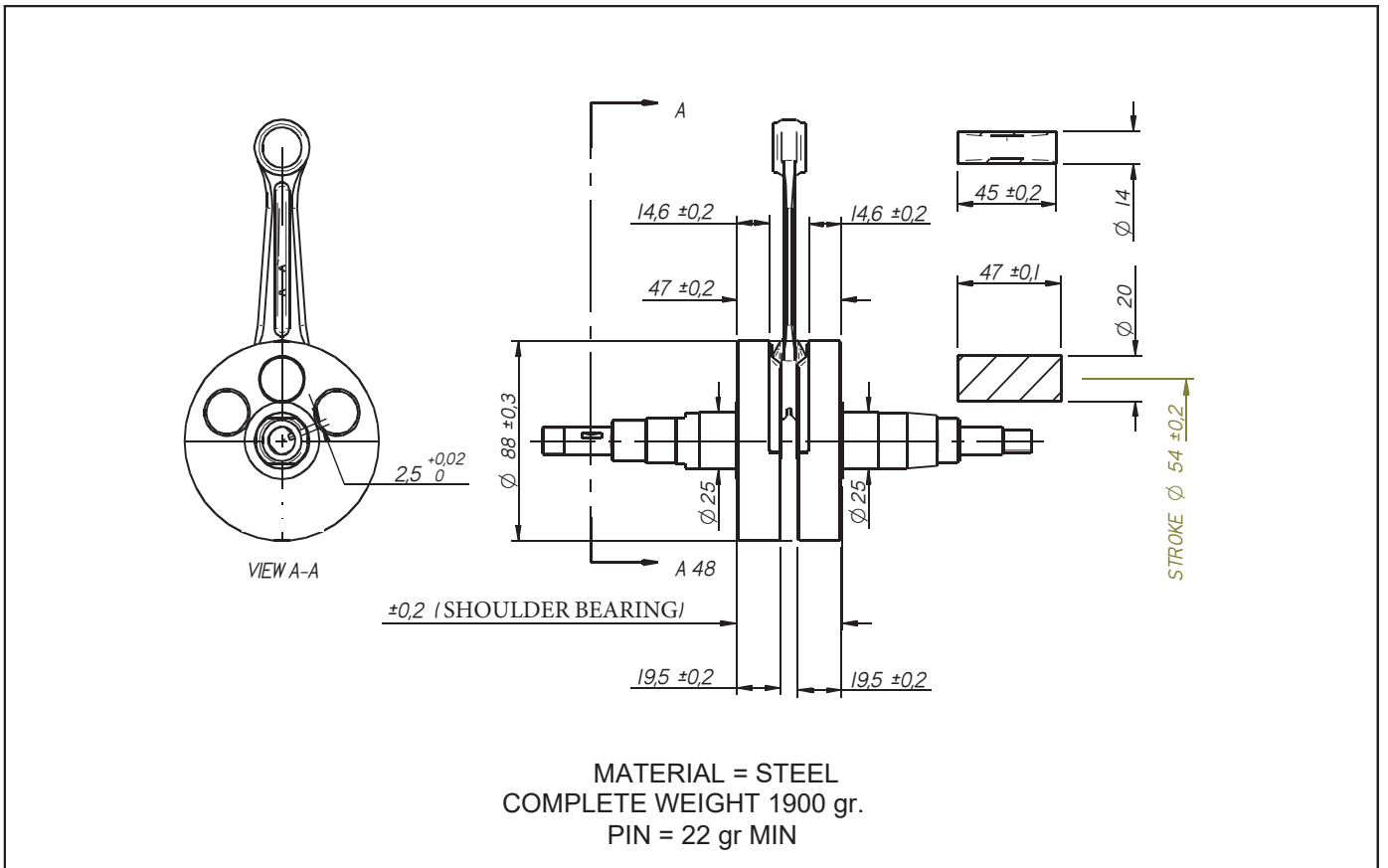

PISTON

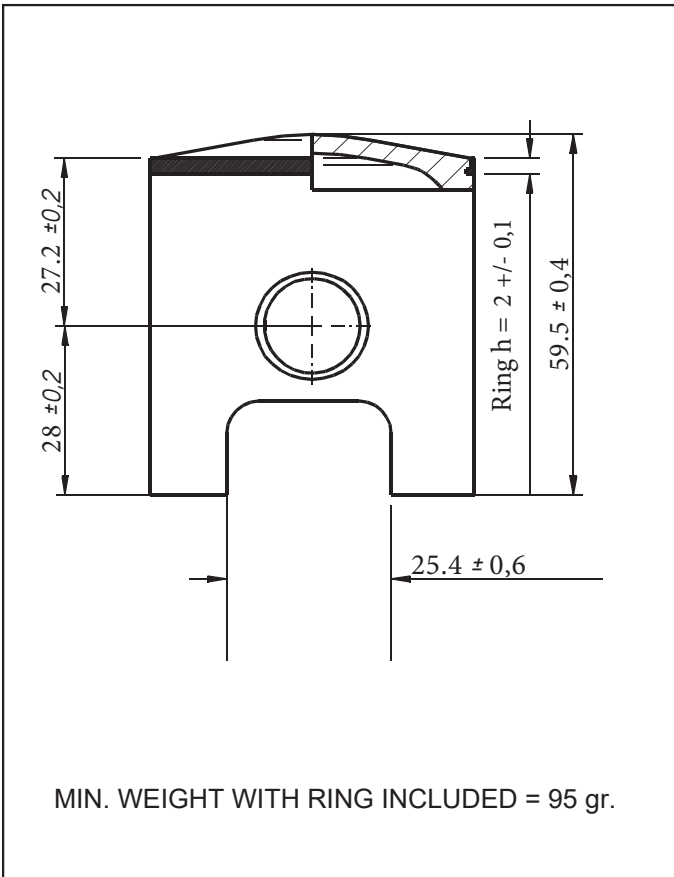

CONNECTING ROD

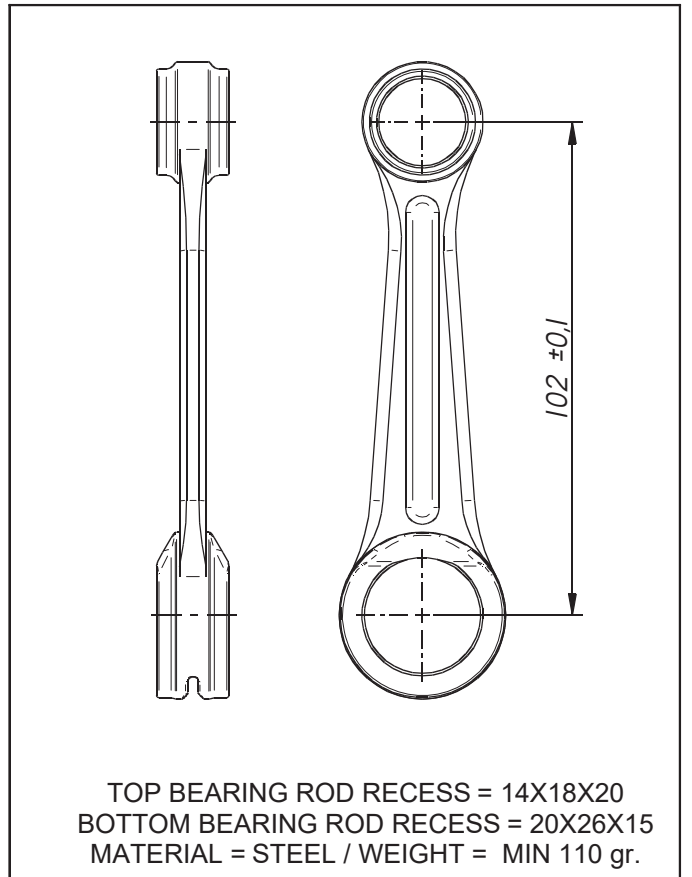

COUNTERSHAFT

PHASE = TOP DEAD CENTER

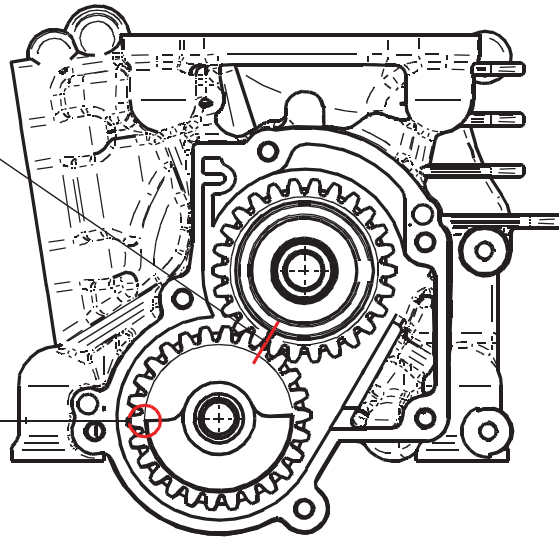
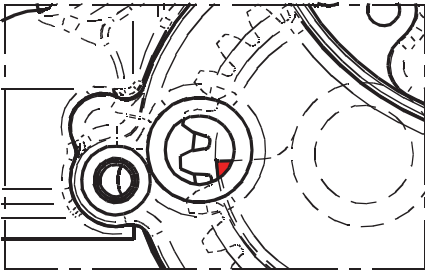
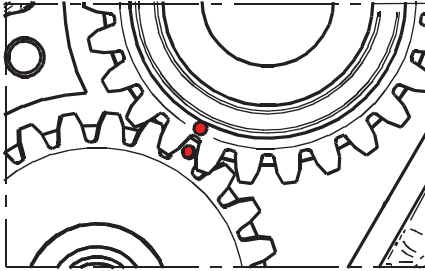

COUNTERSHAFT POSITION AT THE PMS SEEN FROM THE OIL LEVEL

MONOBLOCK COUNTERSHAFT = Z 26 WEIGHT = 230 gr. MIN.
 PRIMARY GEAR = Z 26 WEIGHT = 60 gr. MIN.

CLUTCH

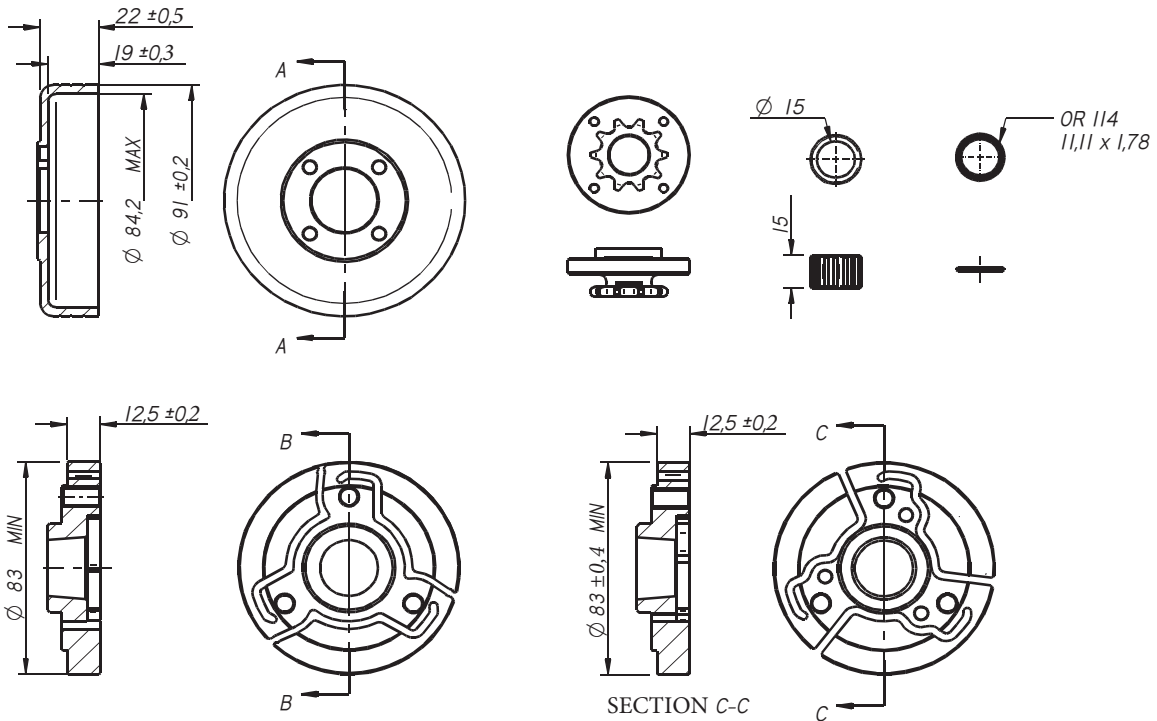

STEEL DRUM COMPLETE WITH PINION WEIGHT = 330g MIN.
 STEEL CLUTCH BODY WEIGHT = 400g MIN.



STEEL STARTER GEAR MODEL "B"

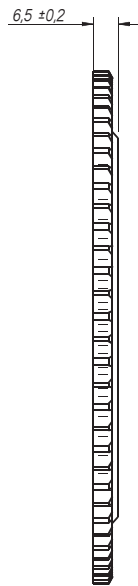

MODEL "B"

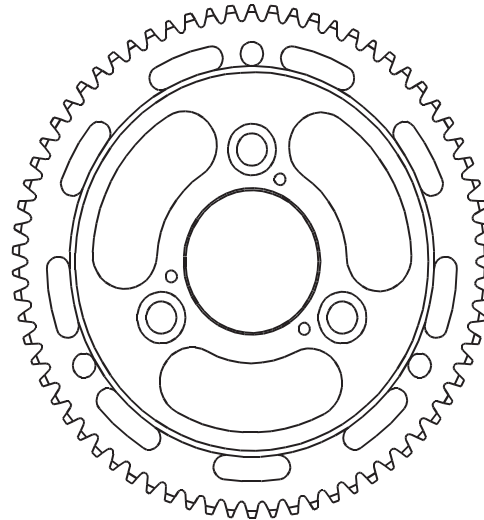

STARTER GEAR Z=70

GEAR MATERIAL = STEEL / WEIGHT = 230 g. MIN.

INLET

PHOTO OF REED ASSEMBLY



PHOTO OF REED PETAL

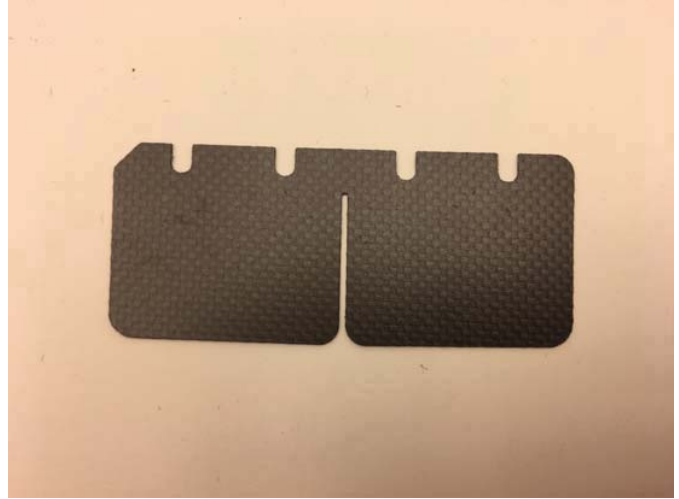

REED PETAL - 40.13783.00



REED ASSEMBLY - 10.9653.00



MANIFOLD (without studs/gasket) - 40.9456.00

PULSE HOLE = 4.1mm max

INLET

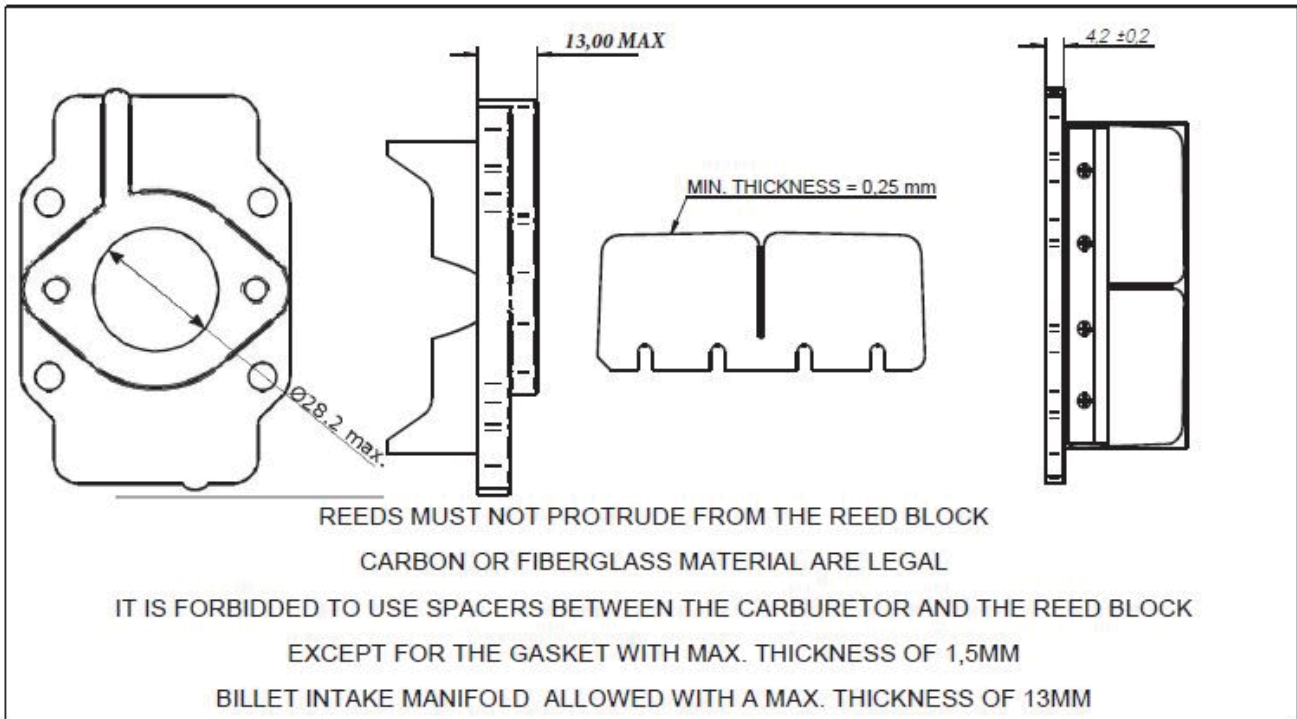

DRAWING OF THE REED VALVE (DIMENSIONS incl. tolerances)

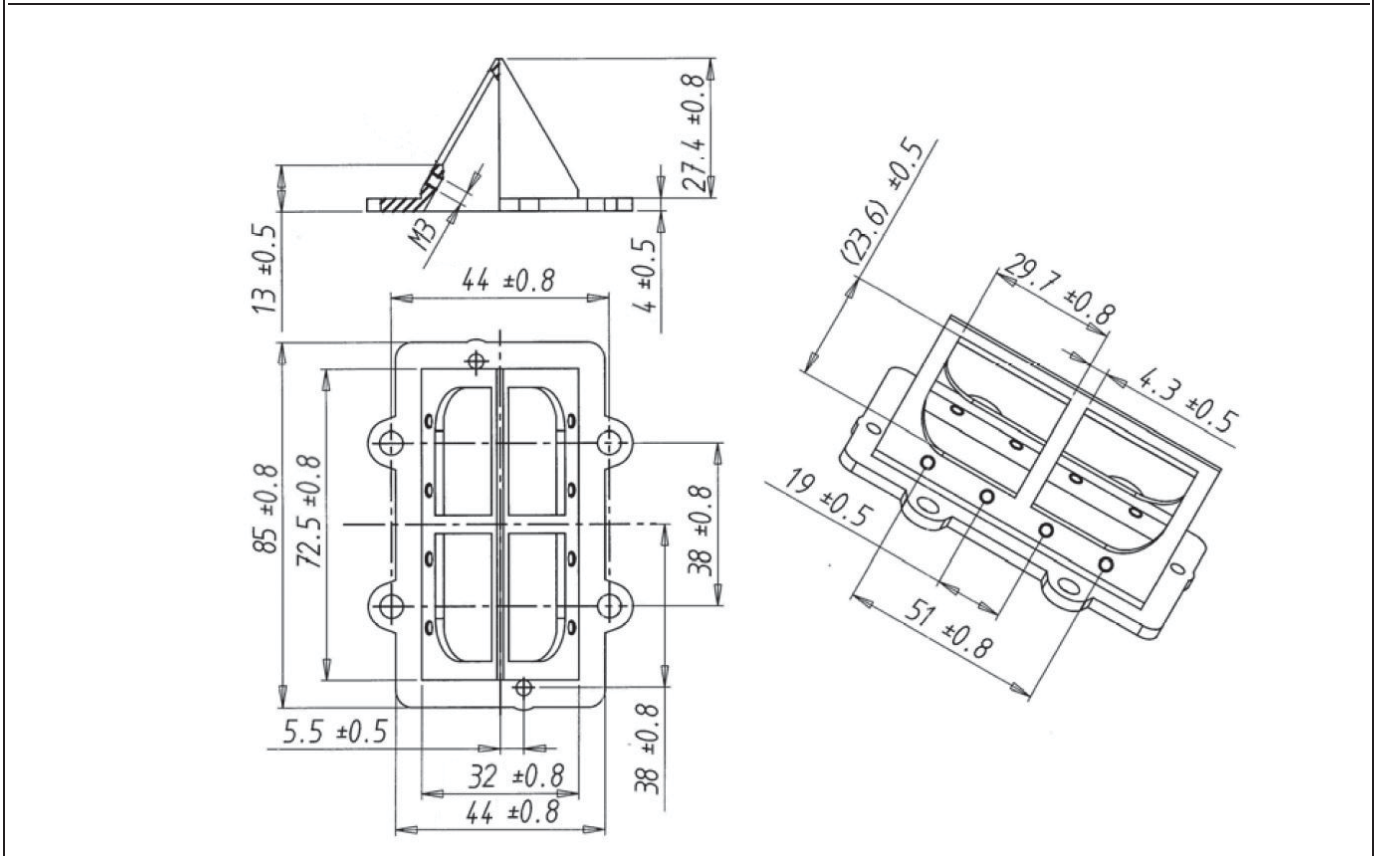

Tillotson HW-44A 24mm Carburetor

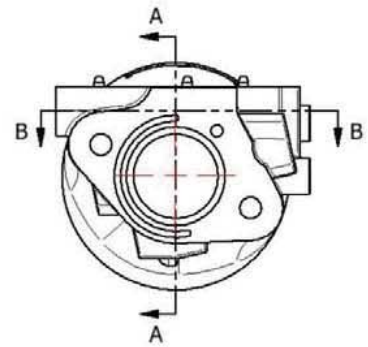
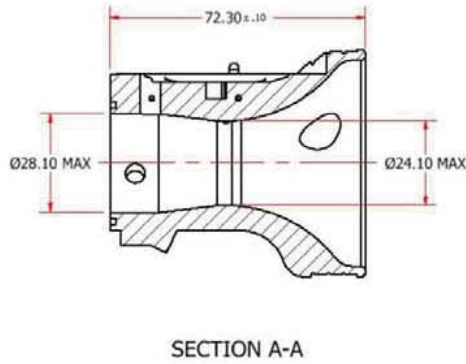
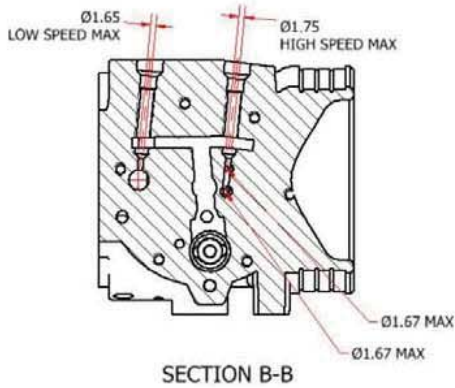

**REF.37 - P. N° 14-A118
THROTTLE SHUTTER**

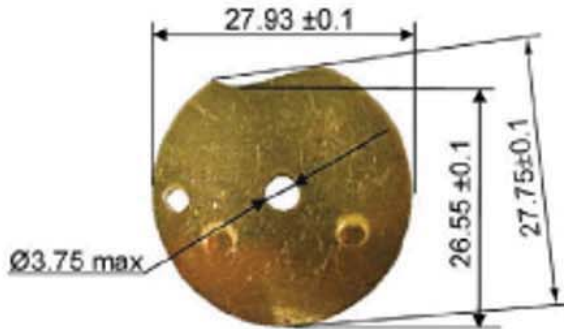

ALTERNATIVE SHAPE



Thickness = 0.84 ± 0.1 mm

**REF.27 - P. N° 233-721P
SEAT + NEEDLE**

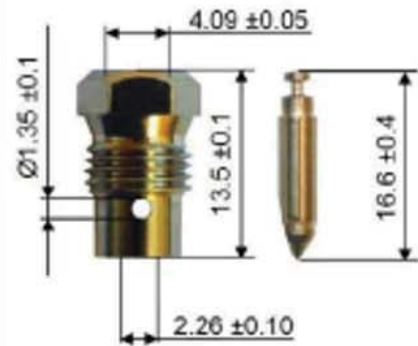

**REF.21A - P. N° 43-1029
NEEDLE LOW SPEED**



**REF.30A - P. N° 43-1030
NEEDLE HIGH SPEED**



ALTERNATIVE FUEL NEEDLE

AIRBOX

INLET SILENCER - K560

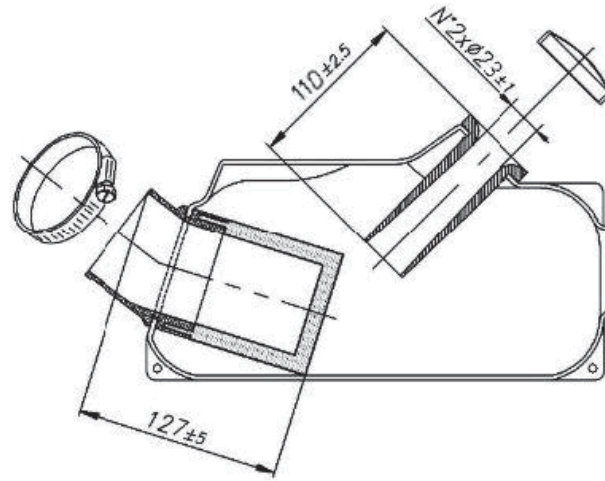

INLET SILENCER - 1750.00.50-RO

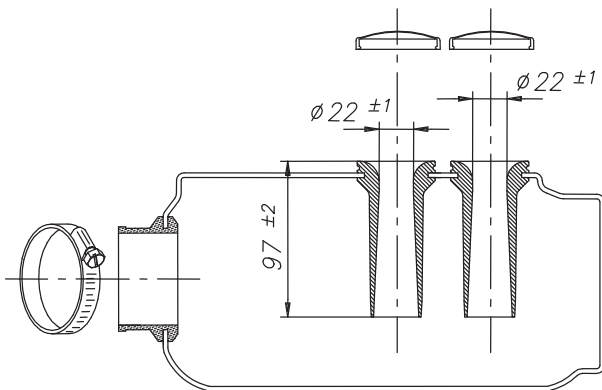

FREE LINE mod. AL-22-PS exclusivement
-L-22-PS only



EXHAUST RESTRICTOR - 20.15598.06

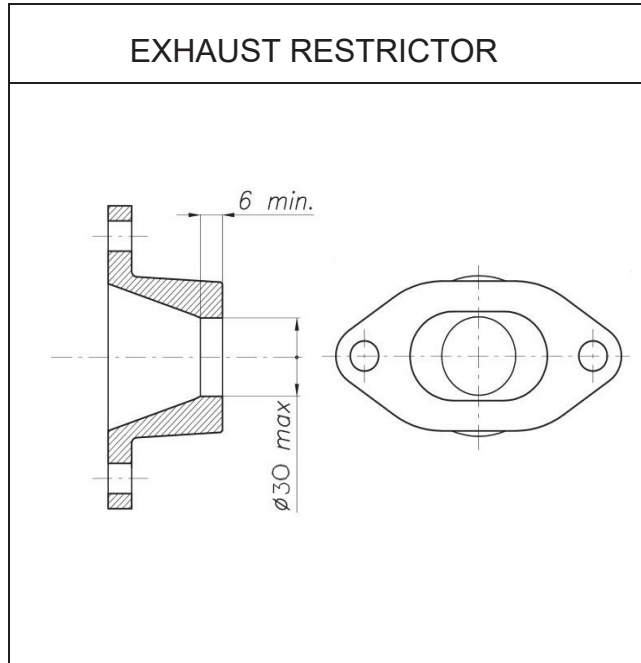

ELECTRICAL SYSTEM SCHEMATIC

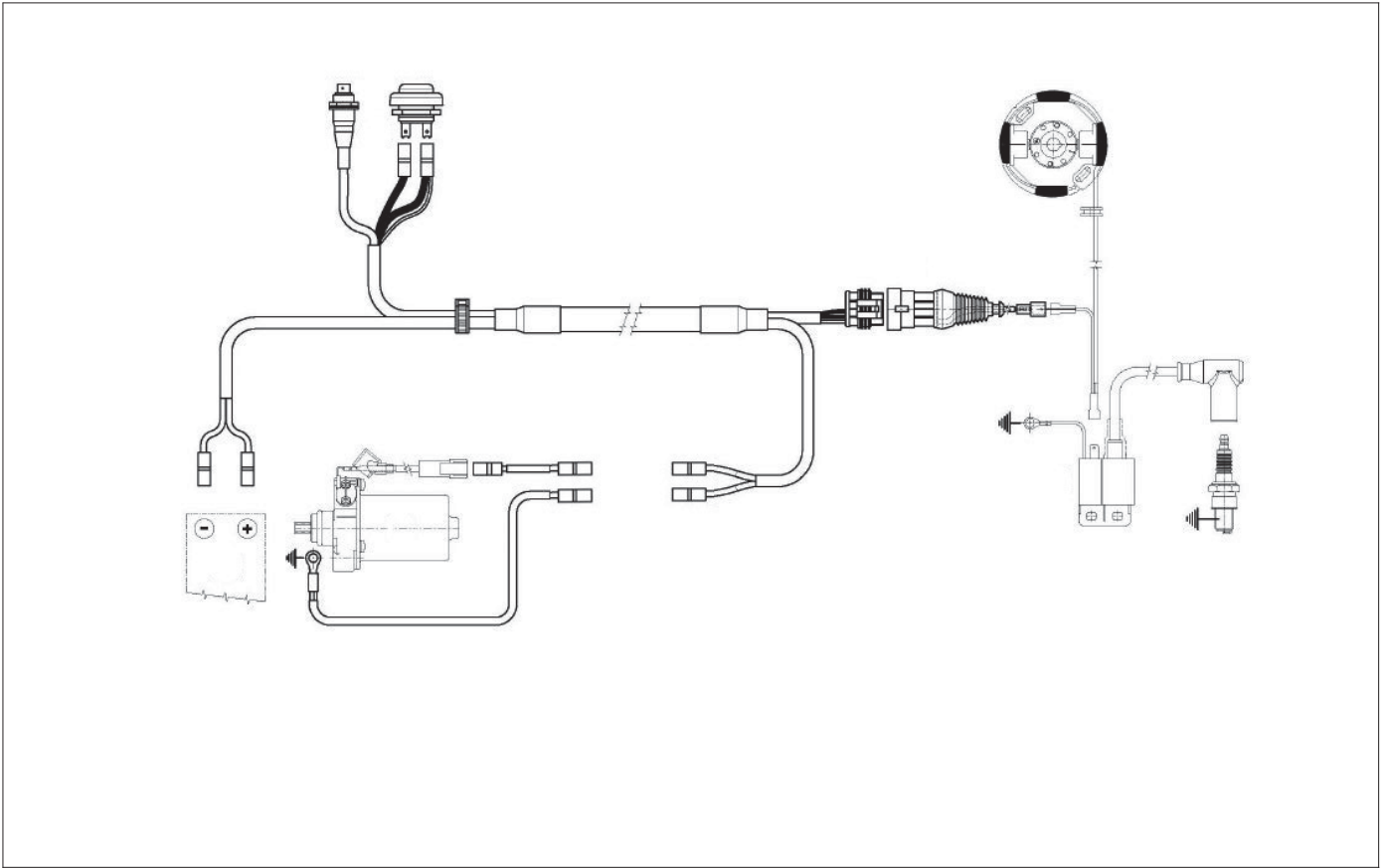

EXHAUST MUFFLER VIEW AND DIMENSIONS

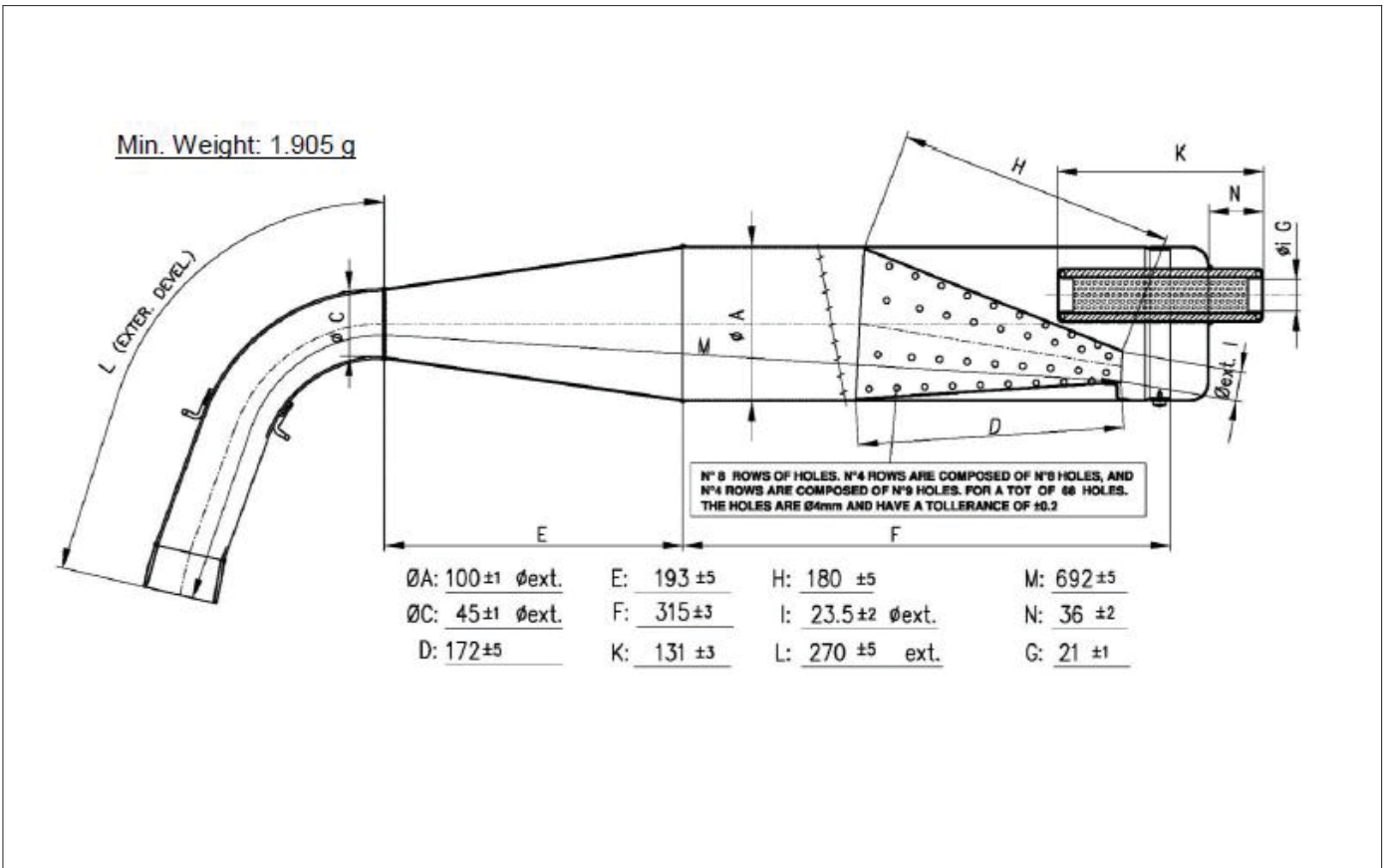

SUPPLEMENTAL PHOTO

COIL

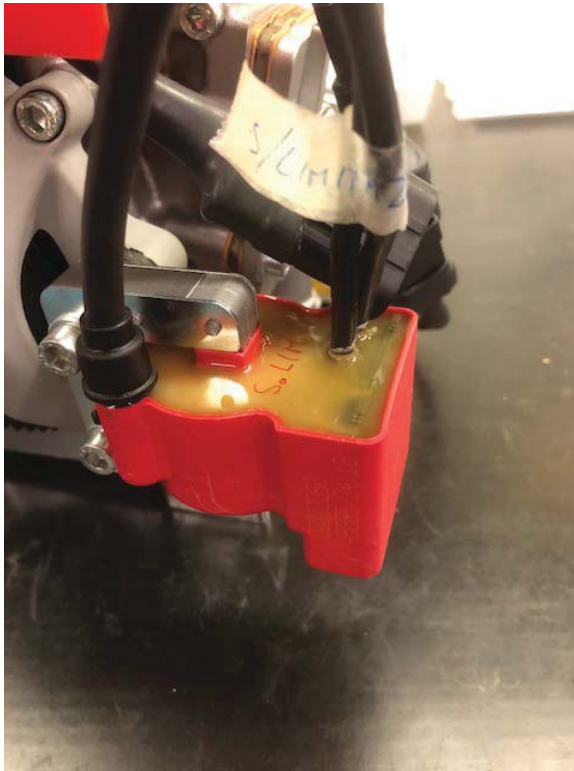

STATOR

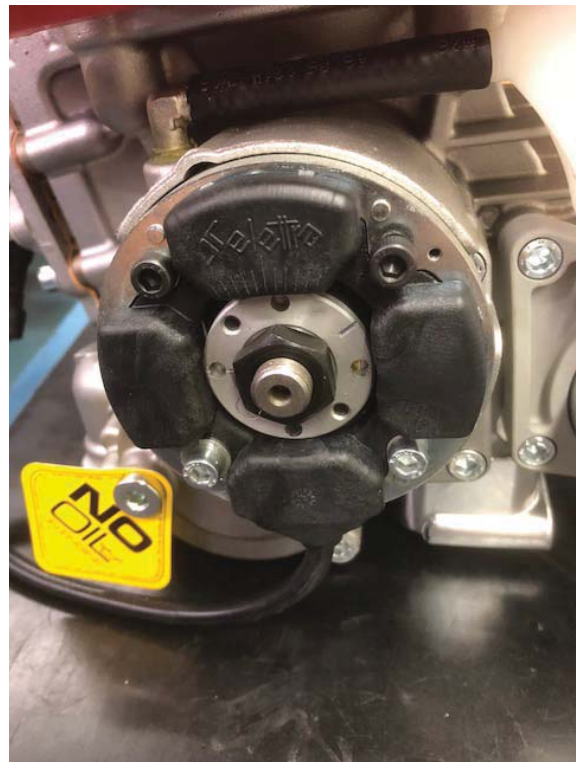

WIRING HARNESS



40.13690.00

BATTERY & SUPPORT



Battery is a non-tech item