

# Eagle eye magtronic

## Laser front axle alignment system

Thank you for purchasing the Eagle eye magtronic laser front axle alignment system. We hope this equipment will give you many years of service and live up to the name of Kelgate Performance for great product design at an affordable price. The Eagle eye magtronic contains many novel features and design advantages. Please take time to read and understand the instructions in order to get the best from this equipment.

### What it can do.

Eagle eye magtronic is for checking and setting the Toe, Camber and Caster angle (with the additional caster angle adapter) on most types of Kart. It has the ability to fit front stub axles with diameters from 12 to 25mm (1/2" to 1") diameter directly and larger stub axles to 50mm (1 5/8"). It can also be fitted on both these with or without the wheels on the stub axles. Thus dynamic settings can be achieved. Because of its unique design the laser beam is kept well clear of the king pin arrangement and any disc brake assembly. It can also be used in conjunction with our Rear axle alignment system to provide a complete setup arrangement.

### Specification.

Light source : Class II solid state laser	Axle sizes : 17mm to 50mm (3/4" to 2")
Control : Multi mode Microprocessor controlled beam either modulated or full beam	Material : Aircraft grade Aluminium alloy for body
Power : Lithium primary cell type CR2 (commonly available)	Finish : Hard anodised for long life
Battery life : Sleep mode up to 5 years	Weight : Each unit weighs approximately 155gm
: Wake mode up to 70 hours continuous use	Magnets : Rare earth Neodymium
Operation : Short press for LOW power - long press (1 sec) for FULL power	
: One press for OFF : Auto OFF after about 8.5 minutes	

Kelgate Performance reserves the right to change specifications without notice Maintenance.

Keep clean by removing excess oil and other materials. Avoid water and keep from rain. This product is not waterproof. Do not drop. (Kelgate provide a recalibration service should this occur.) To replace the battery remove the 4 screws. This exposes the battery which can be gently prised from its holder and replaced. Note carefully the polarity!!

### Warranty.

This product is warranted against faulty materials and workmanship for 12 months.

GBP [www.kelgate.com](http://www.kelgate.com)  
 EUR [www.kelgate.net](http://www.kelgate.net)  
 Email: [sales@kelgate.com](mailto:sales@kelgate.com)

View from above

## BASICS

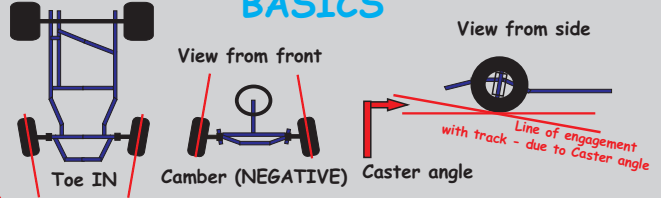

4 STEP SET UP

- 1 Remove the front wheels
- 2 Check steering trunion is central
- 3 Restrain the steering column
- 4 Loosen up King pins and track rods

**NOTE**  
 Measurements can also be made with wheels on, Kart on the ground and driver in position.

## FIT FRONT LASERS

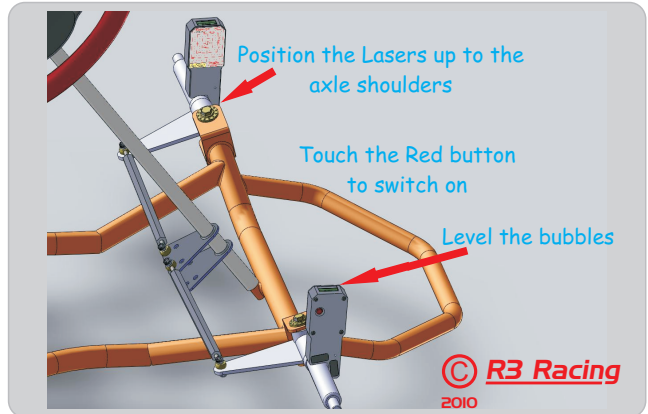

## 1 - TOE

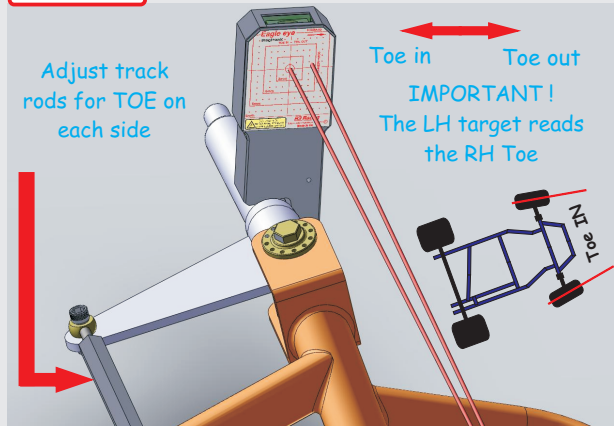

## 2 - CAMBER

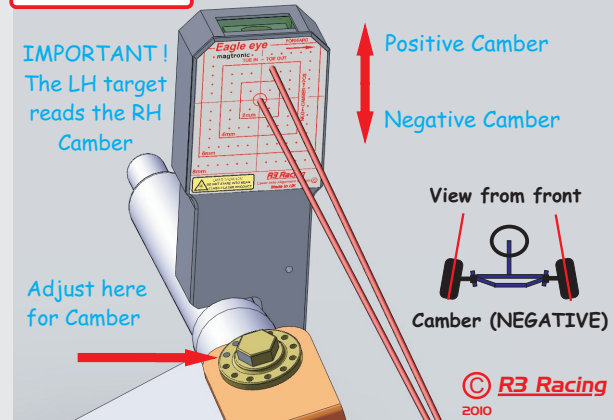

## CASTER

The Eagle eye magtronic's unique caster gauge enables you to set and check your caster angle quickly and easily

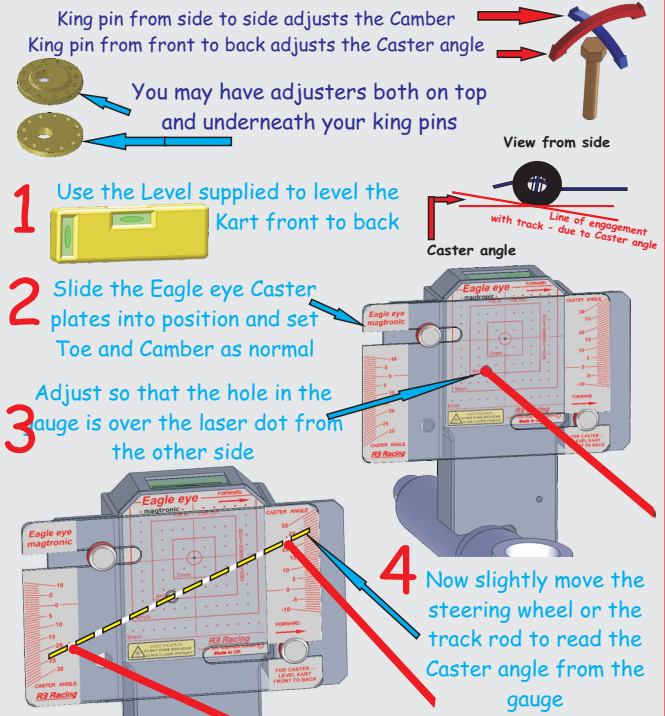

Note that the angle has been measured with the steering wheel in the central position. This is where it is important!

© R3 Racing 2010