

IAME



Parilla

PV100 MAXI '04 - VO
PV100 SWIFT '04 - VO
PV100 SWIFT '05 - VO
PV100 SWIFT '06 - VO

2006 CATALOGO PARTI DI RICAMBIO
SPARE-PARTS CATALOGUE
CATALOGUE PIECES DETACHEES

COP-228

<u>IMPORTANTE</u>	<u>IMPORTANT</u>	<u>IMPORTANT</u>
<p>Il presente listino è in vigore dal giorno 01.01.2006</p> <p>I prezzi si intendono Franco Fabbrica. Imballo al puro costo. PER ORDINARE PARTI DI RICAMBIO E' INDISPENSABILE INDICARE NELL'ORDINE IL NUMERO DI CODICE DI OGNI RICAMBIO.</p> <p>I prezzi potranno essere modificati senza preavviso.</p>	<p>This price-list is effective starting from 01.01.2006</p> <p>Prices are Free Factory. Packing at pure cost. WHEN ORDERING SPARE PARTS IT IS NECESSARY TO MENTION THE CODE NUMBER OF EACH SPARE PART.</p> <p>The prices are subject to change without notice.</p>	<p>Cette liste de prix est valide à partir du 01.01.2006</p> <p>Les prix sont Franco Usine. Emballage à prix de coût. POUR COMMANDER LES PIECES DE RECHANGE IL EST INDISPENSABLE DE MENTIONNER LE CODE DE CHAQUE PIECE.</p> <p>Les prix pourront subir des variations sans préavis.</p>

Pag	INDICE	INDEX	INDEX
1	Testa e cilindro	Cylinder and head	Culasse et cylindre
2	Pistone, segmento, spinotto MAXI '04	Piston, ring, piston pin MAXI '04	Piston, segment, axe de piston MAXI '04
3	Pistone, segmento, spinot. SWIFT '04-'05 '06	Piston, ring, piston pin SWIFT '04-'05-'06	Piston, segment, axe de piston SWIFT '04-'05-'06
4	Basamento, albero motore	Crankcase, crankshaft	Carter, vilebrequin
5	Accensione elettronica	Electrical ignition	Allumage électrique
6	Gruppo frizione	Clutch group	Groupe embrayage
7	Sistema ammissione/scarico, guarnizioni	Exhaust / inlet system, gasket kit	Systeme échappement / admission, joints
8	Silenziatore addizionale	Additional silencer	Silencieux supplémentaire
9	Estrattori e attrezzi vari	Pullers and tools	Extracteurs et outils
10	Gruppo controllo fase, Kit smont. albero	Timing group control, crankshaft disass. Kit	Groupe controle distribution, démont. vilebrequin
11	Gruppo avviatore	Starter group	Groupe demarreur

IAME

2004 MOTOR LINE - LIGNE DES MOTEURS 2004 - LINEA MOTORI 2004

Parilla PV100 MAXI '04 - VO

CIK/FIA 2004/2009 Variant Option



Bore Alésage Alesaggio = 49.86 mm

Stroke Course Corsa = 50.7 mm

Max. Bore Max. Alesage Max. Alesaggio = 50.11 mm

CIK-FIA homologated - Homologué CIK-FIA - Omologato CIK-FIA

IAME

2006 MOTOR LINE - LIGNE DES MOTEURS 2006 - LINEA MOTORI 2006

Parilla PV100 SWIFT '04 - VO PV100 SWIFT '05 - VO PV100 SWIFT '06 - VO

CIK-FIA 2004/2006 Variant Option



Bore Alésage Alesaggio = 52.40 mm

Stroke Course Corsa = 46 mm

Max. Bore Max. Alesage Max. Alesaggio = 52.61 mm

CIK-FIA homologated - Homologué CIK-FIA - Omologato CIK-FIA

TESTA E CILINDRO - HEAD AND CYLINDER - CULASSE ET CYLINDRE

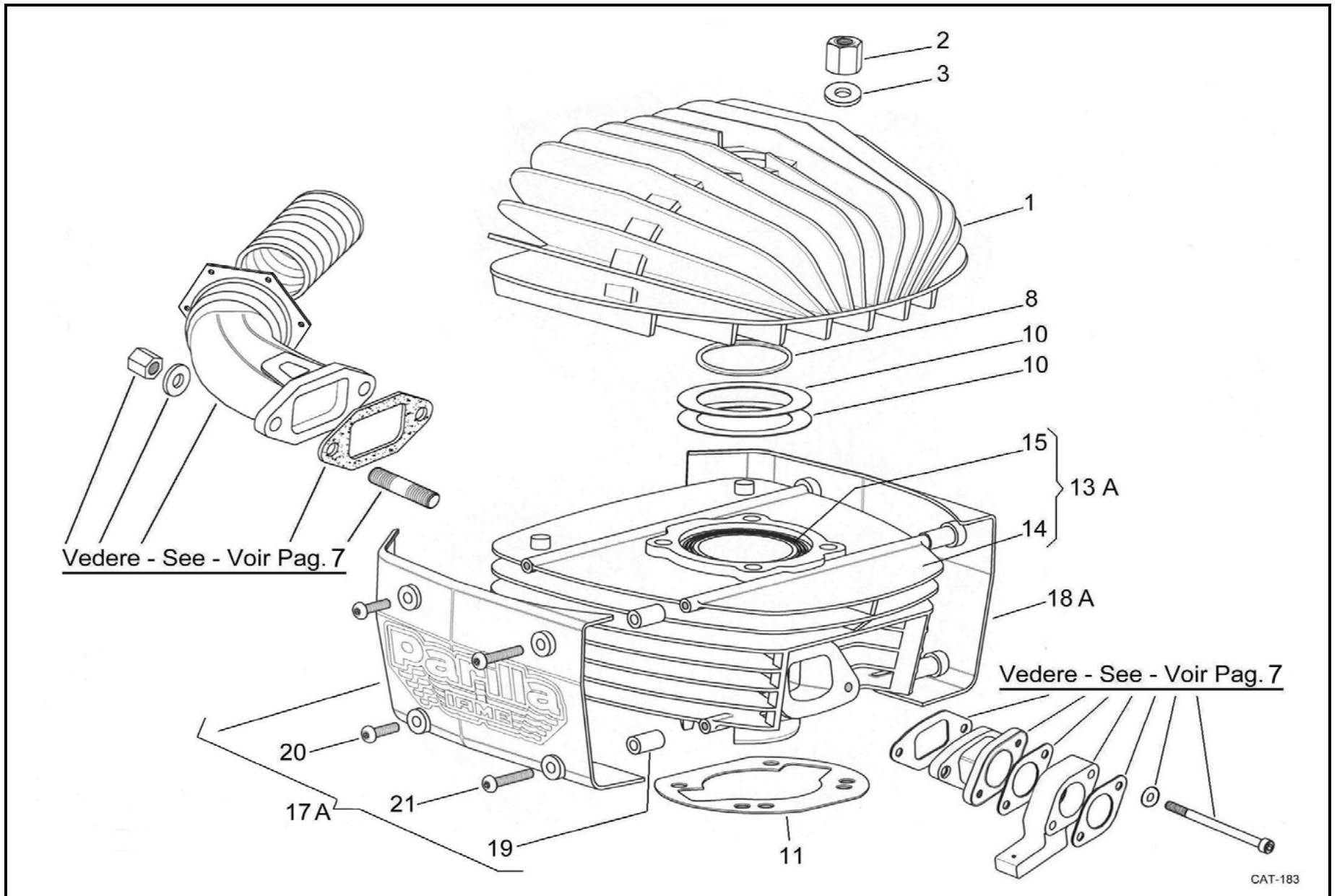

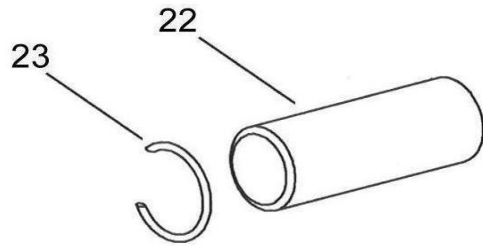
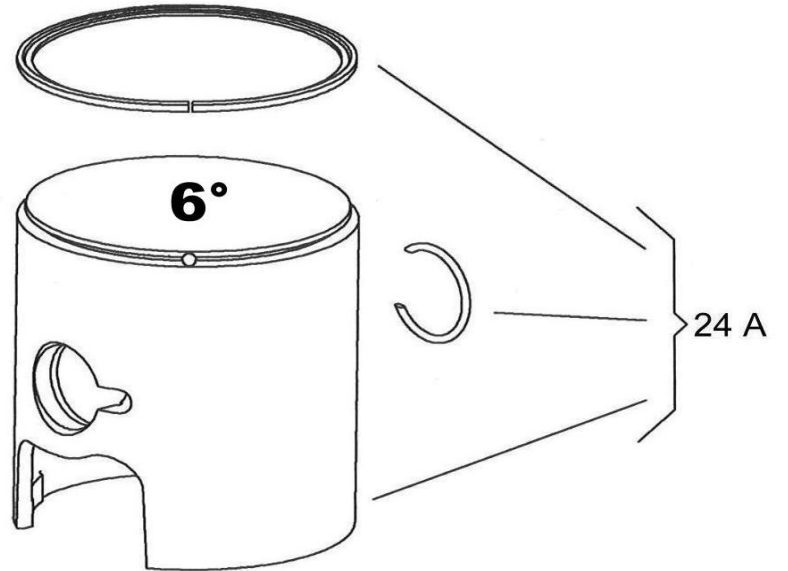
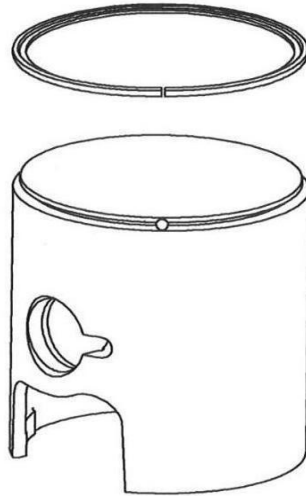
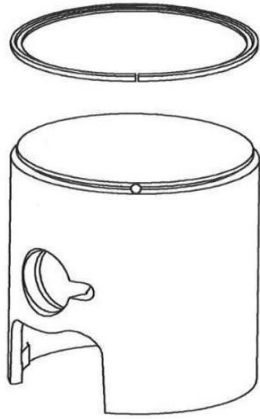
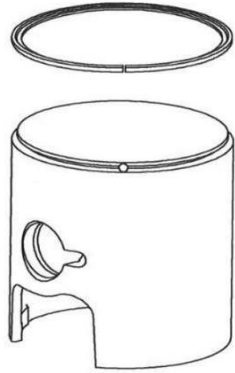

PISTONE - PISTON - PISTON

PV100 MAXI '04 - VO



PARILLA PV100 - 100cc

PISTONE - PISTON - PISTON

Fig.	Code		Dim.			PV 100											
						MAXI '04-VO											
		Descrizione		Description	Description												
22	B-10321-R	SPINOTTO biconico 1^ selez.	14x39	Biconical piston PIN 1^ sel.	AXE de piston biconique 1^ sel.		X										
22	B-10321-B	SPINOTTO biconico 2^ selez.	14x39	Biconical piston PIN 2^ sel.	AXE de piston biconique 2^ sel.		X										
22	B-10321-G	SPINOTTO biconico 3^ selez.	14x39	Biconical piston PIN 3^ sel.	AXE de piston biconique 3^ sel.		X										
23	10341-A	ANELLINO F/SPINOTTO	14X1,2	CIRCLIP	ARRET axe de piston		X										
24A	G-100050-CV	PISTONE completo verde - 6°	T-08 49,86 v	Complete green PISTON - 6°	PISTON complet vert - 6°		X										
24A	G-100050-CR	PISTONE completo rosso - 6°	T-08 49,86 r	Complete red PISTON -6°	PISTON complet rouge - 6°		X										
24A	G-100053-CV	PISTONE completo verde - 6°	T-08 49,88 v	Complete green PISTON - 6°	PISTON complet vert - 6°		X										
24A	G-100053-CR	PISTONE completo rosso - 6°	T-08 49,88 r	Complete red PISTON -6°	PISTON complet rouge - 6°		X										
24A	G-100056-CV	PISTONE completo verde - 6°	T-08 49,90 v	Complete green PISTON - 6°	PISTON complet vert - 6°		X										
24A	G-100056-CR	PISTONE completo rosso - 6°	T-08 49,90 r	Complete red PISTON -6°	PISTON complet rouge - 6°		X										
24A	G-100059-CV	PISTONE completo verde - 6°	T-08 49,92 v	Complete green PISTON - 6°	PISTON complet vert - 6°		X										
24A	G-100059-CR	PISTONE completo rosso - 6°	T-08 49,92 r	Complete red PISTON -6°	PISTON complet rouge - 6°		X										
24A	G-100062-CV	PISTONE completo verde - 6°	T-08 49,94 v	Complete green PISTON - 6°	PISTON complet vert - 6°		X										
24A	G-100062-CR	PISTONE completo rosso - 6°	T-08 49,94 r	Complete red PISTON -6°	PISTON complet rouge - 6°		X										
24A	G-100065-CV	PISTONE completo verde - 6°	T-08 49,96 v	Complete green PISTON - 6°	PISTON complet vert - 6°		X										
24A	G-100065-CR	PISTONE completo rosso - 6°	T-08 49,96 r	Complete red PISTON -6°	PISTON complet rouge - 6°		X										
24A	G-100068-CV	PISTONE completo verde - 6°	T-08 49,98 v	Complete green PISTON - 6°	PISTON complet vert - 6°		X										
24A	G-100068-CR	PISTONE completo rosso - 6°	T-08 49,98 r	Complete red PISTON -6°	PISTON complet rouge - 6°		X										
24A	G-100071-CV	PISTONE completo verde - 6°	T-08 50,00 v	Complete green PISTON - 6°	PISTON complet vert - 6°		X										
24A	G-100071-CR	PISTONE completo rosso - 6°	T-08 50,00 r	Complete red PISTON -6°	PISTON complet rouge - 6°		X										
24A	G-100074-CV	PISTONE completo verde - 6°	T-08 50,02 v	Complete green PISTON - 6°	PISTON complet vert - 6°		X										
24A	G-100074-CR	PISTONE completo rosso - 6°	T-08 50,02 r	Complete red PISTON -6°	PISTON complet rouge - 6°		X										
24A	G-100077-CV	PISTONE completo verde - 6°	T-08 50,04 v	Complete green PISTON - 6°	PISTON complet vert - 6°		X										
24A	G-100077-CR	PISTONE completo rosso - 6°	T-08 50,04 r	Complete red PISTON -6°	PISTON complet rouge - 6°		X										
24A	G-100080-CV	PISTONE completo verde - 6°	T-08 50,06 v	Complete green PISTON - 6°	PISTON complet vert - 6°		X										
24A	G-100080-CR	PISTONE completo rosso - 6°	T-08 50,06 r	Complete red PISTON -6°	PISTON complet rouge - 6°		X										

PISTONE - PISTON - PISTON

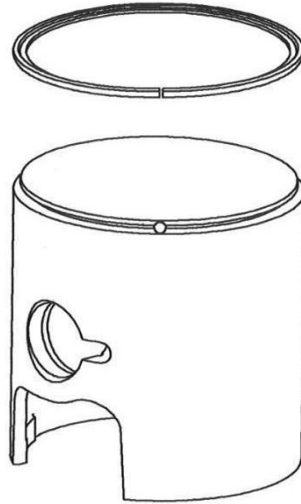
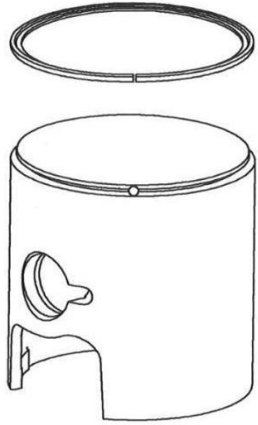
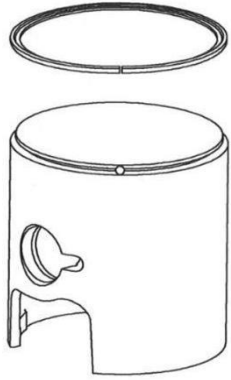

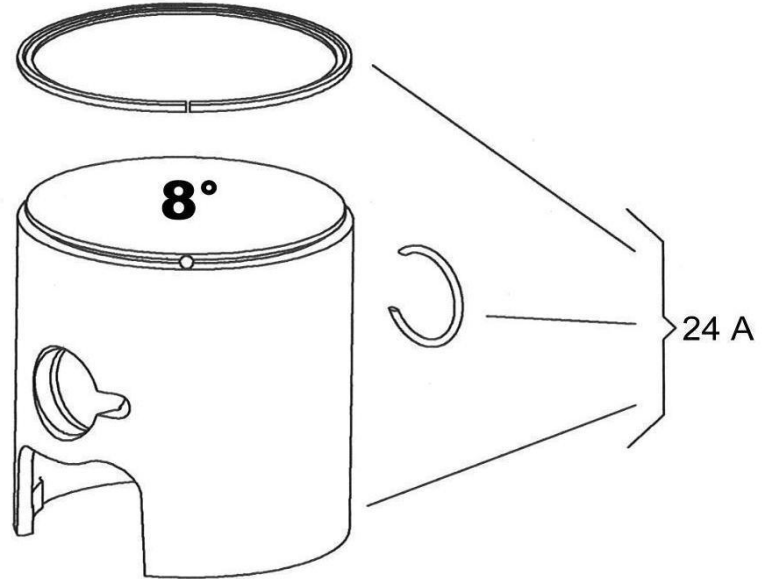
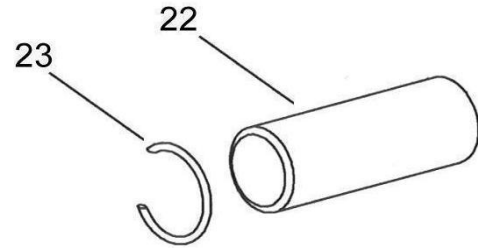

PV100 SWIFT '04 - VO
PV100 SWIFT '05 - VO
PV100 SWIFT '06 - VO



PARILLA PV100 - 100cc

PISTONE - PISTON - PISTON

Fig.	Code	 <i>Descrizione</i>	Dim.	 <i>Description</i>	 <i>Description</i>	PV 100			
						SWIFT '04-VO	SWIFT '05-VO	SWIFT '06-VO	
22	B-71320-R	SPINOTTO biconico 1^ selez.	14x41	Biconical piston PIN 1^ sel.	AXE de piston biconique 1^ sel.		X	X	X
22	B-71320-B	SPINOTTO biconico 2^ selez.	14x41	Biconical piston PIN 2^ sel.	AXE de piston biconique 2^ sel.		X	X	X
22	B-71320-G	SPINOTTO biconico 3^ selez.	14x41	Biconical piston PIN 3^ sel.	AXE de piston biconique 3^ sel.		X	X	X
23	10341-A	ANELLINO F/SPINOTTO	14X1,2	CIRCLIP	ARRET axe de piston		X	X	X
24A	G-100090-CV	PISTONE completo verde - 8°	T-08 52,40 v	Complete green PISTON - 8°	PISTON complet vert - 8°		X	X	X
24A	G-100090-CR	PISTONE completo rosso - 8°	T-08 52,40 r	Complete red PISTON - 8°	PISTON complet rouge - 8°		X	X	X
24A	G-100093-CV	PISTONE completo verde - 8°	T-08 52,42 v	Complete green PISTON - 8°	PISTON complet vert - 8°		X	X	X
24A	G-100093-CR	PISTONE completo rosso - 8°	T-08 52,42 r	Complete red PISTON - 8°	PISTON complet rouge - 8°		X	X	X
24A	G-100096-CV	PISTONE completo verde - 8°	T-08 52,44 v	Complete green PISTON - 8°	PISTON complet vert - 8°		X	X	X
24A	G-100096-CR	PISTONE completo rosso - 8°	T-08 52,44 r	Complete red PISTON - 8°	PISTON complet rouge - 8°		X	X	X
24A	G-100099-CV	PISTONE completo verde - 8°	T-08 52,46 v	Complete green PISTON - 8°	PISTON complet vert - 8°		X	X	X
24A	G-100099-CR	PISTONE completo rosso - 8°	T-08 52,46 r	Complete red PISTON - 8°	PISTON complet rouge - 8°		X	X	X
24A	G-100102-CV	PISTONE completo verde - 8°	T-08 52,48 v	Complete green PISTON - 8°	PISTON complet vert - 8°		X	X	X
24A	G-100102-CR	PISTONE completo rosso - 8°	T-08 52,48 r	Complete red PISTON - 8°	PISTON complet rouge - 8°		X	X	X
24A	G-100105-CV	PISTONE completo verde - 8°	T-08 52,50 v	Complete green PISTON - 8°	PISTON complet vert - 8°		X	X	X
24A	G-100105-CR	PISTONE completo rosso - 8°	T-08 52,50 r	Complete red PISTON - 8°	PISTON complet rouge - 8°		X	X	X
24A	G-100108-CV	PISTONE completo verde - 8°	T-08 52,52 v	Complete green PISTON - 8°	PISTON complet vert - 8°		X	X	X
24A	G-100108-CR	PISTONE completo rosso - 8°	T-08 52,52 r	Complete red PISTON - 8°	PISTON complet rouge - 8°		X	X	X
24A	G-100114-CV	PISTONE completo verde - 8°	T-08 52,56 v	Complete green PISTON - 8°	PISTON complet vert - 8°		X	X	X
24A	G-100114-CR	PISTONE completo rosso - 8°	T-08 52,56 r	Complete red PISTON - 8°	PISTON complet rouge - 8°		X	X	X
24A	G-100120-CV	PISTONE completo verde - 8°	T-08 52,60 v	Complete green PISTON - 8°	PISTON complet vert - 8°		X	X	X
24A	G-100120-CR	PISTONE completo rosso - 8°	T-08 52,60 r	Complete red PISTON - 8°	PISTON complet rouge - 8°		X	X	X

BASAMENTO E ALBERO MOTORE - CRANKCASE AND CRANKSHAFT - CARTER ET VILEBREQUIN

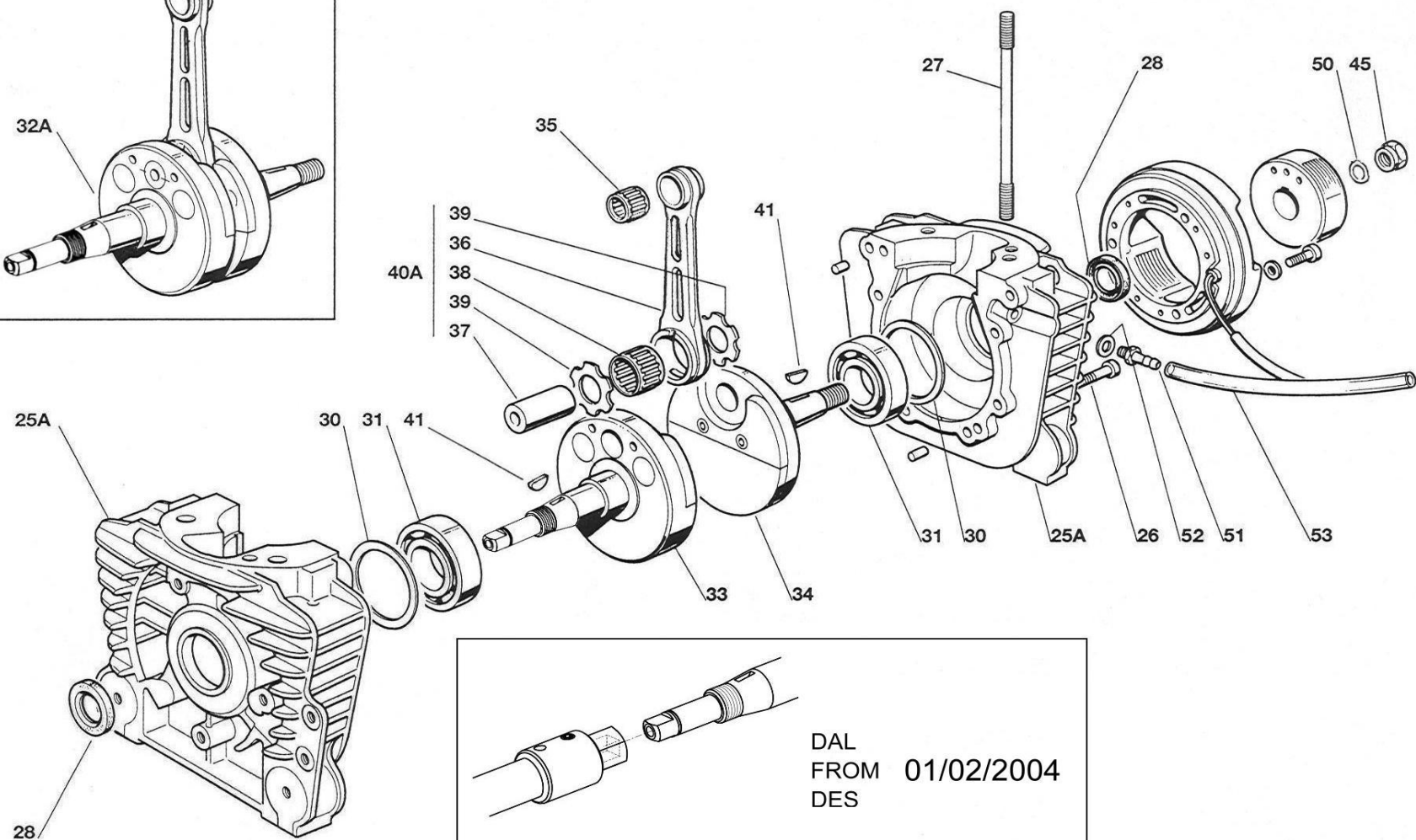
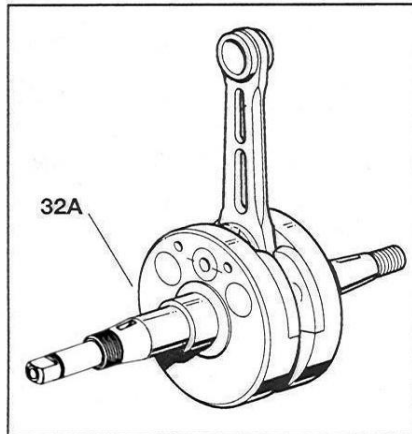

DAL
FROM 01/02/2004
DES

Vedere - See - Voir Pag.13

PARILLA PV100 - 100cc

BASAMENTO E ALBERO MOTORE - CRANKCASE AND CRANKSHAFT - CARTER ET VILEBREQUIN

Fig.	Code	 Descrizione	Dim.	 Description	 Description	PV 100			
						MAXI '04-VO	SWIFT '04-VO	SWIFT '05-VO	SWIFT '06-VO
25A	F-100485	BASAMENTO completo		Complete CRANKCASE	CARTER complet	X			
25A	G-100485A	BASAMENTO completo		Complete CRANKCASE	CARTER complet		X	X	X
26	.00049	VITE basamento	M6x45	Crankcase SCREW	VIS carter	X	X	X	X
27	E-38345	TIRANTE cilindro	8x157	Cylinder TIE-ROD	GOUJON cylindre	X	X	X	X
28	F-10425A	ANELLO TENUTA l. trasmis.	20x35x7 TCJW	Drive side OIL SEAL	ANNEAU transmiss.	X	X	X	X
28	F-10425A	ANELLO TENUTA l. accens.	20x35x7 TCJW	Magn. side OIL SEAL	ANNEAU magneto	X	X	X	X
30	30407	RASAMENTO acciaio	0,1mm	Steel SHIM	RONDELLE acier	X	X	X	X
30	30404	RASAMENTO acciaio	0,15mm	Steel SHIM	RONDELLE acier	X	X	X	X
31	35396-A	CUSCINETTO 6205-T1XAC4	NSK	BALL BEARING 6205-T1XAC4	ROULEMENT 6205-T1XAC4	X	X	X	X
31	B-36398	CUSCINETTO RHP 7205		BALL BEARING RHP 7205	ROULEMENT RHP 7205	X	X	X	X
32A	G-100617B	ALBERO MOTORE completo		Complete CRANKSHAFT	VILEBREQUIN complet		X	X	X
32A	G-100615	ALBERO MOTORE completo		Complete CRANKSHAFT	VILEBREQUIN complet	X			
33	G-100385	SEMIALBERO l. trasmissione		Drive s.HALF CRANKSHAFT	DEMI VILEBREQUIN trans.	X			
33	G-100387	SEMIALBERO l. trasmissione		Drive s.HALF CRANKSHAFT	DEMI VILEBREQUIN trans.		X	X	X
34	E-10390	SEMIALBERO l. accensione		Magn.s.HALF CRANKSHAFT	DEMI VILEBREQUIN magn.	X			
34	E-10391	SEMIALBERO l. accensione		Magn.s.HALF CRANKSHAFT	DEMI VILEBREQUIN magn.		X	X	X
35	E-10440	GABBIETTA piede biella		Small end CAGE	CAGE pied bielle	X	X	X	X
36	E-10460	BIELLA	int. 100mm.	CONROD	BIELLE	X			
36	E-10461B	BIELLA	int.94mm.	CONROD	BIELLE		X	X	X
37	D-37450	ASSE accoppiamento	18x46 mm.	CRANKPIN	AXE de vilebrequin	X	X	X	X
38	B-10431	GABBIETTA testa biella 15 R		Big end CAGE 15 R	CAGE axe de vilebrequin 15 R	X	X	X	X
39	E-38436	RONDELLA bronzo		Bronze WASHER	RONDELLE bronze	X	X	X	X
40A	E-10460-46	BIELLA completa selezionata	int.100mm.	Complete selected CONROD	BIELLE complete selectionnée	X			
40A	E-10461B-46	BIELLA completa selezionata	int.94mm.	Complete selected CONROD	BIELLE complete selectionnée		X	X	X
41	11715	CHIAVETTA pignone	10x3,7x3	Sprocket KEY	CLAVETTE pignon	X	X	X	X
41	11715	CHIAVETTA volano	10x3,7x3	Magneto KEY	CLAVETTE magneto	X	X	X	X
45	10535	DADO volano		Magneto NUT	ECROU magneto	X	X	X	X
50	D-75565	RONDELLA accensione Super		Super ignition WASHER	RONDELLE allumage Super	X	X	X	X
51	D-95800	RACCORDO presa pressione		Pressure FITTING	RACCORD pression	X	X	X	X
52	B-71805	GUARNIZIONE racc. press.		Pressure fitting GASKET	JOINT raccord pression	X	X	X	X
53	B-71810	TUBO raccordo presa press.		Pressure fitting TUBE	TUBE raccord pression	X	X	X	X

ACCENSIONE ELETTRONICA - ELECTRONIC IGNITION - ALLUMAGE ELECTRONIQUE



! IMPORTANTE:

I motori PV100 sono attualmente equipaggiati da un'accensione SELETTRA, tipo SUPER.

L'anticipo di accensione è di:
PV100 MAXI: 2.7 mm prima del P.M.S.
PV100 SWIFT: 3.2 mm prima del P.M.S.



! IMPORTANT:

At present The PV100 engines are equipped with the SELETTRA ignition, in the SUPER version.

Advance timing:
PV100 MAXI: 2.7 mm before T.D.C.
PV100 SWIFT: 3.2 mm before T.D.C.

"Selettra"

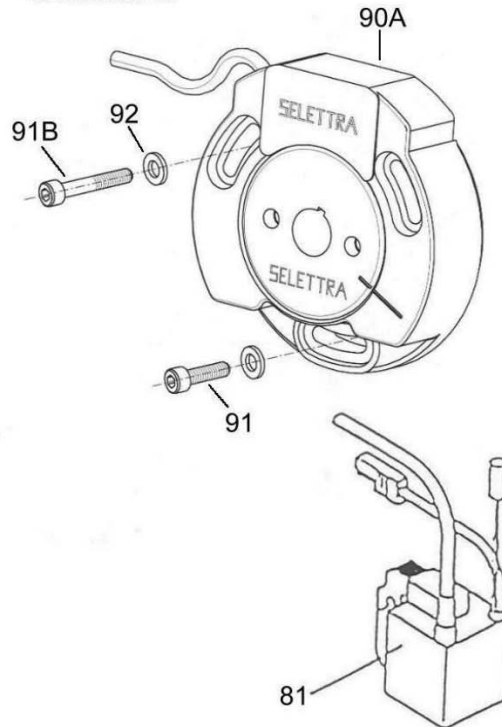

! IMPORTANT:

Les moteurs PV100 sont actuellement équipés d'allumage SELETTRA, version SUPER.

L'avance d'allumage est fixée à:
PV100 MAXI: 2.7 mm avant le P.M.S.
PV100 SWIFT: 3.2 mm avant le P.M.S.

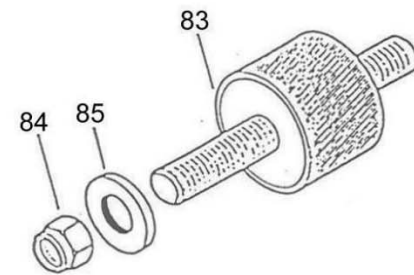
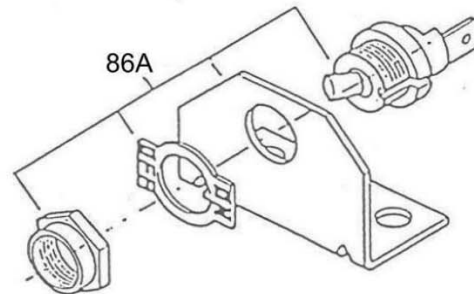
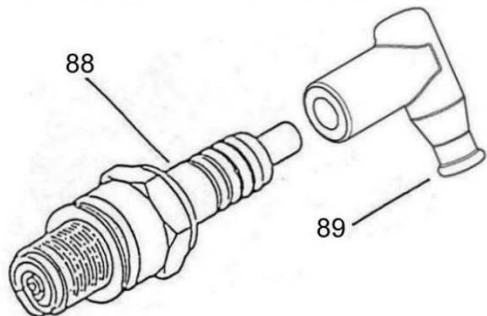

GRUPPO FRIZIONE / CLUTCH GROUP / GROUPE EMBRAYAGE

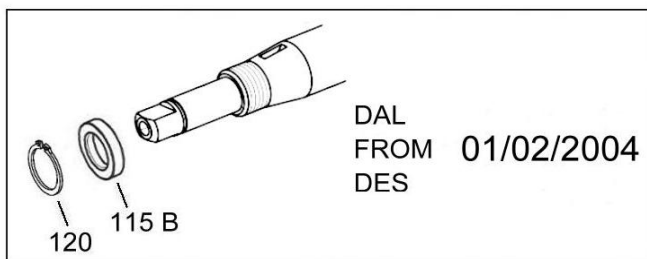
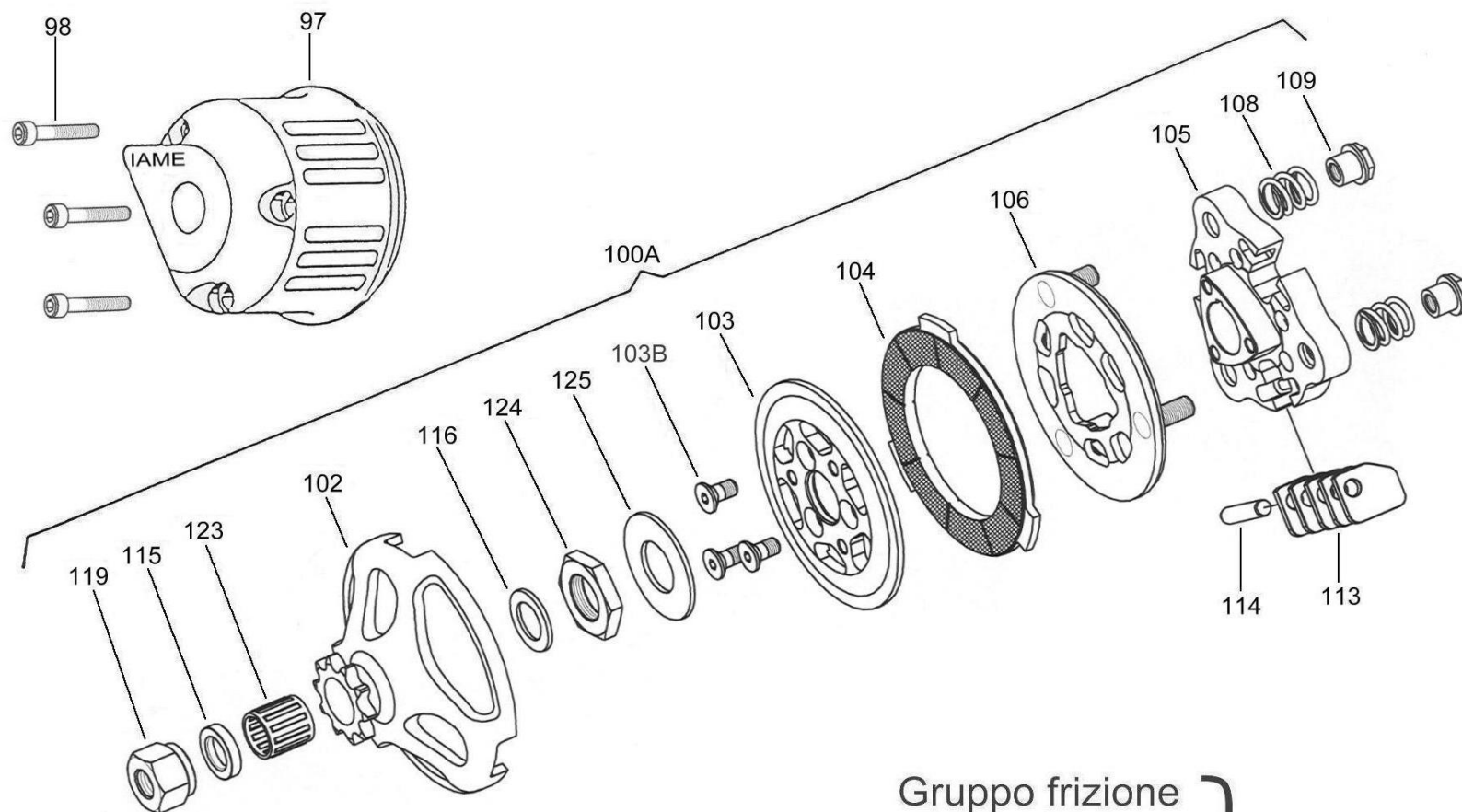

Gruppo frizione }
Clutch group } **"HORSTMAN"**
Groupe embrayage }

SISTEMA AMMISSIONE E SCARICO - SERIE GUARNIZIONI / INLET & EXHAUST SYSTEM - GASKETS SISTEME ADMISSION ET ECHAPPEMENT - SERIE JOINTS.

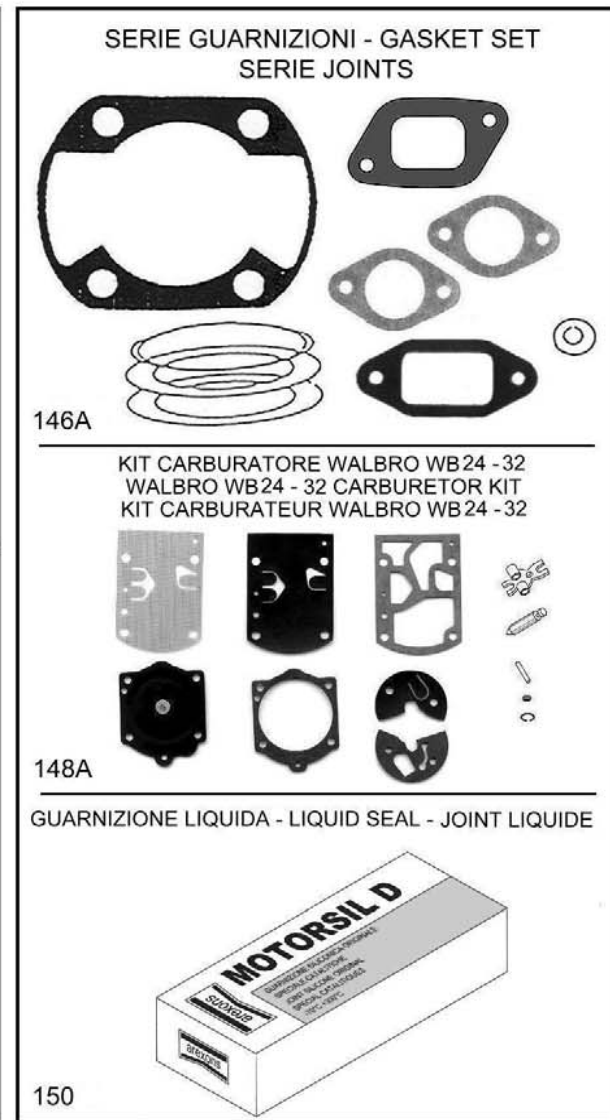
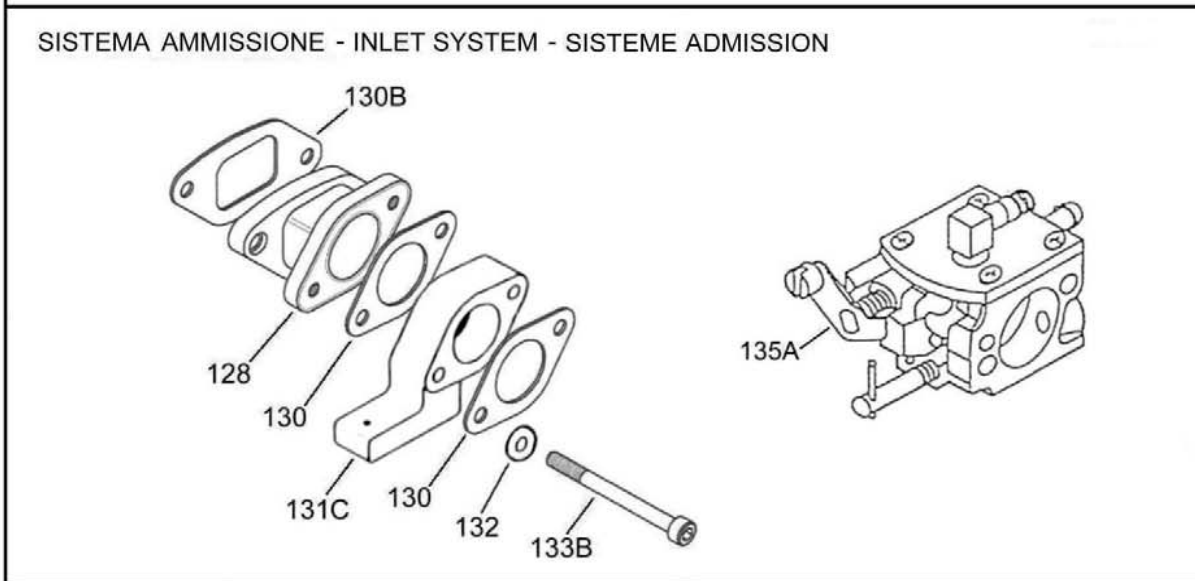
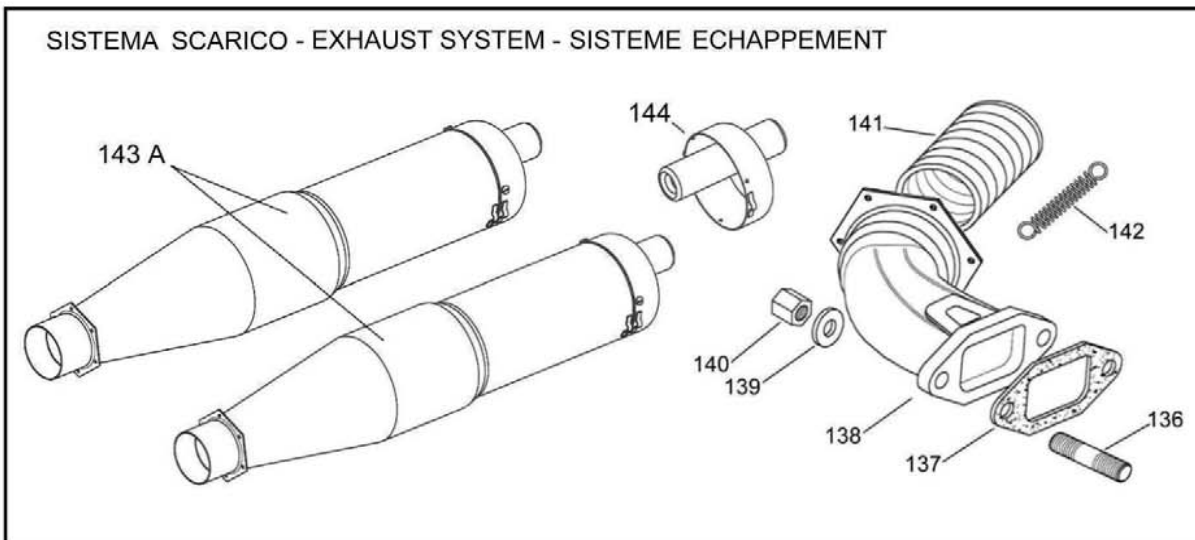



PARILLA PV100 - 100cc

SISTEMA AMMISSIONE E SCARICO - SERIE GUARNIZIONI INLET & EXHAUST SYSTEM - GASKETS SET SISTEME ADMISSION ET ECHAPPEMENT - SERIE JOINTS.

Fig.	Code		Dim.			PV 100			
						MAXI '04-VO	SWIFT '04-VO	SWIFT '05-VO	SWIFT '06-VO
		<i>Descrizione</i>		<i>Description</i>	<i>Description</i>				
128	F-100825	RACCORDO elastico carburatore	Ø27	Elastic carb. MANIFOLD	ENTRETOISE elastic carburateur		X	X	X
128	F-100825A	RACCORDO elastico carburatore	Ø30	Elastic carb. MANIFOLD	ENTRETOISE elastic carburateur	X			
130	B-71822	GUARNIZIONE carburatore		Carburetor GASKET	JOINT carburateur	X	X	X	X
130B	F-100826	GUARNIZIONE raccordo elastico		Elastic manifold GASKET	JOINT raccord elastic	X	X	X	X
131B	F-100818A	DISTANZIALE termico	Ø27	Thermic SPACER	ENTRETOISE termique		X	X	X
131C	G-100818	DISTANZIALE termico conico	Ø27-Ø30	Conical thermic SPACER	ENTRETOISE conique termique	X			
132	.00302	RONDELLA vite distanziale	M6	Spacer screw WASHER	RONDELLE vis entretoise	X	X	X	X
133B	.00053	Vite fissaggio distanziale	M6x65	Spacer locking SCREW	VIS entretoise de blocage	X	X	X	X
135A	10919	CARBURATORE Walbro	WB32	Walbro CARBURETOR	CARBURATEUR Walbro	X	X	X	X
136	B-75355	PRIGIONIERO scarico	M8x36	Exhaust STUDBOLT	GOIJON echappement	X	X	X	X
137	B-75360	GUARNIZIONE scarico		Exhaust pipe GASKET	JOINT pipe echappement	X	X	X	X
138	G-100365	RACCORDO scarico		Exhaust PIPE	PIPE echappement	X	X	X	
138	G-100365A	RACCORDO scarico		Exhaust PIPE	PIPE echappement				X
139	.00332	RONDELLA dado scarico	M8	Exhaust nut WASHER	RONDELLE ecrou echapp.	X	X	X	X
140	B-75660	DADO scarico	M8	Exhaust NUT	ECROU echappement	X	X	X	X
141	10711-B	FLESSIBILE L. 13cm.	D.45mm.	FLEXIBLE L. 13cm.	FLEXIBLE L, 13cm.	X	X	X	X
142	10785	MOLLA tenuta flessibile	L=45mm	Flexible SPRING	RESSORT flexible	X	X	X	X
143A	E-10718	SILENZIATORE Junior	CIK '98	Junior SILENCER	SILENCIEUX Junior		X	X	X
143A	F-10718	SILENZIATORE Junior	CIK '01	Junior SILENCER	SILENCIEUX Junior	X			
144	10721-A	TERMINALE silenziatore		Silencer END	EMBOUT silencieux	X	X	X	X
146A	F-100995	SERIE guarnizioni		Gaskets SET	SERIE joints	X			
146A	G-100990	SERIE guarnizioni		Gaskets SET	SERIE joints		X	X	X
148A	10928-A	KIT carburatore Walbro		KIT for Walbro carburetor	KIT pour carburateur Walbro	X	X	X	X
150	.00602	GUARNIZIONE liquida		Liquid GASKET	JOINT liquide	X	X	X	X

PARILLA PV100 - 100cc

SILENZIATORE ADDIZIONALE COMPLETO / COMPLETE ADDITIONAL SILENCER SILENCIEUX SUPPLEMENTAIRE COMPLET

Fig.	Code	 Descrizione	Dim.	 Description	 Description	PV 100			
						MAXI '04-VO	SWIFT '04-VO	SWIFT '05-VO	SWIFT '06-VO
145B	F-10722A-C	SILENZIATORE addiz. compl.		Complete additional SILENCER	SILENCIEUX supplém. complet	X	X	X	X
145C	F-10725-C	KIT di montaggio		Muffler assembling KIT	KIT pour le montage	X	X	X	X



145 B



SILENZIATORE
ADDIZIONALE
COMPLETO

Cod. F-10722A-C



COMPLETE
ADDITIONAL
SILENCER

Cod. F-10722A-C



SILENCIEUX
SUPPLEMENTAIRE
COMPLET

Cod. F-10722A-C



145 C



KIT DI MONTAGGIO cod. F-10725-C



MUFFLER ASSEMBLING KIT cod. F-10725-C





KIT POUR LE MONTAGE cod. F-10725-C

CAT-158

PARILLA PV100 - 100cc

ESTRATTORI & ATTREZZI - PULLER & TOOLS - EXTRACTEURS & OUTILS

Fig.	Code	 Descrizione	Dim.	 Description	 Description	PV 100			
						MAXI '04-VO	SWIFT '04-VO	SWIFT '05-VO	SWIFT '06-VO
172	10826-C	ESTRATTORE rot.Pvl/Selettra		Pvl/Selettra rotor PULLER	EXTRACTEUR rot.Pvl/Selet.	X	X	X	X
173	B-55614-C	ESTRATTORE friz. Junior		Junior clutch PULLER	EXTRACTEUR embr.Junior	X	X	X	X
177	B-55168-A	CHIAVE blocc.friz. Junior		Junior clutch lock. WRENCH	CLEF bloq. embrayage Junior	X	X	X	X
179	10137	CHIAVE blocc.rot.Pvl/Selettra		Pvl/Selettra rotor WRENCH	CLEF arret rotateur Pvl/Selettra	X	X	X	X

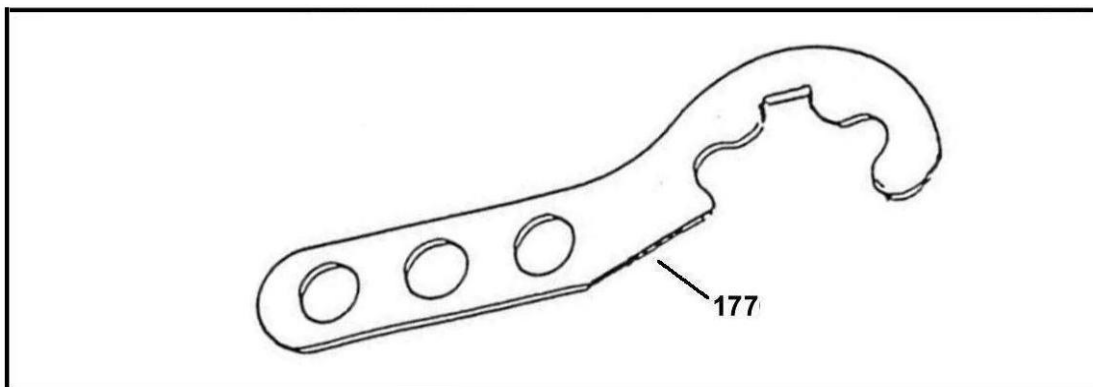
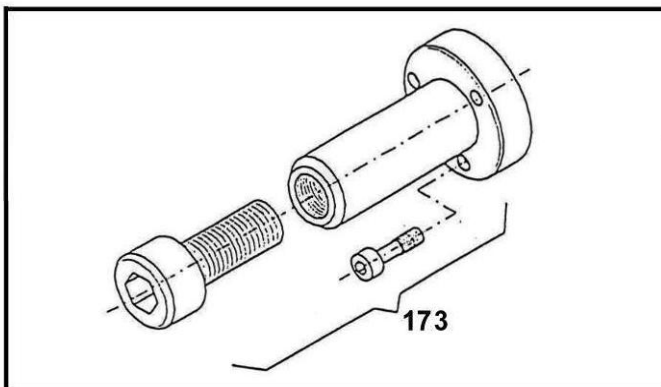
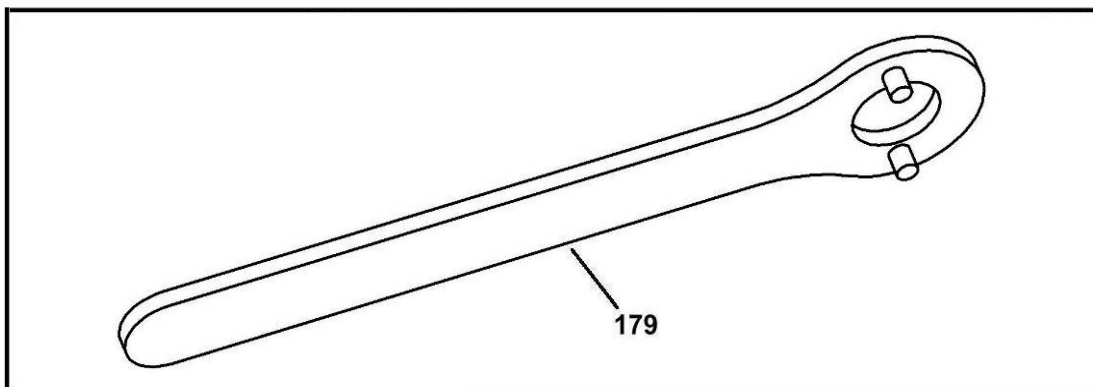
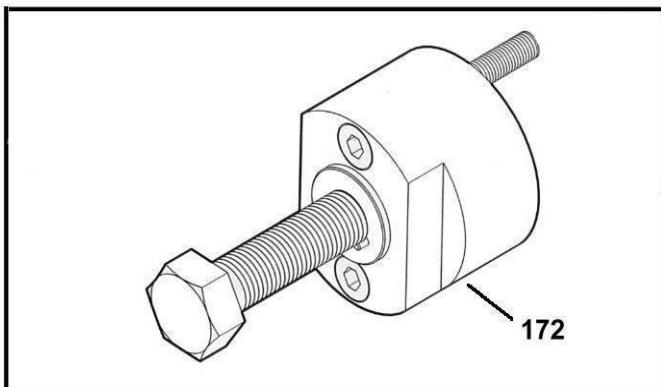

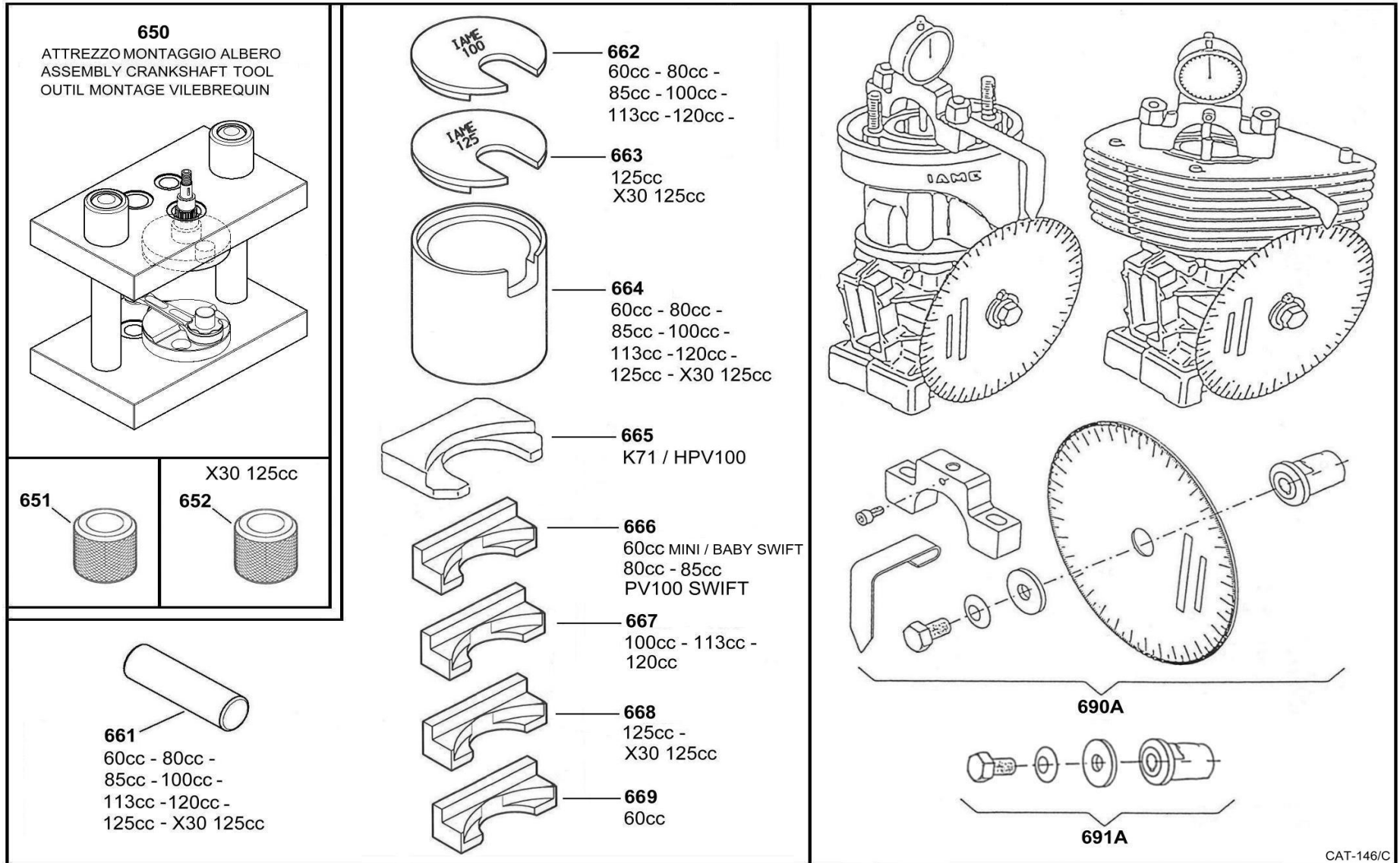

CAT-156

MONTAGGIO E SMONTAGGIO ALBERO - GRUPPO CONTROLLO FASE CRANKSHAFT ASSEMBLING & DISASSEMBLING - TIMING CONTROL GROUP MONTAGE & DEMONTAGE VILEBREQUIN - GROUPE CONTROL DISTRIBUTION



PARILLA PV100 - 100cc

GRUPPO AVVIATORE - STARTER GROUP - GROUPE DEMARREUR

Fig.	Code	 <i>Descrizione</i>	Dim.	 <i>Description</i>	 <i>Description</i>	PV 100			
						MAXI '04-VO	SWIFT '04-VO	SWIFT '05-VO	SWIFT '06-VO
155A	B-35883-B	AVVIATORE completo		STARTER group	DEMARREUR complet	X	X	X	X
156	B-35897	BUSSOLA esagonale	17mm	Hexagonal BUSH	DOUILLE hexagonale	X	X	X	X
156B	B-35886	INSERTO avviatore		Starter INSERT	INSERT demarreur	X	X	X	X
157	00004	VITE senza testa	M6	SCREW without head	VIS sans tête	X	X	X	X
158	10158	CHIAVE fissaggio inserto	3mm	Insert KEY fixing	CLE fixage insert	X	X	X	X
159A	B-35886-C	KIT inserto avviatore		KIT starter insert	KIT insert demarreur	X	X	X	X
160	B-35884	BATTERIA	12Volt 24 Ah	BATTERY	BATTERIE	X	X	X	X

AVVIATORE ELETTRICO-ELECTRIC STARTER-DEMARREUR ELECTRIQUE

BATTERIA-BATTERY-BATTERIE

