

Ballast Compatible LED T8

**Note:** Please read this instruction manual to fully understand and safely install this product. Contractor Source LED fixtures are to be wired and installed in accordance with the national electrical code and all applicable local codes. **This product must be installed by a qualified personal familiar with the construction and operation of this product.**

DIMENSION DIAGRAM

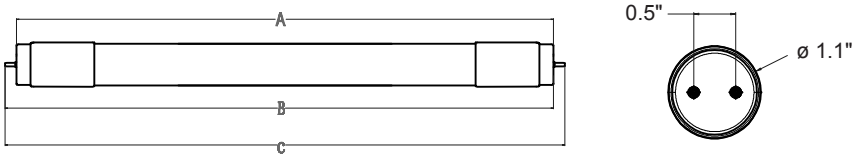

Maximum overall length(in)	4FT
A	47.17
B	47.44
C	47.75
Weight(lb)	0.66

OPERATION AND MAINTENANCE TIPS

The Plug and play LED Tube is compatible with most of Instant start ballasts. Store and use the lamps as same as standard fluorescent lamps. Operates on electronic ballasts only. Please refer to [www.csled.com](http://www.csled.com) for compatible ballast list

- Lamps should be kept free from contamination.
- Switch off mains supply before installing/removing lamp.
- Good condition of the lamp-holder contacts is important to ensure proper operation of lamp.
- For direct wire please check the provided installation instructions.
- Use in fully enclosed fixtures may affect life performance.

DIRECT REPLACEMENT FOR SPECIFIC FLUORESCENT LAMPS

Electronic ballast fluorescent lamps
32W/48T8

Ballast Compatible LED T8

WARNINGS

- Risk Of Electrical Shock! Persons installing this product should have knowledge of electrical systems. DO NOT attempt to install this product. Contact a licensed electrician for installation
- Not for use with Dimmers
- If lamp or fixture exhibits undesirable operation (BUZZING, FLICKERING) immediately turn off power and remove lamp from luminaire and contact manufacturer
- Not intended for use in damp or wet locations
- Not Intended for use in emergency fixtures

INSTALLATION INSTRUCTIONS

1. Turn Off power to the luminaire at the circuit breaker before removing the lamp
2. Remove fluorescent lamps from the luminaire
3. Ensure the ballast is marked Electronic ballast and is listed on the compatible ballast list
4. Install LED replacement tubes
5. Turn on power to the luminaire at the circuit breaker and check for proper operation

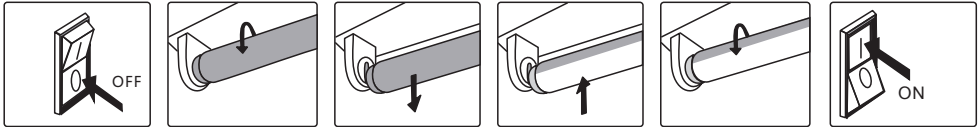

WIRING DIAGRAM

