

4

3

2

1

STEP 1

1. INSTALL UNDER RING INTO TANK
2. ALIGN BOLT PATTERNS
3. USING TWO (2) 1" FLAT HEAD CAP SCREWS, THROUGH THE TOP OF THE TANK, TIGHTEN SCREWS TO SECURE UNDER RING

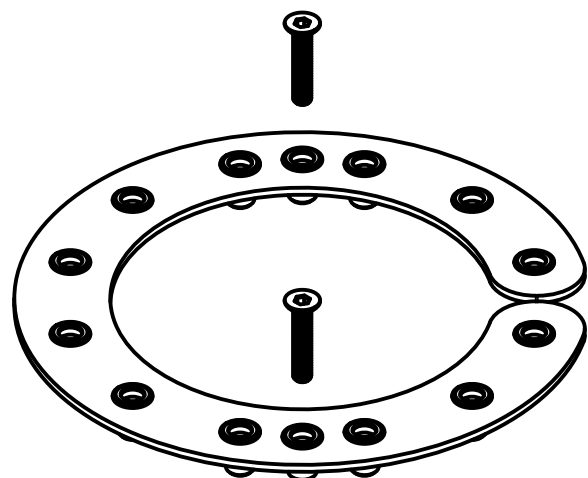

STEP 2:

1. PLACE BOYD WELDING GASKET, THEN ADAPTER FLANGE ON TOP OF TANK
2. ALIGN SO THAT ALL 12 HOLES IN TANK AND GASKET MATCH AND THAT THE COUNTER BORED HOLES ARE ALIGNED WITH THE GASKET.
3. USING TWELVE (12) 1.25" LONG SOCKET CAP SCREWS SECURE ADAPTER RING TO THE TANK
4. MAKE SURE ALL SCREWS HAVE STARTED BEFORE THEY ARE TIGHTENED DOWN

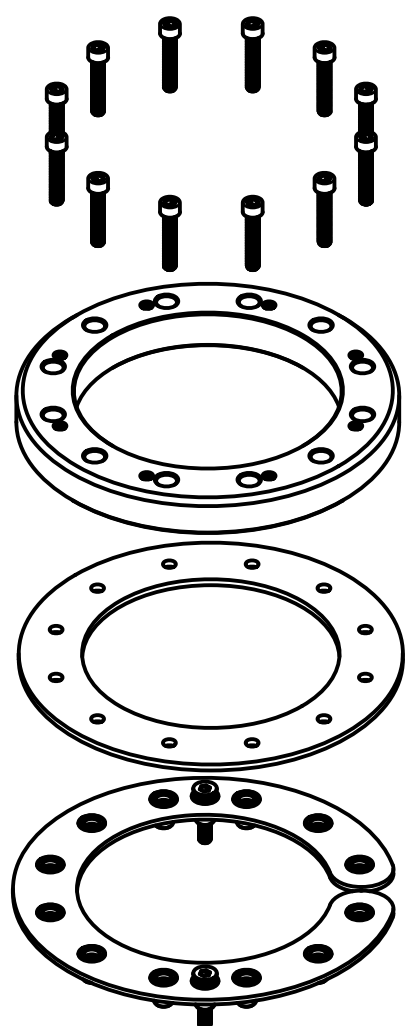

STEP 3:

1. USING THE HYFUEL FOAM GASKET SUPPLIED IN THE HYPERFUEL KIT, PLACE GASKET AND ASSEMBLED PUMP ON TOP OF ADAPTER FLANGE, ALIGNING PATTERNS
2. USING EIGHT (8) 1.25" SOCKET CAP SCREWS, PROVIDED FROM BOYD WELDING, INSTALL PUMP
3. TIGHTEN SCREWS A LITTLE AT A TIME USING A CRISS CROSS PATTERN UNTIL TIGHT

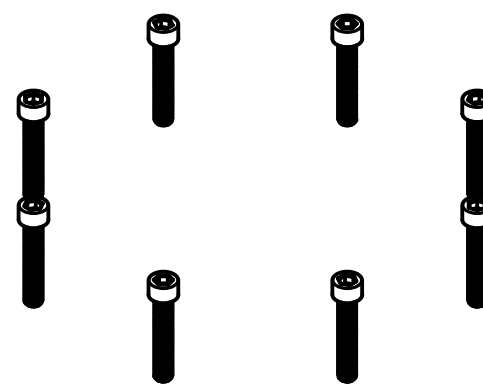

FOAM GASKET AND PUMP

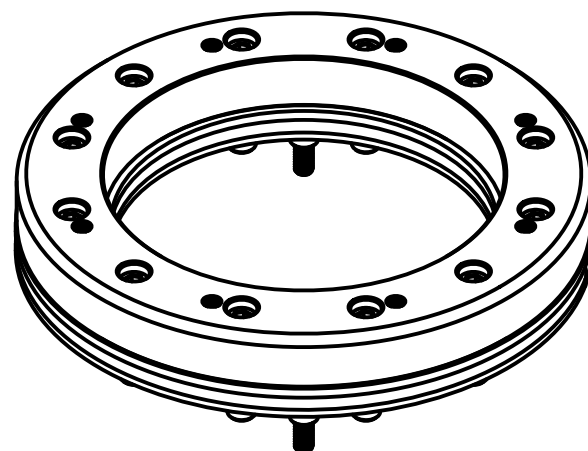

IMPORTANT INFORMATION:

- **READ ALL INSTRUCTIONS FIRST****
- WHEN ASSEMBLING YOUR HYPERFUEL PUMP MAKE SURE THAT YOU HAVE ADDED THE NEEDED HEIGHT TO THE PUMP TO MAKE UP FOR THE ADAPTER FLANGE.
 - BE SURE TO ONLY USE THE HARDWARE SUPPLIED BY BOYD WELDING TO SECURE THE FLANGE AND PUMP
 - * NOT DOING SO MAY DAMAGE THE PRODUCT.*

PARTS INCLUDED

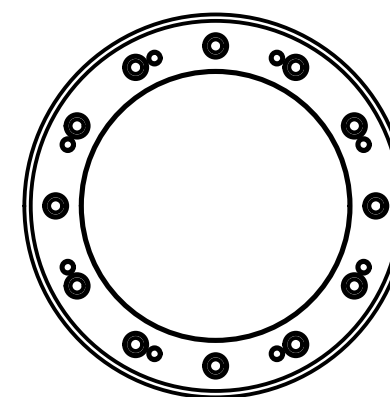

1 X ADAPTER FLANGE

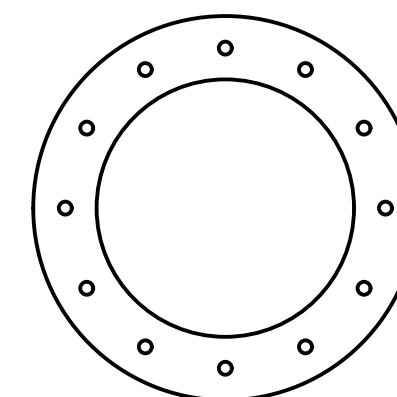

1 X GASKET

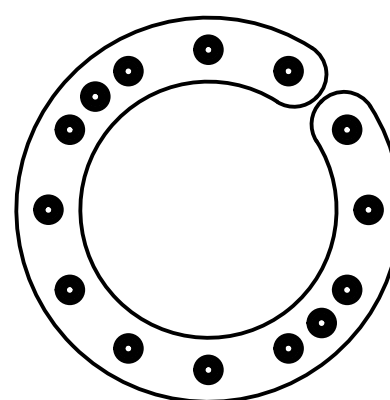

1 X UNDER RING



20 X 1.25" SOCKET CAP SCREWS



2 X 1" FLAT HEAD CAP SCREWS



PROJECT
B.W. CUSTOM TANK
 TITLE
44040
BOYD WELDING 12 BOLT TO HYFUEL ADAPTER

APPROVED	SIZE	BW INT. REV.	DWG NO	CUSTOMER REV
CHECKED	C	000		
DRAWN Dustin Loveland 8/12/2020	SCALE 1:2	WEIGHT	SHEET 1/1	

4

3

2

1