

 **Vacmaster®**

**10L | 620W**  
**CDM0610P**

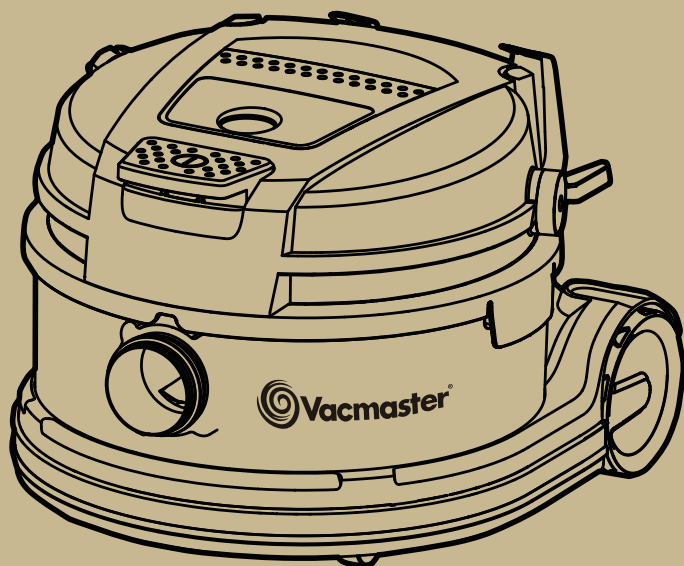

Original Instructions









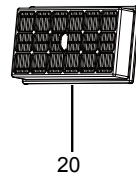
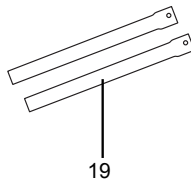
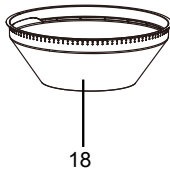
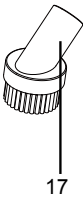
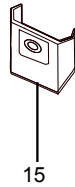
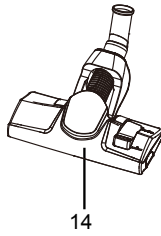
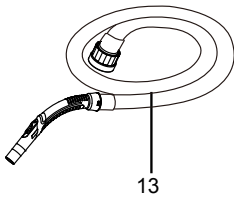
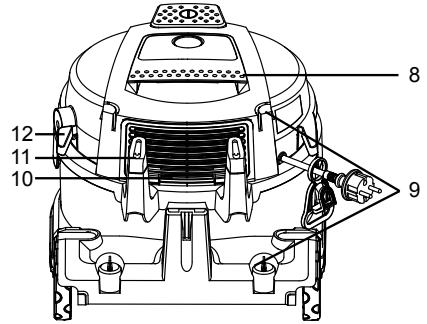
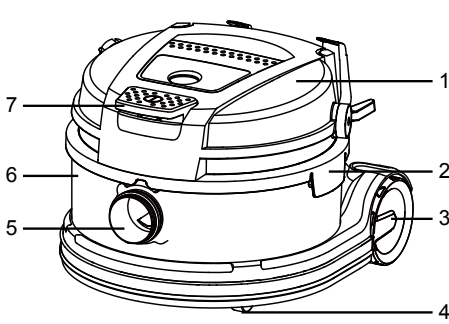



# TABLE OF CONTENTS

SECTION	PAGE
Symbols.....	6
Safety Information .....	7
Unpacking and Checking Carton Contents.....	9
Assembly.....	9
Operation.....	10
Maintenance.....	11
Troubleshooting.....	12
Technical Data.....	13
Recycling and Disposal.....	13
Plug/Fuse Replacement (UK & Ireland Only).....	14

Thank you for purchasing this Vacmaster® vacuum cleaner. Feel confident that with Vacmaster® you are obtaining a high-quality product that is engineered for optimal performance. This vacuum cleaner is suitable for use with dry materials.

**FOR YOUR SAFETY: CAREFULLY READ AND UNDERSTAND ALL INSTRUCTIONS.**

## SYMBOLS

	Caution
	Read instruction manual.
	Appliance in which protection against electric shock does not rely on basic insulation only but in which additional safety precautions are provided, such as double insulation or reinforced insulation, there being no provision for protective earthing or reliance upon installation conditions.

## SAFETY INFORMATION

### **READ AND UNDERSTAND ALL INSTRUCTIONS BEFORE USING THIS VACUUM CLEANER.**

When using the equipment, a few safety precautions must be observed to avoid injuries and damage. Please read the complete operating manual with due care. Keep this manual in a safe place so that the information is always available. If you give the equipment to any other person, give them these operating instructions as well. We cannot accept any liability for damage or accidents which arise due to a failure to follow these instructions and the safety information.

- This machine is for dry and indoor use only.
- Never leave the appliance switched on unattended, if you leave the work area, switch the appliance off or unplug it from the power supply.
- Do not vacuum or use this vacuum cleaner near flammable liquids, gases or explosive vapours like gasoline or other fuels, lighter fluids, cleaners, oil-based paints, natural gas, hydrogen, or explosive dusts like coal dust, magnesium dust, grain dust or gun powder, or toxic materials. Sparks inside the motor can ignite flammable vapours or dust. Do not vacuum toxic materials.
- This vacuum cleaner is not suitable for the vacuuming of asbestos or asbestos dust.
- Do not vacuum anything that is burning or smoking, such as cigarettes, matches, or hot ashes.
- Do not use the vacuum cleaner in a wet environment or to vacuum wet materials.
- Do not use steam cleaners, pressure washers or immerse in water to clean the vacuum cleaner.
- Ensure the hose and connections are always pointed away from the users face, hair, ears and eyes during operation and never direct the nozzle towards persons or animals.
- Clear the working area of any items or possessions that you do not wish to be vacuumed before operation.

- Keep cord away from heated surfaces.
- Do not expose to rain. Store indoors.
- Do not unplug by pulling on the cord. To unplug, grasp the plug, not the cord.
- Do not use with damaged cord, plug or other parts.
- Do not pull or carry by cord, use cord as handle, close a door on cord, or pull cord around sharp edges or corners.
- Do not handle the plug or vacuum cleaner with wet hands.
- Do not use or store near hazardous materials.
- Do not use this vacuum cleaner with a torn filter or without the filter installed.
- Do not allow to be used as a toy. Close attention is necessary when used by or near children.
- Do not leave vacuum cleaner unattended when plugged in. Unplug from power supply when not in use and before carrying out maintenance.
- Turn off vacuum cleaner before unplugging.
- Do not cover the ventilation openings. Do not vacuum with any ventilation openings blocked; keep free of dust, lint, hair or anything that may reduce air flow.
- Keep hair, loose clothing, fingers, all parts of body away from openings and moving parts.
- If the supply cord is damaged, it must be replaced by the manufacturer, a qualified service agent or similarly qualified persons in order to avoid a hazard.
- This appliance is not intended for use by persons (including children) with reduced physical, sensory or mental capabilities, or lack of experience and knowledge, unless they have been given supervision or instruction concerning use of the appliance by a person responsible for their safety.
- Children should be supervised to ensure that they do not play with the appliance.
- For additional protection: It is recommended that this vacuum cleaner can be used in conjunction with residual current device (RCD) with a rated residual current of 30mA or less.
- Always unplug the appliance after use and before cleaning or changing the filters or accessories.



## UNPACKING AND CHECKING CARTON CONTENTS

1	Power Head	9	Accessory Storage	17	Round Dust Brush
2	Latch	10	Exhaust Filter Door	18	Pre-filter (pre-installed)
3	Rear Wheel	11	Hose Storage	19	Extension Wand (x2)
4	Front Caster	12	Power Cable Hook	20	Exhaust Filter (pre-installed)
5	Suction Port	13	Suction Hose	21	Detachable Power Cable
6	Container	14	Dual Mode Floor Nozzle	22	Cable Restraint Hook
7	On/Off Switch	15	Dust Bag (x5)	23	Instruction Manual
8	Carry Handle	16	Crevice Tool		

## ASSEMBLY

**NOTE:** A Phillips screwdriver is required. 

1. Remove all the contents from inside of the vacuum cleaner container.
2. Your vacuum cleaner comes ready for dry vacuum cleaning with the pre-filter pre-installed. If the pre-filter is not installed, refer to page 10.
3. Optionally, for improved dust filtration, remove the pre-installed pre-filter, and then fully fit the dust bag flange onto the inlet stub (Fig. 1). Place the pre-filter back into the container. The vacuum cleaner can be used with or without dust bags.
4. Secure the power head back on the container, using the 2 push-to-lock side latches. Insert the locking end of the hose into the suction port of the container and turn clockwise to lock into place (Fig. 2).
5. Choose the desired accessories and/or extension wands and push fit onto the hose nozzle (Fig. 3).
6. Attach the detachable power cable to the connection lead using the cable restraint hook (Fig. 4).

# OPERATION

## 1. Switching On/Off

Connect the mains plug to a suitable power outlet.

To turn the vacuum cleaner ON, press the power switch once.

To turn the vacuum cleaner OFF, press the power switch again.

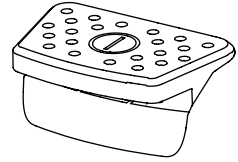

## 2. Dry Vacuum Operation

**WARNING:** ENSURE YOU READ, UNDERSTAND AND APPLY SECTION ENTITLED 'SAFETY INFORMATION'.

**WARNING:** BEFORE INSTALLING, REMOVING OR CLEANING THE VACUUM CLEANER FILTER, ENSURE THAT THE POWER CORD IS UNPLUGGED AND SWITCHED OFF.

- 1) This vacuum cleaner can be used with or without dust bags. To use a dust bag, remove the pre-installed pre-filter and fully fit the dust bag flange onto the inlet stub.
- 2) Place the pre-filter back into the container. Ensure the notch of the pre-filter is aligned with the inlet stub. The pre-filter is designed to cover the full circumference of the container (Fig. 5).
- 3) Secure the locking end of the hose into the vacuum suction port.
- 4) Push the desired accessories onto the hose nozzle. The air flow regulation on the suction hose allows you to change vacuum cleaner suction. For best cleaning results, fully close the air flow regulation (Fig. 6).
- 5) Verify that the container latches are secured. Plug the power cord into a power outlet.
- 6) Turn on the motor by pressing the On/Off switch.
- 7) Once you have completed vacuuming, press the On/Off switch again and unplug the power cord from the power.

**IMPORTANT:** Check the filter regularly for optimal performance. An old or blocked filter will reduce suction performance.

# MAINTENANCE

 **WARNING:** REMOVE THE POWER CORD FROM THE POWER SUPPLY BEFORE CARRYING OUT ANY MAINTENANCE.

- 1) Keep all safety devices, air vents and the motor housing free of dirt and dust. Use a soft, dry brush to clean the equipment regularly.
- 2) Clear all dirt or debris from the container after each use. Allow to dry before replacing the power head. Do not use cleaning agents or solvents; these may damage the appliance.
- 3) Check the hose, attachments, and power cord to verify that they have not been damaged or any debris is trapped and blocking airflow.

## 1. Cleaning the Pre-filter

- 1) Remove the pre-filter and clean by gently tapping or brushing dirt off. For optimal performance it is recommended to replace the old filter with a new filter regularly.
- 2) If necessary, use a mild soap and water solution to wash pre-filter and rinse with clean water. Allow the filters to air dry before re-installing.

## 2. Cleaning the Air Inlet Filter

- 1) Remove the air inlet filter by releasing the holding pin. Firmly press the two open ends of the holding pin together and remove from the securing tabs (Fig. 7)
- 2) Remove the air inlet filter and use a mild soap and water solution to wash air inlet filter and rinse with clean water. Allow the filter to air dry before re-installing.

## 3. Cleaning & Replacing Exhaust Filter

- 1) Unlock the exhaust filter door by lifting both of locking tabs upwards to release. Pull the door out (Fig. 8).
- 2) Remove the exhaust filter from the vacuum cleaner and clean by gently tapping or brushing off dirt. For optimal performance it is recommended to replace the old filter with a new filter regularly (Fig. 9).
- 3) Install the cleaned or new filter. Then insert the filter door tabs into the upper slots and lock the filter door into place.

## 4. Storage

- 1) Ensure the power cable hook is fully rotated into the storage position. Wrap the power cable loosely around the power cable hook (Fig. 10).
- 2) To release the power cable, rotate the power cable hook towards the front of the vacuum cleaner.
- 3) Store the suction hose around the hose storage (Fig. 11).

# TROUBLESHOOTING



**WARNING: TO REDUCE THE RISK OF ELECTRIC SHOCK-UNPLUG BEFORE TROUBLESHOOTING.**

## Cleaning Performance

Vacmaster vacuum cleaners are tested for endurance. If your motor is operating, then the most likely cause for a loss in suction is a blockage or an opening in the vacuum.

To maintain a high cleaning performance from your machine, it is important to replace or clean pre-filters as necessary. Replace full dust bags to prevent performance drops. A performance drop with clean filters can only be caused by a blockage in the tools or the hose.

PROBLEM	POSSIBLE CAUSE	SOLUTION
The appliance does not work.	No power.	Check the power supply and fuse.
	Functional fault in the power cord, switch, or motor.	Have the damaged part checked by qualified personnel or contact the after sales helpline.
Dust is escaping from the motor cover.	The pre-filter is missing or damaged.	Ensure the pre-filter is correctly installed or replace if damaged.
	The air inlet filter is missing or damaged.	Ensure the air inlet filter is correctly installed or replace if damaged.
Low suction power and high operating noise / vibrations.	Dust bag is full.	Replace the dust bag.
	Suction nozzle, hose, or tank inlet is blocked.	Check the suction nozzle, hose, and tank inlet for obstructions.
	The pre-filter or air inlet filter needs to be cleaned.	Check and clean the pre-filter and air inlet filter. Replace if damaged.

## TECHNICAL DATA

Model Number	CDM0610P
Motor	220-240V~50Hz
Power Input	620W
Tank Volume	10L
Net Weight	11kg
Energy Efficiency Class	A
Annual Energy Consumption in kW•h per Annum	24.8 kW•h /annum
Cleaning Performance on Carpet	B
Cleaning Performance on Hard Floor	A
Dust Re-mission	A

### Noise/Vibration Information

Noise emission values determined according to EN 60335-2-69.

Typically, the A-weighted sound pressure level of the power tool is 58 dB (A). Uncertainty K = 3 dB

Total vibration values  $a_h$  (triax vector sum) and uncertainty K determined according to EN 60335-2-69:  $a_h < 2.5 \text{ m/s}^2$ ,  $K = 1.5 \text{ m/s}^2$ .

## RECYCLING AND DISPOSAL



This marking indicates that this product should not be disposed with other household wastes throughout the EU. The machine must be delivered in rigid packaging to avoid damage during transportation. The packaging and the machine itself are manufactured from recyclable materials and should be disposed of accordingly.

# PLUG/FUSE REPLACEMENT (UK & IRELAND ONLY)

This product is fitted with a non-rewirable plug. If the plug has to be changed, refer to the picture below.

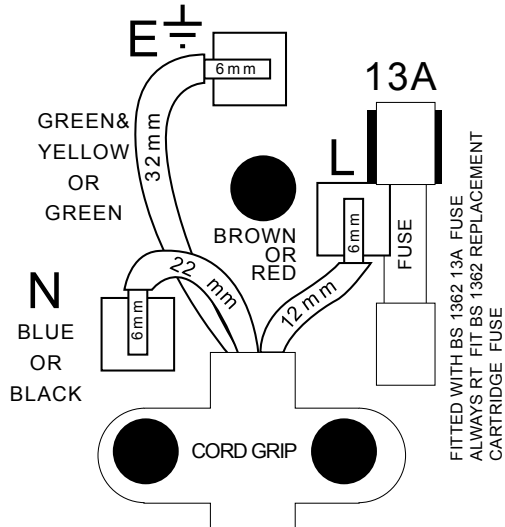



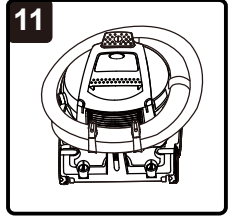
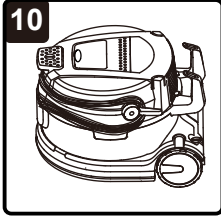
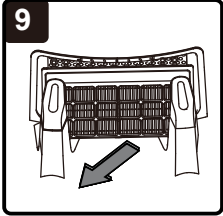
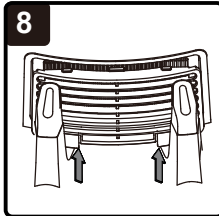
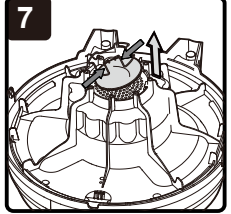
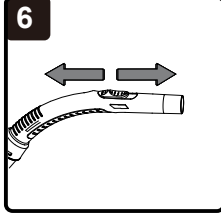
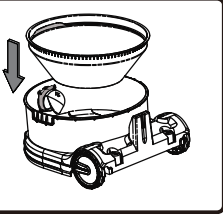
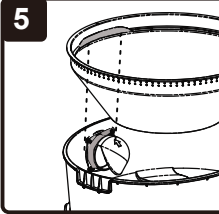
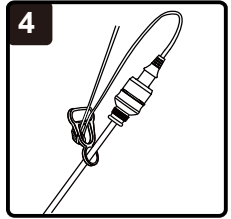
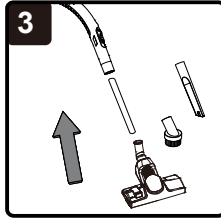
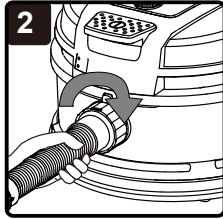
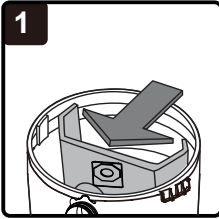









**CDM0610P**  
**Suzhou Cleva Electric Appliance Co., Ltd.**  
**No.8 Ting Rong Street**  
**Suzhou Industrial Park, Suzhou**  
**Jiangsu Province, China**  
**[www.cleva-europe.com](http://www.cleva-europe.com)**  
**Made in P.R.C**