

**CLEVA**

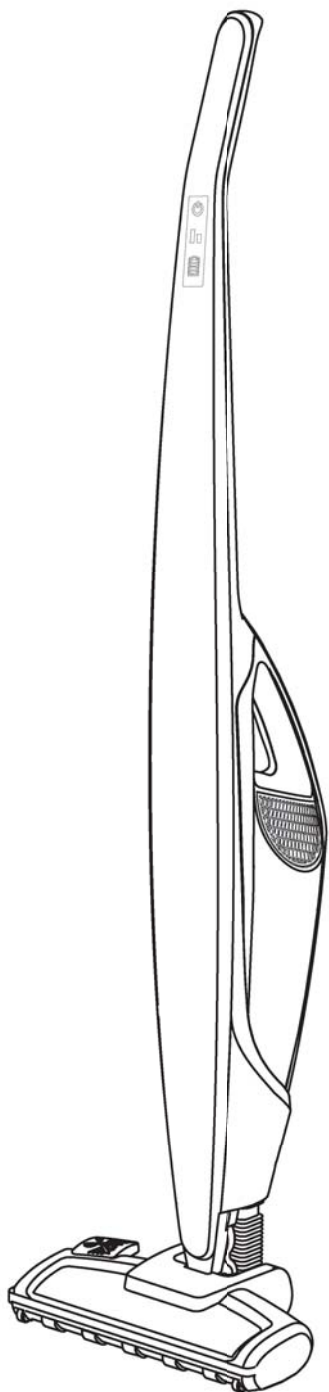

**JOEY™ 21.6V Lithium**

Cordless Vacuum Cleaner

Slimline Design and 2-in-1

Model Number - **VSA2110UK**

Thank you for choosing our JOEY™ cordless vacuum cleaner. This is a cordless vacuum cleaner intended for indoor use on light, dry household dust and debris.

## CONTENTS

Before Using Your New Vacuum Cleaner.....	1
Getting Help.....	1
Safety Information.....	2
Guarantee Information.....	4
Parts and Features.....	5
Assembly Instructions.....	6
Charging Instructions.....	7
Operating Instructions & Tips .....	8
Maintenance and Care.....	11
Troubleshooting.....	15
Technical Data .....	17
Disposal and Recycling .....	17

## BEFORE USING YOUR VACUUM CLEANER

- Please read this instruction manual. It will help you assemble and operate your new vacuum cleaner in the safest and most effective way.
- Keep this instruction book and your sales receipt in a safe place for future reference.

## GETTING HELP

For more information on this product, please visit our website.

**[cleva-uk.com](http://cleva-uk.com)**

## SAFETY INFORMATION

- This appliance can be used by children aged from 8 years and above and persons with reduced physical, sensory or mental capabilities or lack of experience and knowledge if they have been given supervision or instruction concerning use of the appliance in a safe way and understand the hazards involved. Children must not play with the appliance. Cleaning and user maintenance must not be made by children without supervision.
- This appliance should only be used for normal vacuuming in a domestic environment.
- Make sure the vacuum cleaner is stored in a dry place.
- Unplug the vacuum cleaner from the charger before cleaning or maintenance.
- Children should be supervised to ensure that they do not play with the appliance.
- Packaging material, e.g. plastic bags should not be accessible to children to avoid suffocation.
- Check that your supply voltage is the same as that stated on the rating plate on the charging adaptor.
- Each vacuum cleaner is designed for a specific charging voltage, use only the original charging adaptor supplied with this vacuum cleaner.
- While there is no shock hazard from electrical terminals located on the vacuum, a burn could result from metal objects being inserted into the terminal areas. Vacuum cleaner terminals should always be kept free of objects.
- Leaks from battery cells can occur under extreme usage or temperature conditions. If the liquid gets on skin, wash quickly with water. If liquid gets into the eyes, flush them immediately with clean water for a minimum of 10 minutes. Seek medical attention.
- Do not mutilate or incinerate batteries as they will explode at high temperatures.

## PROPER USE

- The appliance must only be stored and charged indoors.
- Do not leave the vacuum cleaner in direct sunlight.
- Avoid exposing the vacuum cleaner to strong heat.
- Do not expose the appliance to temperatures below 0 °C or above 40 °C.
- Keep the vacuum cleaner away from your head when using nozzles and tubes.
- Do not use a damaged charger or cable.
- When disconnecting the charging cable from the mains, pull the plug itself to remove it; do not pull on the power cord.
- Do not pull the charging cable over sharp edges or allow it to become trapped.
- If a fault is detected, switch off the appliance and disconnect it from the charging cable and the mains.
- For safety reasons, only authorised or experienced service personnel are permitted to carry out repairs.
- Do not try to touch the brush roll while the cleaner is switched on and the brush roll is turning.
- Switch off the appliance when it is not in use.
- The battery cells within must not be dismantled, short circuited, or placed against a metal surface.

## NEVER USE THIS VACUUM CLEANER

- In wet areas.
- On building rubble.
- Close to flammable gases, etc.
- When the product shows visible signs of damage.
- On sharp objects or fluids.
- On hot or cold cinders, lighted cigarette butts, etc.
- On fine dust, for instance from plaster, concrete, flour, hot or cold ashes.
- Without its filters.

Using the vacuum cleaner in the above circumstances may cause serious personal injury or damage to the product. Such injury or damage is not covered by the warranty or by CLEVA.

## GUARANTEE INFORMATION

Cleva take pride in engineering high quality, durable products.

This product is guaranteed against defects in workmanship and materials for two years from the date of purchase when it is assembled, operated and maintained according to all supplied instructions.

- This guarantee is void if this product is used for anything other than private household purposes.
- This guarantee does not apply to defects due to direct or indirect abuse, negligence, misuse, accidental damage, repairs or alterations or lack of maintenance.
- This guarantee provides benefits which are additional to your statutory rights as a consumer and does not affect your legal rights.

For more detailed information about your guarantee, please visit **[cleva-uk.com](http://cleva-uk.com)**

## PARTS AND FEATURES

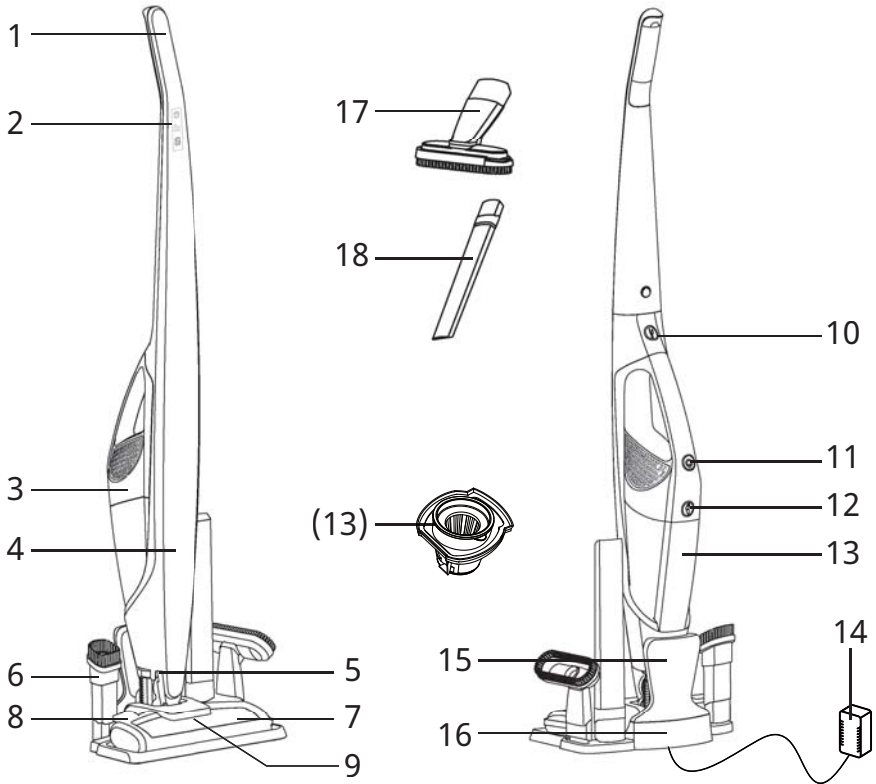

- |    |  |    |                                      |
|----|--|----|--------------------------------------|
| 1  | Handle                                 | 11 | Handheld Vacuum Cleaner Power Switch |
| 2  | Touch control panel                    | 12 | Dust Bin Release Button              |
| 3  | Handheld Vacuum Cleaner                | 13 | Dust Bin (Filter Inside)             |
| 4  | Main Body                              | 14 | Charging Adapter                     |
| 5  | Release Button                         | 15 | Vacuum Cleaner Support               |
| 6  | Combination Tool                       | 16 | Charger Base                         |
| 7  | Motorised Brush Head                   | 17 | Upholstery Tool                      |
| 8  | Brush Cleaning Button                  | 18 | Long crevice Tool                    |
| 9  | LED Lights                             |    |                                      |
| 10 | Handheld Vacuum Cleaner Release Button |    |                                      |

## ASSEMBLY INSTRUCTIONS

- Fit the vacuum cleaner body into the motorised brush head and lock into place (Fig.1).
- Insert the handle into the top of the main body as illustrated and lock into place (Fig.2).
- Insert the handheld vacuum cleaner into the main body as shown and lock into place. Ensure that the dust bin is secure in place (Fig.3).

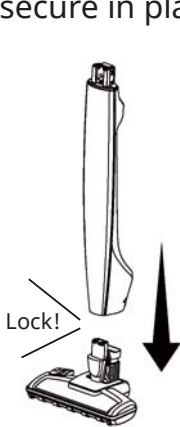

Fig.1

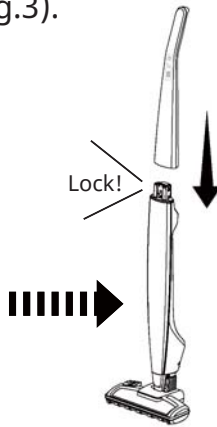

Fig.2

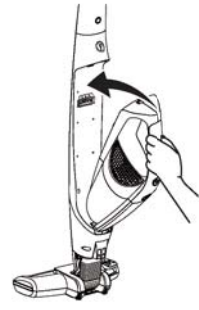

Fig.3

- Insert vacuum cleaner support and brush tool attachment into charger base and lock into place (Fig.4).
- Insert the charging adapter plug into the charging port on the bottom of the charger base and secure the cord (Fig.5).
- Plug the adapter into a wall socket (Fig.6).

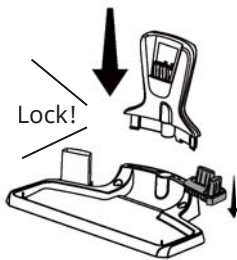

Fig.4

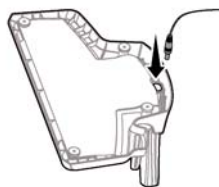

Fig.5

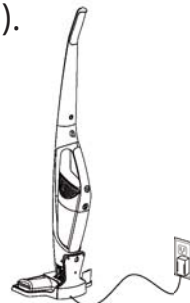

Fig.6

## CHARGING INSTRUCTIONS

Please switch off the unit before placing it on the charger.

- Plug the charging adapter into an outlet. Insert the vacuum cleaner onto the charger base as shown (Fig.7).
- Make sure the vacuum cleaner is fully charged before using for the first time. The vacuum cleaner may take up to 5 hours to charge completely if fully discharged.
- The battery charge indicator will flash continuously until vacuum is fully charged. (Fig.8).

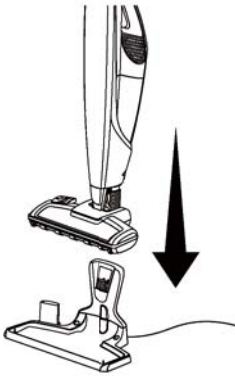

Fig.7

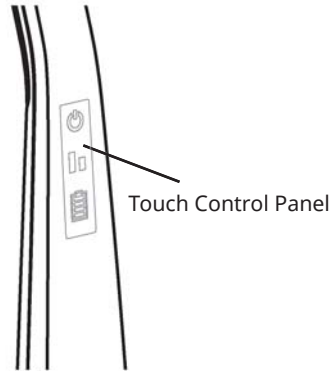

Fig.8

Battery Charge Indicator:



- When the vacuum has reached full charge (100%), the battery charge indicator will remain lit with four (4) bars illuminated for 3 seconds then go to dormant mode with no illuminated lights showing. (Fig.9)

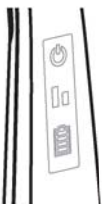

Fig.9



**NOTE: If the battery charging indicator does not illuminate when charging, ensure:**

- that the vacuum cleaner is seated properly on to the charger base.
- that the charging adaptor is plugged into the wall socket properly.
- that the wall socket is switched on.
- that the adaptor power plug is connected properly on the charger base.

**NOTE:** For improved battery performance, always keep the vacuum cleaner on the charger base while not in use.

## OPERATING INSTRUCTIONS & TIPS

**!** **CAUTION!** Moving parts! To reduce the risk of personal injury, DO NOT touch the brush roll when the vacuum cleaner is on. Contacting the brush roll while it is rotating can cut, bruise or cause other injuries. Always turn off before servicing. Use caution when operating near children (Fig.10).



Fig.10

## USING YOUR VACUUM CLEANER

### CONTROL PANEL

The control panel is located on the top of the handle, which includes:



Power Icon=On/Off



Speed Indicator=Low/High



Battery Indicator = Electric Capacity

**⚠ WARNING - Do not operate vacuum cleaner without filter in place.**

- Before vacuuming, check that the brush wheels and brush roll are clear of any sharp objects to avoid scratching floors.
- Use low speed for surface cleaning of bare floors or low pile rugs and carpets or when increased runtime is needed.
- Use high speed for cleaning of plush rugs and carpets or when additional cleaning power is required.

**Vacuum Operation:**

- Touch the power icon to illuminate control panel and initiate power. (Fig.11)

NOTE: If no further action is taken in 5 seconds, panel returns to previous state.

- Start the vacuum cleaner by touching the power icon once more. The speed bars will illuminate allowing for speed control. (Fig.12)

- To change power setting, touch the speed indicator icon for desired power setting (Low or High). (Fig.13)

NOTE: This vacuum cleaner is equipped with a memory function that allows the vacuum to start in the last power setting.

- After vacuuming, turn the unit off by touching the power icon for 2 seconds. (Fig.14)

NOTE: Holding for less than 2 seconds causes no action.

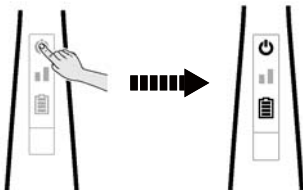

Fig.11

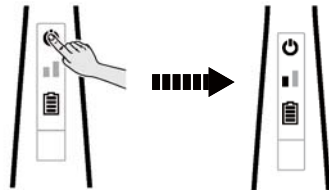

Fig.12

**NOTE: When the vacuum is low on battery power, the control panel or the battery icon will flash. The flashing will continue until the unit is placed on the charging station or is completely out of battery power.**

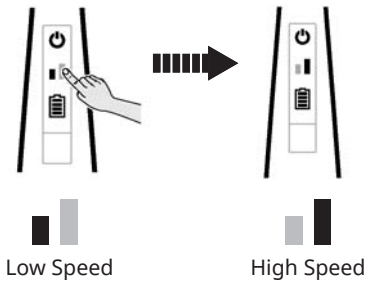

Fig.13

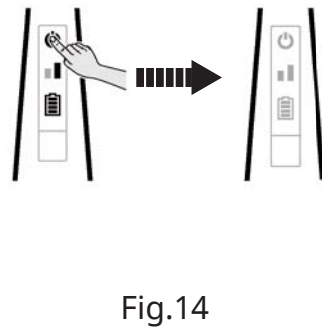

Fig.14

**CLEANING WITH THE HANDHELD VACUUM CLEANER**

- To remove the handheld vacuum cleaner, press the release button and detach from the main body (Fig.15).
- To turn on the handheld vacuum cleaner, press the power switch located on top of the handle (Fig.16).
- To clean difficult to reach areas, use the Combination Tool / Long Crevice Tool / Upholstery Brush by inserting end of tool into the handheld vacuum cleaner as shown (Fig.17).

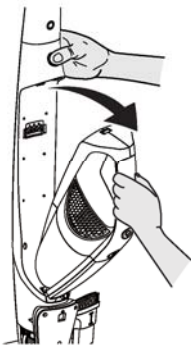

Fig.15

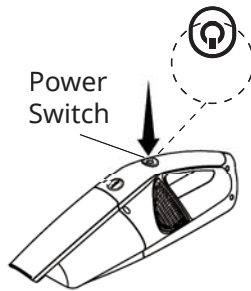

Fig.16

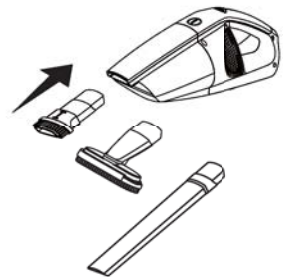

Fig.17

**NOTE:** When battery power is low, the battery charge indicator around the switch will flash.

To charge, place the handheld vacuum cleaner into the main body and place the whole unit onto the charger base

## MAINTENANCE AND CARE

### EMPTYING THE DUST BIN

For best performance, empty the dust bin after every use. Never operate the vacuum cleaner without the dust bin and filter in place.

- Remove the handheld vacuum cleaner from the main body by pressing the release button and detaching the handheld vacuum cleaner (Fig.18).
- Press the dust bin release button and separate the dust bin from the handheld vacuum cleaner body (Fig.19).
- Remove the filter basket from the dust bin. Empty the dust bin contents into a waste bin (Fig.20).



Fig.18

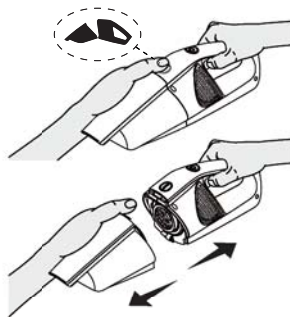

Fig.19

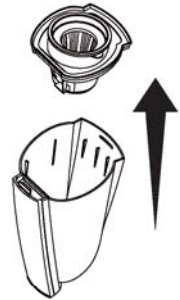

Fig.20

## CLEANING THE FILTER

The key to maximum performance is having a clean filter. Cleaning the filter frequently will help your vacuum cleaner operate at peak efficiency. A spare filter is provided with your vacuum cleaner to allow you to dry one filter properly while using the other.

- Remove the filter from the filter basket. With a soft brush, brush accumulated debris from the side screens of the filter basket and from the filter cloth (Fig.21).
- After repeated use, it may be necessary to wash the filter. First brush loose debris from the filter cloth, then hand wash in warm water. After washing, set it aside and allow it to air dry (Fig.22).
- Insert the spare clean, dry filter into the basket, fit the basket into the dust bin, and reconnect the dust bin to the handheld vacuum cleaner (Fig.23).



Fig.21



Fig.22

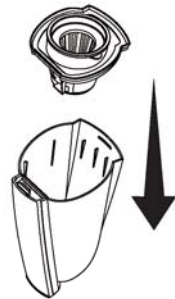

Fig.23

**IMPORTANT: The filter must be completely dry before reuse. A spare filter is provided with your vacuum cleaner to allow you to dry one filter properly while using the other.**

## CLEANING THE MOTORISED BRUSH ROLL

The brush roll may accumulate debris such as strings, hair and fibres. This type of debris can wrap around the brush and diminish its ability to clean effectively.

- The brush cleaning system will remove most debris accumulated on the brush roll. To clean the brush roll with the brush cleaning system step on the button as illustrated while the brush roll is spinning (Fig.24).



Fig.24

## REMOVING THE BRUSH ROLL FOR CLEANING



**WARNING: This Product contains a brushroll cleaning blade. Do not touch the blade during maintenance. Do not touch moving parts.**

- Ensure the vacuum cleaner is OFF. Turn unit over to access the brush roll, unlock the brush roll tab with flat head screwdriver or similar tool as illustrated (Fig.25).
- Lift the brush roll out of the housing. Clean off debris and anything wrapped around the brush (Fig.26).
- If the brush roll is damaged or needs replacing please contact our sales department to purchase the accessory.

- Align the end to the brush drive first, then insert the other end correctly. When installed correctly, the brush roll should rotate freely. Lock the brush in place by closing the tab as illustrated (Fig.27).



Fig.25

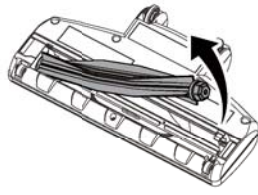

Fig.26

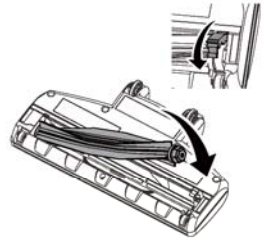

Fig.27

## REMOVING BLOCKAGES

- To clean out the hose, press the hose release tabs, as illustrated, and pull the motorised brush head away from the main body (Fig.28).
- Carefully remove any debris or blockage from the inside of the hose. Reattach the motorised brush head onto the main body (Fig.29).

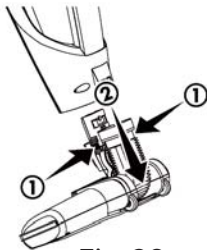

Fig.28

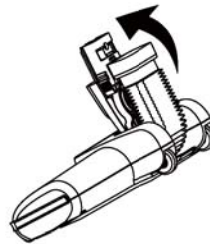

Fig.29

**NOTE: Do not use scissors or other sharp objects to remove a blockage from the hose as these may damage the hose.**

## TROUBLESHOOTING



**WARNING: Disconnect electrical supply before performing maintenance to the vacuum cleaner. Failure to do so could result in electrical shock or personal injury.**

<b>Problem</b>	<b>Possible Cause</b>	<b>Solution</b>
Vacuum cleaner will not turn on.	<ol style="list-style-type: none"> <li>1. Battery may be depleted.</li> <li>2. Wrong charger being used.</li> <li>3. Handheld vacuum cleaner is not installed properly.</li> </ol>	<ol style="list-style-type: none"> <li>1. Charge the battery as instructed on page 7.</li> <li>2. Be sure to use only the charger supplied with your product.</li> <li>3. Remove handheld vacuum cleaner and reattach ensuring that it is securely in place.</li> </ol>
Battery charge indicator does not illuminate.	<ol style="list-style-type: none"> <li>1. Battery may be depleted.</li> <li>2. Charging adapter is not plugged in.</li> <li>3. Debris accumulated on the metal charge contacts on the handheld vacuum cleaner, main body and charging adapter.</li> <li>4. The electrical outlet is switched off.</li> </ol>	<ol style="list-style-type: none"> <li>1. Charge the battery as instructed on page 7.</li> <li>2. Be sure the charging adapter is plugged in properly to the outlet and to the charging hole on the bottom of the charging adapter.</li> <li>3. Be sure no debris is accumulated on the metal charger contacts on the handheld vacuum cleaner, main body and charging adapter.</li> <li>4. Ensure that the outlet is supplying power to the charger.</li> </ol>



<p>Motorised brush not turning.</p>	<ol style="list-style-type: none"> <li>1. Brush roll is jammed.</li> <li>2. Brush roll is not installed well.</li> </ol>	<ol style="list-style-type: none"> <li>1. Remove any obstruction or clean the brushroll as necessary. Follow instructions on page 12.</li> <li>2. Remove brush roll and reinstall following instructions on page 12.</li> </ol>
<p>Vacuum cleaner not picking up or suction power is weak.</p>	<ol style="list-style-type: none"> <li>1. Dust bin is full.</li> <li>2. Filter needs cleaning.</li> <li>3. Filter needs to be replaced.</li> <li>4. Battery may be depleted.</li> <li>5. Dust bin is not installed well.</li> </ol>	<ol style="list-style-type: none"> <li>1. Empty dust bin.</li> <li>2. Follow filter cleaning instructions on page 11.</li> <li>3. Replace filter.</li> <li>4. Charge the battery as instructed on page 7.</li> <li>5. Check dust bin for correct installation and ensure it is snapped firmly in place.</li> </ol>
<p>Dust escapes from vacuum cleaner.</p>	<ol style="list-style-type: none"> <li>1. Filter is missing or installed incorrectly.</li> <li>2. Filter is damaged and needs to be replaced.</li> <li>3. Dust bin installed incorrectly.</li> </ol>	<ol style="list-style-type: none"> <li>1. Check filter for correct installation.</li> <li>2. Replace filter.</li> <li>3. Position dust bin correctly and snap firmly into place.</li> </ol>
<p>Vacuum cleaner turns off on its own.</p>	<ol style="list-style-type: none"> <li>1. Battery may be depleted.</li> <li>2. The motorised brush bar may be wrapped in hair.</li> </ol>	<ol style="list-style-type: none"> <li>1. Charge the battery as instructed on page 7.</li> <li>2. Thoroughly clean the brush bar and in the vacuum head. Replace the brush bar if necessary.</li> </ol>

## TECHNICAL DATA

Specification	Value
Battery power	21.6V $\equiv$ 2.0Ah
Battery pack	21.6V Li-ion
Running time	35 mins max
Speed settings	2 speeds
Dust capacity	0.5L
Weight	2.6 kg
Charger input	100-240V~ 50-60Hz
Charger output	25.6V $\equiv$ 500mA
Battery full charge time	5 hours

## DISPOSAL AND RECYCLING



Do not dispose with household waste



Recycle products and components according to local legal requirements.



[cleva-uk.com](http://cleva-uk.com)

Cleva UK Ltd  
G2 Stephenson  
Prestwick Park  
Prestwick  
Newcastle upon Tyne  
NE20 9SJ