

Face Shield

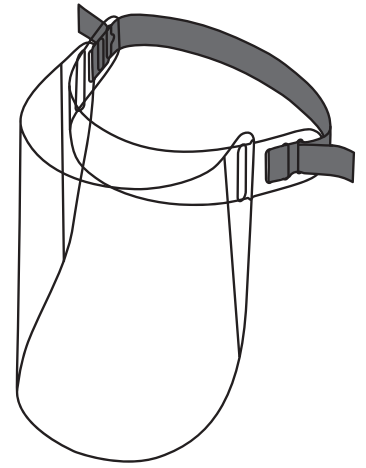

Cleaning products required:

Soap (e.g. dish soap) and disinfectant wipes (e.g. Accel wipes, Hydrogen Peroxide on clean cloth).

PPE required:

Exam Gloves (Vinyl or Nitrile)



If face shield appears damaged or compromised: DO NOT USE.

1 IMPORTANT - Clean both sides while Separated and Flat Before Assembly and First Use!

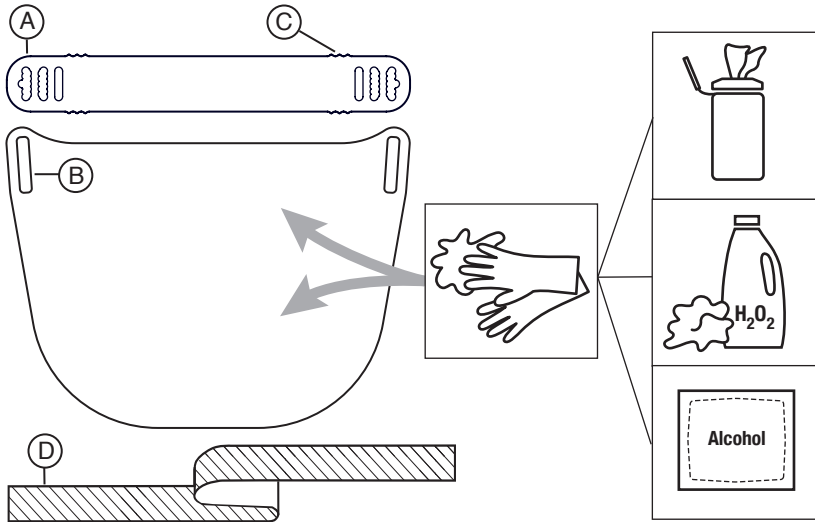

Cleaning & Disinfecting

1. Don new pair of exam gloves.
2. Using one disinfectant wipe at a time, and first squeezing excess disinfectant into a sink to prevent splash to face, thoroughly wipe the interior followed by the exterior of the facial protection.
3. Ensure all surfaces remain wet with disinfectant for at least 1 minute (or applicable disinfectant wipe contact time).
4. Equipment may be rinsed with tap water if visibility is compromised by residual disinfectant.
5. Allow to dry (air dry or use clean absorbent towel).
6. Remove gloves and perform hand hygiene.

2

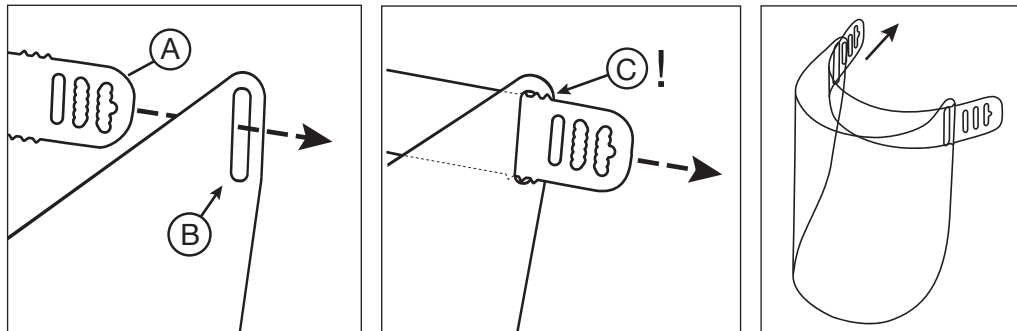

Insert Forehead Clip (A) into Visor slot (B). Pull until 'nubs' (C) click through. Repeat for opposite side.

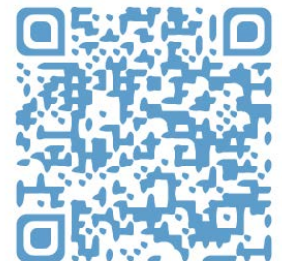

3

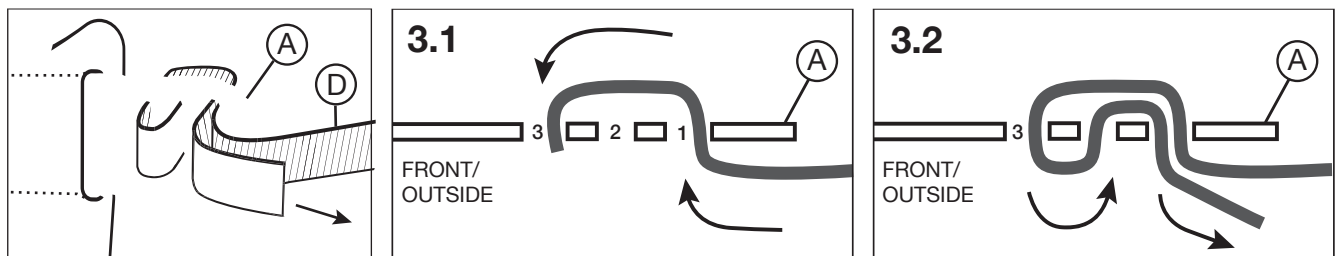

- 3.1** Thread Headband (D) into Forehead Clip (A). In through Slot 1, back out through Slot 3.
- 3.2** Continue in through Slot 2, then back out Slot 1. Repeat for opposite side. Tighten to fit.