

Installation Guide



S-CHASSIS MANTIS KIT

Fully Assembled view of the S-chassis kit is shown for the left side of the car

- 1- Control arm assembly
- 2- Tierod Assembly
- 3- Steering Knuckle
- 4- Caster plate

Bolt check regularly, take note of the orientation of all the components in this view

-Ackerman Adjustment see image for how to change the ackerman plates. The kit includes +2, 0 and -2 ackerman plates. This is the difference in angle measured at full lock. Example- with 0 ackerman plates installed the angle of the car will be 65 on the inside wheel, and 65 on the outside. *please note that alignment settings, rack position and other variables can effect the ackerman curve resulting in differences from chassis to chassis, make adjustments according to your individual setup*

-Offset Rack spacer, if the steering rack is in the factory position, the rack spacer is designed to move the inner tierod forward 32mm. (the other 2 holes are only for if the rack is relocated forward) use red lock-tite on the rack bolt and torque to factory spec.

Alignment Recommendations

Caster 5.5 + or - .5

Camber -4 + or -1.0

Toe 0-1/8th out

Wheel size recommendation-18x9 +10 offset (or close to this)

LEFT SIDE FRONT

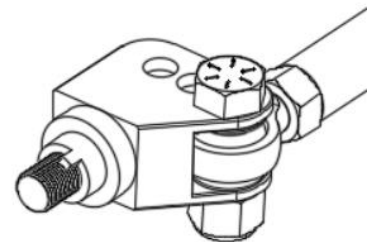
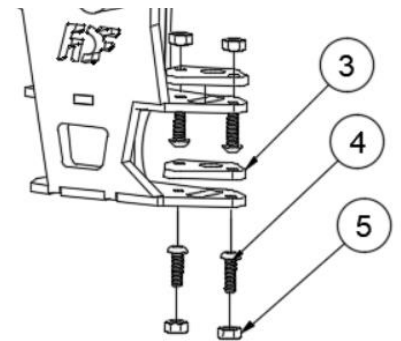
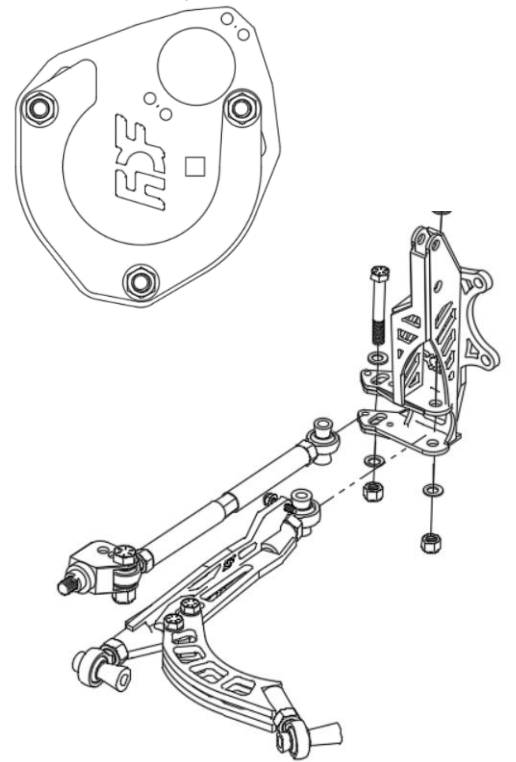

**For Racing
Use only**



**Not For
Road Use**

Must be installed by a licensed professional



fdfraceshopcustomerservice@gmail.com

+1(613)243-8859