

# Installation Guide



## C5/C6 MANTIS KIT

Fully Assembled view of the C5/C6 mantis kit is shown for the left side of the car

- 1- Steering Knuckle
- 2- Upper control arm
- 3- Lower control arm

\*Bolt check regularly, take note of the orientation of all the components in this view\*

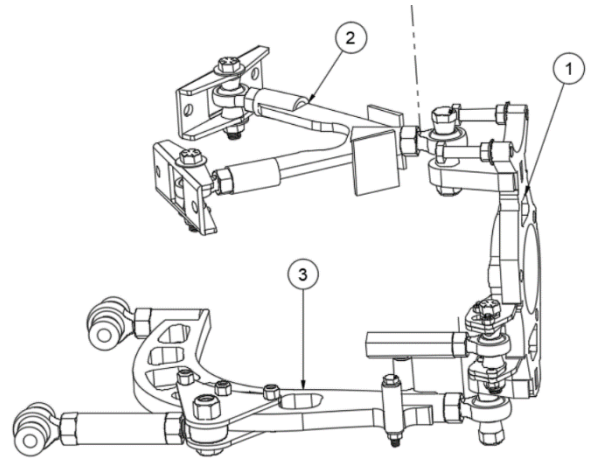

**-ACKERMAN PLATES** see image for how to change the ackerman plates.

The kit includes +2, 0 and -2 ackerman plates. This is the difference in angle measured at full lock. Example- with 0 ackerman plates installed the angle of the car will be 60 on the inside wheel, and 60 on the outside. \*please note that alignment settings, rack position and other variables can effect the ackerman curve resulting in differences from chassis to chassis, make adjustments according to your individual setup\*

**BUMP STOP BOLTS**- using these bolts, adjust the length to limit the angle. This is to avoid contact from the wheel to control arms components

**CALIPER BRACKET**- is installed behind the knuckle, using the wheel bearing bolts to secure it in place. Make sure the offset of the bracket hold the caliper in the center of the rotor. There is a left and right side, machine surface should facing outward\*

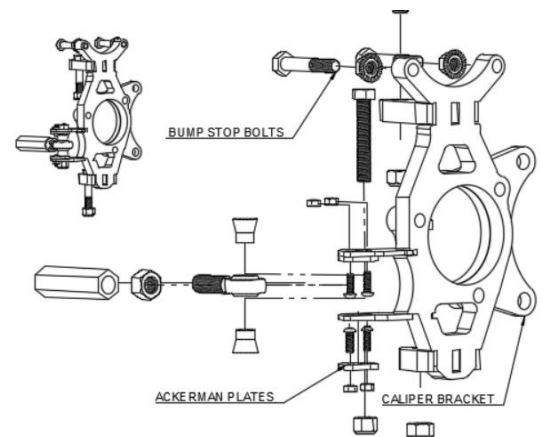

### Alignment Recommendations

**Caster** 7 + or - .5

**Camber** -4 + or -1.0

**Toe** 0-1/8<sup>th</sup> out

### Wheel size recommendation

18x9 +10 offset (close to this size will work well)

**For Racing  
Use only**



**Not For  
Road Use**

Must be installed by a licensed professional



fdfraceshopcustomerservice@gmail.com

+1(613)243-8859