

# Installation Guide



## V2 CORVETTE C5/C6/C7 FLCA

Fully Assembled view of the driver's side, V2 Corvette LCA for C5/C6/C7

\*Bolt check regularly, take note of the orientation of all the components in this view\*

\*do not exceed the rod ends adjustments, each rod end should have a minimum of 1 to 1.5x the diameter of the joint. (example, a 3/4-16 rod end needs to have approx. .75-1.125" inside of the arm at a minimum, this is 12-18 threads)

The LCA's for C5/C6/C7 are 25mm longer than factory at its shortest Adjustment. Use the ON-CAR smooth adjusters to Dial in your camber and caster. Torque all hardware To GM factory spec. to run a wider track width and stay within the recommended alignment settings, you may need to add upper control arm shims.

The shock mounting point has 3 positions for motion Ratio adjustment. For a stiffer ride, move the mount outward towards the knuckle and for a softer ride, move the mount Inward towards the engine.

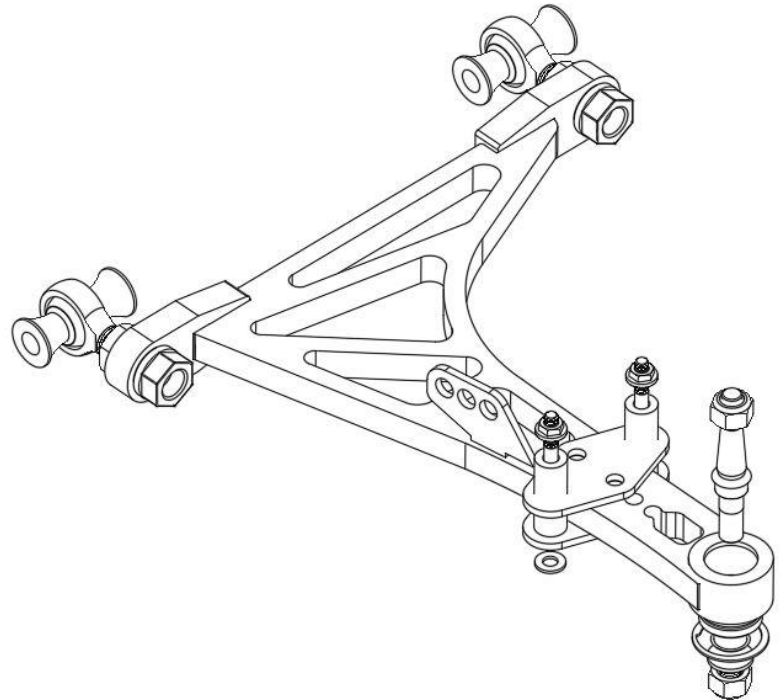

### Alignment Recommendations

**Caster**- 7 + or - .5

**Camber** -4 + or -1.0

**Toe** 0-1/8<sup>th</sup> out

Wheel size recommendation

18x9 +10 offset (close to this size will work well)

**For Racing  
Use only**



**Not For  
Road Use**

Must be installed by a licensed professional



fdfraceshopcustomerservice@gmail.com  
+1-888-361-7223