

Flat Brass & Sintered Bronze Silencers

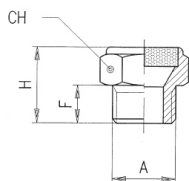

Technical Characteristics

Maximum pressure: 12 bar
Minimum temperature: -10°C
Maximum temperature: +80°C
Filtration threshold: 100 µm

dB = Noise level in (dB) at 6 bar

Code	A	F	H	CH	dB
7010-1/8	1/8"	6	14	13	73
7010-1/4	1/4"	7	17	16	74
7010-3/8	3/8"	8	18	19	85
7010-1/2	1/2"	10	20	24	89
7010-3/4	3/4"	10	23	30	90

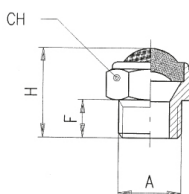

Technical Characteristics

Maximum pressure: 12 bar
Minimum temperature: -10°C
Maximum temperature: +80°C
Filtration threshold: 100 µm

dB = Noise level in (dB) at 6 bar

Code	A	F	H	CH	dB
7020-M5	M5	4	9	8	
7020-1/8	1/8"	6	15	13	74
7020-1/4	1/4"	7	18	16	72
7020-3/8	3/8"	8	20	19	88
7020-1/2	1/2"	10	22	24	90
7020-3/4	3/4"	10	26	30	90

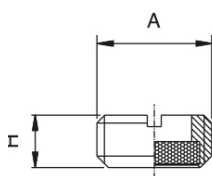

Technical Characteristics

Maximum pressure: 12 bar
Minimum temperature: -10°C
Maximum temperature: +80°C
Filtration threshold: 120 µm

dB = Noise level in (dB) at 6 bar

Code	A	H
7120-1/8	1/8"	4
7120-1/4	1/4"	6
7120-3/8	3/8"	6
7120-1/2	1/2"	9
7120-3/4	3/4"	10
7120-1	1"	10