

Manual

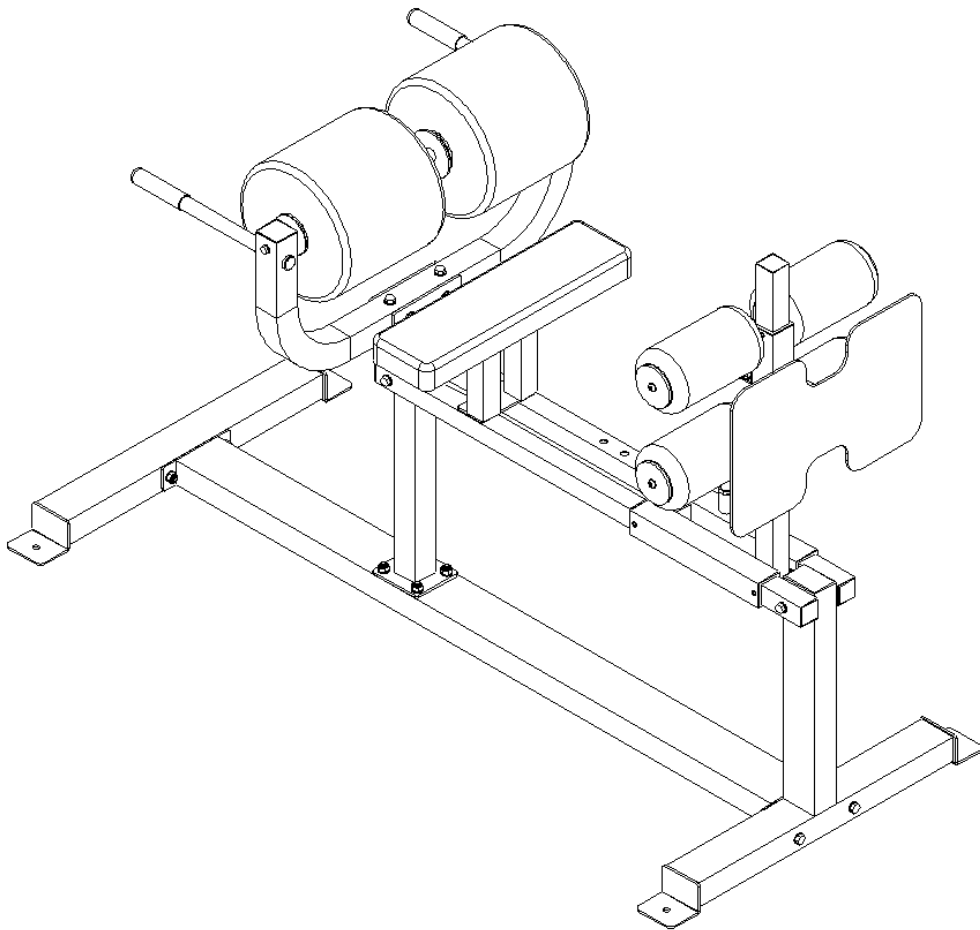

EXPLODED DRAWING

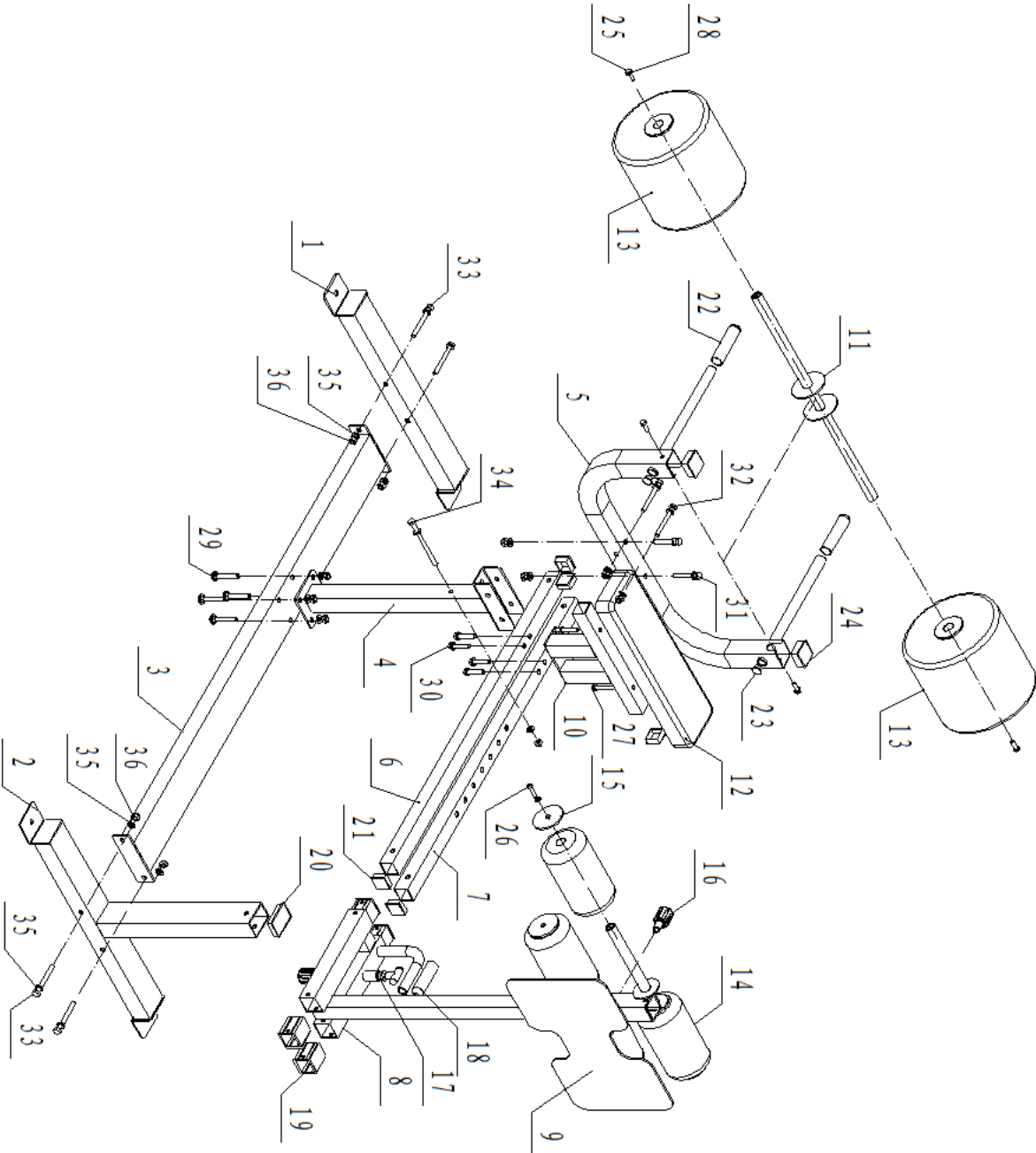

PARTS LIST

No.	Description	Qty	No.	Description	Qty
1	Front Base Frame	1	21	Plug 40*40*2	8
2	Rear Frame	1	22	Handle Grip ϕ 25	2
3	Lower Cross Arm	1	23	Round Cap ϕ 25*3	2
4	Front Upright Frame	1	24	Plug 50*50*2	2
5	Support Tube	1	25	Bolt M8*25	2
6	Upper Connecting Tube Left	1	26	Bolt M8*35	4
7	Upper Connecting Tube Right	1	27	Bolt M8*65	2
8	Horizontal Adjustment	1	28	Flat Washer ϕ 8	8
9	Small Adjustable Assembly	1	29	Carriage Bolt M10*70	4
10	Support Frame for Pad	1	30	Bolt M10*50	4
11	Foam Frame	1	31	Bolt M10*70	2
12	Thin Pad	1	32	Bolt M10*75	2
13	Big Foam ϕ 260* ϕ 26*255mm	2	33	Bolt M10*95	4
14	Foam for foot	4	34	Bolt M10*145	2
15	Foam Roller Plate	4	35	Flat Washer ϕ 10	28
16	Quick release knob	2	36	Nut M10	14
17	Knob	1			
18	Round Cap ϕ 25*3*100mm	1			
19	Sleeve 40*1.5-40mm	6			
20	Plug 50*75*3	1			

ASSEMBLY

Step 1

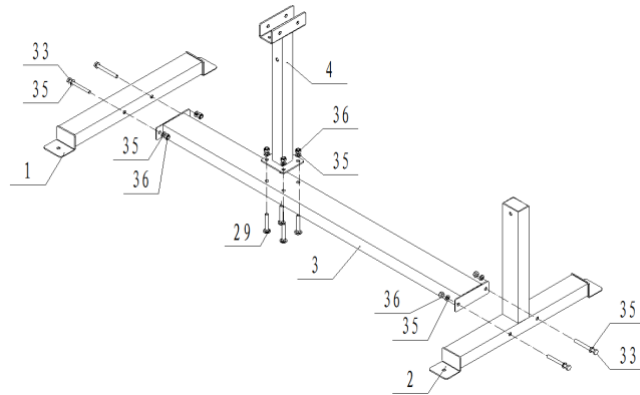

1. Assembly Front Base Frame (1) , Rear Frame (2) and Lower Cross Arm (3) by Bolt M10*95 (33),Flat Washer ϕ 10 (35) and Nut M10 (36).

2. Assembly Lower Cross Arm (3) and Front Upright Frame (4) by Carriage Bolt M10*70 (29),Flat Washer ϕ 10 (35) and Nut M10 (36).

Step 2

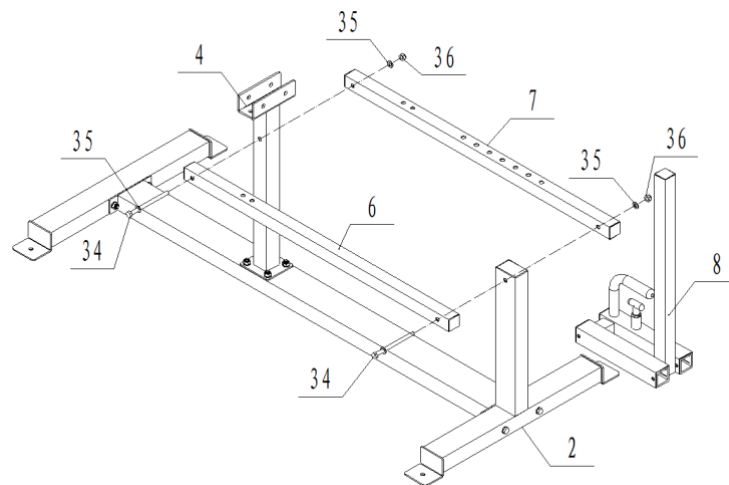

1. Insert Horizontal Adjustment (8) to Upper Connecting Tube Left (6)and Upper Connecting Tube Right (7).

2. Assembly Rear Frame (2) , Front Upright Frame (4) ,Upper Connecting Tube Left (6) and Upper Connecting Tube Right (7) by Bolt M10*145 (34),Flat Washer ϕ 10 (35) and Nut M10 (36).

Step 3

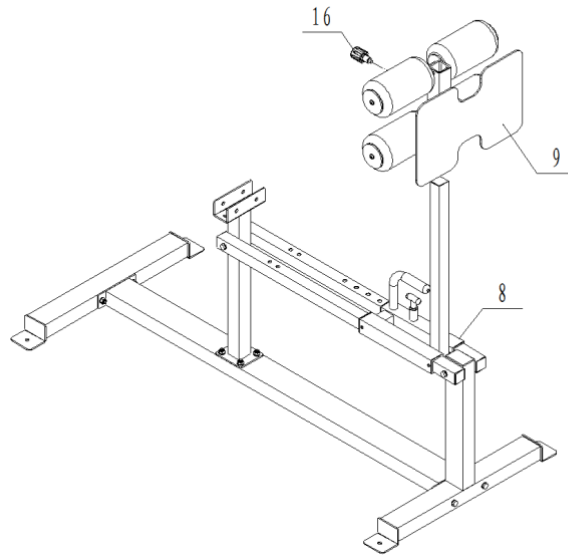

Insert Small Adjustable Assembly (9) to Horizontal Adjustment (8),and then tighten it using Quick release knob (16) .

Step 4

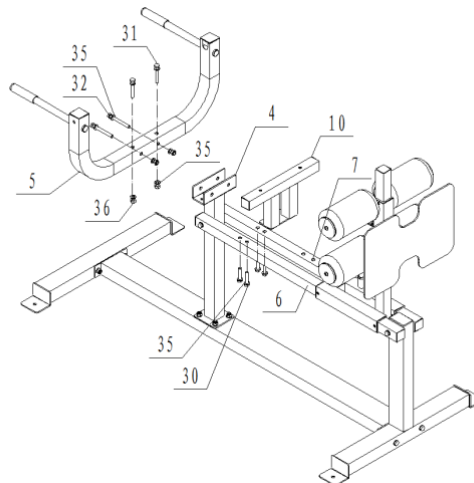

1. Assembly Support Tube (5) and Front Upright Frame (4) by Bolt M10*70 (31),Bolt M10*75 (32),Flat Washer ϕ 10 (35) and Nut M10 (36).

2. Assembly Support Frame for Pad (10) , Upper Connecting Tube Left (6) and Upper Connecting Tube Right (7) by Bolt M10*50 (30) and Flat Washer ϕ 10 (35) .

Step 5

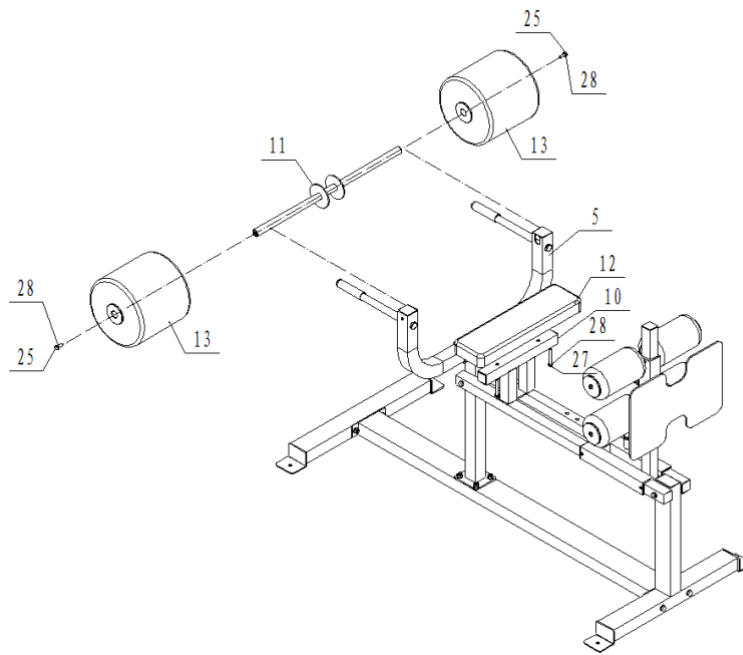

1. Insert Big Foam ϕ 260* ϕ 26*255mm (13) to Foam Frame (11).

2. Assembly Foam Frame (11) and Support Tube (5) by Bolt M8*25 (25) and Flat Washer ϕ 8 (28) .

3. Assembly Thin Pad (12) and Support Frame for Pad (10) by Bolt M8*65 (27) and Flat Washer ϕ 8 (28).