

VINYL TILE PANEL HANGING GUIDE

-How to install your vinyl panels with QUADROSTYLE

The easiest way to hang your vinyl panels is to handle them as enormous vinyl tiles. The technique is almost as simple.

Fig.1. Preparation is key to getting a perfect result. Create a plumb line to use as your guide in placing the first panel.

Fig 2. Peel the panel from its backing by bending the corner back. Position the top of the panel to the ceiling

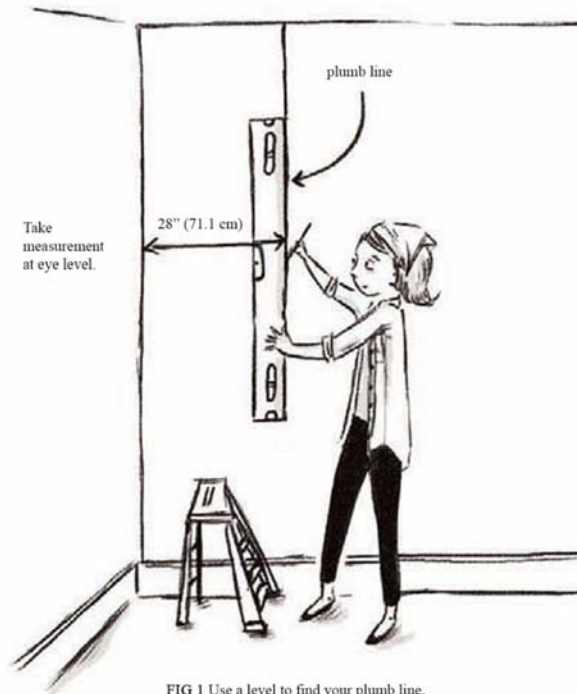

FIG 1 Use a level to find your plumb line, and extend line to ceiling and floor.

Fig.3. Line up the edge of the panel with your plumb line.

Fig 4. Smooth your panel against the wall, pressing out any air bubbles to either side.

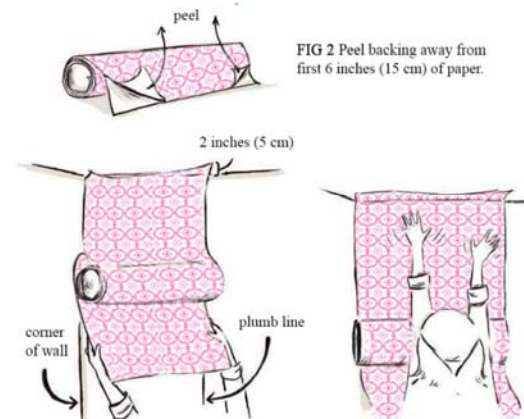

FIG 2 Peel backing away from first 6 inches (15 cm) of paper.

FIG 3 Line up right edge of paper with plumb line.

FIG 4 Smooth paper against wall.

Align the next panel beside the first, carefully matching the pattern edge and ensuring it's straight. Seams should not overlap, rather butt up against each other.

Trim away any excess using a very sharp cutter or blade. Use this method around windows, door and moldings.



FIG 5 Trim away excess paper.

