

MOBEL RISE ELECTRIC HEIGHT ADJUSTABLE DESK

Assembly Instructions

Thank you for your purchase

Please follow the instructions for correct assembly





Caution

 Make sure children and pets are away from the product when it is operating. Please unplug it when there is thunder and lightning or long-time no-use.

 Make sure there is a gap between desk and wall.

 Make sure there is no obstacle during operation. No obstacle higher than 500mm is allowed under the desk.

 Working temperature is 0-40 degrees. The product should be away from erosive gas, liquid or dusty objects.

 Disassemble the product yourself may cause a malfunction to product and cause a damage to human body.

 To avoid unnecessary damage to human body, make sure your hands and other body parts are placed at safe positions during operation in spite of the anti-bumping function of this product. When reset manually, this function won't be activated.

 Please read instructions carefully before using this product. We won't take responsibility for product damages or human injuries caused by improper operations.

 When use it for the first time, or use it after a power-off, please reset manually and after that carry out relevant operations.

Accessory list

30 min

Time period

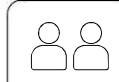

Personnel

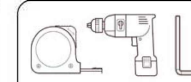

Tool

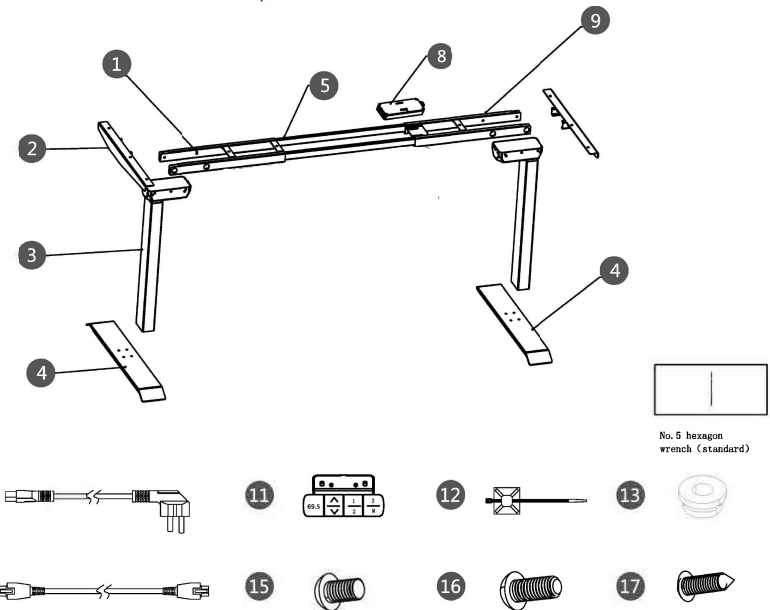

No.	Component name	Amount(PCS)
1	frame(with holes)	1
2	side panel	2
3	lift pole	2
4	feet	2
5	connecting pole	2
6	N/A	
7	N/A	
8	N2 controller	1
9	frame with controller(with holes)	1
10	power cord	1
11	hand controller	1
12	wire clip	10

No.	Component name	Amount(PCS)
13	soft rubber mat	9
14	extension wire	1
15	M6x10hexagon flat round head screw	8
16	M6x14 hexagon flat round head screw	12
17	ST4.2*16 tapping screw	2
18	M6*19 tapping screw (not Pictured)	11

Assembly instruction

STEP 1

- Take controlling box from installing shelf and put it aside
- Separate installing shelf and controlling box installing shelf, take out two central beams inside.

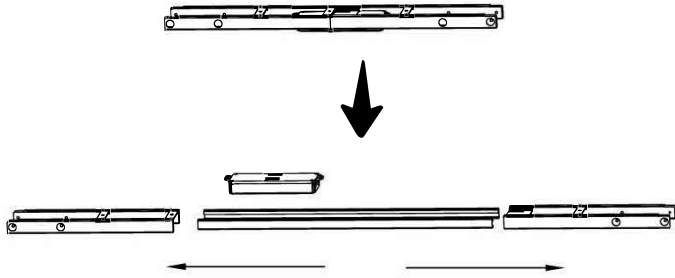

STEP 2

- Use four M6*10 hexagon flat round head screws to fix frame and standing pole ; (8pcs)
- Use two M6*14 hexagon flat round head screws to fix side panel and frame; (4pcs)

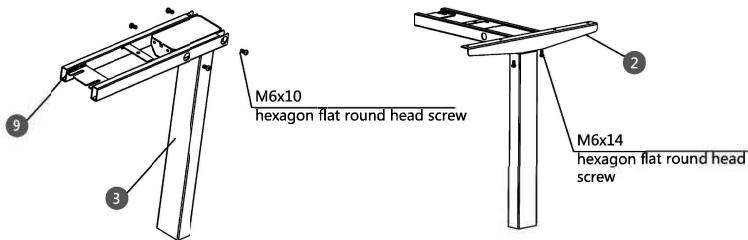

STEP 3

- Use four M6*14hexagon screws to fix desk leg and feet ; (8pcs)
- Insert two connecting poles into installing shelves,make sure the open slot of central beam is closer to desk leg(with thinner sides upwards).

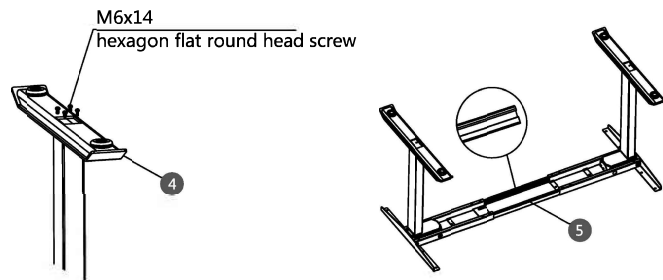

Assembly instruction

STEP 4

- Put frame at the center of desktop, extend frames to adjust width accordingly;
- Use M6x19 tapping screws to tighten(put soft cushion between desktop and frame (11pcs) , use two ST4.2*16 tapping screws to fix p hand controller.

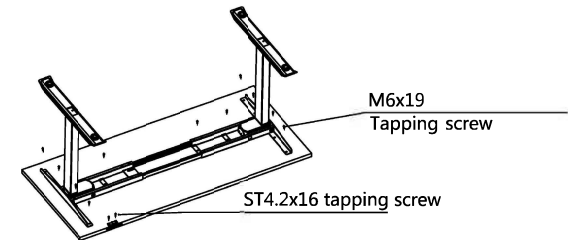

STEP 5

- Insert controller into frames and connect accessories, fix them with wire clips :

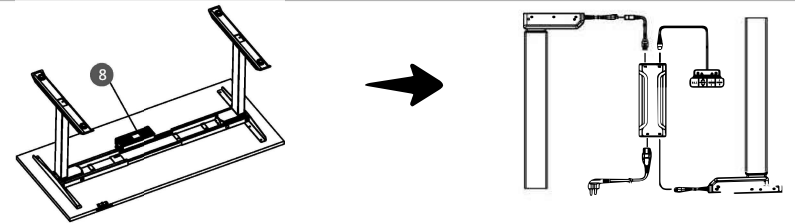

STEP 6

- Flip over desk, follow controller reset instructions on following page

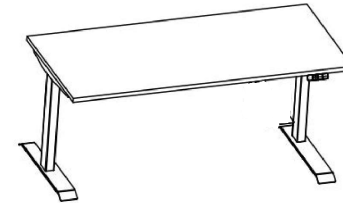

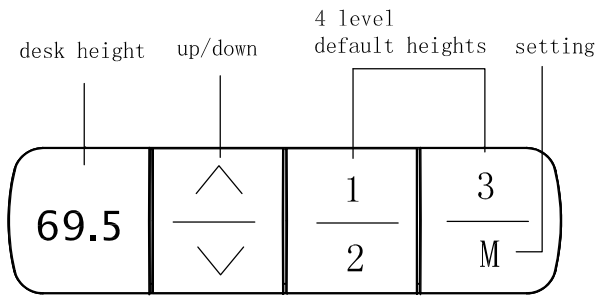

Note Please make sure there is no obstacle during the operation, and there is a gap between desk and wall. And all wires are long enough to allow the up-down of desk.

Advice Please set up as 1 the most comfortable height when you sit down, and set up as 2 the most comfortable height when you stand up. For the other two heights, you can choose whatever you like.

Reset abnormality protection

When there is something wrong with controller reported, the digital tube shows E07-E09. Even if it has access to power after a power cut-off, it will still give an error notice no matter what button you press.

Operation

After pressing for 5s and digital tube shows RST, release the button and press the down button, reset will be activated.

Set up upper limit position

Press M button, the digital tube shows "S-", then release the button. Press the up button, the digital tube will flash once, release the button. Press M button again for 2s, the digital tube shows "999". The upper limit position has been set.

Set up lower limit position

Press M button, the digital tube shows "S-", release the button. Press the down button. The digital tube will flash once. Release the button. Press down M button again for 2s, the digital tube shows "000". The lower limit position has been set.

Delete limit position

Press M button, the digital tube shows "S-", release the button. Press M button again for 2S, it shows "555". The upper and lower limits have been deleted.

Lock

Press M button, the digital tube shows "S-", long press M button for 5S, the digital tube shows numbers. Press M button for 3S, it shows LOC. The buttons on the hand controller are locked.

Unlock

Under the LOC condition, long press M button for 8S, it shows numbers. Buttons on hand controller are unlocked.

Revise lowest height

Under the reset condition, it shows RST. Long press "M" button for 5S, it shows the height after reset and twinkles. Press up or down button to adjust to the appropriate height. 5S after releasing the button, the digital tube will go back to RST, which means the amendment is successful.

Switch between memory inching/continuous moving

Under the reset condition (digital tube shows RST) Long press button "1" for 5s, switch inching and continuous moving.

When it shows "10.1", continuous moving.

When it shows "10.2", inching moving.

Centimeter/inch display switch

Under the reset condition (digital tube shows RST), long press "2" for 5s, you can switch between inch display and cm display.

When it shows "10.3", the height after reset will be shown in cm;

When it shows "10.4", the height after reset will be shown in inch.

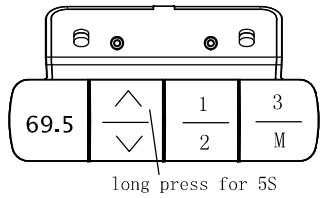

Sensitivity setting on retreating upon obstacle

Under the reset condition (the digital tube shows RST), long press the up button for 5S, the sensitivity can be adjusted.

switch display

“10.5” --10kg

“10.6” --15kg

“10.7” --20kg

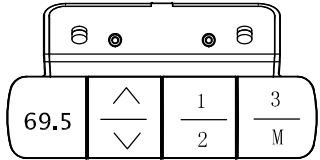

Setting of memory position

Press M button, it shows “S-”, select and press one of the memory buttons, current height will be remembered.

Use up/down button to get the desirable height, then repeat the following action.

Normal problems and solutions

1. If your desk has the following issues, please try resetting:
 - Working abnormality
 - Hand controller shows RES (reset)
 - Hand controller shows error (E07, E08), but motor drive wire is well connected.
2. If it shows HOT (hot), please cut off the power and allow it to cool off for 20 minutes.