

# SONOFF

## SNZB-04

User manual V 1.0

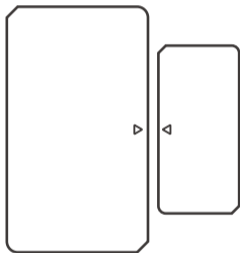

## Wireless Door/Window Sensor

中文-----1-6

Deutsch-----13-18

Français-----25-30

Русский язык-----37-43

FCC Warning-----51

English-----7-12

Español-----19-24

Italiano-----31-36

Português-----44-50

本设备需要连接SONOFF ZigBee网关进行智能操作，可与其他产品互联互通。

①设备支持其他无线协议为ZigBee 3.0的网关，具体以实际产品为准。

## 使用说明

### 1. 下载APP



### 2. 取出电池绝缘片

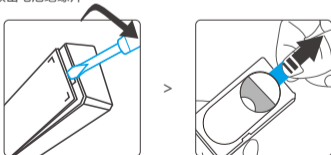

### 3. 添加子设备

① 添加子设备前，请先连接网关。

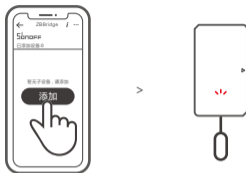

打开eWeLink APP，选择要连接的网关，点击“添加”子设备，然后长按设备重置按钮5秒直至LED指示灯闪烁3下，设备进入配对状态，等待设备连接。

① 如添加失败，请将设备移近网关后再重新添加。

## 产品参数

产品型号	SNZB-04
电池型号	CR2032(3V)
无线连接	ZigBee (IEEE 802.15.4)
静态电流	<2uA
发射电流	<15mA
安装距离	<10mm
工作温度	-10°C~40°C
工作湿度	10-90%RH(无冷凝)
外壳材料	PC
产品规格	发射器(47x27x13.5mm) 磁铁(32x15.6x13mm)

## 产品介绍

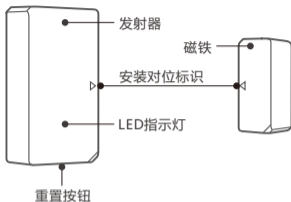

## 产品特点

SNZB-04是一款低功耗的无线门窗传感器，通过发射器与磁铁的靠近与分开感知门窗开/合状态，通过添加场景联动设置控制其它设备。



低功耗



电量低消息推送



场景联动

## SONOFF ZigBee网关支持同时连接多个子设备

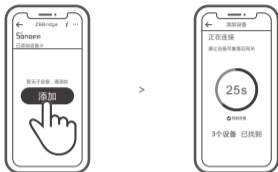

先将网关通电，打开eWeLink APP网关页面，点击添加，然后设置让所需配对的子设备进入配对状态，等待设备连接。

## 删除子设备

长按子设备重置按钮5秒直到LED指示灯闪烁3下，此时子设备已在网关中删除。



① 用户还可在APP子设备界面中删除子设备。

## 设备安装

1. 撕下3M胶保护膜

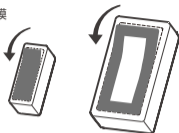

2. 安装时发射器和磁铁上的安装对位标识尽量对齐。

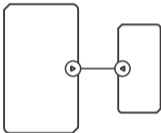

3. 分别粘贴在所需开合区域。

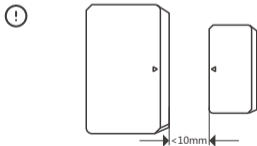

发射器和磁铁安装间隙门窗在闭合状态下小于10mm。

设备重量 < 1Kg，建议安装高度 < 2米。

## 使用场景

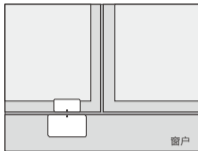
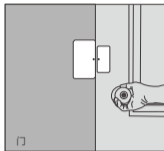

### 注意事项：

- 请勿安装在户外容易被破坏的位置；
- 请勿安装在基础不牢固或有雨淋的位置；
- 请勿安装在线路旁或磁性物体附近；

The device can be operated intelligently via working with the SONOFF ZigBee Bridge to communicate with other devices.

ⓘ The device can work with other gateways supporting ZigBee 3.0 wireless protocol. Detailed information is in accordance with the final product.

## Operation instruction

### 1. Download APP

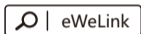

### 2. Pull out the battery insulation sheet

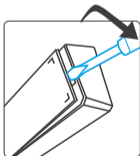

>

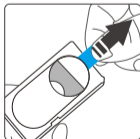



### 3. Add sub-devices

- ① Connect the Bridge before adding the sub-device

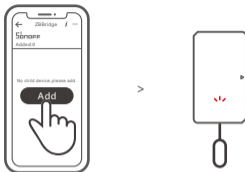

Access eWeLink APP, select the Bridge that you want to connect, and tap "Add" to add a sub-device. Then long press reset button on the device for 5s until the LED indicator flashes three times, which means the device has entered the pairing mode, and be patient until pairing completes.

- ① If the addition failed, move the sub-device closer to the Bridge and try again.

## Specifications

Model	SNZB-04
Battery model	CR2032(3V)
Wireless connection	ZigBee (IEEE 802.15.4)
Quiescent current	<2uA
Emission current	<15mA
Installation gap	<10mm
Working temperature	-10°C~40°C
Working humidity	10-90%RH (non-condensing)
Material	PC
Dimension	Transmitter: 47x27x13.5mm Magnet: 32x15.6x13mm

## Product Introduction

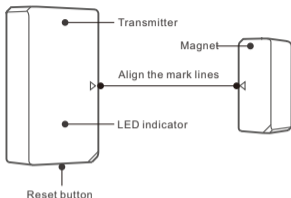

## Features

SNZB-04 is a ZigBee low-energy wireless door/window sensor that makes you know the opening/closing status of door and window by separating the magnet from the transmitter. Connect it with the Bridge and you can create a smart scene to trigger other devices.



Low-energy



Low battery notification



Smart scene

SONOFF ZigBee Bridge supports connecting multiple sub-devices at the same time.

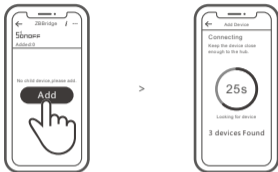

Power the Bridge on, access the Bridge page in the eWeLink APP, and tap "Add". Then set the sub-device to be paired to the pairing mode, and be patient until the pairing completes.

## Delete sub-devices

Long press the reset button on the sub-device for 5s until the LED indicator flashes three times. In this case, the sub-device is deleted from the Bridge successfully.



ⓘ Users can delete sub-devices directly from the sub-device page on APP.

## Installation methods

1. Tear off the protective film of the 3M adhesive.

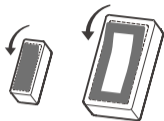

2. Try to align the mark line on the magnet with that on the transmitter during installation.

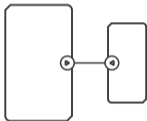

3. Install them in the opening and closing area separately.

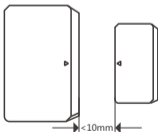

Make sure the installation gap is less than 10mm when the door or the window is closed.

The device weight is less than 1 kg.

The installation height of less than 2 m is recommended.

## Application

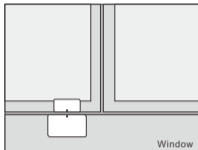
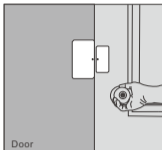

**Note:**

- Do not install outside the door/window.
- Do not install in the unstable position or in the place exposed to rain or moisture.
- Do not install near wiring or magnetic object.

Das Gerät kann intelligent betrieben werden, indem man mit dem SONOFF ZigBee Gateway arbeitet, um mit anderen Geräten zu kommunizieren.

ⓘ Das Gerät kann mit anderen Gateways zusammenarbeiten, die das drahtlose ZigBee 3.0-Protokoll unterstützen. Detaillierte Informationen sind in Übereinstimmung mit dem Endprodukt.

## Betriebsanweisung

### 1. APP herunterladen

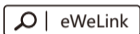

### 2. Ziehen Sie die Batterieisolierungsfolie heraus

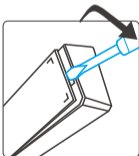

>

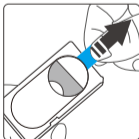

### 3. Untergeräte hinzufügen

- ⓘ Schließen Sie das Gateway an, bevor Sie das Untergerät hinzufügen

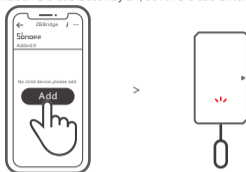

Rufen Sie eWeLink APP auf, wählen Sie das Gateway, das Sie verbinden möchten, und tippen Sie auf „Hinzufügen“, um ein Untergerät hinzuzufügen. Drücken Sie dann lange auf Rückstelltaste am Gerät für 5 Sekunden, bis die LED-Anzeige dreimal blinkt, was bedeutet, dass das Gerät in den Kopplungsmodus eingetreten ist, und haben Sie Geduld, bis die Kopplung abgeschlossen ist.

- ⓘ Wenn das Hinzufügen fehlgeschlagen ist, bewegen Sie das Untergerät näher an das Gateway und versuchen Sie es erneut.

## Technische Daten

Modell	SNZB-04
Batterie Modell	CR2032(3V)
Drahtlose Verbindung	ZigBee (IEEE 802.15.4)
Ruhestrom	<2uA
Emissionsstrom	<15mA
Einbauspalt	<10mm
Arbeitstemperatur	-10°C~40°C
Luftfeuchtigkeit bei der Arbeit	10-90% Luftfeuchtigkeit (nicht kondensierend)
Materialien	PC
Abmessungen	Sender: 47x27x13.5mm Magnet: 32x15.6x13mm

## Produktvorstellung

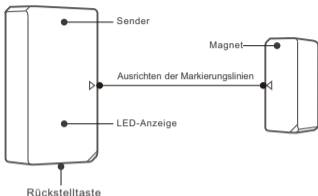

## Merkmale

SNZB-04 ist ein energiesparender drahtloser ZigBee-Tür- / Fenstersensor mit niedrigem Energieverbrauch, der Ihnen den Öffnungs- / Schließzustand von Tür und Fenster anzeigt, indem er den Magneten vom Sender trennt. Verbinden Sie ihn mit dem Gateway, und Sie können eine intelligente Szene erstellen, um andere Geräte auszulösen.



Niedrige Energie



Benachrichtigung bei  
niedrigem  
Batteriestand



Intelligente Szenarien



## SONOFF das ZigBee-Gateway unterstützt die gleichzeitige Verbindung mehrerer Untergeräte.

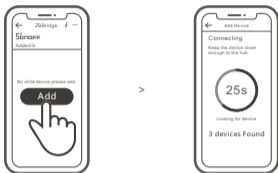

Schalten Sie das Gateway ein, rufen Sie die Gateway-Seite im eWeLink APP auf und tippen Sie auf „Hinzufügen“. Stellen Sie dann das zu koppelnde Untergerät auf den Kopplungsmodus ein und haben Sie Geduld, bis die Kopplung abgeschlossen ist.

## Löschen von Untergeräten

Drücken Sie die Rücksteltaste am Untergerät 5 Sekunden lang, bis die LED-Anzeige dreimal blinkt. In diesem Fall wird das Untergerät erfolgreich aus dem Gateway gelöscht.



ⓘ Benutzer können Untergeräte direkt von der Untergeräteseite auf APP löschen.

# Installationsmethoden

1. Die Schutzfolie des 3M-Klebstoffs abreißen.

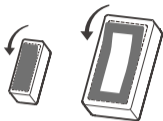

2. Versuchen Sie die Markierungslinie auf dem Magneten bei der Montage mit der auf dem Sender auszurichten.

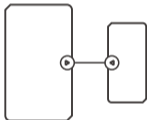

3. Installieren Sie sie im Öffnungs- und Schließbereich getrennt.

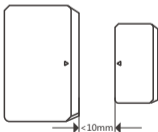

Achten Sie darauf, dass der Einbauspalt bei geschlossener Tür oder geschlossenem Fenster weniger als 10 mm beträgt.

Das Gerätegewicht beträgt weniger als 1 kg.

Es wird eine Installationshöhe von weniger als 2 m empfohlen.

## Anwendung

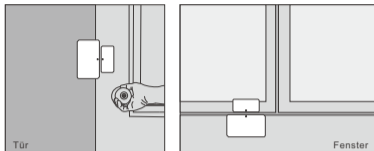

### Hinweis:

- Nicht außerhalb der Tür / Fenster installieren.
- Nicht in einer instabilen Position oder an einem Ort installieren, an dem es Regen oder Feuchtigkeit ausgesetzt ist.
- Nicht in der Nähe von Leitungen oder magnetischen Objekten installieren.

El dispositivo puede operarse de forma inteligente trabajando con el SONOFF de ZigBee puerta de enlace para comunicarse con otros dispositivos.

ⓘ El dispositivo puede trabajar con otras puertas de enlace que sean compatibles con el protocolo inalámbrico de ZigBee 3.0. La información detallada es conforme al producto final.

## Instrucciones de funcionamiento

### 1. Descargar la aplicación

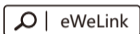

### 2. Extraiga la lámina aislante de la batería

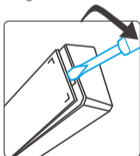

>

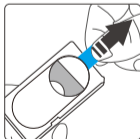

### 3. Agregar subdispositivos

- ⓘ Conecte la puerta de enlace antes de agregar el subdispositivo.

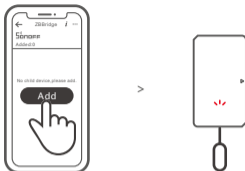

Acceda a la aplicación eWeLink, seleccione la puerta de enlace que desee conectar y toque en "Agregar" para agregar el subdispositivo. Posteriormente, pulse el botón de reinicio del dispositivo durante 5 segundos hasta que el indicador LED parpadee tres veces, lo que significa que el dispositivo ha entrado en modo emparejamiento y tenga paciencia hasta que se complete el emparejamiento.

- ⓘ Si se produce un error al agregar, mueva el subdispositivo más cerca de la puerta de enlace e inténtelo de nuevo.

## Especificaciones

Modelo	SNZB-04
Batería modelo	CR2450(3V)
Conexión inalámbrica	ZigBee (IEEE 802.15.4)
Corriente estática	<2uA
Corriente de emisión	<15mA
Brecha de instalación	<10mm
Temperatura de funcionamiento	-10°C~40°C
Humedad de funcionamiento	10-90%RH (sin condensación)
Materiales	PC
Dimensiones	Transmisor: 47x27x13.5mm Imán: 32x15.6x13mm

## Introducción al producto

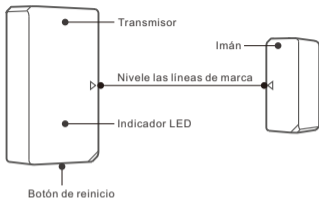

## Características

El SNZB-04 es un sensor ZigBee inalámbrico de puertas / ventanas de baja energía que le hace saber el cierre de apertura / cierre de la puerta y ventana separando el imán del transmisor. Conéctelo con la puerta de enlace y puede crear una escena inteligente para habilitar otros dispositivos.



Baja energía



Notificación de  
batería baja



Escenas

El SONOFF del puerta de enlace de ZigBee es compatible con la conexión de múltiples subdispositivos al mismo tiempo.

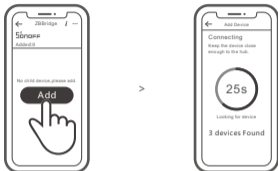

Conecte la puerta de enlace, acceda a la página de puerta de enlace en la aplicación eWeLink y toque en "Agregar". Posteriormente, configure el subdispositivo para que se empareje al modo de emparejamiento y tenga paciencia hasta que se complete el emparejamiento.

## Eliminar subdispositivos

Pulse durante 5 segundos el botón de reinicio del subdispositivo hasta que el indicador LED parpadee tres veces. En este caso, el subdispositivo se elimina correctamente de la puerta de enlace.



ⓘ Los usuarios pueden eliminar los subdispositivos directamente desde la página de subdispositivos de la aplicación.

## Métodos de instalación

1. Quite la lamina protectora del adhesivo 3M.

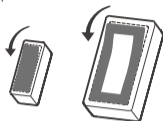

2. Intente alinear la línea del imán con la que se encuentra en el transmisor durante la instalación.

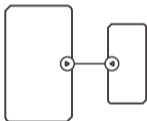

3. Instálelos por separado en el área de apertura y de cierre.

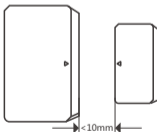

Asegúrese de que la brecha de instalación sea menor a 10mm cuando la puerta o ventana esté cerrada.

El peso del dispositivo es inferior a 1 kg.  
Se recomienda una altura de instalación inferior a 2 m.



## Aplicación

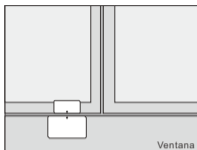
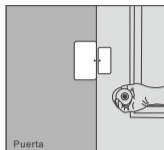

### Nota:

- No lo instale fuera de la puerta/ventana.
- No lo instale en superficies inestables o en lugares expuestos a la lluvia o la humedad.
- No lo instale cerca de objetos inalámbricos o magnéticos.

L'appareil peut être utilisé de manière intelligente en travaillant avec la passerelle SONOFF ZigBee pour communiquer avec d'autres appareils.

ⓘ Le dispositif peut fonctionner avec d'autres passerelles prenant en charge le protocole sans fil ZigBee 3.0. Les informations détaillées sont conformes au produit final.

## Instruction d'opération

### 1. Télécharger l'application



### 2. Retirez la feuille d'isolation de la batterie

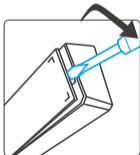

>

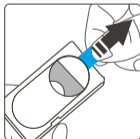

### 3. Ajouter des sous-appareils

- ⓘ Connecter la passerelle avant d'ajouter le sous-dispositif.

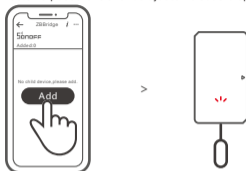

Accédez à eWeLink APP, sélectionnez la passerelle que vous souhaitez connecter et appuyez sur «Ajouter» pour ajouter un sous-dispositif. Ensuite, appuyez longuement sur le bouton de réinitialisation de l'appareil pendant 5s jusqu'à ce que le voyant LED clignote trois fois, ce qui signifie que l'appareil est entré en mode d'appairage, et soyez patient jusqu'à la fin de l'appairage.

- ⓘ Si l'ajout a échoué, rapprochez le sous-appareil de la passerelle et essayez à nouveau.

## Caractéristiques techniques

Modèle	SNZB-04
Batterie modèle	CR2450(3V)
Connexion sans fil	ZigBee (IEEE 802.15.4)
Courant de repos	<2uA
Courant d'émission	<15mA
Espace d'installation	<10mm
Température de travail	-10°C~40°C
L'humidité de travail	10-90%HR (sans condensation)
Matériaux	PC
Dimensions	Emetteur: 47x27x13.5mm Aimant: 32x15.6x13mm

## Présentation du produit

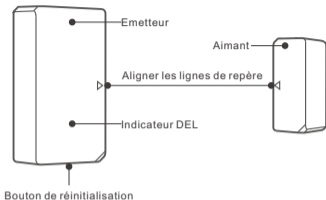

## Caractéristiques

SNZB-04 est un capteur de porte/fenêtre sans fil ZigBee à faible consommation d'énergie qui vous permet de connaître l'état d'ouverture/fermeture des portes et fenêtres en séparant l'aimant de l'émetteur. Connectez-le avec la passerelle et vous pouvez créer une scène intelligente pour déclencher d'autres appareils.



Faible  
consommation



Notification  
de batterie faible



Scènes intelligentes

SONOFF ZigBee Passerelle permet de connecter plusieurs sous-appareils en même temps.

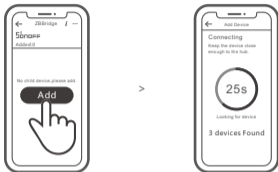

Mettez la passerelle sous tension, accédez à la page passerelle dans le eWeLink APP et appuyez sur «Ajouter». Réglez ensuite les sous-périphériques en mode d'appairage et soyez patient jusqu'à ce que l'appairage soit terminé.

## Supprimer des sous-appareils

Appuyez longuement sur le bouton de réinitialisation du sous-appareil pendant 5s jusqu'à ce que le voyant LED clignote trois fois. Dans ce cas, le sous-appareil est supprimé de la passerelle avec succès.



ⓘ Les utilisateurs peuvent supprimer des sous-appareils directement à partir de la page des sous-appareils sur APP.

## Méthodes d'installation

1. Déchirer le film protecteur de l'adhésif 3M.

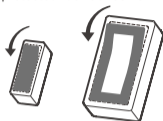

2. Essayer d'aligner la ligne de repère sur l'aimant avec celle de l'émetteur lors du montage.

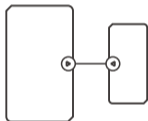

3. Les installer séparément dans la zone d'ouverture et de fermeture.

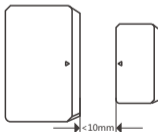

S'assurer que l'espace d'installation est inférieur à 10 mm lorsque la porte ou la fenêtre est fermée.

Le poids du dispositif est inférieur à 1 kg.

Il est recommandé d'installer le dispositif à une hauteur inférieure à 2 m.

## Application

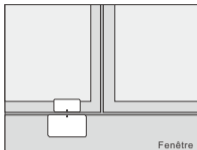
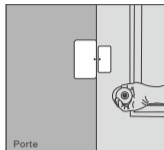

### Remarque:

- Ne pas installer à l'extérieur de la porte/fenêtre.
- Ne pas installer dans la position instable ou dans l'endroit exposé à la pluie ou à l'humidité.
- Ne pas installer près du câblage ou objet magnétique.

Il dispositivo può essere azionato in modo intelligente attraverso SONOFF ZigBee Gateway per comunicare con altri dispositivi.

ⓘ Il dispositivo può essere utilizzato con altri gateway che supportano il protocollo wireless ZigBee 3.0. Le informazioni dettagliate sono conformi al prodotto finale.

## Istruzioni per l'uso

### 1. Scarica la APP



### 2. Togliere il rivestimento isolante della batteria

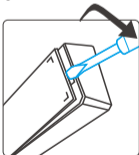

>

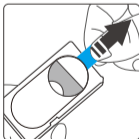



### 3. Aggiungere sotto-dispositivi

ⓘ Collegare il Gateway prima di aggiungere il sotto-dispositivo.

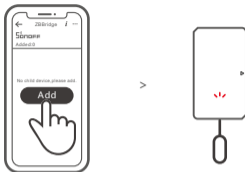

Accedere all'APP eWeLink, selezionare il Gateway che si vuole collegare e toccare "Add" per aggiungere un sotto-dispositivo. Quindi premere a lungo il pulsante di reset sul dispositivo per 5s fino a quando l'indicatore LED non lampeggia tre volte; questo segnale indica che il dispositivo è entrato nella modalità di associazione. Attendere fino al completamento dell'operazione.

ⓘ Se l'operazione di associazione non dovesse andare a buon fine, avvicinare il sotto-dispositivo al Gateway e riprovare.

## Specifiche

Modello	SNZB-04
Batteria modello	CR2450(3V)
Connessione wireless	ZigBee (IEEE 802.15.4)
Corrente di riposo	<2uA
Corrente emessa	<15mA
Distanza di installazione	<10mm
Temperatura di funzionamento	-10°C~40°C
Umidità di esercizio	10-90%HR (senza condensa)
Materiale	PC
Dimensioni	Trasmettitore: 47x27x13.5mm Magnete: 32x15.6x13mm

## Introduzione al prodotto

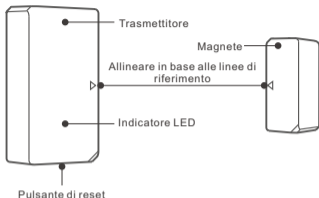

## Caratteristiche

SNZB-04 è un sensore wireless ZigBee a basso consumo energetico per porte/finestre che consente di conoscere lo stato di apertura/chiusura di porte e finestre attraverso la separazione del magnete dal trasmettitore. Collegatelo con il Gateway e potrete creare una scenografia intelligente per attivare altri dispositivi.



Basso consumo energetico



Notifica di batteria scarica



Scene intelligenti

## SONOFF ZigBee Gateway permette di collegare più sotto-dispositivi contemporaneamente.

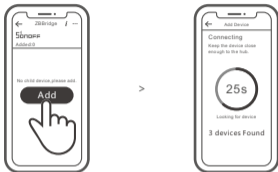

Accendere il Gateway, accedere alla pagina Gateway nell'APP eWeLink e toccare "Add". Quindi impostare il sotto-dispositivo nella modalità di associazione, e attendere fino al completamento della procedura.

## Cancellare i sotto-dispositivi

Premere a lungo il pulsante di reset sul sotto-dispositivo per 5s fino a quando l'indicatore LED lampeggia tre volte. Questo indica che il sotto-dispositivo è stato cancellato con successo dal Gateway.



ⓘ Gli utenti possono cancellare i sotto-dispositivi direttamente dalla pagina dei sotto-dispositivi sull'APP.

## Metodi di installazione

1. Rimuovere la pellicola protettiva dell'adesivo 3M.

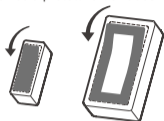

2. Cercare di allineare la linea di riferimento sul magnete con quella del trasmettitore, durante l'installazione.

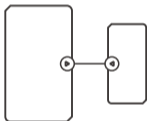

3. Installarli separatamente nell'area di apertura e di chiusura.

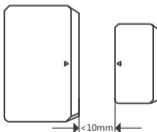

assicurarsi che la distanza di installazione sia inferiore a 10 mm quando la porta o la finestra sono chiuse.

Il peso del dispositivo è inferiore a 1 kg.

Si raccomanda un'altezza di installazione inferiore a 2 m.

## Application

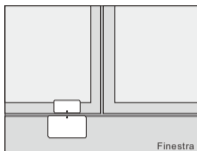
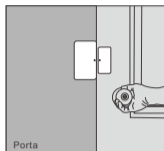

### Nota:

- Non installare all'esterno della porta/finestra.
- Non installare in condizioni instabili o in luoghi esposti alla pioggia o all'umidità.
- Non installare in prossimità di cavi od oggetti magnetici.

Устройством можно управлять интеллектуально посредством шлюза SONOFF производства компании ZigBee для обмена данными с другими устройствами.

⚠ Устройство может работать с другими шлюзами, поддерживающими беспроводной протокол ZigBee 3.0. Подробная информация соответствует характеристикам конечного изделия.

## Инструкция по эксплуатации

### 1. Скачать приложение



### 2. Извлеките изоляционный лист аккумулятора

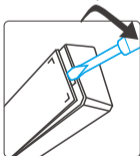

>

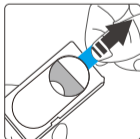

### 3. Добавьте суб-устройства

ⓘ Подключите шлюз перед добавлением суб-устройства.

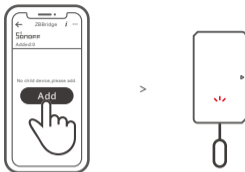

Осуществите доступ к приложению eWeLink, выберите шлюз, который желаете подключить, и коснитесь «Добавить», чтобы добавить суб-устройство. Затем выполняйте долгое нажатие кнопки сброса на устройстве в течение 5 секунд, пока светодиодный индикатор не мигнет трижды. Это означает, что устройство перешло в режим установки соединения, затем ждите завершения процесса установки соединения.

ⓘ Если добавление не удалось, переместите суб-устройство ближе к шлюзу и повторите попытку.

## Технические характеристики

Модель	SNZB-04
Модель батарейки	CR2450(3V)
Беспроводное соединение	ZigBee (IEEE 802.15.4)
Ток в рабочей точке	<2uA
Ток эмиссии	<15mA
Установочный зазор	<10mm
Рабочая температура	-10°C~40°C
Рабочая влажность	10-90% относительной влажности (без образования конденсата)
Материалы	PC
Размеры	Передатчик: 47x27x13.5 мм Магнит: 32x15.6x13 мм

## Знакомство с изделием

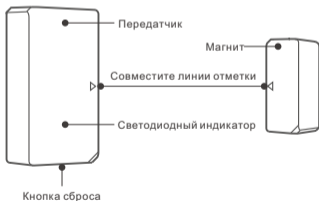



## Функции

SNZB-04 — это беспроводной датчик двери/окна ZigBee с низким потреблением энергии, сообщающий о состоянии открытия/закрытия двери и окна посредством отделения магнита от передатчика. Подключив его к шлюзу, вы сможете создать интеллектуальную сцену для запуска других устройств.



Низкое  
энергопотребление



Уведомление  
о низком заряде  
аккумулятора



Смарт-сюжеты

Шлюз SONOFF ZigBee поддерживает одновременное подключение нескольких суб-устройств.

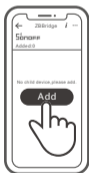

>



Включите питание шлюза, осуществите доступ к странице шлюза в приложении eWeLink и коснитесь «Добавить». Затем настройте суб-устройство для установки соединения в режиме установки соединения и ждите завершения процесса установки соединения.

## Удаление суб-устройств

Выполняйте долгое нажатие кнопки сброса на суб-устройстве в течение 5 секунд, пока светодиодный индикатор не мигнет трижды. В этом случае суб-устройство успешно удалено из шлюза.



- ⓘ Пользователи могут удалять суб-устройства непосредственно на странице суб-устройств в приложении.

## Способы установки

1. Оторвите защитную пленку наклейки 3М.

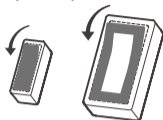

2. Во время установки попытайтесь совместить линию отметки на магните с линией на передатчике.

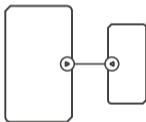

3. Устанавливайте их в области открытия и закрытия отдельно.

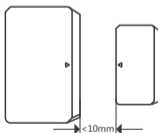

зазор при установке должен быть менее 10 мм, когда закрыта дверь или окно.

Вес устройства составляет менее 1 kg.

Рекомендуется устанавливать устройство на высоте менее 2 м.

## Применение

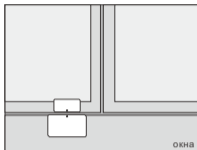

Примечание:

- Не устанавливайте снаружи двери/окна.
- Не устанавливайте в неустойчивом положении или в месте, подверженном воздействию дождя либо влаги.
- Не устанавливайте поблизости от проводки или предмета, обладающего магнитными свойствами.

O dispositivo pode ser operado de maneira inteligente através do trabalho com o SONOFF ZigBee Bridge para se comunicar com outros dispositivos.

ⓘ O dispositivo pode funcionar com outras entradas que suportam o protocolo sem fio ZigBee 3.0. Informações detalhadas estão de acordo com o produto final.

## Instrução de Operação

### 1. Baixe o APP



### 2. Retire a plástico de isolamento da bateria

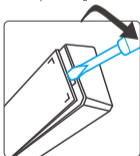

>

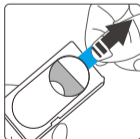

### 3. Adicionar sub-dispositivos

ⓘ Conecte o Bridge antes de adicionar o sub-dispositivo.

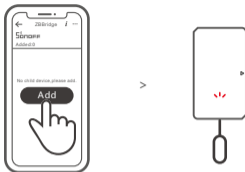

Acesse o aplicativo eWeLink, selecione o Bridge que você deseja conectar e toque em "Adicionar" para adicionar um sub-dispositivo. Em seguida, pressione e segure o botão de reset no dispositivo por 5s até o indicador LED piscar três vezes, o que significa que o dispositivo entrou no modo de emparelhamento e seja paciente até que o emparelhamento seja concluído.

ⓘ Se a adição falhar, mova o sub-dispositivo para mais perto do Bridge e tente novamente.

## Parâmetros do produto

Modelo	SNZB-04
Modelo de bateria	CR2450(3V)
Conexão sem fio	ZigBee (IEEE 802.15.4)
Corrente estático	<2uA
Corrente de emissão	<15mA
Distância de instalação	<10mm
Temperatura de trabalho	-10°C~40°C
Umidade de trabalho	10-90% RH (sem condensação)
Material de revestimento	PC
Dimensão	Transmissor: 47x27x13.5mm Magnético: 32x15.6x13mm

## Introdução ao produto

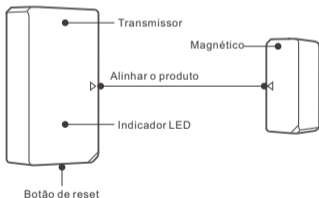

## Características

O SNZB-04 é um sensor sem fio de porta / janela ZigBee de baixo consumo, que faz você saber o status de abertura / fechamento de porta e janela, separando o ímã do transmissor. Conecte-o ao Bridge e você poderá criar uma cena inteligente para acionar outros dispositivos.



Baixo consumo



Notificação de bateria  
fraca



Cenas inteligentes

O SONOFF ZigBee Bridge suporta a conexão de vários sub-dispositivos ao mesmo tempo.



>



Ligue o Bridge, acesse a página do Bridge no APP eWeLink e toque em "Adicionar". Em seguida, defina o sub-dispositivo para emparelhar com o modo de emparelhamento e seja paciente até que o emparelhamento seja concluído.



## Excluir sub-dispositivos

Mantenha pressionado o botão de reset no sub-dispositivo por 5s até o indicador LED piscar três vezes. Nesse caso, o sub-dispositivo é excluído com sucesso.



ⓘ os usuários podem excluir sub-dispositivos diretamente da página de sub-dispositivos no APP.

## Métodos de instalação

1. Retire o adesivo de proteção do 3M.

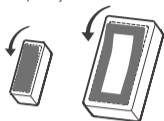

2. Tente alinhar a marca de linha do ímã com a do transmissor durante a instalação.

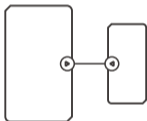

3. Instale-os na área de abertura e fechamento separadamente.

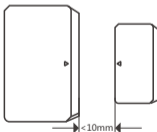

Certifique-se de que o espaço da instalação, quando portas ou anelas estiverem fechadas, seja de pelo menos 10mm.

O peso do dispositivo é inferior a 1 kg.

Recomenda-se uma altura de instalação inferior a 2 m.

## Aplicação

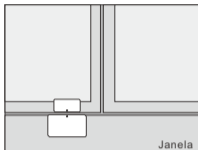
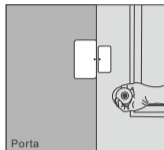

Nota:

- Não instale fora da porta / janela.
- Não instale na posição instável ou em locais expostos à chuva ou umidade.
- Não instale próximo a fiação ou objeto magnético.

## FCC Warning

Changes or modifications not expressly approved by the party responsible for compliance could avoid the user's authority to operate the equipment.

This device complies with part 15 of the FCC Rules. Operation is subject to the following two conditions: (1) This device may not cause harmful interference, and (2) this device must accept any interference received, including interference that may cause undesired operation.

### **FCC Radiation Exposure Statement:**

This equipment complies with FCC radiation exposure limits set forth for an uncontrolled environment. This equipment should be installed and operated with minimum distance 20cm between the radiator & your body. This transmitter must not be co-located or operating in conjunction with any other antenna or transmitter.

### **Note:**

This equipment has been tested and found to comply with the limits for a Class B digital device, pursuant to part 15 of the FCC Rules. These limits are designed to provide reasonable protection against harmful interference in a residential installation. This equipment generates, uses and can radiate radio frequency energy and, if not installed and used in accordance with the instructions, may cause harmful interference to radio communications. However, there is no guarantee that interference will not occur in a particular installation. If this equipment does cause harmful interference to radio or television reception, which can be determined by turning the equipment off and on, the user is encouraged to try to correct the interference by one or more of the following measures:

- Reorient or relocate the receiving antenna.
- Increase the separation between the equipment and receiver.
- Connect the equipment into an outlet on a circuit different from that to which the receiver is connected.
- Consult the dealer or an experienced radio/TV technician for help.

Hereby, Shenzhen Sonoff Technologies Co., Ltd. declares that the radio equipment type SNZB-04 is in compliance with Directive 2014/53/EU. The full text of the EU declaration of conformity is available at the following internet address:

<https://www.sonoff.tech/usermanuals>

**TX Frequency:**

ZigBee: 2405-2480MHz

**MAX PER:**

2.21(2405MHz) ' 2.16(2480MHz)

**SONOFF**

**Shenzhen Sonoff Technologies Co., Ltd.**

1001, BLDG8, Lianhua Industrial Park, shenzhen,  
GD, China

ZIP code: 518000

Website: [sonoff.tech](https://www.sonoff.tech)

MADE IN CHINA

