

SPINDECK MAX

FULLY AUTOMATIC BELT-DRIVEN TURNTABLE

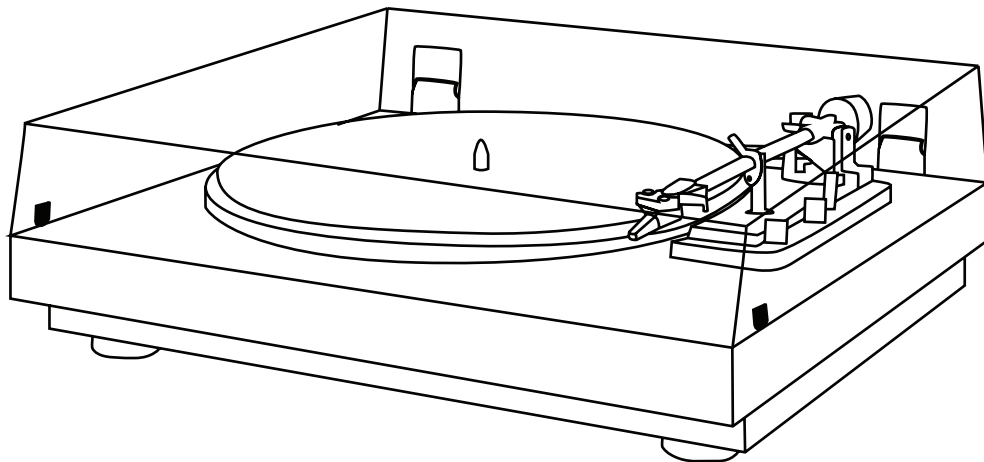

Table of Contents

Introduction / Safety notes.....	3
Operating Controls.....	4
To Set-up your Spindeck MAX.....	5-6
Useful Tips.....	7
Specifications / Cartridge Replacement	8
In Case of Difficulty.....	9
Customizing Your Experience.....	10
30-Day Guarantee / Warranty / Service.....	12

Thanks for selecting Spindeck MAX!

Your Spindeck MAX has been painstakingly designed to treat your valuable records with great care and provide exceptional sound quality with the ultimate convenience of fully automatic operation.

Spindeck has been custom crafted for us in Germany by one of the most respected manufacturers of high-fidelity turntables with over 60 years of experience. Unlike many automatic turntables, the low-mass tonearm of Spindeck MAX provides the vanishingly low friction provided by precision bearings necessary to allow the phono cartridge to perform at its best.

We know you are anxious to get spinning, but please take a few moments to read through this booklet to get the most enjoyment from your Spindeck MAX. If you have any questions not covered here please contact Andover Audio support via email (support@andoveraudio.com).

Getting Started

Spindeck comes with a cartridge pre-mounted and all critical adjustments factory set. No user adjustment is necessary. To setup Spindeck, you only have to remove the packing materials and install the platter and dust cover. Then plug it into your system and you're ready to play.

Check for Damage

Your turntable was shipped partially disassembled with transportation locks in place to avoid damage to sensitive parts. Please check to make sure that neither the packaging nor the device was damaged in transit. If you are missing parts, or if the unit is damaged, please do not operate it and contact either your dealer or support@andoveraudio.com.

Safety instructions

The power adapter is used to connect and disconnect the unit from the main power. Make sure that the plug is easily accessible at all times. Hold the plug when unplugging the power cord. Never handle the power cord while your hands are wet or damp.

Avoid letting liquids enter the device. Never place any item containing liquid, like a flower vase, on or near the device. Never spill any liquid on the device. Never place any open flame sources, like lighted candles, on or near the device. The product shall not be used in damp or wet locations, next to a bathtub, sink, swimming pool or any other similar conditions.

Keep plastic bags away from children to prevent any risk of suffocation.

Operating controls



Cueing Lever - Use to gently raise and lower the tonearm manually.

Armrest Latch - Make certain this latch is released before using. Snap the latch closed whenever the turntable must be moved for any reason. We also recommend keeping the latch closed whenever the Spinbase MAX is not being used to prevent the arm from accidentally being knocked off the armrest.

Speed Selector - Simultaneously selects speed and record size for the automatic mechanism. 33RPM sets the automatic start for 12" LP's. 45 RPM sets the auto-start for 7" records. Other sizes may be played by moving the arm into position manually.

Function selector - Flip towards the front for automatic start, and flip to the rear to stop playback.

Manual Play - Moving the tonearm from the rest position will start the motor. Returning the arm to the rest will stop the motor.

To Set-up your Spindeck MAX

1. Remove the two transportation locks (Fig. 1) by applying lateral pressure. The locks are located on the floating subchassis at the front left and at the rear right.

IMPORTANT: Please retain these locks and reinstall them whenever your Spindeck MAX requires shipment.

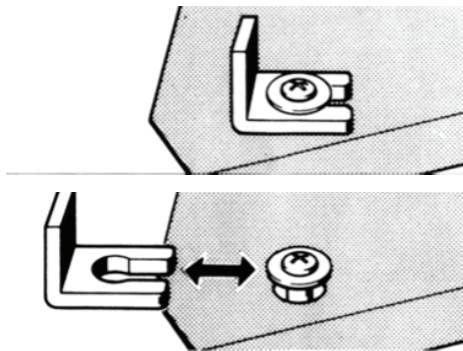

2. Place the platter over the center spindle and press down until the two wire springs snap into the groove of the spindle. Place the felt mat on the platter.

IMPORTANT: If your Spindeck MAX ever requires shipment, please remove the platter and place it under the turntable in the carton. If this is not done the platter may become dislodged in shipment and cause damage to the tonearm, dustcover or cartridge.

Press the spring wires until they click into the spindle groove.

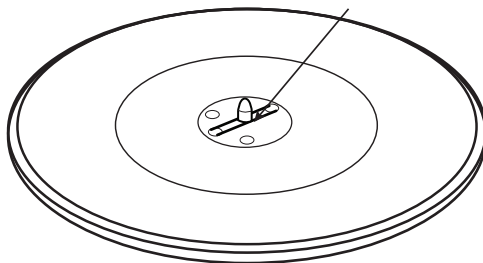

3. Insert the two cover hinges into the slots at the rear edge of the plinth. Slide the notches in the cover into the slots at the top edge of the hinges.

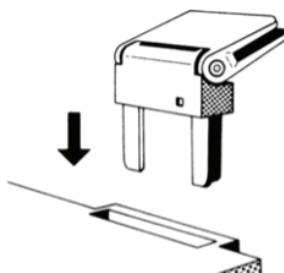

Connect Spindeck MAX to your Audio System

Spindeck MAX requires a phono input suitable for use with a magnetic cartridge. Line-level inputs (such as Aux, CD, Tuner, Tape or Video) are not suitable. If your amplifier does not have a suitable Phono input you will need a separate phono preamplifier stage for magnetic cartridges connected between the Spindeck MAX and a free line level input of the amplifier. Contact your dealer or support@andoveraudio.com if you need help choosing an appropriate preamplifier. Andover's Spinbase products are all equipped with an appropriate input.

Spindeck has a captive tonearm signal lead for connection to the amplifier. The plug with the red band or with an "R" marking should be attached to the RIGHT channel input jack, and the plug with the white band or "L" marking is the LEFT channel.

The third individual wire is a GROUND wire. Connect this to the ground screw on Spinbase or compatible amplifier. If your amplifier does not have a ground screw, slip it under one of the screws which hold the amplifier chassis together and tighten it securely. Leaving this wire unattached will result in excessive hum.

Connect it to Power

The turntable is supplied with a power adapter. Plug the power adapter into the DC power jack at the rear of Spindeck first, then plug the adapter into your AC power.

Maintenance and Cleaning

Your record player requires little or no regular maintenance. Remove dust with a slightly moistened antistatic cloth. Never use a dry cloth because this will create static electricity which will attract more dust! Antistatic cleaning fluids are available at specialist stores but must be applied sparingly to avoid damage to rubber parts. To avoid damage it is recommended to fit the stylus cover before cleaning or maintenance is carried out. If the player is not used over an extended period of time, the drive belt should be removed to prevent unequal stretching.

Useful Tips

Spindeck MAX should be positioned on a low-resonance surface such as wood, MDF, or multiple layer plywood board to avoid structural vibrations disturbing replay. The Andover Spinbase products have been specifically designed to provide a stable, solid support that perfectly compliments Spindeck MAX.

Turntables and vinyl LP's require a gentle touch to maximize performance and longevity. Following these guidelines will result in years of noise-free, reliable performance.

- Do not handle records by the grooved areas. Grasp them by the edges, or by balancing the label on your thumb and steadying it with your forefinger at the edge of the record. Fingerprint oils attract dust which increases wear and adds noise.
- Invest in a good record cleaning brush and use it prior to each play.
- Invest in a quality residue-free record cleaning system. Use it after every few plays or as needed.
- Always place your records back in their protective sleeves immediately after each use. Never leave them laying around unprotected.
- Always store your records vertically, and away from heat and sunlight.
- Whenever possible, use the arm lift (a.k.a. cueing lever) to gently raise and lower the stylus to the record surface.
- Clean the stylus regularly using a soft brush, or by blowing on it. Always brush from back to front. NEVER brush from side to side or front to back or the stylus will be damaged.
- Never play a record with a bent, misaligned, or damaged stylus as this can permanently damage your record.

Technical Specifications

Spindeck MAX

Nominal speeds	33.33/45 r.p.m.
Wow and flutter	<0.04% RMS
Signal to noise	-65dB Weighted
Effective tonearm length	211 mm
Overhang	19.5 mm
Signal cable capacitance	160pF
Power consumption	12V DC / 1.5W
Power adapter	Suitable for USA/Canada
Dimensions (W x H x D)	420 x 119 x 360 mm (WxHxD)

Ortofon OM10 phono cartridge

Frequency range	20-20,000Hz
Channel separation	22dB/1kHz
Output voltage	4.0mV
Recommended load impedance	47kohms/200-600pF – MM-input
Compliance/stylus type	20µm/mN – Elliptical
Recommended tracking force	1.25 - 1.75g
Weight	5g
Replacement Stylus	Stylus 10

Cartridge replacement

Your Spindeck MAX is engineered to be simple, easy to use, and requires no adjustment.

In the unlikely event that phono cartridge replacement becomes necessary, we recommend replacement with a similar Ortofon OM series cartridge, as tracking force adjustment is not possible.

If a model from the recommended OM series is unavailable, we suggest a cartridge with a weight of 5 grams, and a recommended tracking force of between 1.25g and 2g. Any additional cartridge weight above 5 grams will be added to the tracking force. For example, if the new cartridge weighs 5.5g, the effective tracking force will increase by 0.5g.

If any changes are made, a stylus force gauge, available from many sources, should be used to confirm that the actual tracking force is within the range recommended by the cartridge manufacturer.

In Case of Difficulty

Your Spindeck MAX is manufactured to the highest standards and underwent strict quality inspection before leaving the factory. Despite this, you may encounter difficulty due to improper installation, connection, or shipping damage. The following are a few examples, and their most likely causes.

The platter doesn't turn although the unit is powered on:

- The unit is not properly connected to the main power supply.
- There is no power at the wall outlet.
- Drive belt is not fitted or has slipped off the motor pulley or platter.

No signal through one or both channels:

- No signal contact from the cartridge to the internal tonearm wiring. Check that the four small wires attached to the rear of the cartridge are attached and no wires are faulty.
- Faulty contact between the Tonearm and the Phono input on your Spinbase or amplifier. Make certain both plugs are firmly and fully inserted.
- The unit is not connected to a phono input designed for a magnetic cartridge. Line or Aux inputs are not suitable. If you do not have a magnetic phono input on your amplifier a separate phono preamp is required. Contact Andover Audio, or your dealer, for a suitable preamp.
- Amplifier is not switched on, or an incorrect input is selected. If using a vintage amplifier, make sure the "Tape Monitor" switch is not engaged.

Stong hum on phono input:

- No ground connection to amplifier. (Note that due to the high gain required of phono circuits, it is normal to have a higher background noise level than typical auxiliary line-level sources such as CD players, DACs, or radio tuners.)

Distorted or inconsistent sound from one or both channels:

- The tracking force may be insufficient or excessive.
- The stylus or cantilever may be damaged.
- There may be too much dust on the stylus.
- The stylus may not be fully seated in the cartridge body.

Customize your Vinyl Experience

Vinyl playback technology offers the ability to customize your experience. Various accessories are available to allow you to tune the sound and operation to your taste. Here are a few examples that may be available on www.andoveraudio.com, or from your dealer:

Platter Mats: Changing the platter mat to a different material can alter the sound in ways you may like. The stock felt mat provides good balanced performance, but some users prefer a leather or cork mat, claiming that they alter the sound in positive ways and reduce static build-up.

Damping weight: The use of a record damping weight can help stabilize the disc and reduce undesired vibrations. The Andover Spinweight is designed to provide proper damping, without being too heavy, so it will not cause excessive bearing wear on your turntable.

Stylus upgrades: The Ortofon cartridge that comes with your Spindeck MAX may be upgraded by simply replacing the stylus. Step-up stylus models within the Ortofon OM lineup may provide improved sound and tracking ability. You may want to consider upgrading when it becomes time to change your stylus. Always use a genuine Ortofon replacement stylus to guarantee optimum performance.

30-Day Satisfaction Guarantee for Orders placed on Andoveraudio.com

We are so convinced that you will love your new Andover product that if you are dissatisfied in any way, you may return your unit (purchased through www.andoveraudio.com) within 30-days from the time you receive your order for a full refund, minus the cost of any damaged, missing or abused components.

Products purchased through an authorized reseller are governed by the policies of that reseller.

To initiate a return for a unit purchased on our website, please email us at support@andoveraudio.com with the following information:

1. Your order number and product serial number (if applicable).
2. Your reason for returning the item: For example, repair or refund.
3. You will be issued a Return Authorization and a pre-printed shipping label, which must be used to ensure accurate transaction tracking.
4. You are responsible for any missing parts or accessories. Damage due to accident or abuse, or products not returned in their complete original packaging will be subject to restocking and/or replacement fees. Returned items are the customer's responsibility until they reach the return address. A refund will be issued once we receive and have inspected the returned items (normally within 3 business days). Refunds do not include any shipping costs.

Two-Year Warranty

Andover Audio warrants Spindeck products against manufacturing defects and workmanship to the initial purchaser for a period of two (2) years from the date of delivery to customer. Andover Audio will repair or replace the unit as necessary to restore proper operation.

This warranty covers both parts and labor for the warranty period. The warranty excludes physical damage caused by accident or abuse outside of our control. Or if the unit is damaged due to incorrect return packing. The warranty also excludes normal wear items such as the stylus and belt. If you think you need warranty service, please contact us to obtain an RMA (Return Merchandise Authorization) by e-mailing support@andoveraudio.com. For more information on returns and exchanges, please visit www.andoveraudio.com/pages/returns-and-exchanges.

Service

Should you encounter a problem that you are unable to solve, please contact customer service at support@andoveraudio.com, or the dealer that sold you your Spindeck. If you must return your Spindeck for any reason, it must be safely packed and shipped in its original carton and packing material. **Damage that is the result of improper packaging is not covered by the warranty.** Please contact Andover Audio if you need replacement packaging.

Important: Fit the stylus protection cap and the transport lock-tie for the tonearm tube, prior to carefully packaging Spindeck.

Andover Audio, L.L.C.
15 High Street North Andover, Massachusetts 01845
www.andoveraudio.com | support@andoveraudio.com | 978.775.3670

Andover is a registered trademark of Andover Audio L.L.C.
ORTOFON is a registered trademark of ORTOFON S/A.