

ANDOVER-ONE E

TURNTABLE MUSIC SYSTEM

TURNTABLE QUICK SETUP

Your Andover-One E comes with its Ortofon cartridge pre-mounted and adjusted. Therefore minimal setup is required. You only need to remove the screws that secure the turntable in place for shipping, and install the belt and platter.

IMPORTANT: Retain the shipping screws, and all packaging materials in case you ever need to ship your unit for service.

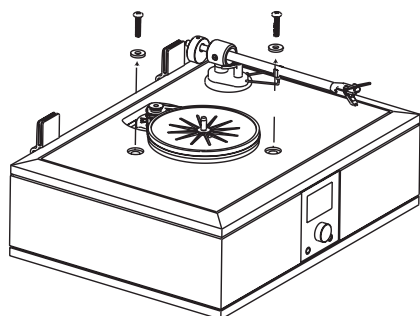

STEP 1 - Remove the Shipping Screws

- Remove the TWO large Philips shipping screws. A Philips screwdriver is included in the accessory package.
- Save the screws and reinstall them whenever shipping or moving the unit to prevent damage.

STEP 2 - Install the Drive Belt

- Install the flat drive belt by stretching it around the inner platter and over the "top step" of the small motor pulley to use with 33 or 45RPM records.
- For use with 78RPM records: Install the round drive belt on the large lower pulley instead.

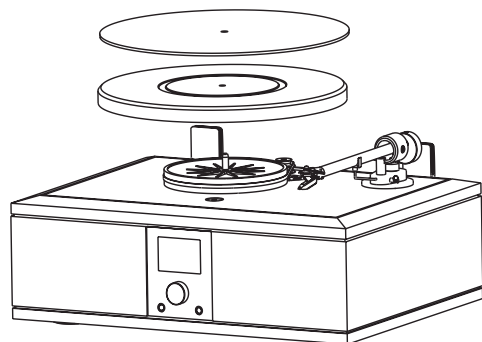
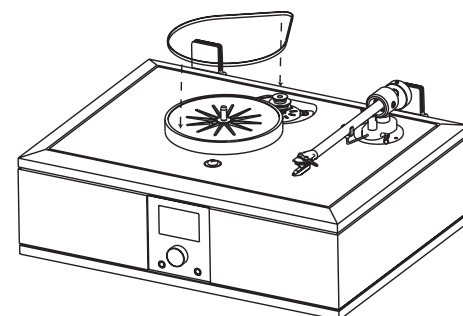

STEP 3 - Install the Platter

- With two hands, gently place the platter on the spindle, followed by the felt platter mat.

STEP 4 - Remove the tie wrap and stylus protector which secured the tonearm for shipping.

Cartridge Tracking Force Adjustment:

There is no need to make any adjustment to the tonearm when using the supplied Ortofon cartridge. The tonearm is pre-set from the factory. Refer to p.15 of the Product Manual if you wish to install a different cartridge, or need to adjust tracking force.

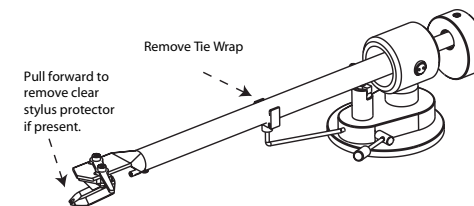

TURNTABLE STROBE DISC

For 60Hz power only

Instructions: Place the strobe disc on the platter.

View under a fluorescent or neon light source to check speed.

The dots will appear stationary when the indicated speed is reached.

33.33 RPM - Outer Ring

45 RPM - Middle Ring

78 RPM - Inner Ring (Actual 78.2)

Note: The correct number of dots for 78RPM @ 60Hz. is not an integer, therefore some slight drift will be apparent.



www.andoveraudio.com

pn 1733RA