

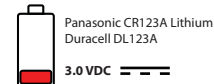

# RF113 SMART RF Wireless Contact

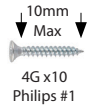

## Installation Guide Rev1.4

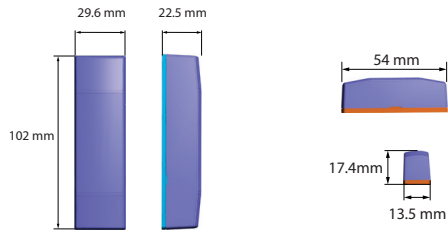

For Further Information  
See Your Control Panel  
Installation Manual

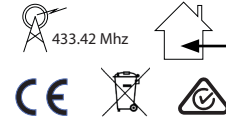

0-93% Relative Humidity  
Non-condensing

Functional range: -10°C to +49°C  
EN5013-5 Class II Only: -10°C to +40°C

### 1 Opening The Housing

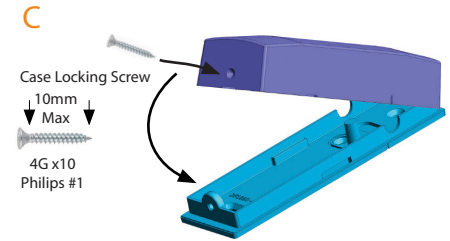
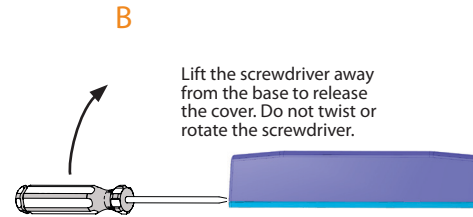
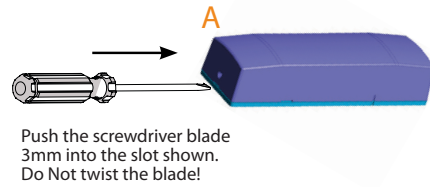

### The RF113 Ships With The Following Items

- RF113 Printed Wiring Assembly
- RF113 Housing Including Cover And Mounting Plate
- Double Sided Adhesive Tape To Suit Above Housing
- Magnet Housing Including Cover And Mounting Plate
- Double Sided Adhesive Tape To Suit Above Housing
- Neodymium Magnet
- CR123A Lithium Battery
- 5 x Mounting Screws and 1 x Case Lock Screw
- RF113IRG Installer Reference Guide

Ensure that the transmitter is protected from weather elements such as extreme temperatures, humidity, rain or snow.

### 2 Mounting

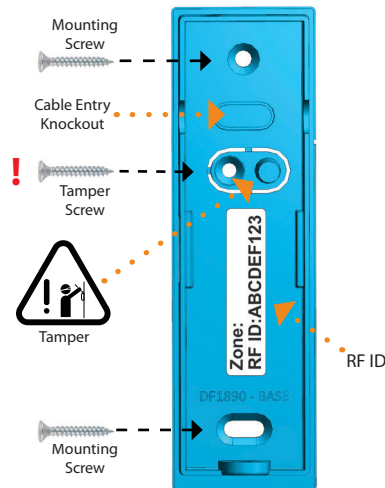

### 3 Battery Installation

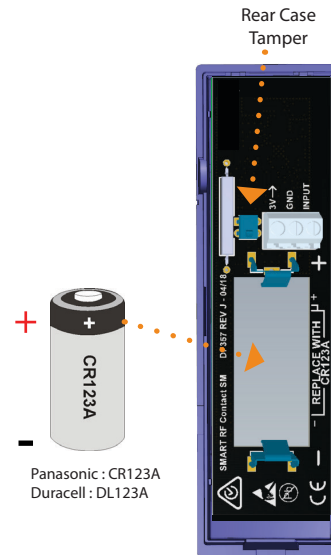

### 4 Wiring

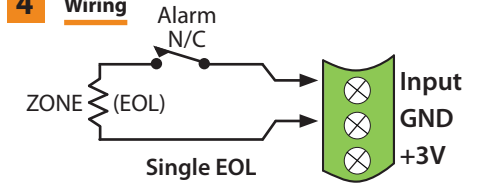

End Of Line Resistor (EOL)  
For further information refer to Control Panel EOL Selection

Wiring Distance = 8m MAX

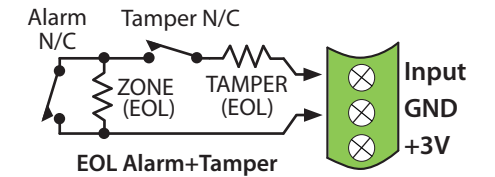

3V D.C. Output  
Powering external devices  
from this output will reduce  
battery life.



**DIGIFLEX PTY LTD**  
 18 Brumby Street  
 Seven Hills NSW 2147, AUSTRALIA  
 Phone: (+612) 97417000  
 Email: sales@digiflex.com.au  
 Web: www.digiflex.com.au  
*Our Vision Is Your Peace Of Mind*

## 7 Magnet Installation

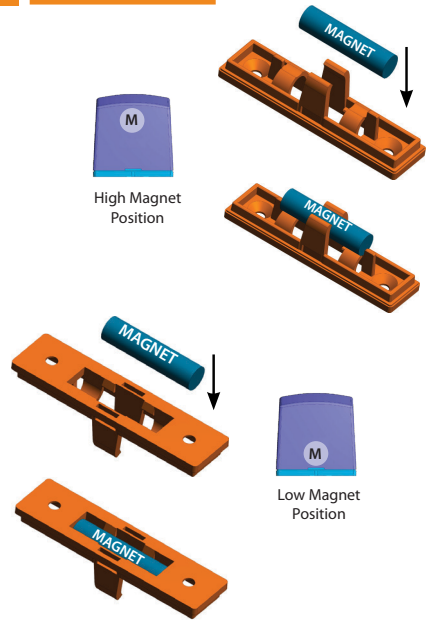

For best performance install the magnet as close as possible to the RF113, and align the centre of the magnet with the alignment mark on the RF113 housing. Use the tables in section 8 as a guide to placement performance in your installation.

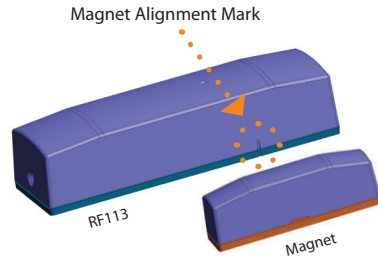

## 9 Using Adhesive Mounting

The RF113 is supplied with a double sided tape mounting option. Use this mounting method to speed installation where appropriate.

Follow the guidelines below for best results.







- 1) Do not use on rough or uneven surfaces.
- 2) Clean both surfaces using isopropyl alcohol wipes before installing tape.
- 3) Test zone function to ensure correct placement before removing backing tape.
- 4) Apply firm pressure to the device for 30 seconds after placement to ensure the adhesive activates. (The adhesive is pressure activated)

## 10 LED Indicator





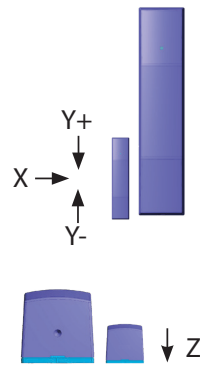

6 Slow Flashes	Device Powered Up
4 Fast Flashes	Device Has been Configured
Continuous Flash	Device TX or RX
Single Pulse	Device Input Triggered

When panel is in service mode and device Tamper is triggered, the LED will activate for up to 15 minutes to assist with device placement and configuration. During normal operation, the LED is off to extend battery life.

## 8 Magnet Placement Guide

Using Side Reed SW			
			
	Alarm to N/C	Metal Surface	Timber Surface
 Magnet In High Position	X	15mm	22mm
	Y	+13mm to -13mm	+13mm to -15mm
	Z	35mm	39mm
 Magnet In Low Position	X	7mm	20mm
	Y	+9mm to -12mm	+13mm to -17mm
	Z	42mm	48mm



Using Side Reed SW			
			
	N/C to Alarm	Metal Surface	Timber Surface
 Magnet In High Position	X	16mm	23mm
	Y	+13mm, -13mm	+13mm, -15mm
	Z	37mm	41mm
 Magnet In Low Position	X	8mm	22mm
	Y	+10mm, -13mm	+13.5mm, -17mm
	Z	43mm	50mm

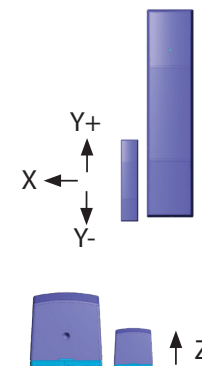

## RF113 Device Specifications

Parameter	Value
Input Types Supported	Single EOL, Alarm+Tamper, Dry Contact or Pulse Counting (Clicker input)
Operating Temp	-10°C to +49°C
Humidity	0% - 93% Non-condensing
Battery	3V CR123A Lithium
Battery Life	Up to 5 years
Frequency	433.42MHz
RF Modulation	FSK
Data Rate	25kbps
Data Encoding	Manchester
Approvals	RCM (ANZ), CE (Europe)