

PRINT MAY BE REDUCED - DO NOT SCALE.

Item #	Part Name	Part No.	Qty
1	LT Lift Hoist	LTU-1COBN5N-001	1
2	LD Guide Rail Complete Assembly	LDU-AUN0AUN-001	1
3	LT Car Body Half Door	LTU-HUVS48CN-001	1
4	LT Shaft Lid Assembly	53102-00207	1
5	LT Floor Insert	35108-00028	1
6	LT Floor Insert Flange	35108-00029	1

Rev	Description	By	Date
A	New Drawing	Wagon	2017/11/06

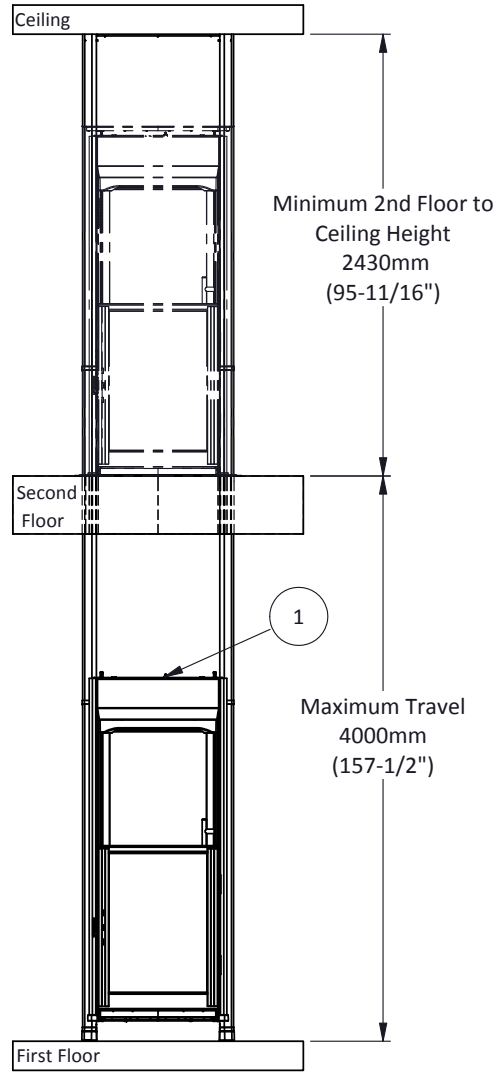

Front View

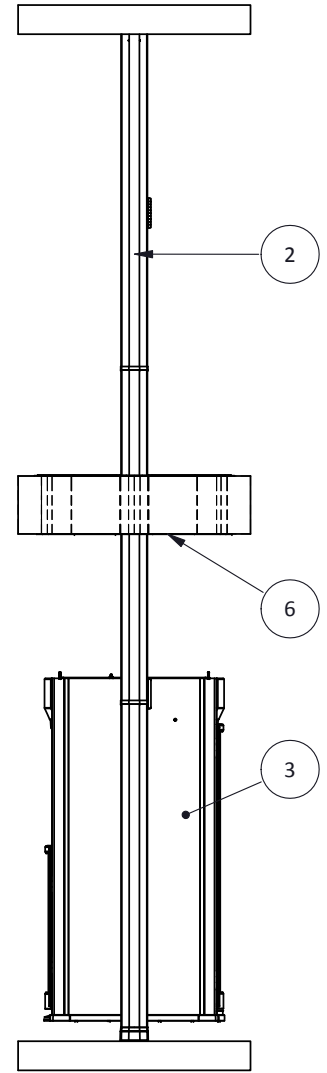

Side View

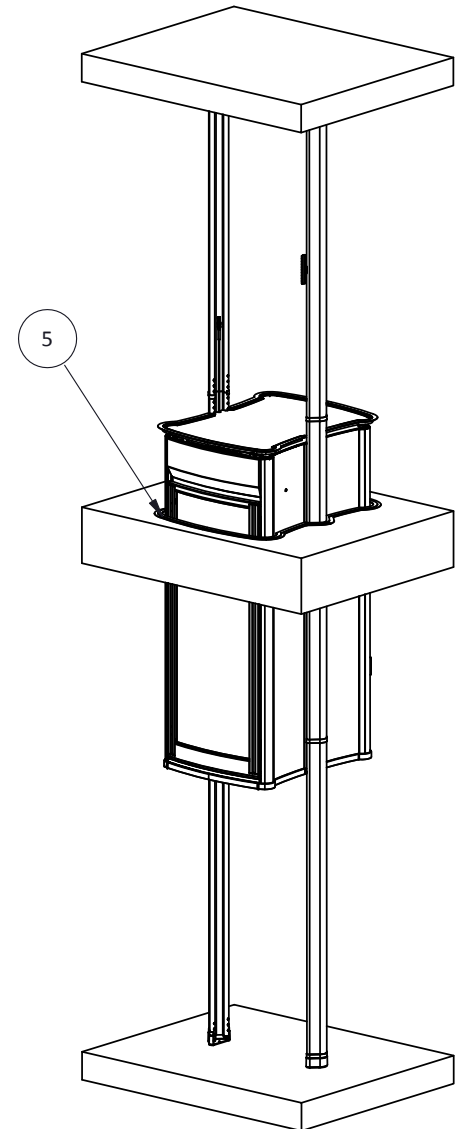
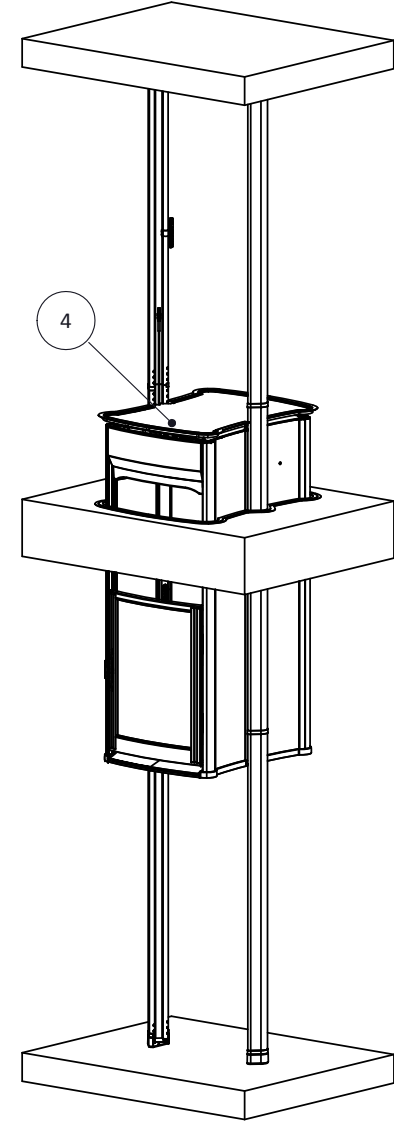

Approved for Manufacture
 By: (Sign)
 Name:.....

GENERAL TOLERANCES (Unless Noted Otherwise):

0-30mm	±0.1	30-120mm	±0.2
120-400mm	±0.3	400-1000mm	±0.5
1000-2000mm	±1.0	>2000mm	±1.5
	Angular		±0.25 Deg.

Break ALL sharp corners and remove burrs or swarf.



Drawn Wagon Wang	Date 2017/11/06
 DIMENSIONS IN MM UNLESS OTHERWISE NOTED THIRD ANGLE PROJECTION - AS 1100	

TITLE	
LT Lift Complete	
A4	Dwg No LTU-CESBU101
SCALE:	PAGE 1 OF 15

PRINT MAY BE REDUCED - DO NOT SCALE.

Rev	Description	By	Date
A	New Drawing	Wagon	2017/05/13

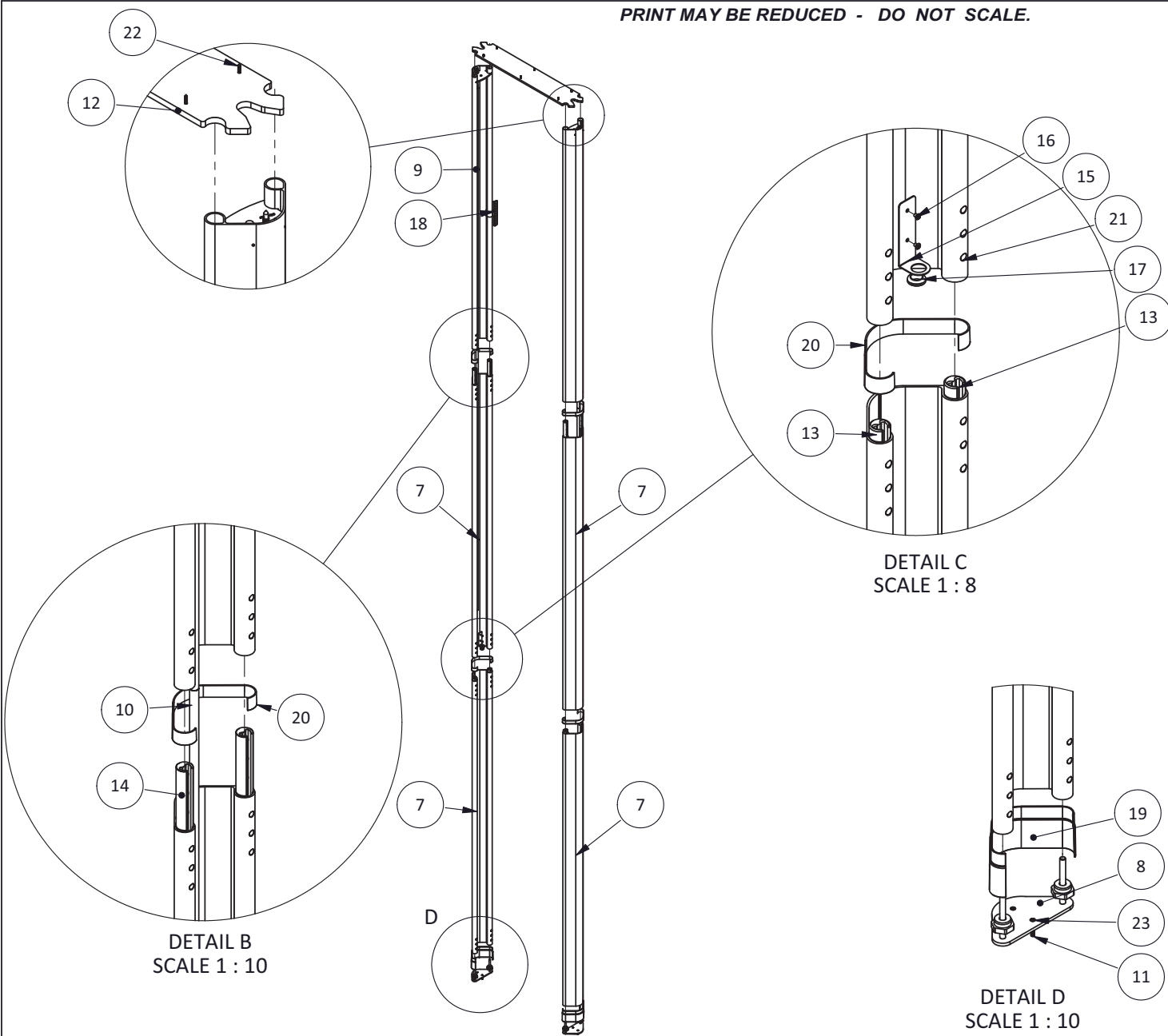

Item #	Part Name	Part No.	Qty
7	Guide Rail Uni 2.3m V.B	25104-00063	4
8	Guide Base Plate Assembly	55102-00025	2
9	Guide Top Rail(7038) 2.3m Assembly	55102-00013	2
10	Lift Gripper Rod Assembly	55102-00020	2
11	Anchor 6x30mm	30110-00001	4
12	Guide Top Spacer V.E	28102-00005	1
13	Guide Rail Short Joiner Assembly	55104-00016	4
14	Guide Rail Long Joiner Assembly	55104-00017	4
15	Gripper Rod Bottom Bracket V.A	35104-00001	2
16	Big Pan Head Blind Rivet $\Phi 9 \times \Phi 3.2 \times 7 \text{mm}$	30108-00002	4
17	Cable Bush 16mm White	10908-00001	2
18	Magnetic Working Limit Assembly	55102-00018	1
19	Guide Rail Base Cover	20101-00036	2
20	Guide rail joint cover	20101-00037	4
21	Hole Plug 8mm	20101-00013	63
22	SS Philips Pan Head Self-tapping screw 4.2x30mm	30101-80727	6
23	SS Philips Csk Head Self-tapping Screw 3.9x32mm	35102-00001	4

Approved for Manufacture
 By: (Sign)
 Name:.....

GENERAL TOLERANCES (Unless Noted Otherwise):

0-30mm	±0.1	30-120mm	±0.2
120-400mm	±0.3	400-1000mm	±0.5
1000-2000mm	±1.0	>2000mm	±1.5
Angular	±0.25 Deg.		

Break ALL sharp corners and remove burrs or swarf.



Drawn Wagon Wang	Date 2017/05/13
 DIMENSIONS IN MM UNLESS OTHERWISE NOTED THIRD ANGLE PROJECTION - AS 1100	

TITLE	
LD Guide Rail Assembly	
A4	Dwg No LDU-AUN0AUN-001
SCALE:	PAGE 2 OF 15

PRINT MAY BE REDUCED - DO NOT SCALE.

Rev	Description	By	Date
A	New Drawing	Wagon	2017/11/07

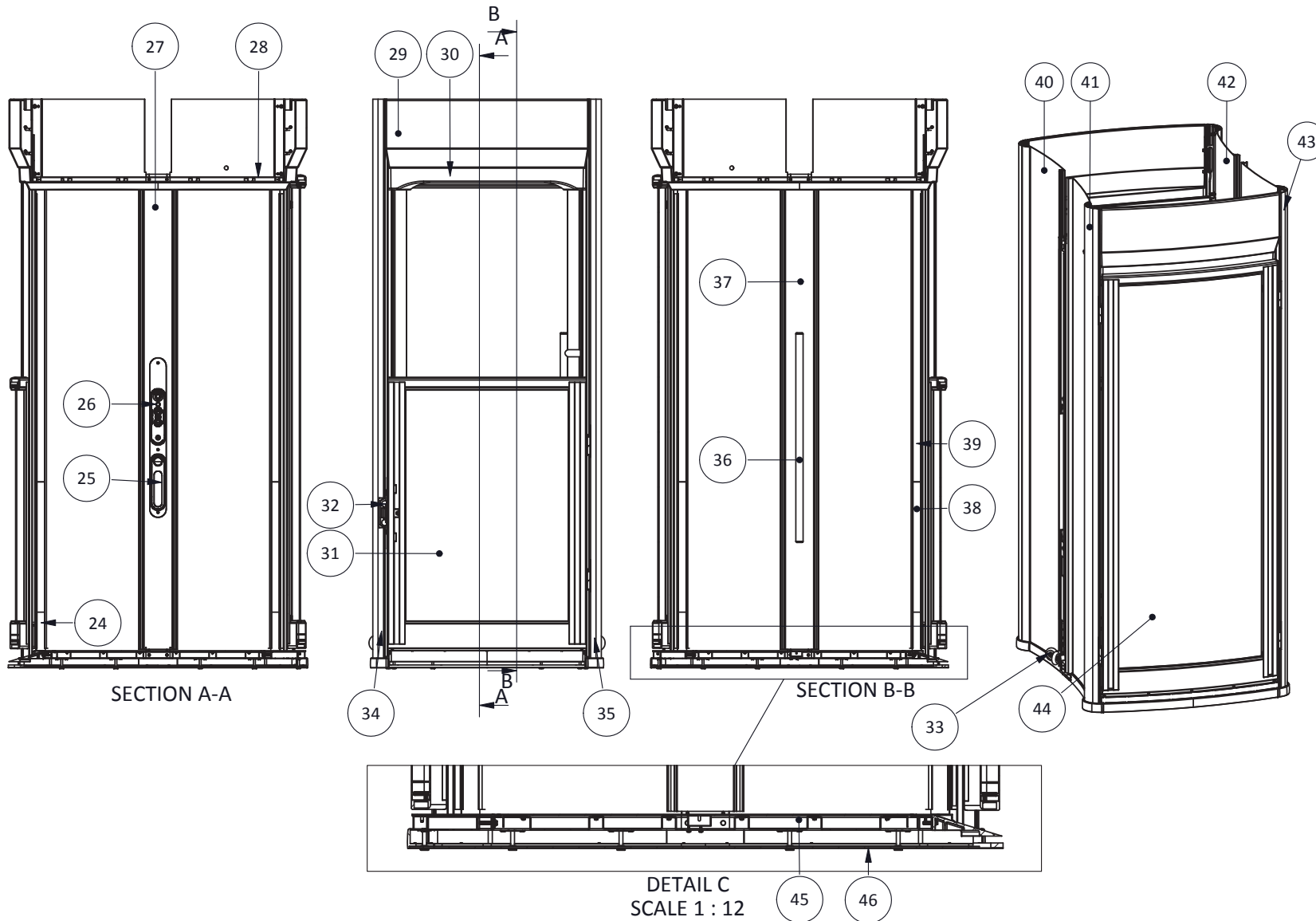

Item #	Part Name	Part No.	Qty
24	LT Corner LED Cover	20102-00024	4
25	LD Phone Case N106	53102-00093	1
26	LD Universal COP Assembly	53104-00047	1
27	LT Extruded Side Channel Clamping LH Assembly	53102-00219	1
28	Lifton Trio Ceiling Hoop Assy	53102-00213	1
29	LT Electrics Cover	20101-00031	1
30	LT Ceiling Panel Assembly	53102-00212	1
31	LT Half Door Assembly	53102-00215	1
32	LD Door Lock	53104-00022	1
33	LD Bottom Guide Roller Bracket Top Plate Assembly	53102-00117	2
34	LT HD Entry Corner Stile Cover Ext Front LH Lock	25104-40092	1
35	LT HD Entry Corner Stile Cover Ext Front RH Hinge	25104-40095	1
36	LT Handrail Assembly	53102-00242	1
37	LT Extruded Side Channel Clamping RH Assembly	53102-00093	1
38	LT Corner Trim 0.61m	20102-00025	4
39	LT Corner Trim 1.22m	20102-00022	4
40	Lifton Trio Entry Side Panel Front RH PC Assy	53102-00211	2
41	LT FD Entry Corner Stile Cover Ext Front LH Hinge	25104-40097	1
42	Lifton Trio Entry Side Panel Front LH PC Assy	53102-00210	2
43	LT FD Entry Corner Stile Cover Ext Front RH Hinge	25104-40099	1
44	LT Rear Door Assembly	53102-00216	1
45	LT Floor Assembly	53102-00214	1
46	LT Safety Pan Assembly	53102-00218	1
47	LT Hinge Cover Strip 286	25104-40104	1
48	LT Hinge Cover Strip 481	25104-40103	1
49	LT Hinge Cover Strip 1176	25104-40102	1
50	LT Hinge Cover Strip 187	25104-40107	2
51	LT Hinge Cover Strip 1520	25104-40105	2
52	LT Hinge Cover Strip 236	25104-40106	2
53	LT Lock Cover Strip 516	25104-40100	1
54	LT Lock Cover Strip 1404	25104-40101	1
55	LT Foot Light Assembly	53104-00038	4

Approved for Manufacture
 By: (Sign)
 Name:.....

GENERAL TOLERANCES (Unless Noted Otherwise):

0-30mm	±0.1	30-120mm	±0.2
120-400mm	±0.3	400-1000mm	±0.5
1000-2000mm	±1.0	>2000mm	±1.5
Angular	±0.25 Deg.		

Break ALL sharp corners and remove burrs or swarf.



Drawn Wagon Wang	Date 2017/11/07
DIMENSIONS IN MM UNLESS OTHERWISE NOTED	
THIRD ANGLE PROJECTION - AS 1100	

TITLE Lifton Trio Car Body Half Door	
A4	Dwg No LTU-HUVS48CN-001
SCALE:	PAGE 3 OF 15

PRINT MAY BE REDUCED - DO NOT SCALE.

Rev	Description	By	Date
A	New Drawing	Wagon	2017/11/07

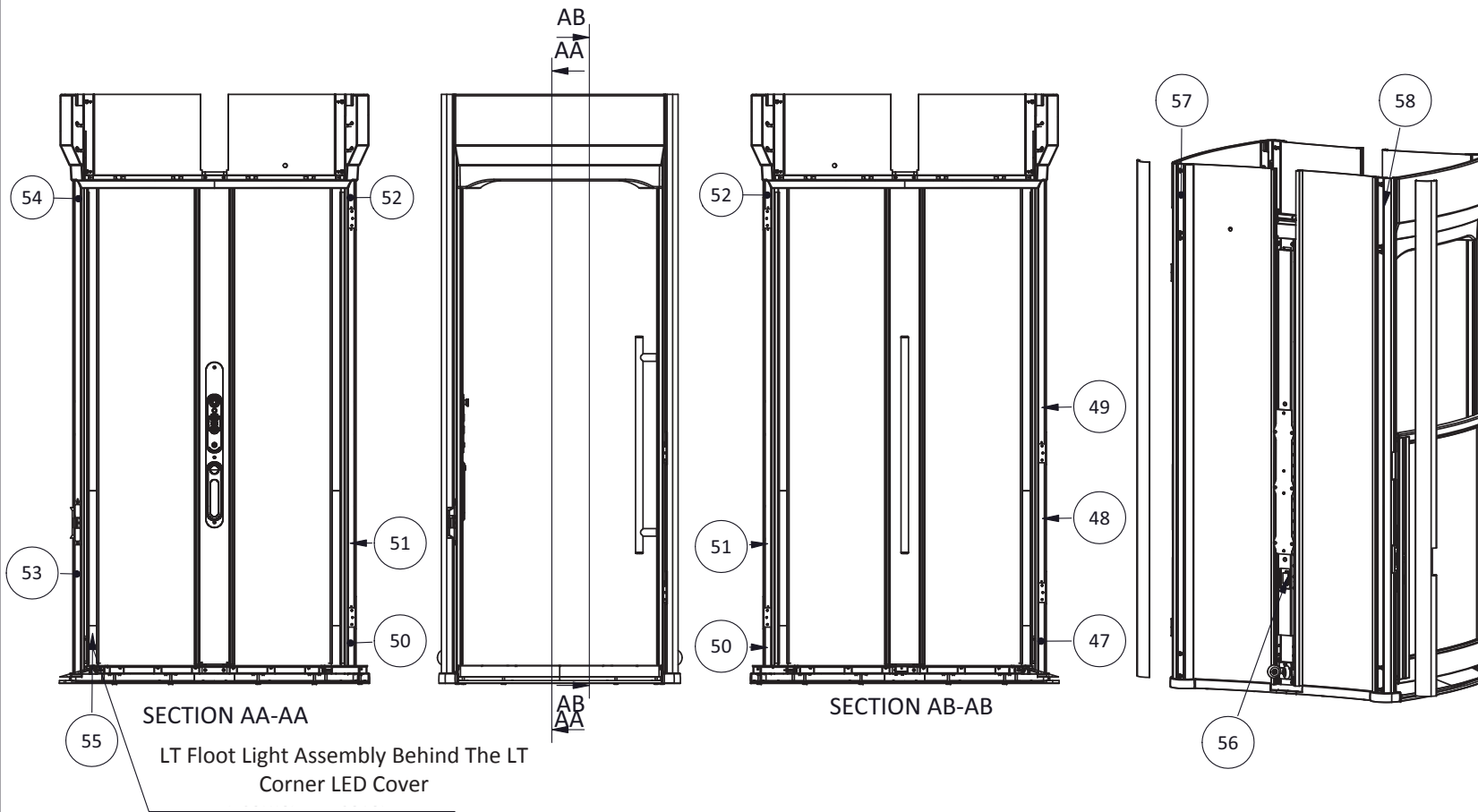

Item #	Part Name	Part No.	Qty
24	LT Corner LED Cover	20102-00024	4
25	LD Phone Case N106	53102-00093	1
26	LD Universal COP Assembly	53104-00047	1
27	LT Extruded Side Channel Clamping LH Assembly	53102-00219	1
28	Lifton Trio Ceiling Hoop Assy	53102-00213	1
29	LT Electrics Cover	20101-00031	1
30	LT Ceiling Panel Assembly	53102-00212	1
31	LT Half Door Assembly	53102-00215	1
32	LD Door Lock	53104-00022	1
33	LD Bottom Guide Roller Bracket Top Plate Assembly	53102-00117	2
34	LT HD Entry Corner Stile Cover Ext Front LH Lock	25104-40092	1
35	LT HD Entry Corner Stile Cover Ext Front RH Hinge	25104-40095	1
36	LT Handrail Assembly	53102-00242	1
37	LT Extruded Side Channel Clamping RH Assembly	53102-00093	1
38	LT Corner Trim 0.61m	20102-00025	4
39	LT Corner Trim 1.22m	20102-00022	1
40	Lifton Trio Entry Side Panel Front RH PC Assy	53102-00211	2
41	LT FD Entry Corner Stile Cover Ext Front LH Hinge	25104-40097	1
42	Lifton Trio Entry Side Panel Front LH PC Assy	53102-00210	2
43	LT FD Entry Corner Stile Cover Ext Front RH Hinge	25104-40099	1
44	LT Rear Door Assembly	53102-00216	1
45	LT Floor Assembly	53102-00214	1
46	LT Safety Pan Assembly	53102-00218	1
47	LT Hinge Cover Strip 286	25104-40104	1
48	LT Hinge Cover Strip 481	25104-40103	1
49	LT Hinge Cover Strip 1176	25104-40102	1
50	LT Hinge Cover Strip 187	25104-40107	2
51	LT Hinge Cover Strip 1520	25104-40105	2
52	LT Hinge Cover Strip 236	25104-40106	2
56	USB Phone Charger Kit	53104-00025	1
57	LT Entry Corner Stile Ext Front RH Rivet Assembly	53102-00226	2
58	LT Entry Corner Stile Ext Front LH Rivet Assembly	53102-00225	2
53	LT Lock Cover Strip 516	25104-40100	1
54	LT Lock Cover Strip 1404	25104-40101	1
55	LT Foot Light Assembly	53104-00038	4

56	USB Phone Charger Kit	53104-00025	1
57	LT Entry Corner Stile Ext Front RH Rivet Assembly	53102-00226	2
58	LT Entry Corner Stile Ext Front LH Rivet Assembly	53102-00225	2

Approved for Manufacture

By: (Sign)
Name:.....

GENERAL TOLERANCES (Unless Noted Otherwise):			
0-30mm	±0.1	30-120mm	±0.2
120-400mm	±0.3	400-1000mm	±0.5
1000-2000mm	±1.0	>2000mm	±1.5
Angular		±0.25 Deg.	

Break ALL sharp corners and remove burrs or swarf.



Drawn	Wagon Wang	Date	2017/11/07
		DIMENSIONS IN MM UNLESS OTHERWISE NOTED	
THIRD ANGLE PROJECTION - AS 1100			

TITLE		Lifton Trio Car Body Half Door	
A4	Dwg No	LTU-HUVS48CN-001	PAGE 4 OF 15
	SCALE:		

PRINT MAY BE REDUCED - DO NOT SCALE.

Rev	Description	By	Date
A	New Drawing	Wagon	2017/11/06

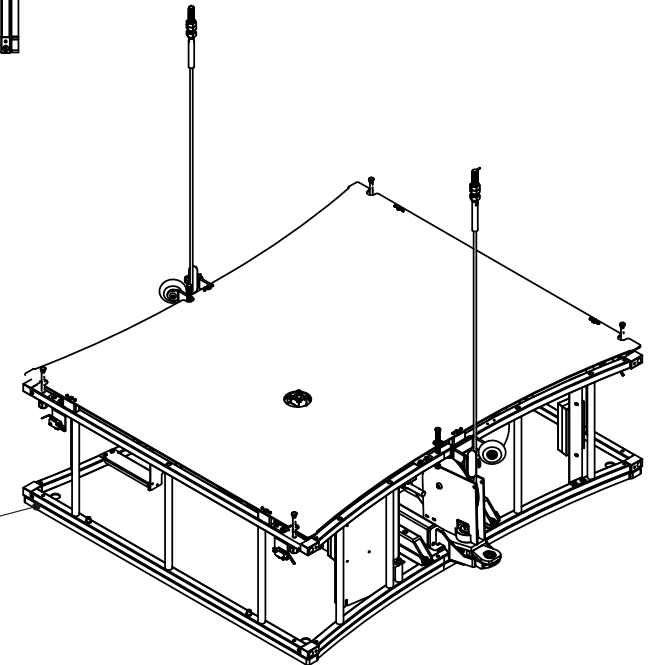
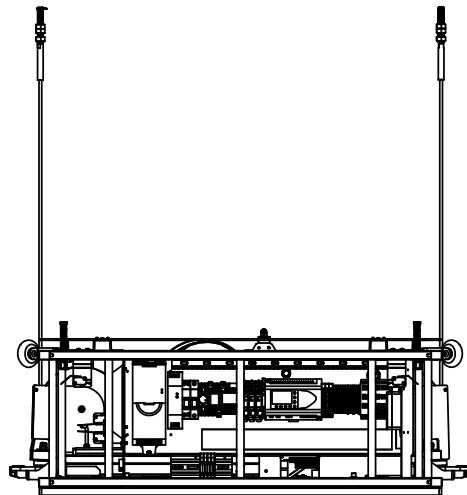
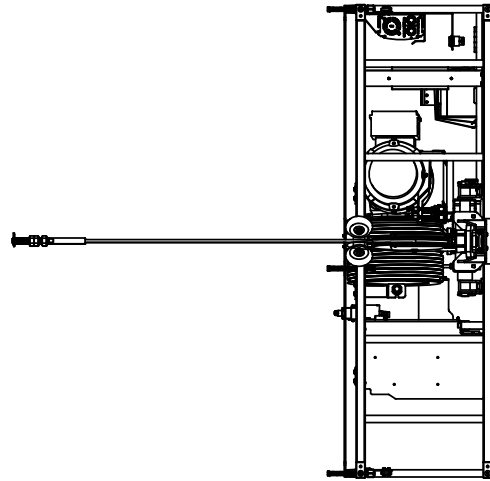
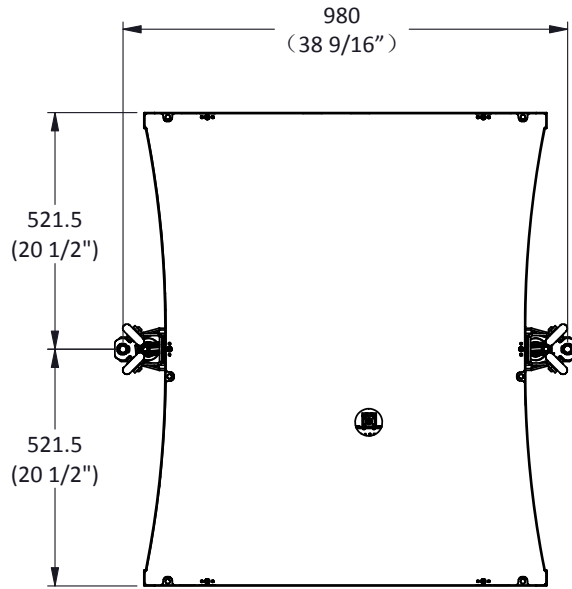

LT Ceiling Protection Panel
P/N:28102-00051
(Befor istall take off it)

Approved for Manufacture

By: (Sign)
Name:.....

GENERAL TOLERANCES (Unless Noted Otherwise):

0-30mm	±0.1	30-120mm	±0.2
120-400mm	±0.3	400-1000mm	±0.5
1000-2000mm	±1.0	>2000mm	±1.5
Angular	±0.25 Deg.		

Break ALL sharp corners and remove burrs or swarf.

Drawn		Date		TITLE	
Wagon Wang		2017/11/06		Lifton Trio Hoist Assembly	
 THIRD ANGLE PROJECTION - AS 1100		DIMENSIONS IN MM UNLESS OTHERWISE NOTED		A4 Dwg No LTU-1C0BN5N-001	
SCALE:				PAGE 5 OF 15	

PRINT MAY BE REDUCED - DO NOT SCALE.

Rev	Description	By	Date
A	New Drawing	Wagon	2017/11/06

Item #	Part Name	Part No.	Qty
59	Rocker Beam Swivel Sheave Assembly	50102-00024	1
60	CTEK Battery Charger With Bracket Assembly	50104-00022	1
61	LT Hoist Electrical Panel Assembly	50103-00009	1
62	LT Hoist Frame Assembly	50102-00096	1
63	Overload Switch Bracket Assembly	50104-00009	1
64	Overload Striker Plate Assembly	50104-00029	1
65	LD Main Switch Assembly	50104-00055	1
66	LT Battery Retainer Bracket Electrical Assembly	50102-00109	1
67	Power Inverter Assembly	50104-00051	1
68	Rope Drum 200 Assembly	50102-00004	1
69	Count Sensor Mount Bracket Assembly	50104-00008	1
70	LD Electromagnetic Switch Assembly	50104-00027	2
71	Interrupt Limit Bolt Assembly 1	50102-00013	4
72	Interrupt Limit Bolt Assembly 2	50102-00014	2
73	Lead Acid Battery 12V	50104-00052	1
74	Duo Guide Roller Assembly	50102-00020	1
75	Lift Wire Rope 6m Assembly	50102-00007	1 Set
76	LT Motor Cover Plate Assembly	53102-00206	1

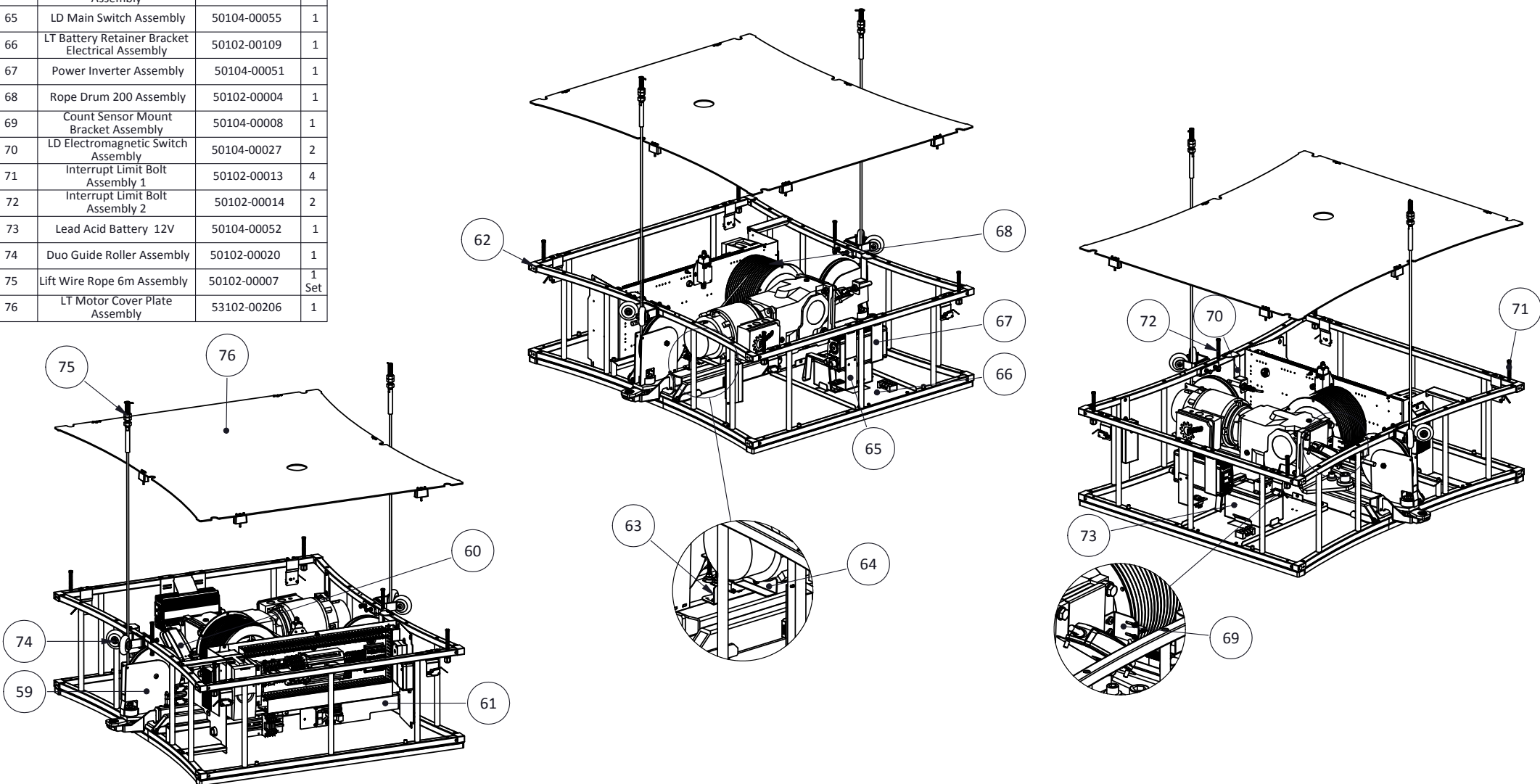

Approved for Manufacture
 By: (Sign)
 Name:.....

GENERAL TOLERANCES (Unless Noted Otherwise):

0-30mm	±0.1	30-120mm	±0.2
120-400mm	±0.3	400-1000mm	±0.5
1000-2000mm	±1.0	>2000mm	±1.5
Angular	±0.25 Deg.		

Break ALL sharp corners and remove burrs or swarf.



Drawn Wagon Wang	Date 2017/11/06
DIMENSIONS IN MM UNLESS OTHERWISE NOTED THIRD ANGLE PROJECTION - AS 1100	

TITLE	
Lifton Trio Hoist Assembly	
A4	Dwg No LTU-1C0BN5N-001
SCALE:	PAGE 6 OF 15

PRINT MAY BE REDUCED - DO NOT SCALE.

Rev	Description	By	Date
A	New Drawing	Wagon	2017/11/06

Item #	Part Name	Part No.	Qty
59	Rocker Beam Swivel Sheave Assembly	50102-00024	1
60	CTEK Battery Charger With Bracket Assembly	50104-00022	1
61	LT Hoist Electrical Panel Assembly	50103-00009	1
62	LT Hoist Frame Assembly	50102-00096	1
63	Overload Switch Bracket Assembly	50104-00009	1
64	Overload Striker Plate Assembly	50104-00029	1
65	LD Main Switch Assembly	50104-00055	1
66	LT Battery Retainer Bracket Electrical Assembly	50102-00109	1
67	Power Inverter Assembly	50104-00051	1
68	Rope Drum 200 Assembly	50102-00004	1
69	Count Sensor Mount Bracket Assembly	50104-00008	1
70	LD Electromagnetic Switch Assembly	50104-00027	2
71	Interrupt Limit Bolt Assembly 1	50102-00013	4
72	Interrupt Limit Bolt Assembly 2	50102-00014	2
73	Lead Acid Battery 12V	50104-00052	1
74	Duo Guide Roller Assembly	50102-00020	2
75	Lift Wire Rope 6m Assembly	50102-00007	1 Set
76	LT Motor Cover Plate Assembly	53102-00206	1
77	Nord GearBox Motor 550W N2 Assembly	50102-00076	1
78	Pivot Pin Assembly	53102-00138	1
79	Interrupt Limit Tag Switch Assembly	50104-00006	1 set

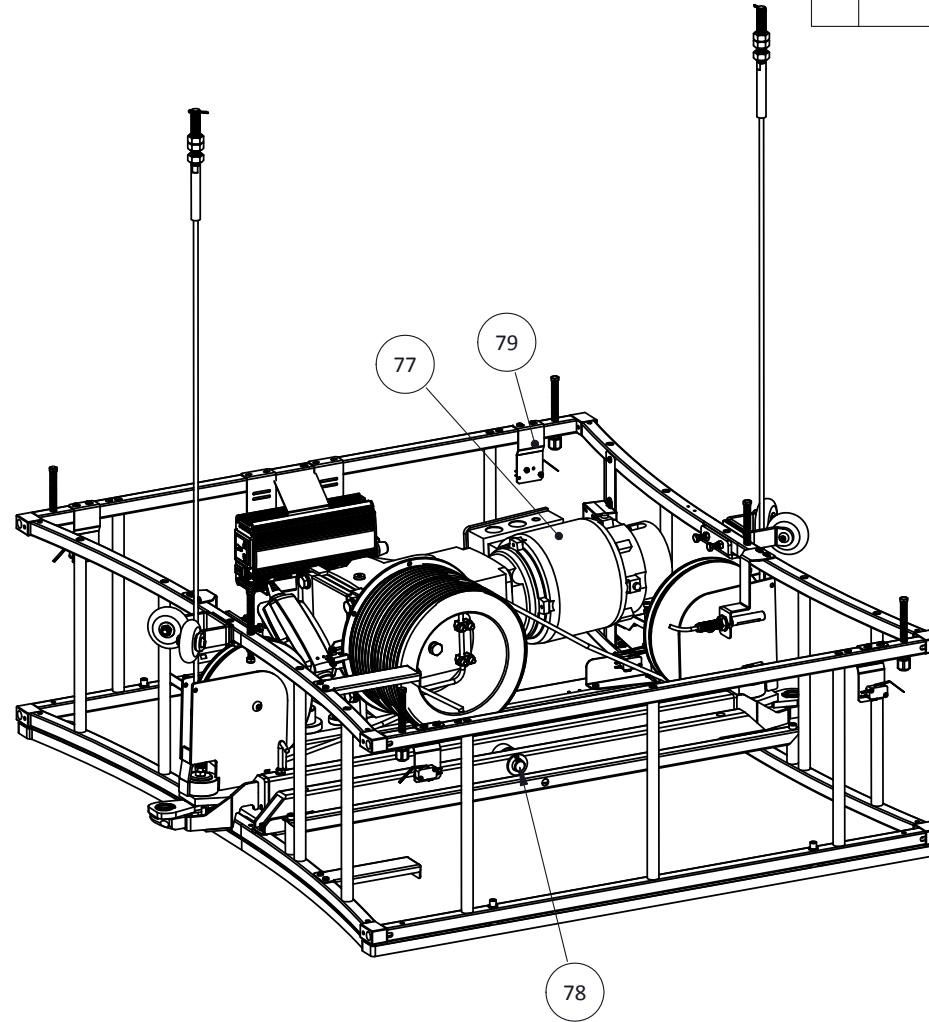

Approved for Manufacture
 By: (Sign)
 Name:.....

GENERAL TOLERANCES (Unless Noted Otherwise):

0-30mm	±0.1	30-120mm	±0.2
120-400mm	±0.3	400-1000mm	±0.5
1000-2000mm	±1.0	>2000mm	±1.5
	Angular		±0.25 Deg.

Break ALL sharp corners and remove burrs or swarf.



Drawn Wagon Wang	Date 2017/11/06
DIMENSIONS IN MM UNLESS OTHERWISE NOTED THIRD ANGLE PROJECTION - AS 1100	

TITLE	
Lifton Trio Hoist Assembly	
A4	Dwg No LTU-1C0BN5N-001
SCALE:	PAGE 7 OF 15

PRINT MAY BE REDUCED - DO NOT SCALE.

Rev	Description	By	Date
A	New Drawing	Wagon	2017/11/08

Item #	Part Name	Part No.	Qty
62.1	Phillips Pan Head Triangle Thread Screw M4x10	30101-30060	9
62.2	LT Hoist PAN Fix Plate	35112-10159	2
62.3	LT Lift Battery Bracket V.C	35112-10187	1
62.4	Flat Head Rivet Nut M4	30102-30033	6
62.5	Lifton Trio Hoist Hoop Top V.A	35105-100960	1
62.6	Flat Head Rivet Nut M5	30102-30034	1
62.7	Hoist Support Pipe Assy	50102-10011	14
62.8	Lifton Trio Hoist Hoop Bottom V.C	35105-10097	1
62.9	Socket Cap Head Screw M6X25mm	30101-80501	32
62.10	LT Hoist Short Support Bar	35115-00011	2
62.11	LT Hoist Horizontal Tube	35107-10061	1
62.12	Lifton Trio Ceiling Plate V.C	28106-00058	1

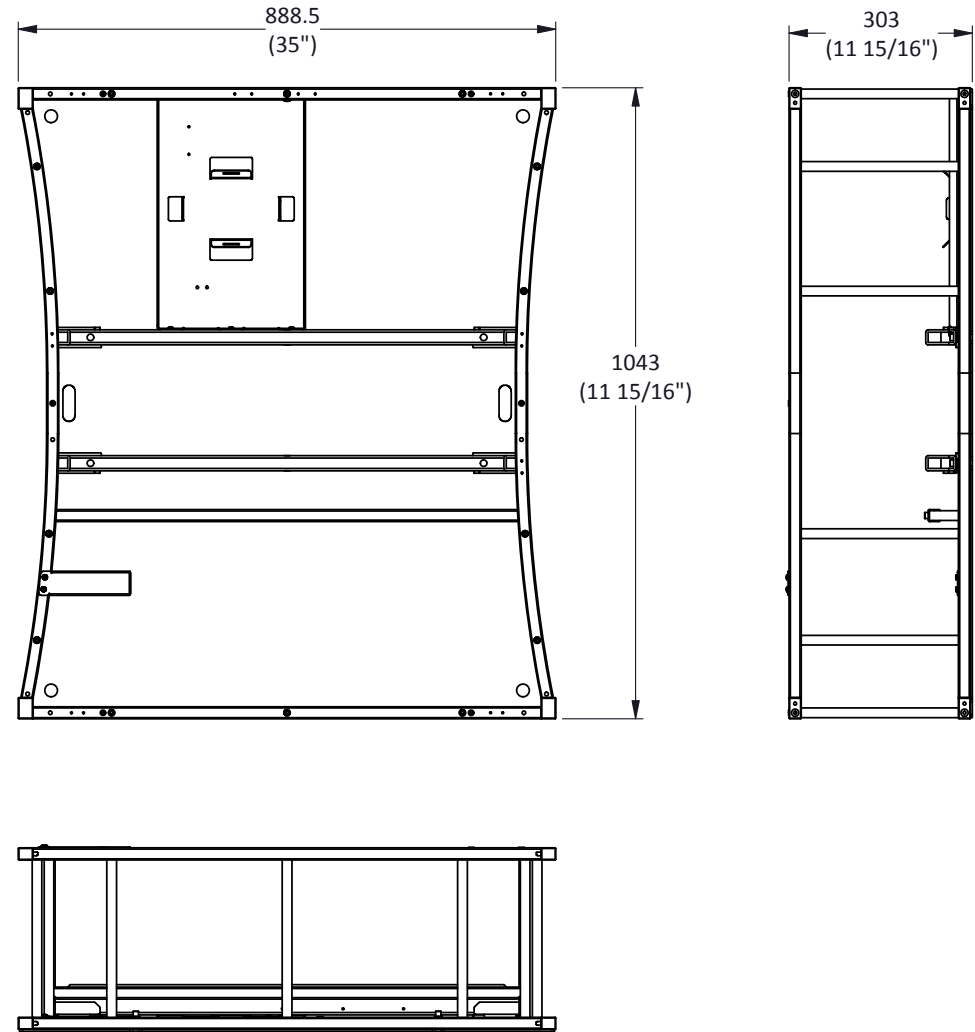
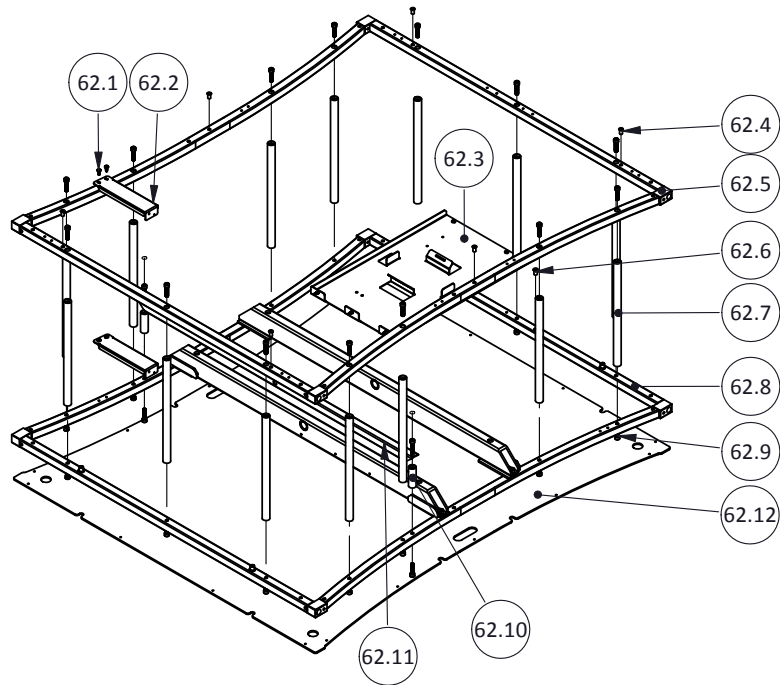

Approved for Manufacture

By: (Sign)
Name:.....

GENERAL TOLERANCES (Unless Noted Otherwise):
 0-30mm ±0.1 30-120mm ±0.2
 120-400mm ±0.3 400-1000mm ±0.5
 1000-2000mm ±1.0 >2000mm ±1.5
 Angular ±0.25 Deg.
Break ALL sharp corners and remove burrs or swarf.



Drawn Wagon Wang		Date 2017/11/08	TITLE Lifton Trio Hoist Frames V.C	
DIMENSIONS IN MM UNLESS OTHERWISE NOTED THIRD ANGLE PROJECTION - AS 1100		A4	Dwg No 50102-00096	PAGE 8 OF 15
SCALE:				

PRINT MAY BE REDUCED - DO NOT SCALE.

Rev	Description	By	Date
A	New Drawing	Wagon	2017/10/28

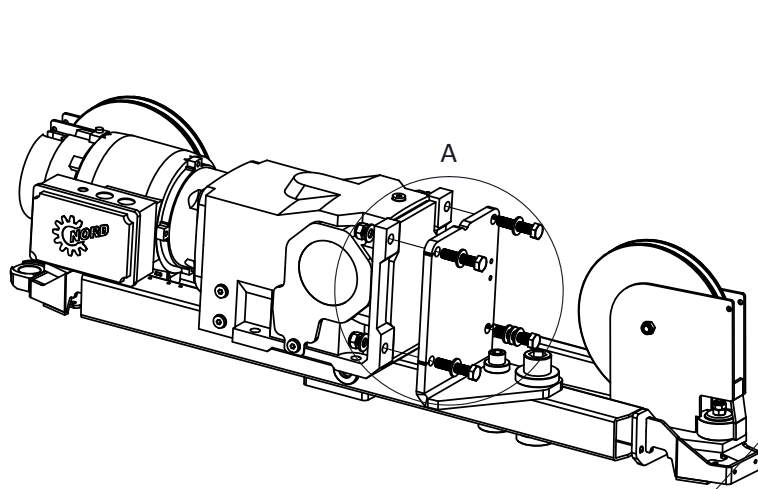

Nylon Self-locking Nut M10-Plated (3 pcs)
P/N:30102-10018

Flat washer $\Phi 20 \times \Phi 10 \times 2$ mm-Plated (9 pcs)
P/N:30103-10006

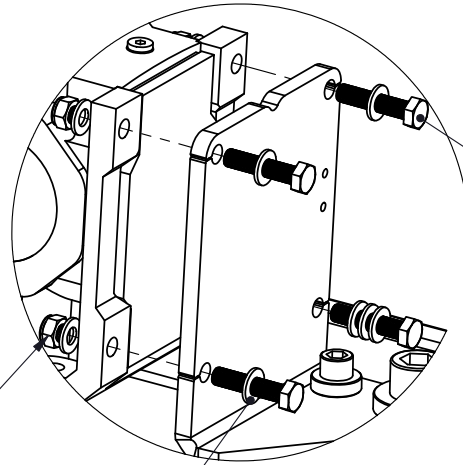

DETAIL A
SCALE 1 : 4

Hex Head Bolt M10*45mm
P/N:30101-11058

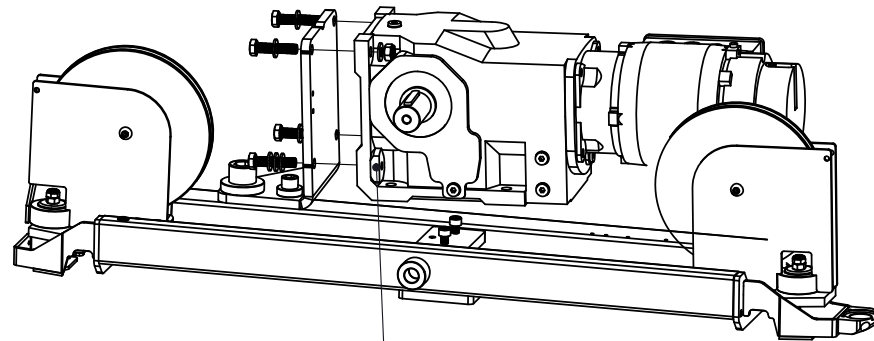

Motor Nut (1 pc)
P/N:35111-10017

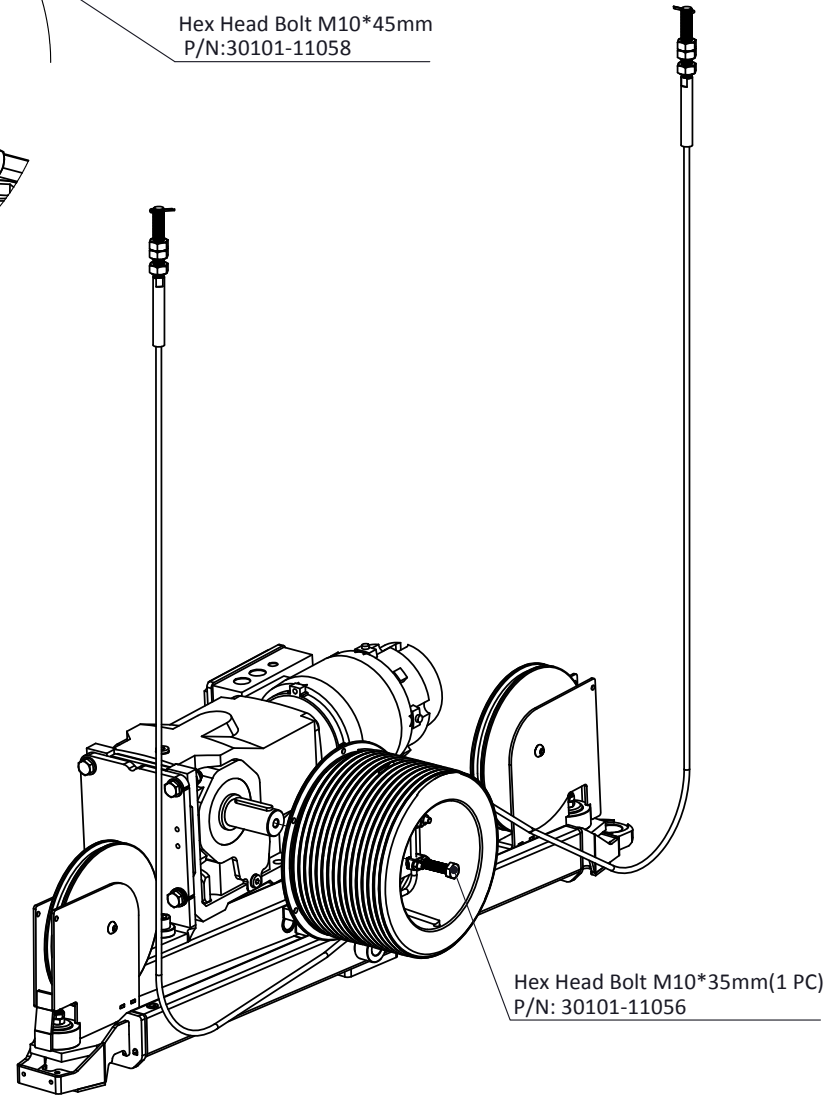

Hex Head Bolt M10*35mm(1 PC)
P/N: 30101-11056

Approved for Manufacture

By: (Sign)
Name:.....

GENERAL TOLERANCES (Unless Noted Otherwise):
 0-30mm ± 0.1 30-120mm ± 0.2
 120-400mm ± 0.3 400-1000mm ± 0.5
 1000-2000mm ± 1.0 >2000mm ± 1.5
 Angular ± 0.25 Deg.
Break ALL sharp corners and remove burrs or swarf.

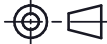

Drawn Wagon Wang		Date 2017/10/28	TITLE Motor Install	
 DIMENSIONS IN MM UNLESS OTHERWISE NOTED THIRD ANGLE PROJECTION - AS 1100		A4	Dwg No -	PAGE 9 OF 15
			SCALE:	

PRINT MAY BE REDUCED - DO NOT SCALE.

Rev	Description	By	Date
A	New Drawing	Wagon	2017/11/08

DETAIL A

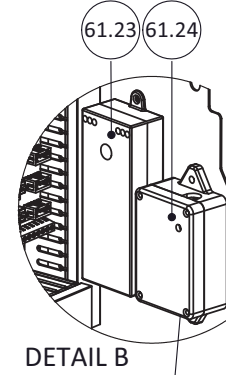
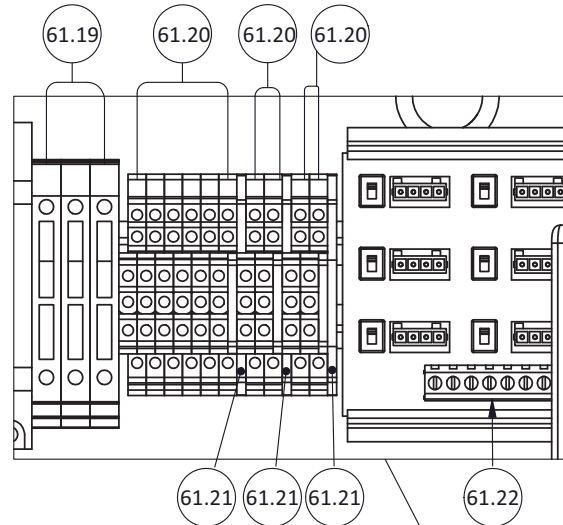

DETAIL B

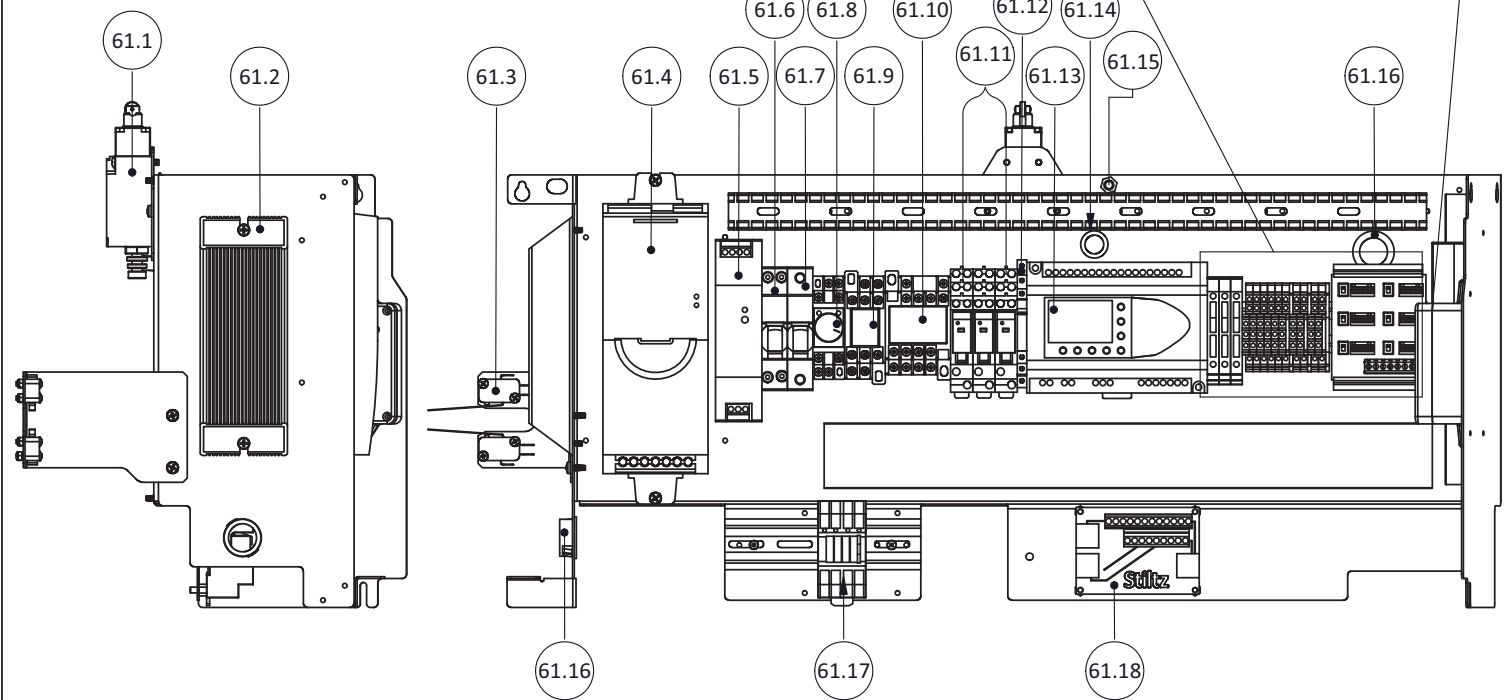

Item #	Part Name	Part No.	Qty
61.1	Extreme Upper Limit Tag Switch Assembly	50104-00004	1
61.2	Brake Resister N2	10203-00003	1
61.3	Trio Balance Limit Bracket Assembly	50104-00032	1
61.4	Frequency Inverter N1	10202-00002	1
61.5	Power Supply 24v	10701-00003	1
61.6	Circuit Breaker 10A	10101-00001	1
61.7	Circuit Breaker 32A	10101-00002	1
61.8	Timer Relay	10103-00007	1
61.9	Relay AC220/240V	10103-00005	1
61.10	Relay AC200/220V	10103-00001	1
61.11	Relay DC24V	10103-00003	3
61.12	Mini Relay(With Base)	10103-00012	1
61.13	PLC	10201-00001	1
61.14	Cable Bush Φ:16 - Black	10908-00003	1
61.15	Limit Override Push Button	10304-00001	1
61.16	Cable Bush Φ:26 - Black	10908-00002	2
61.17	Relay 24V	10103-00014	1
61.18	Car Control PCB Assembly	50104-00024	1
61.19	Fuse Terminals	10104-00001	3
61.20	Two Level Terminal	10401-00001	10
61.21	Terminal End Plate	10401-00003	3
61.22	Door Lock Link PCB Assembly	50104-00026	1
61.23	Light Curtain Controller	10204-00001	1
61.24	Remote Control Receiver Fixed Code Assembly	50104-00071	1

Approved for Manufacture

By: (Sign)
Name:.....

GENERAL TOLERANCES (Unless Noted Otherwise):

0-30mm	±0.1	30-120mm	±0.2
120-400mm	±0.3	400-1000mm	±0.5
1000-2000mm	±1.0	>2000mm	±1.5
Angular	±0.25 Deg.		

Break ALL sharp corners and remove burrs or swarf.



Drawn Wagon Wang		Date 2017/11/08		TITLE LT Hoist Electrical Panel Assembly	
 THIRD ANGLE PROJECTION - AS 1100		DIMENSIONS IN MM UNLESS OTHERWISE NOTED		A4	Dwg No 50103-00009 SCALE:
PAGE 10 OF 15					

PRINT MAY BE REDUCED - DO NOT SCALE.

Rev	Description	By	Date
A	New Drawing	Guangji	2015/03/20

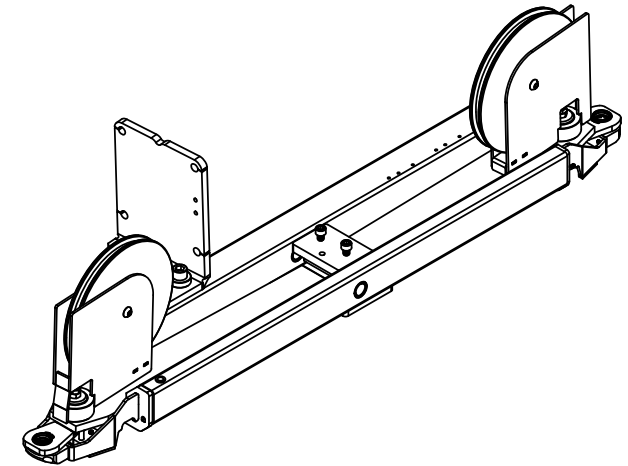
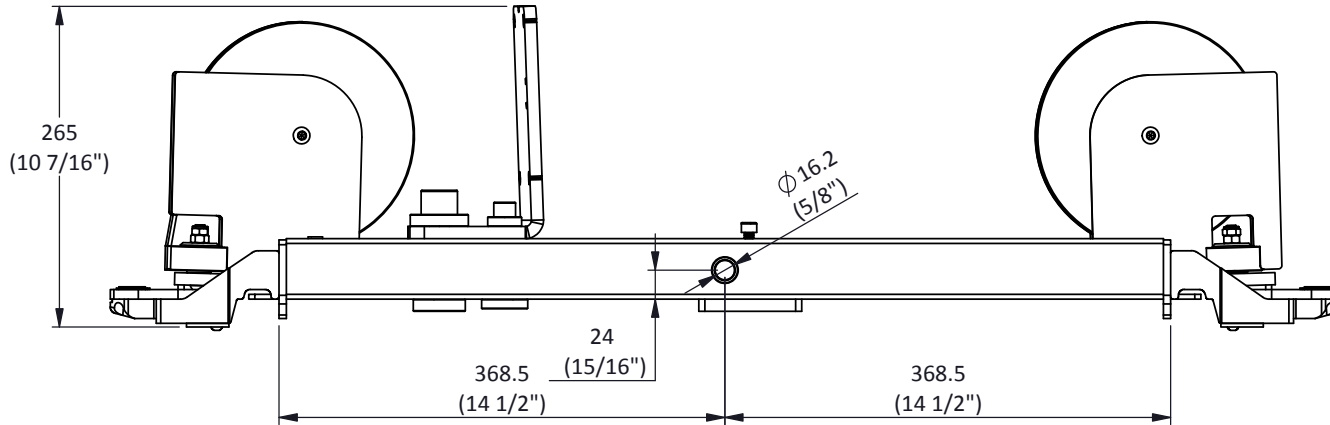
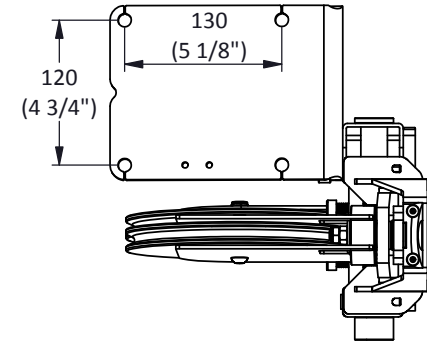
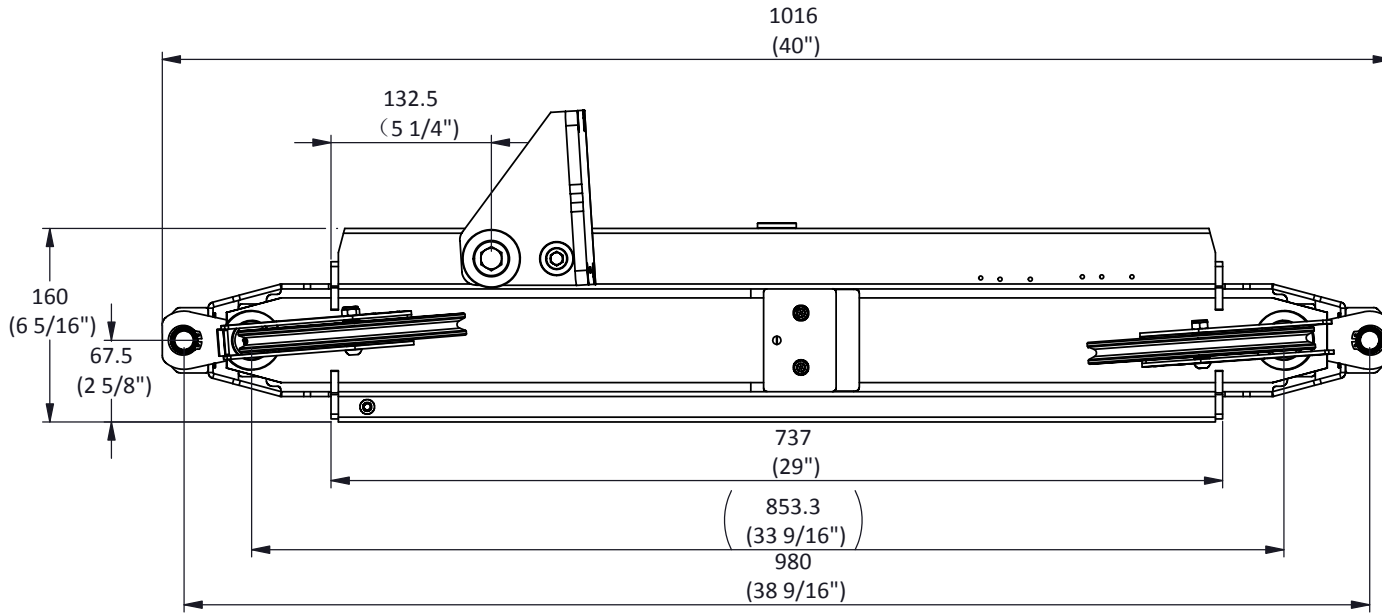

Approved for Manufacture

By: (Sign)
Name:.....

GENERAL TOLERANCES (Unless Noted Otherwise):

0-30mm	±0.1	30-120mm	±0.2
120-400mm	±0.3	400-1000mm	±0.5
1000-2000mm	±1.0	>2000mm	±1.5
Angular	±0.25 Deg.		

Break ALL sharp corners and remove burrs or swarf.

Stiltz

Drawn		Date		TITLE	
Guangji Chen		2015/03/20		Hoist Swivel Rocker Beam Assembly	
 THIRD ANGLE PROJECTION - AS 1100		DIMENSIONS IN MM UNLESS OTHERWISE NOTED		A4	Dwg No 50102-00024
SCALE:				PAGE	11 OF 15

PRINT MAY BE REDUCED - DO NOT SCALE.

Rev	Description	By	Date
A	New Drawing	Guangji	2015/03/20

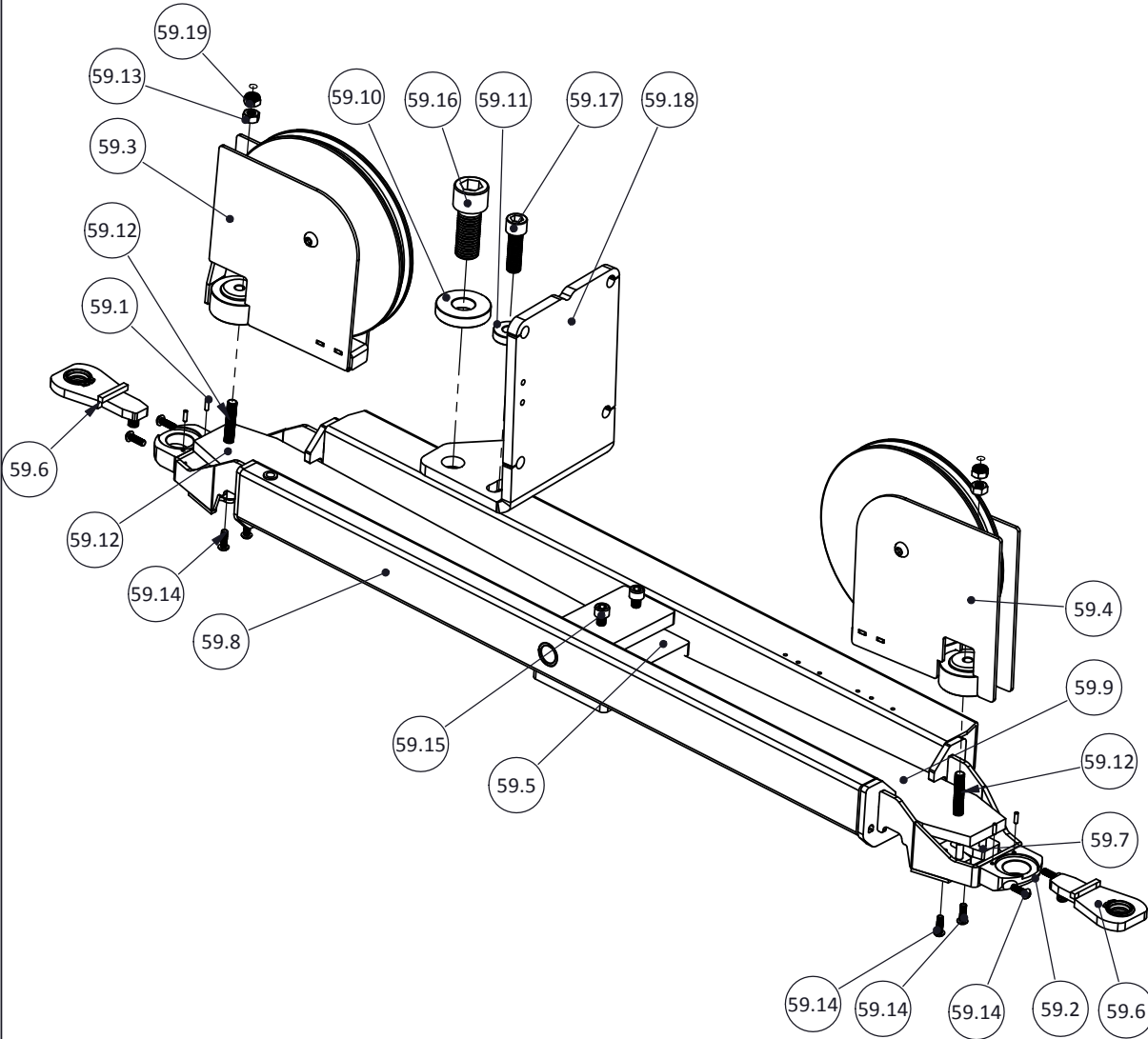

Item #	Part Name	Part No.	Qty
59.1	Magnet Pin OD3x10	30113-00015	4
59.2	Gripper Support V.B	20102-00005	2
59.3	Swivel Sheave Assembly LH V.A	50102-00038	1
59.4	Swivel Sheave Assembly RH V.A	50102-00039	1
59.5	Spring block plate V.A	35111-10035	1
59.6	Gripper Plate II Assembly	50102-00025	2
59.7	Gripper Steady Plate Assembly V.B	35105-10016	2
59.8	Swivel Rocker Beam V.C	35105-10013	1
59.9	Spring II_bend	35111-10030	1
59.10	Pivot Washer V.A	35111-10034	1
59.11	Lock Washer V.A	35111-10033	1
59.12	Socket Button Head Screw M8x50mm	30101-10221	2
59.13	Hexagon Nut M8	30102-10043	2
59.14	SS Socket Button Head Screw M5X16mm	30101-80182	8
59.15	Socket Cap Head Screw M8x35mm	30101-10520	2
59.16	Socket Cap Head Screw M20x50mm	30101-10593	1
59.17	Socket Cap Head Screw M12x40mm	30101-10557	1
59.18	Motor Mount Bracket V.C	35112-10027	1
59.19	Nylon Self-locking Nut M8	30102-10017	2

Approved for Manufacture

By: (Sign)
Name:.....

GENERAL TOLERANCES (Unless Noted Otherwise):

0-30mm	±0.1	30-120mm	±0.2
120-400mm	±0.3	400-1000mm	±0.5
1000-2000mm	±1.0	>2000mm	±1.5
	Angular		±0.25 Deg.

Break ALL sharp corners and remove burrs or swarf.

Stiltz

Drawn		Date		TITLE	
Guangji Chen		2015/03/20		Hoist Swivel Rocker Beam Assembly	
 THIRD ANGLE PROJECTION - AS 1100		DIMENSIONS IN MM UNLESS OTHERWISE NOTED		A4 Dwg No 50102-00024	
SCALE:				PAGE 12 OF 15	

PRINT MAY BE REDUCED - DO NOT SCALE.

28

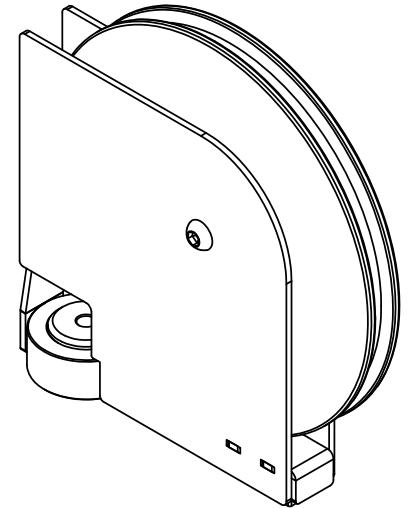
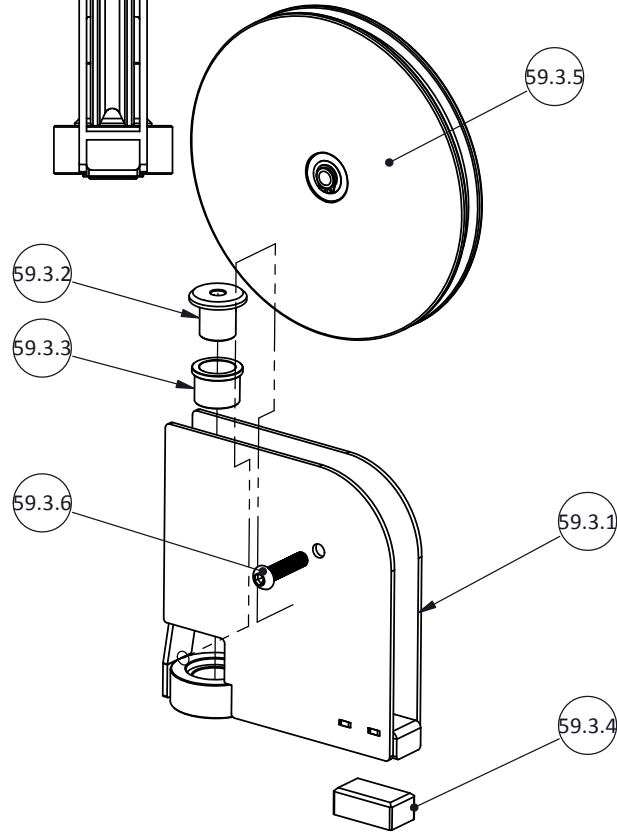
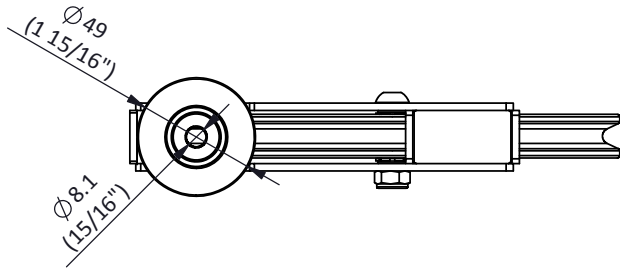
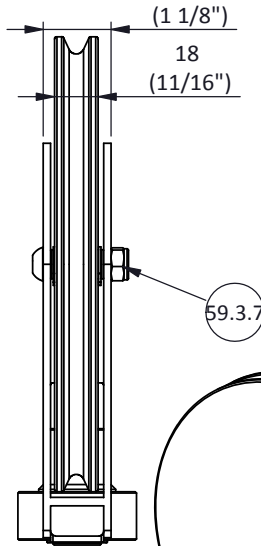
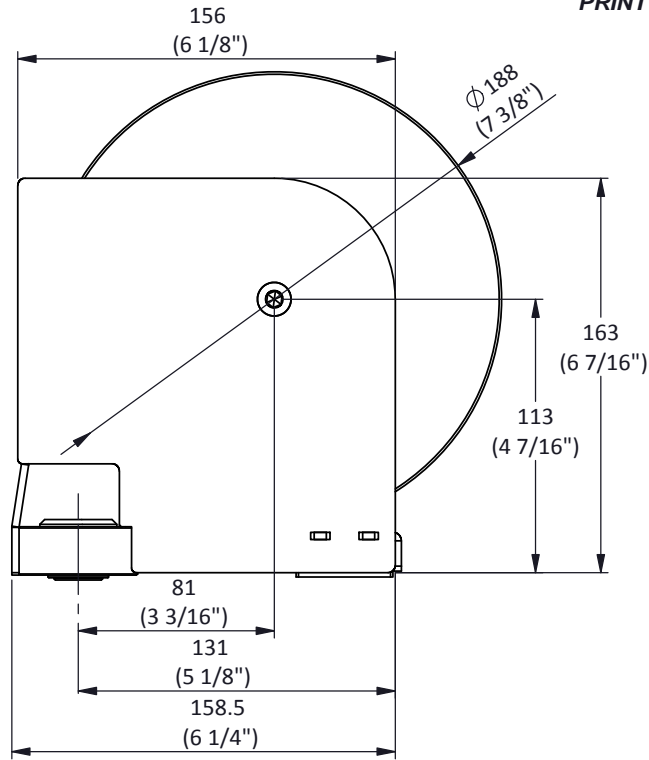

Rev	Description	By	Date
A	New Drawing	Guangji	2015/03/21

Item #	Part Name	Part No.	Qty
59.3.1	Swivel Sheave Bracket LH V.A	35105-10014	1
59.3.2	Sheave Pivot V.A	35111-10032	1
59.3.3	Sheave Guide Bush	30113-00018	1
59.3.4	Swivel Block V.B	20102-00006	1
59.3.5	Nylon Sheave Assembly	50102-00001	1
59.3.6	Socket Button Head Screw M8X35mm	30101-10218	1
59.3.7	Nylon Self-locking Nut M8	30102-10017	1

Approved for Manufacture

GENERAL TOLERANCES (Unless Noted Otherwise):
 0-30mm ±0.1 30-120mm ±0.2
 120-400mm ±0.3 400-1000mm ±0.5
 1000-2000mm ±1.0 >2000mm ±1.5
 Angular ±0.25 Deg.
Break ALL sharp corners and remove burrs or swarf.

By: (Sign)
 Name:.....



Drawn Guangji Chen		Date 2015/03/21	TITLE Swivel Sheave Assembly LH V.A	
DIMENSIONS IN MM UNLESS OTHERWISE NOTED THIRD ANGLE PROJECTION - AS 1100		A4	Dwg No 50102-00038	PAGE 13 OF 15
SCALE:				

PRINT MAY BE REDUCED - DO NOT SCALE.

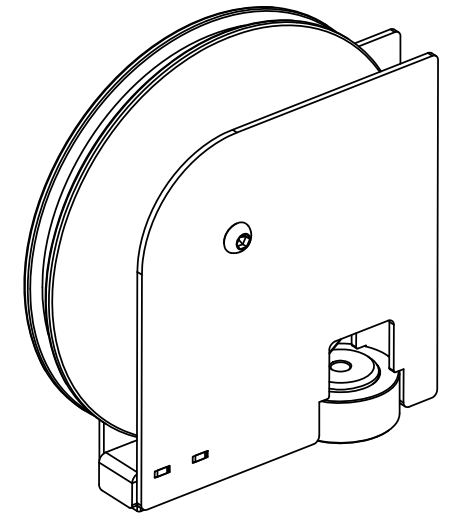
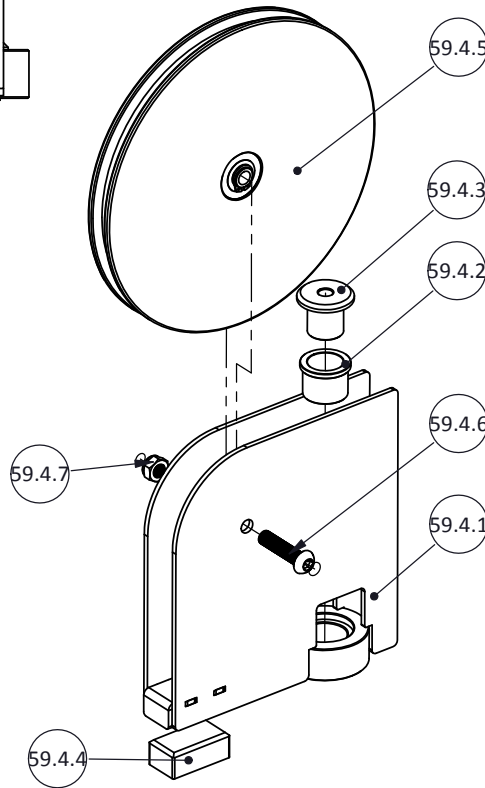
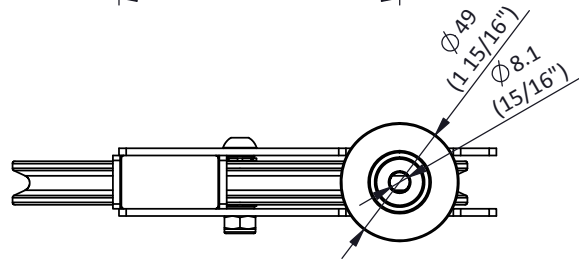
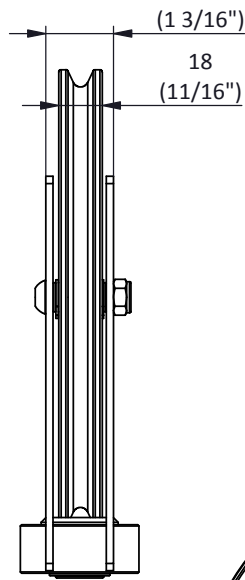
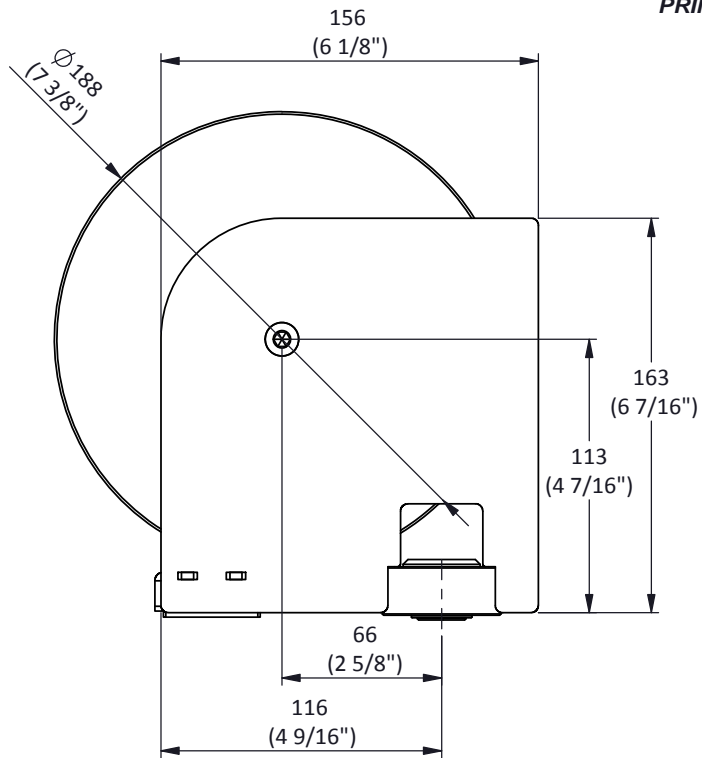

Rev	Description	By	Date
A	New Drawing	Guangji	2015/03/21

Item #	Part Name	Part No.	Qty
59.4.1	Swivel Sheave Bracket RH V.A	35105-10015	1
59.4.2	Sheave Guide Bush	30113-00018	1
59.4.3	Sheave Pivot V.A	35111-10032	1
59.4.4	Swivel Block V.B	20102-00006	1
59.4.5	Nylon Sheave Assembly	50102-00001	1
59.4.6	Socket Button Head Screw M8X35mm	30101-10218	1
59.4.7	Nylon Self-locking Nut M8	30102-10017	1

Approved for Manufacture

By: (Sign)
Name:.....

GENERAL TOLERANCES (Unless Noted Otherwise):

0-30mm	±0.1	30-120mm	±0.2
120-400mm	±0.3	400-1000mm	±0.5
1000-2000mm	±1.0	>2000mm	±1.5
Angular	±0.25 Deg.		

Break ALL sharp corners and remove burrs or swarf.

Stiltz

Drawn		Date		TITLE	
Guangji Chen		2015/03/21		Swivel Sheave Assembly RH V.A	
 THIRD ANGLE PROJECTION - AS 1100		DIMENSIONS IN MM UNLESS OTHERWISE NOTED		A4	Dwg No 50102-00039
SCALE:				PAGE	14 OF 15

PRINT MAY BE REDUCED - DO NOT SCALE.

Rev	Description	By	Date
A	New drawing	Guangji	2015/03/21

Item #	Part Name	Part No.	Qty
59.6.1	Gripper Plate II	35105-10020	1
59.6.2	Gripper spring	30105-00001	1
59.6.3	Circlips For Shaft Ø22mm	30111-00010	1
59.6.4	Gripper Insert Assembly	50102-00025A	1

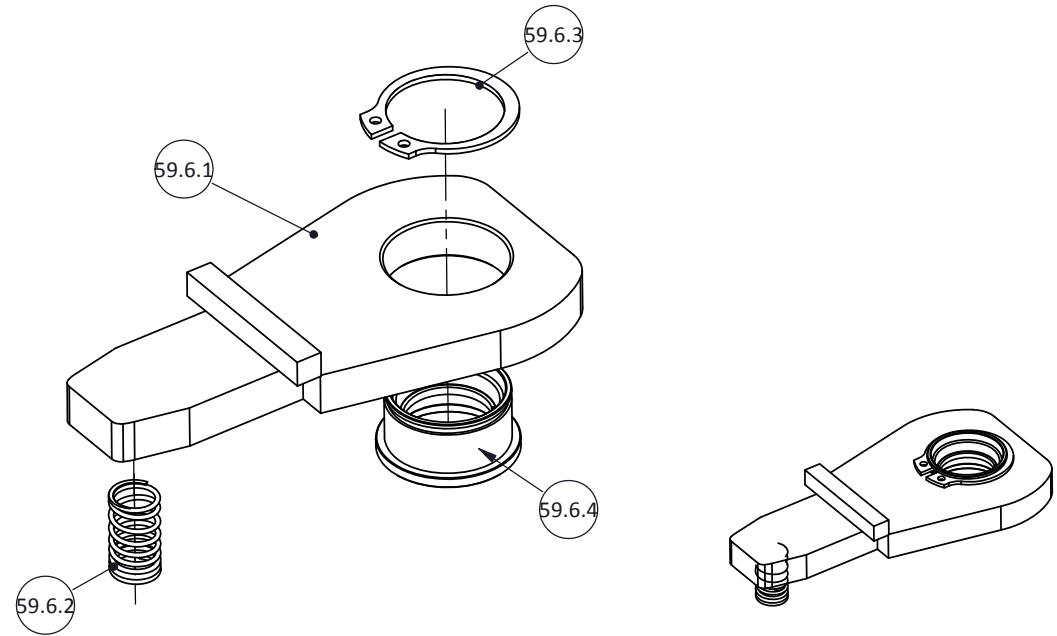
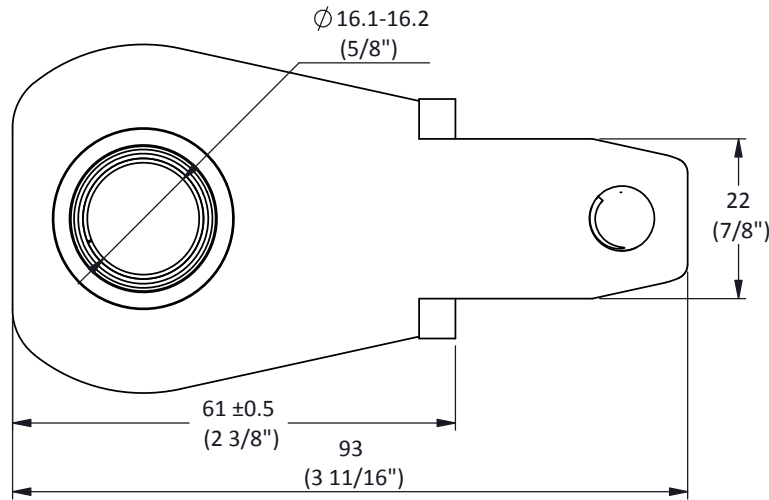
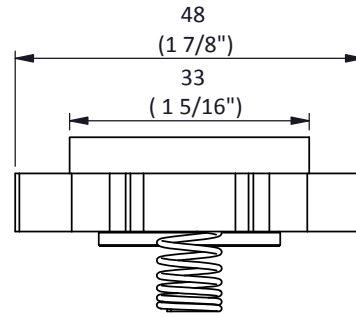
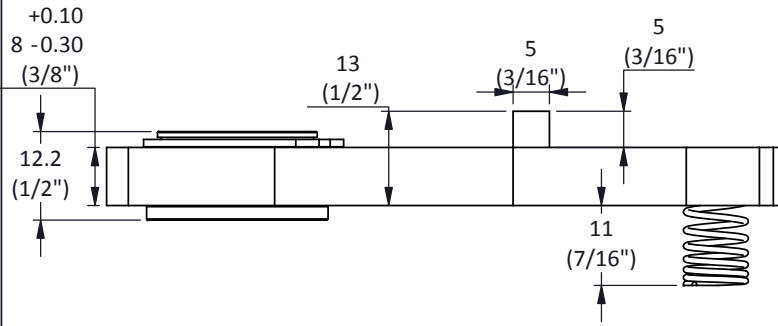

Approved for Manufacture

By: (Sign)
Name:.....

GENERAL TOLERANCES (Unless Noted Otherwise):
 0-30mm ±0.1 30-120mm ±0.2
 120-400mm ±0.3 400-1000mm ±0.5
 1000-2000mm ±1.0 >2000mm ±1.5
 Angular ±0.25 Deg.
Break ALL sharp corners and remove burrs or swarf.



Drawn Guangji Chen		Date 2015/03/21	TITLE	
THIRD ANGLE PROJECTION - AS 1100		Gripper Plate II Assembly		PAGE 15 OF 15
DIMENSIONS IN MM UNLESS OTHERWISE NOTED		A4	Dwg No 50102-00025	
SCALE:				