



# Configuration Guide

TaHoma®



TaHoma works with Amazon Alexa

# 1. GETTING STARTED

Download from the online stores the mobile app Amazon Alexa



**Amazon Alexa** 4+  
AMZN Mobile LLC  
#7 in Lifestyle  
★★★★★ 4.5 + 216K Ratings  
Free



Make sure you have a valid account on Amazon; Alexa services are provided based on the information recorded in the Amazon website. Alexa services are available in several regions, be sure that your Amazon account used for Alexa is in your region

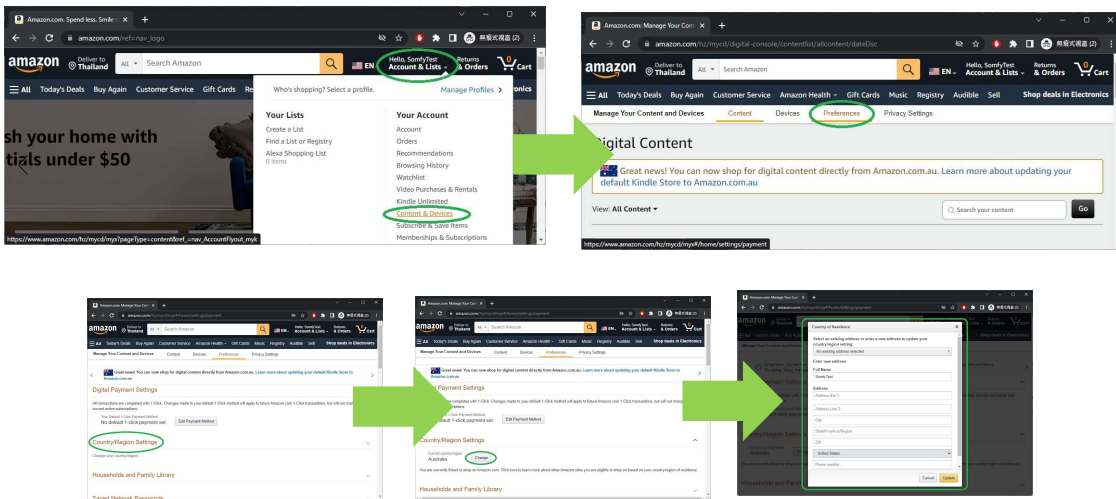

E.g., India's Tahoma by Somfy users should use Amazon account registered on "Amazon.in" and not account registered in other regions such like .UK or .COM.



Tahoma Living 4+

SOMFY SAS

Designed for iPhone

★★★★ 4.5 • 4 Ratings

Free



Make sure you have already added some **devices**, and **scenes** in your **Tahoma Living** Application, blinds, shutters or lights are all supported by Alexa.

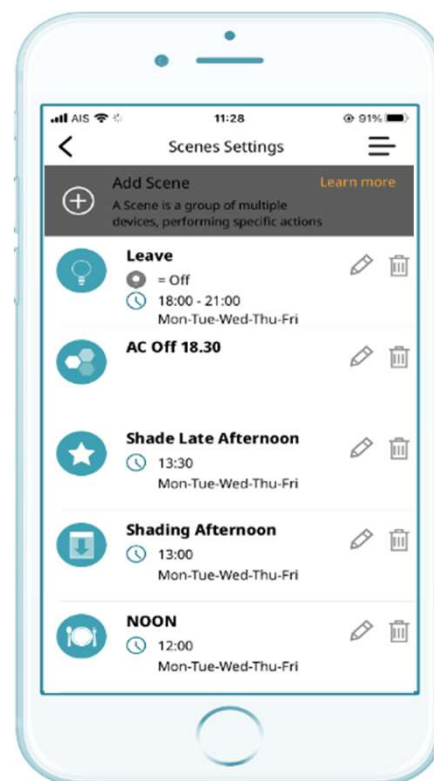

## 2. ALEXA SKILL SETTING

Launch the ALEXA mobile app on your smart phone.



1. Open your ALEXA application
2. Tap on “More”
3. Select the section Skills & Games

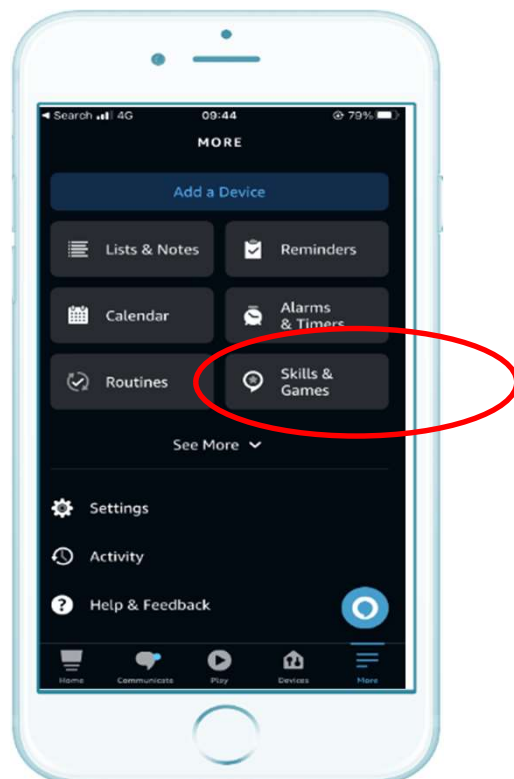
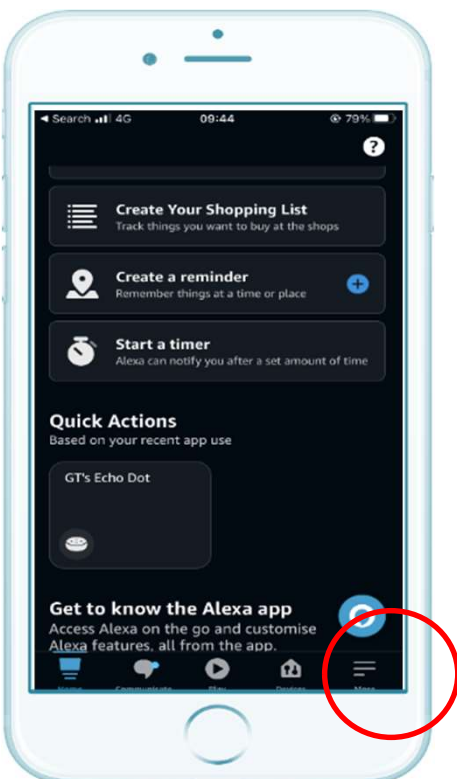

4. Search for the skill named “Tahoma by Somfy”.

5. Enable the Skill on your phone.

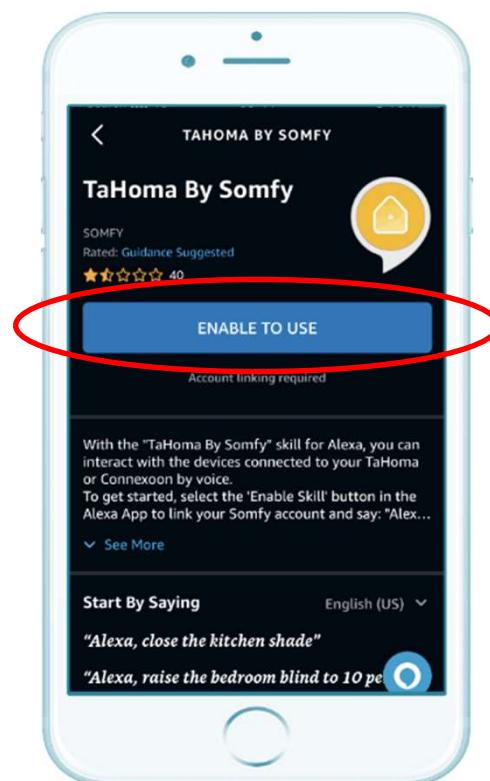
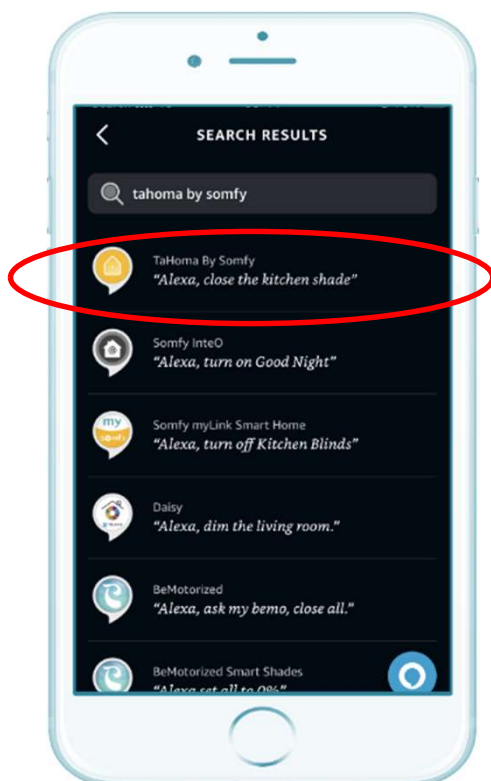
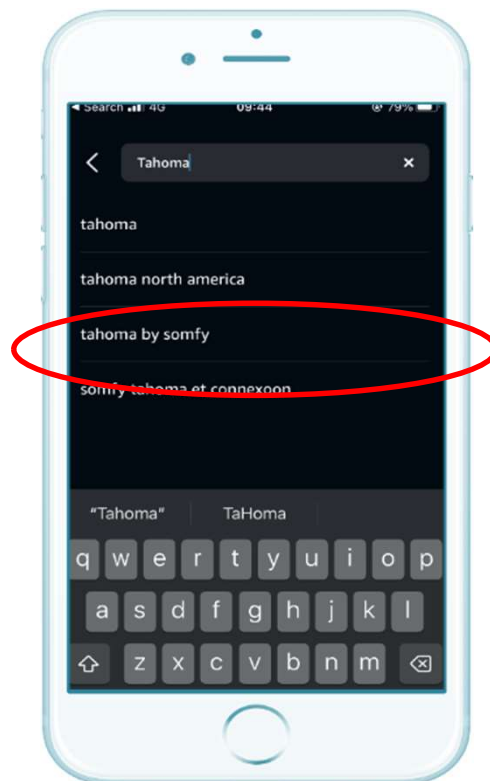
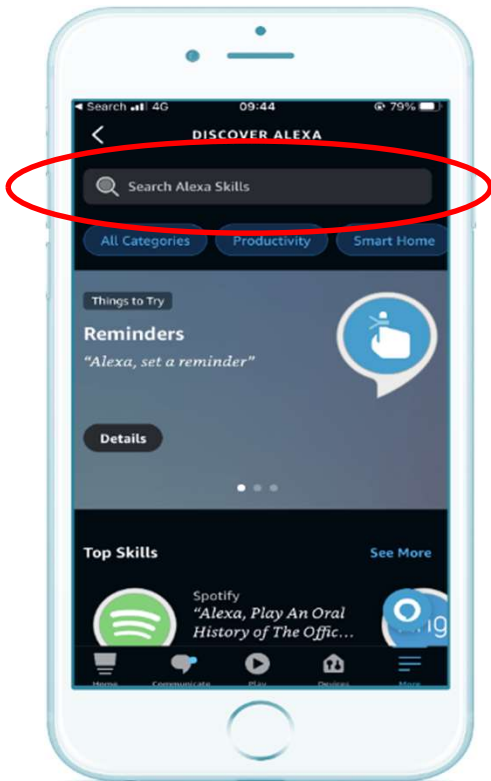

6. It is required link the Alexa application with the Somfy account.

7. Enter your Tahoma login (email address) and password to connect Alexa to Somfy Smart Services. (This operation is required only once).

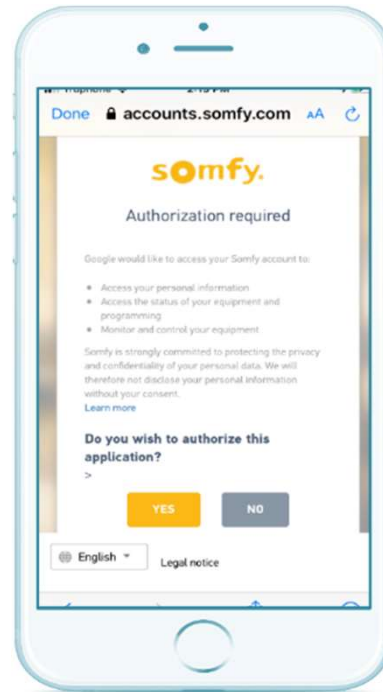
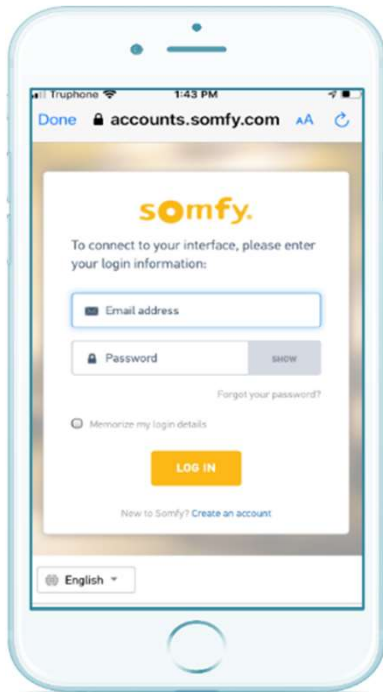

Wait during Alexa & Somfy are setting up and browsing your Smart Home System.

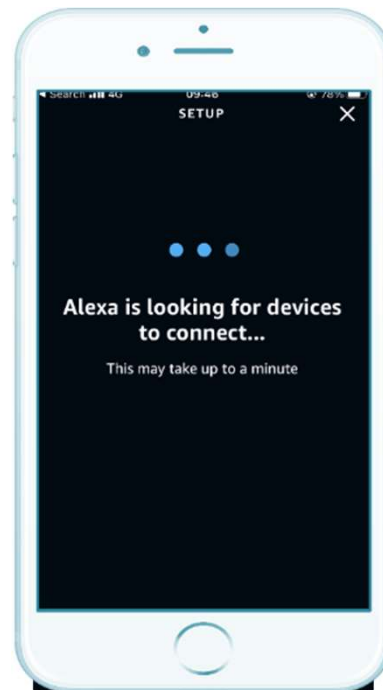
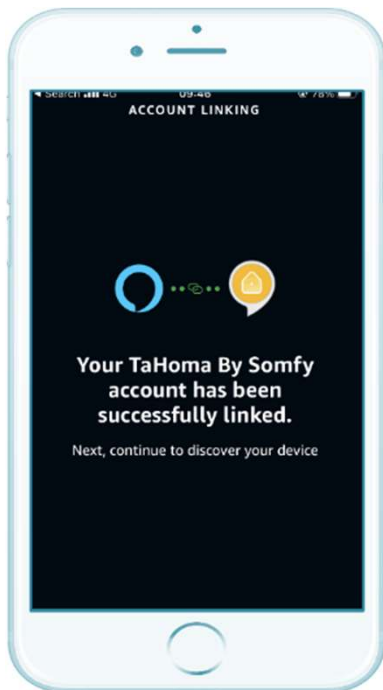



**Congratulation!**

**Now your Alexa account is  
linked with Somfy Tahoma!**

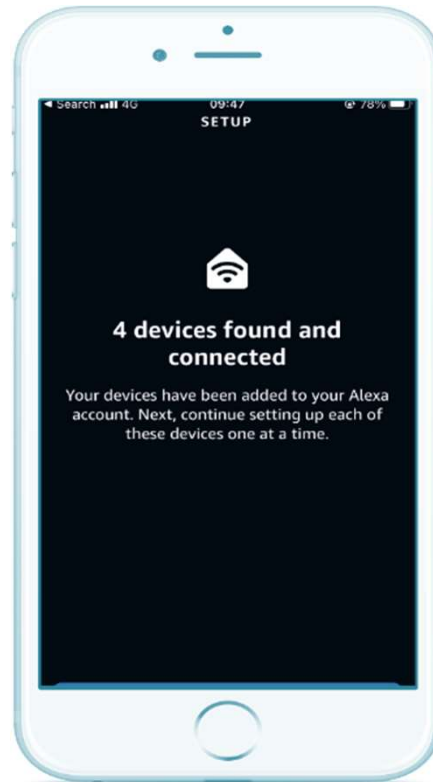

Lighting and window covering devices are automatically discovered, however, setting up each and every single device is required.

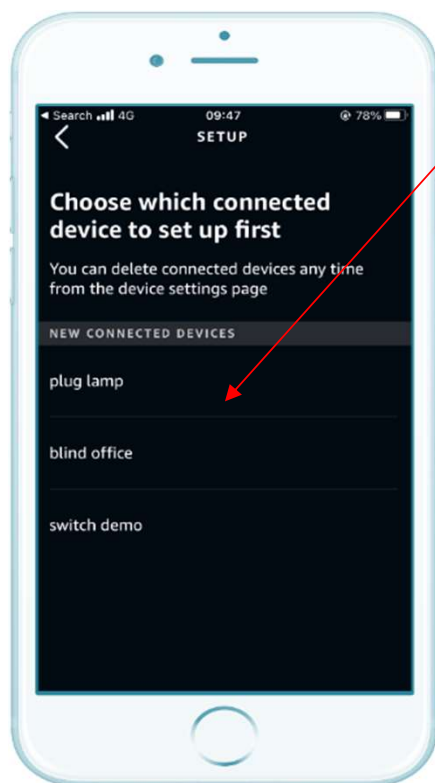

List of devices automatically discovered.

In case the devices already configured in Tahoma aren't displayed in Alexa, it is necessary disable and enable again the Skill. If the procedure don't succeed go to the trouble shooting page in this guide.

### 3. ALEXA DEVICE SETUP

Select the device to setup.

Alexa will include in the list of enabled devices

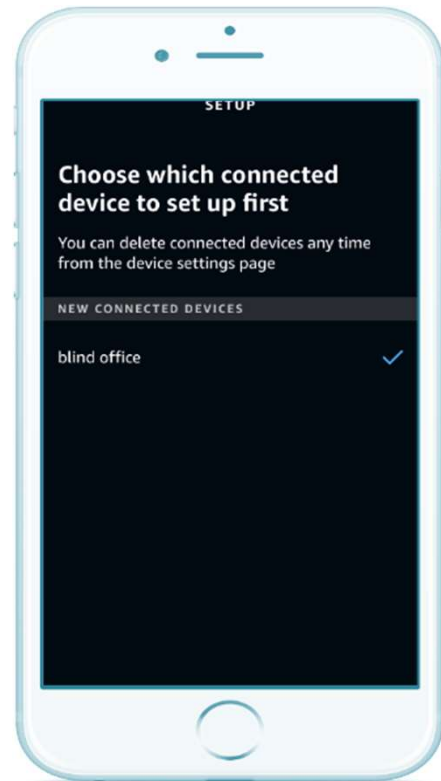

Terminated the setup of all the Smart Home devices, Alexa will provide the message “All your devices are set up”

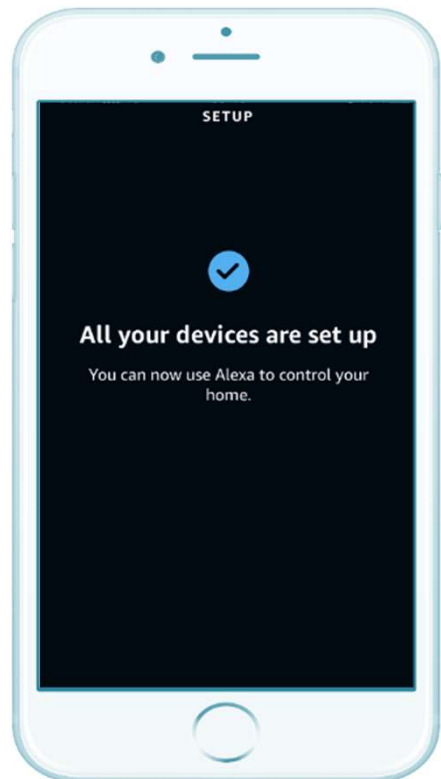
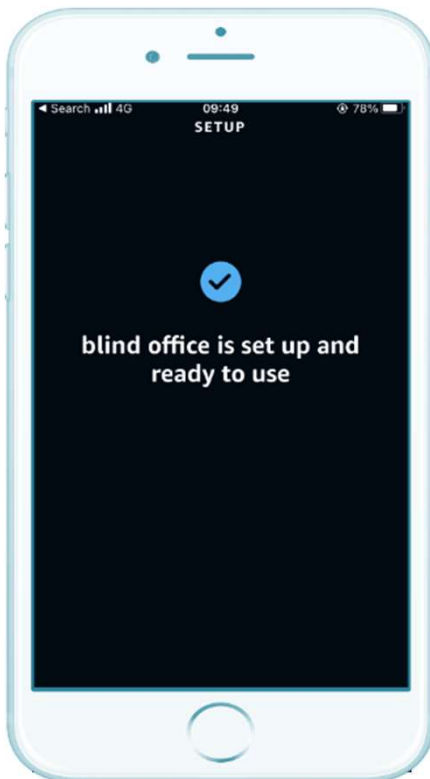



## 4. WHAT CAN I CONTROL WITH ALEXA

Now blinds, curtains and lights can be controlled even by with voice just saying “Alexa, <name of the device>”

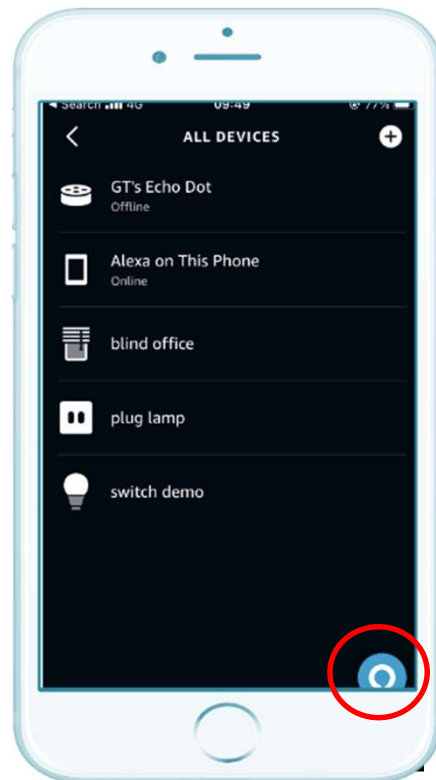
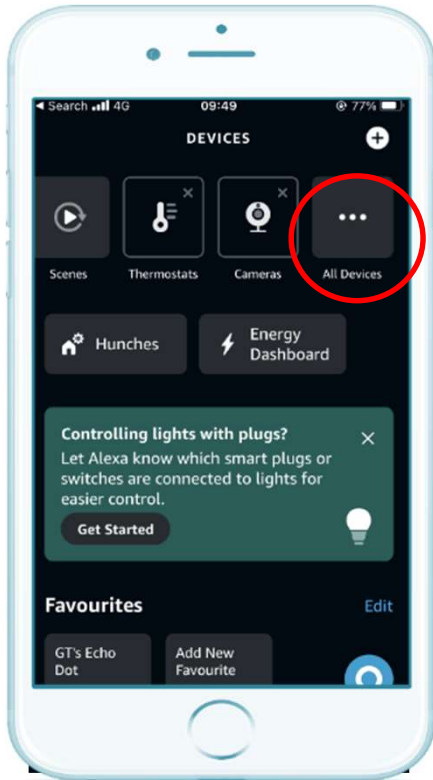

Devices able to be discovered by Alexa by amazon.



Roller Shutters



Swinging Shutters



Exterior Venetian Blinds



Exterior Screens



Screens



Venetian Blinds



Curtains



Lights



On Off



Lights



blaster

Scenes will also be discovered by Alexa.

## 5. SCENARIO & ROUTINE

Alexa offer Routines & Scenes. Scenes are imported from Tahoma configuration. For launching an imported Scene from Tahoma just say: “**Alexa, RUN <name of the scene>**”.

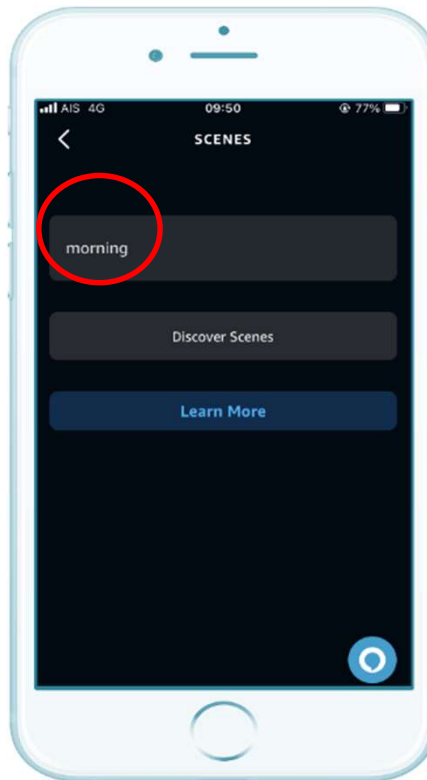
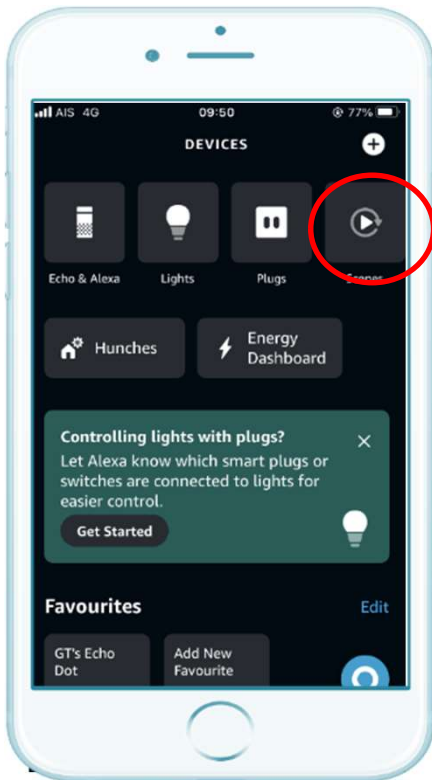

1. Tap on **Scene**.
2. A list of imported Scenarios is available.
3. Tapping on “Learn More” is possible update the list of Scenes.

In case the scene configured in Tahoma aren't displayed, check the trouble shooting page in this guide.



**Routines** are a combinations of commands made available by Alexa and configurable directly from Alexa mobile app.

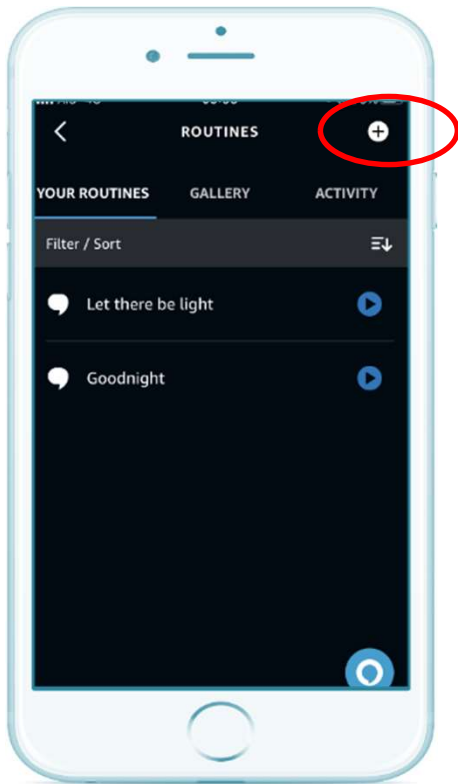

1. Tap on “+” for adding a new routine.

Tap on “Enter Routine Name” for adding the new routine name.

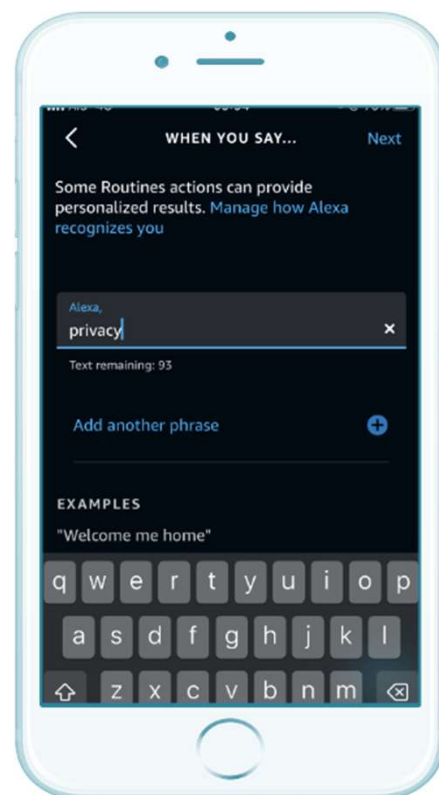
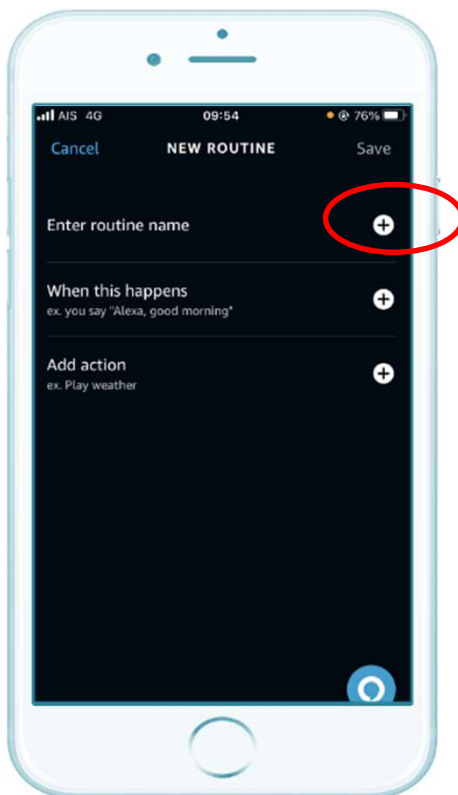

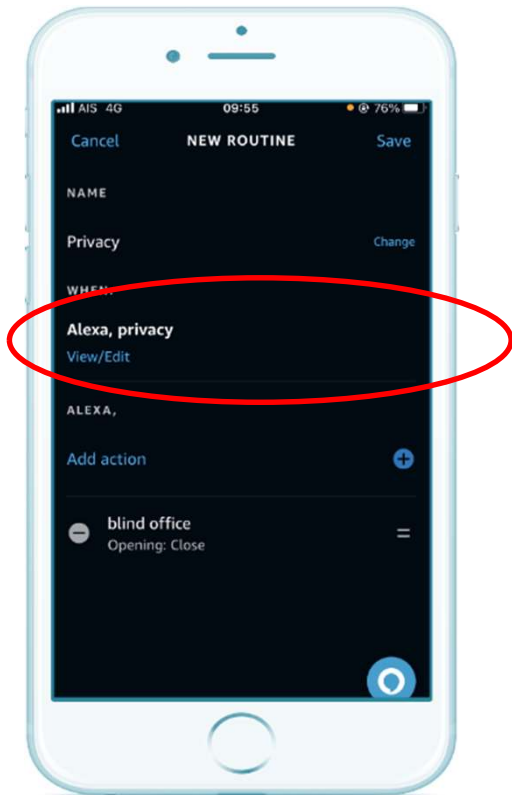

1. Select a starter condition for the new routine.

Routine can be launched by a voice command or if a specific condition is met (e.g., a routine can be configured to pull up the rolling blind in the bedroom every morning at 8 am.)

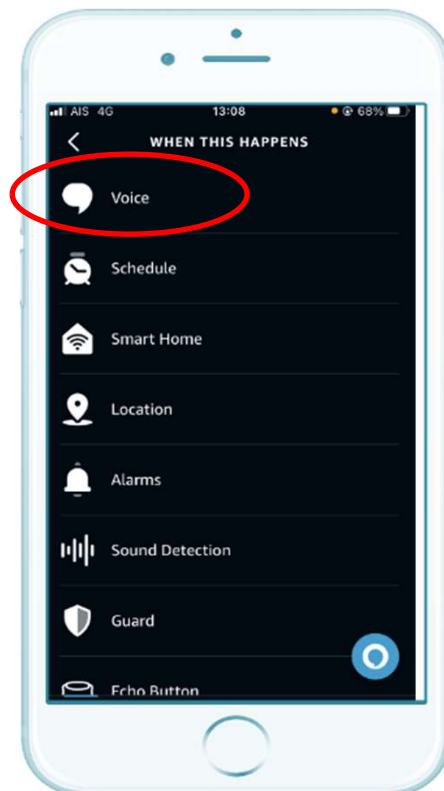

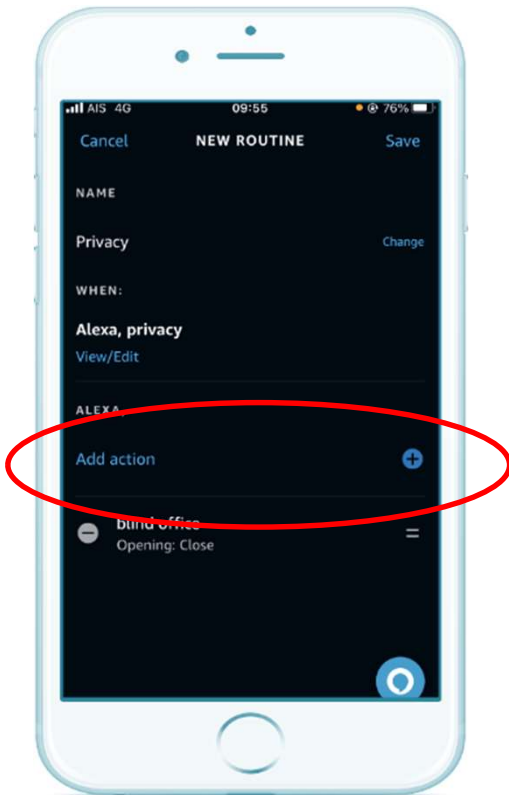

1. A routine can control single devices as well group of devices or even scene.

Routine can be related to Smart Home or to other automated functions. In the section Smart Home are accessible all the Tahoma devices and scene.

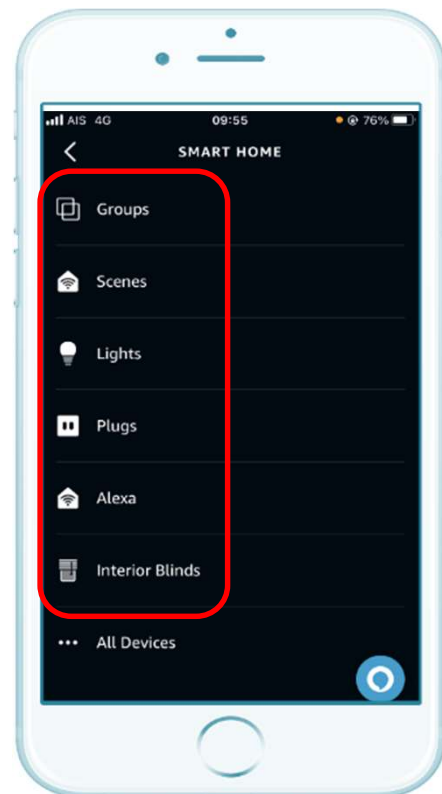
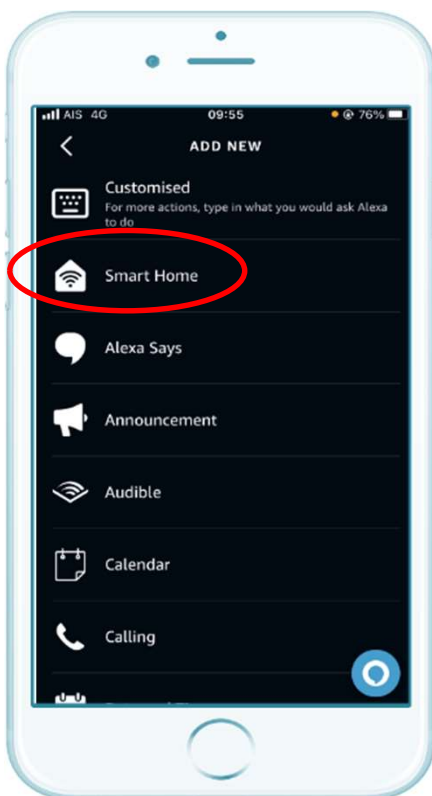

For each device involved in the routine, is required to specify the action that it need to perform (e.g. Open/Close, On/Off).

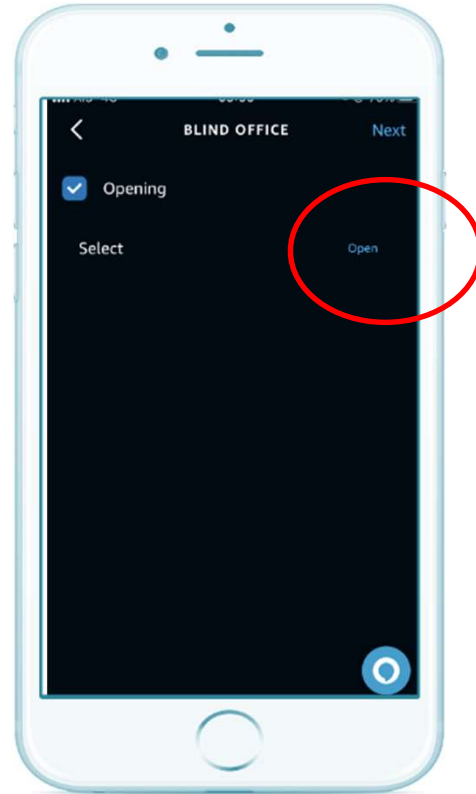
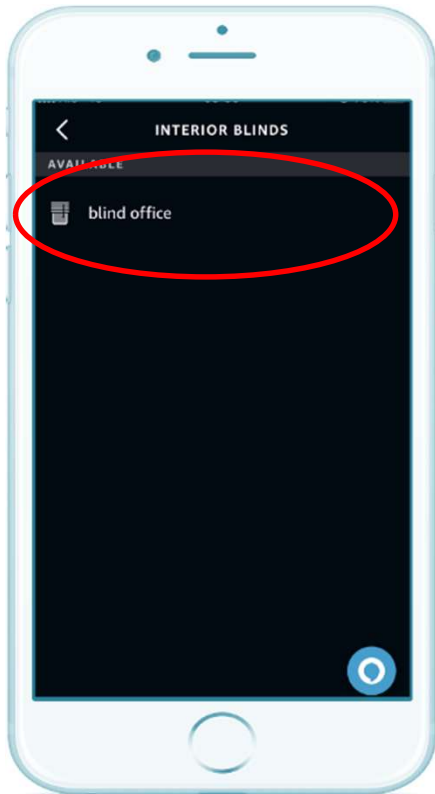

When the routine is fully configured and saved, an acknowledge message will be displayed on the top of the screen.

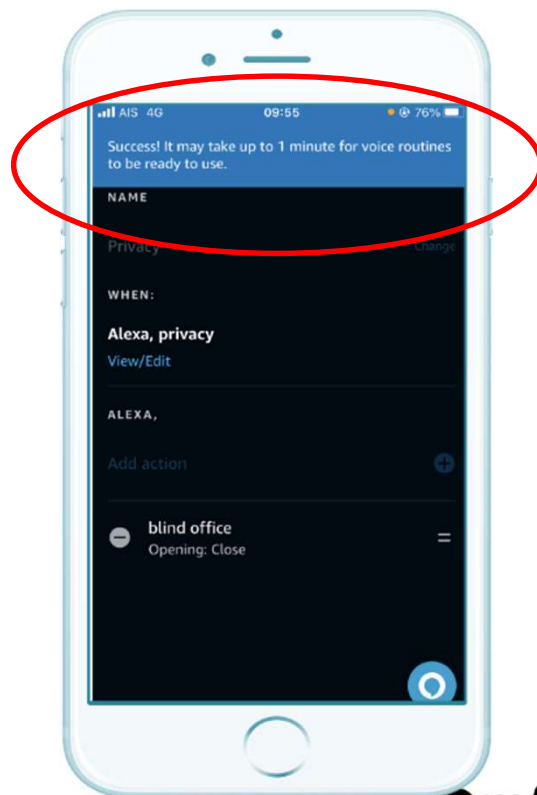
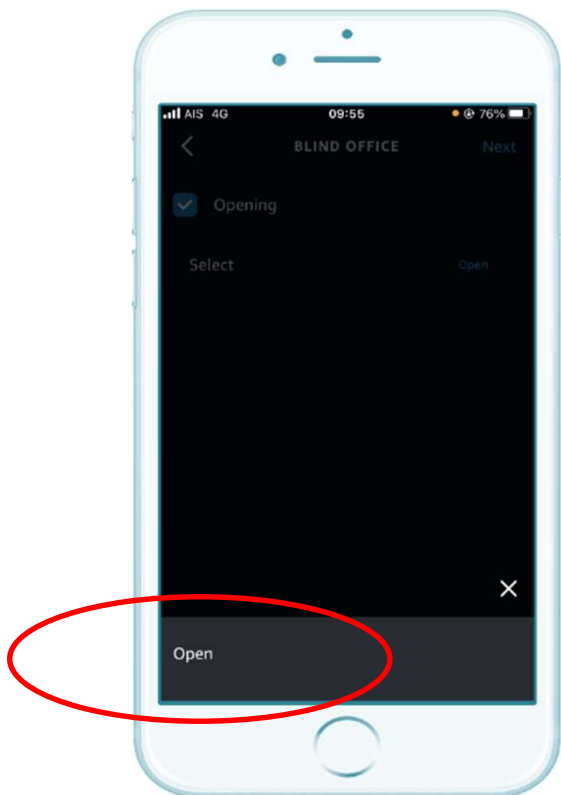



## 6. Other functions

### 6.1. Groups & Rooms



1. Groups & Rooms allow you to control group of devices all together.

6.2. Each group present a list of controllable devices. Each device can be enable or disable inside the group.

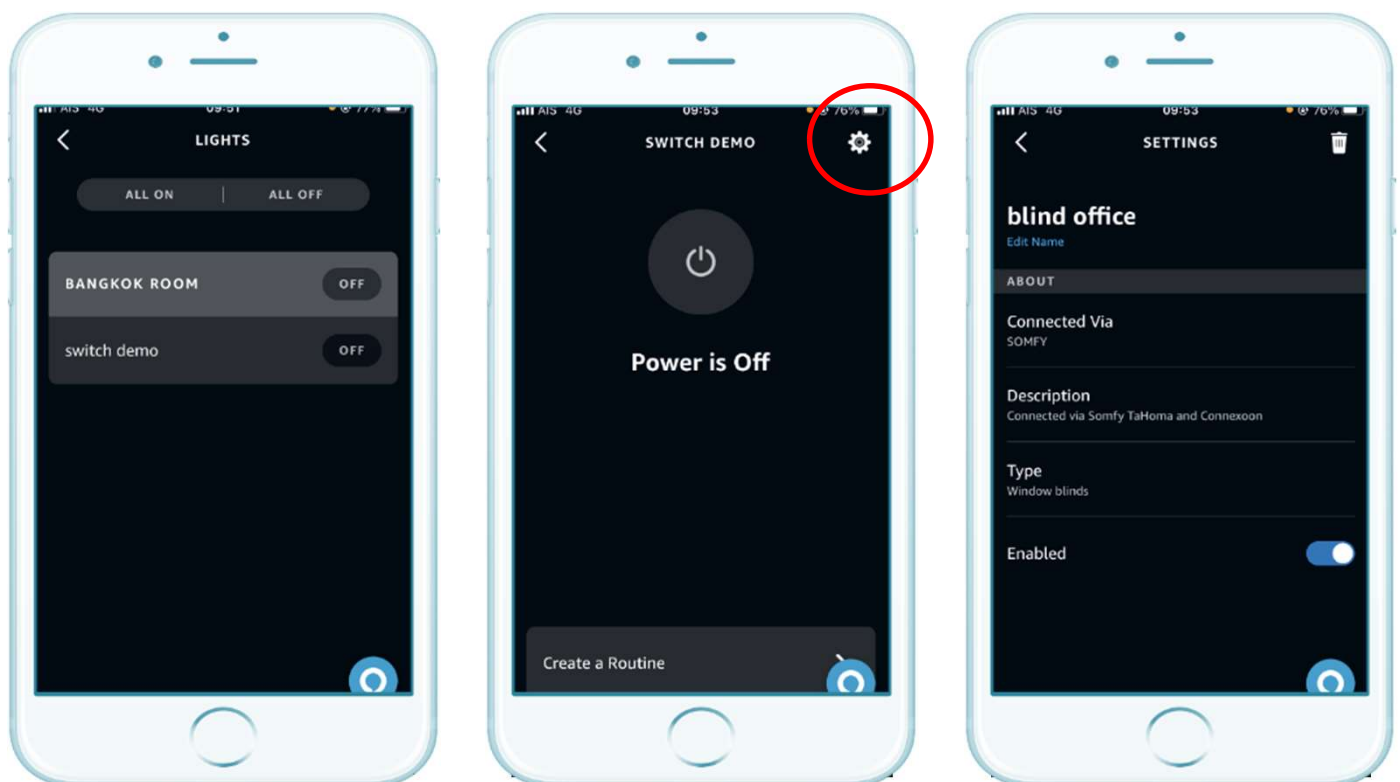

## 7. Trouble Shooting

ISSUE	REMEDY
I cannot find Tahoma by Somfy in the list of Skill in the mobile app.	Be sure that your <b>Amazon</b> profile is in one of the region supported.
I cannot enable Tahoma by Somfy Skill to my Amazon account.	Be sure that <b>Somfy</b> services are enable for your region.
After successfully enabled Tahoma by Somfy Skill, Alexa cannot find any devices or Scenario.	<ol style="list-style-type: none"><li>1) Retry disabling and enabling again the Skill in Alexa mobile app.</li><li>2) Try to enable the skill from the web interface on Amazon website.</li><li>3) Contact your local Somfy Support for resynch your gateway.</li></ol>
After successfully enabled Tahoma by Somfy Skill, Alexa can find my devices but not my scenario.	<ol style="list-style-type: none"><li>1) Retry disabling and enabling again the Skill in Alexa mobile app.</li><li>2) Try to enable the skill from the web interface on Amazon website.</li><li>3) Contact your local Somfy Support for resynch your gateway.</li></ol>

For a complete list of Countries and features supported by Alexa around the world please visit Amazon website:

<https://www.amazon.com/gp/help/customer/display.html?nodeId=202207000>