

**Welcome to the SQUARELY family. By choosing the SQUARELY planter, you help us spread the idea of conscious consumption and sustainable design. Our products are made from upcycled wood; our containers bring to life once used plastic.**

### Self-irrigation system

SQUARELY introduces the self-watering system to help you reduce watering efforts and keep the right moisture of the plants. To control the water level of the plants, remove the magnet plank with the SQUARELY logo, which reveals a water tank. Here you can also water the plant in the middle. You can water by using a watering can or if you share a passion for recycling like us, use an old wine bottle, it fits perfectly. To refill water tanks on the sides, simply lift the top boxes. Capillary straps take the water up to prevent your plants from drying out by keeping the right level of moisture in the soil.

### Plant instructions

Place a plant directly in the top box on the capillary mat. For plants that prefer less moist environments, leave a layer of sand or small stones on the top of the capillary mat. The first time you use a planter, pour water directly on the soil and fill up the bottom tank with 3 liters of water.

Always water additionally from the top, if the straps and water containers dry out.

#### Step 1:

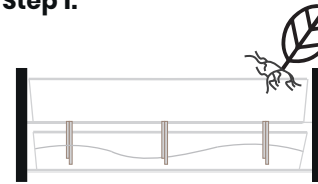

Place the plants into the plant-bag, directly on top of the capillary mat

#### Step 2:

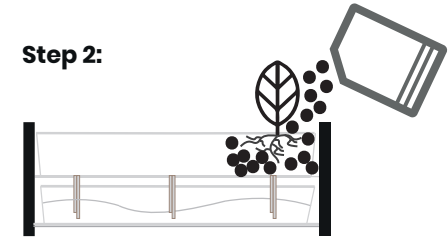

Fill up the plant-bag with the soil and press lightly down to tamp it

#### Step 3:

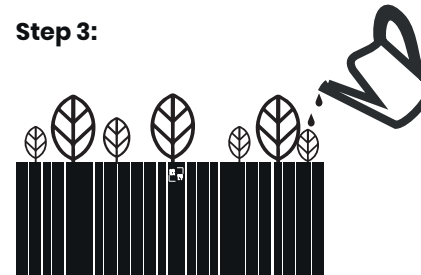

First time, pour water on the soil so it can run down to the water tank through the capillary straps .

#### Step 4:

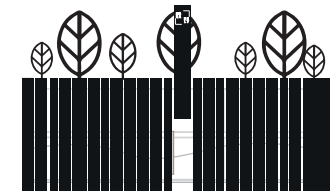

Detach the magnet plank with the Squarely logo and pull the water tank slightly forward to fill it up with water. Make sure that the water container is where the capillary straps are.

#### Step 5:



Refill the water tanks 1-3 times a month, depending on the season.

#### Step 6:

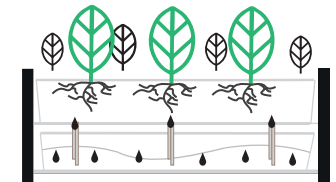

Through the capillary mats your plants absorb the water to fulfill their needs. The more water they need, the more they absorb.