



All-In-One

Railing System

[Surface Mount]

User Guide

1. Overview

Muzata All-In-One Railing System is a user-friendly complete kit, perfect for beginners. The package includes all the necessary components and tools for the cable railing system. Multiple length options are available, or you can customize it to suit your desired length with DIY flexibility. With the hidden and swageless design of the Muzata CB05 turnbuckle kit, you can enjoy a clean and easy railing system. Upgrade your space with the "All-In-One Railing System" to experience the perfect blend of functionality, style, and ease-of-use.

2. Specifications

Black powder-coated

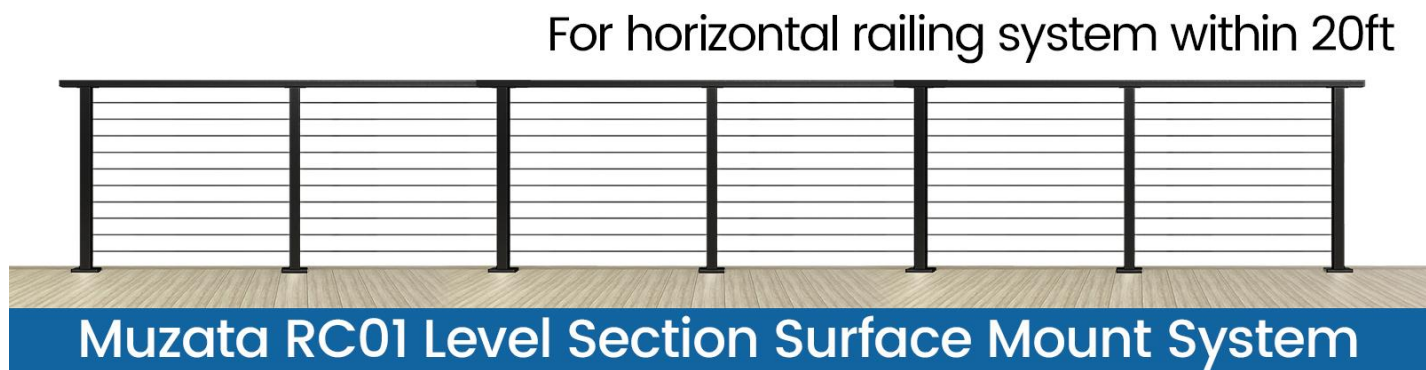
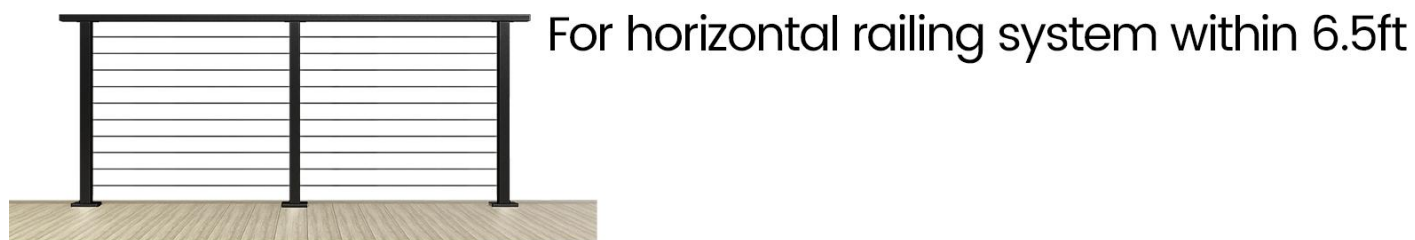

Brushed



For horizontal railing system within 6.5ft



For horizontal railing system within 13ft



For horizontal railing system within 20ft

Muzata RC01 Level Section Surface Mount System

Black powder-coated

Brushed

For stair railing system within 6.5ft

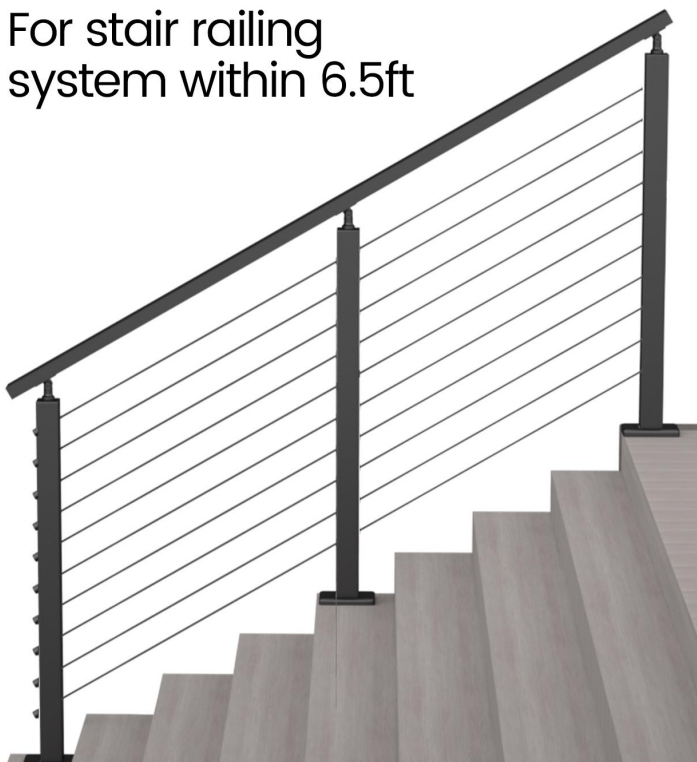

For stair railing system within 6.5ft

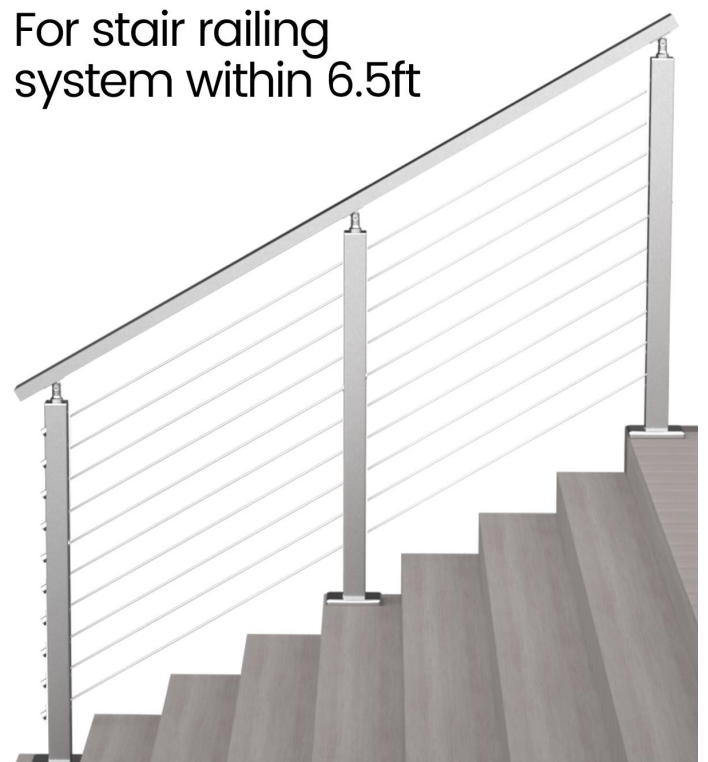





Muzata RC03 Stair Section Surface Mount System

Model Number	Dimension	Installation Section	Length Options	Finishing	Material
RC01	33"X2"X2" (36"=total height of post and handrail)	Horizontal	6.5ft 13ft 20ft	Black powder-coated	304 stainless steel
RC01			6.5ft 13ft 20ft	Brushed	304 stainless steel
RC03		Staircase	6.5ft	Black powder-coated	304 stainless steel
RC03			6.5ft	Brushed	304 stainless steel

3. Items related

For your convenience, we have provided a list of items in the packaging. Our all-in-one system accessories can be purchased separately. If your DIY system requires more related accessories, please search Muzata and the corresponding model number for additional purchase.

RC01 Level Section Surface Mount System

<p>1 Fixed-top post</p>  <p>PS02 BH4S PS02 LH4S</p>	<p>2 Pre-drilled Handrail</p>  <p>HT14 BP4 HT14 SL4</p>	
<p>3 Extension connector</p>  <p>HA35</p>	<p>4 End cap</p>  <p>HA12</p>	
<p>5 Cable railing kit CB05</p>  <p>(Tensioner) (Fixed end)</p>		

6 Stainless steel cable



WR19

WR01

7 Adhesive washer



CR66

8 Socket wrench



CT16

9 Cable cutter



CR12

RC03 Stair Section Surface Mount System

10 Adjustable-top post



PS01 BA4S

PS01 LA4S

11 Pre-drilled Handrail



HT14 BP4

HT14 SL4

12 Adjustable-top bracket



13 Extension connector



HA35

14 Cable railing kit

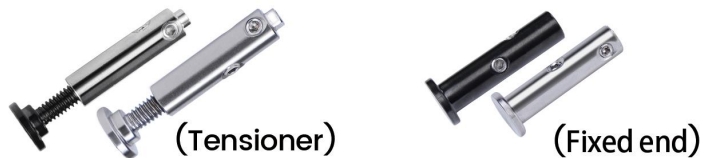

(Tensioner)

(Fixed end)

CB05

15 End cap



HA12

16 Stainless steel cable



WR19

WR01



4. Installation Steps

Please note that the installation steps for the black and brushed all-in-one cable railing systems are the same, and the installation steps shown below are based on the black cable railing system as a template.

4.1 [For RC01] Level Installation

4.1.1 Cable Railing Posts Installation

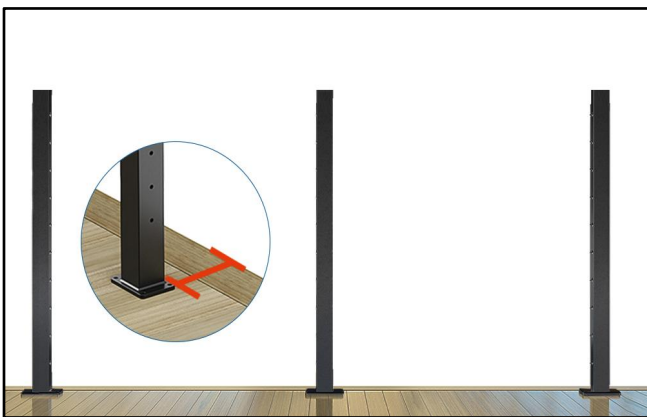

Step 1 - Determine the distance between the foot plate and the edge of the deck.

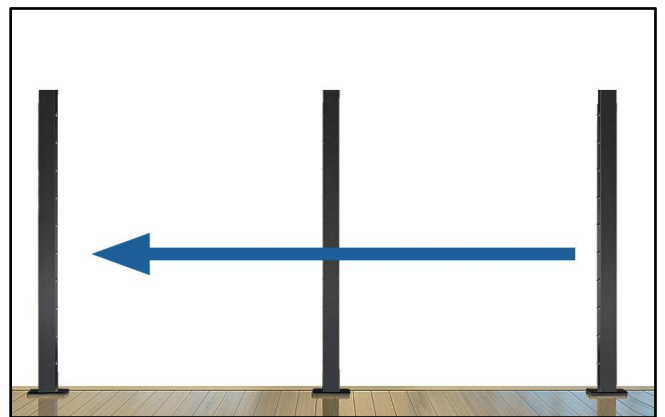

Step 2 - Draw a horizontal line to ensure that the posts **1** are aligned.



Step 3 - Mark the hole positions.



Step 4 - Drill 1/4" pilot holes.



Step 5 - Thread four screws through the washer and tighten them with a wrench.



Step 6 - Install the foot cover.

4.1.2 Brackets Installation



Step 1 - Mount the fixed top bracket onto the top of the post **1** with M6 bolts.

4.1.3 Handrails Installation

(1) Installation of Two Handrail Connectors



Step 1 - Cover the connector cover onto the base **3** and screw the set screws into the base.

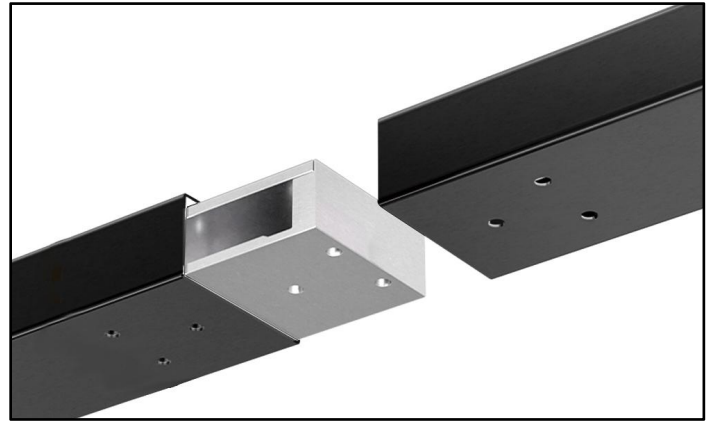

Step 2 - Insert the extension connector **3** and align the holes in two handrails **2**.

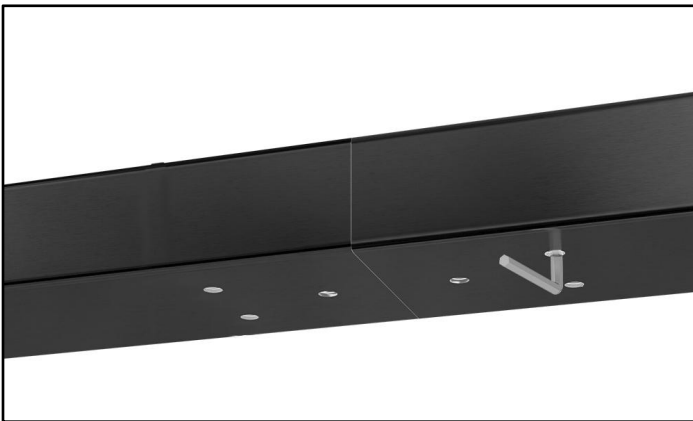

Step 3 - Tighten the set screws until the connector **3** is completely tapped in handrails **2**.

(2) Install The Handrails onto The Posts



Step 1 - Place the installed handrails **2** onto the post **1** and align it with the holes.



Step 2 - Install the M5x14mm bolts.

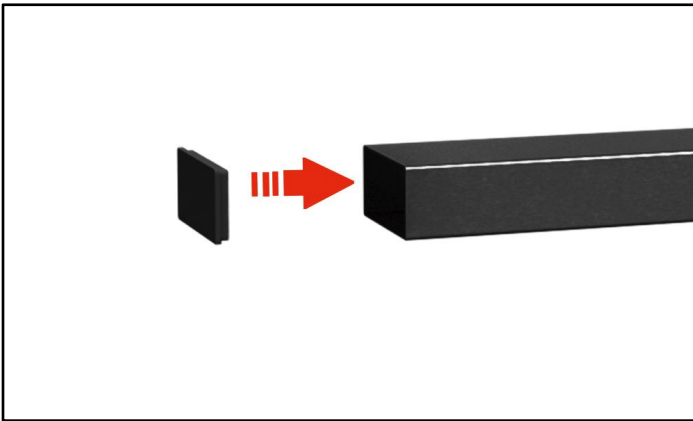

Step 3 - Install the end caps **4**.

4.1.4 Terminal and Cable Installation

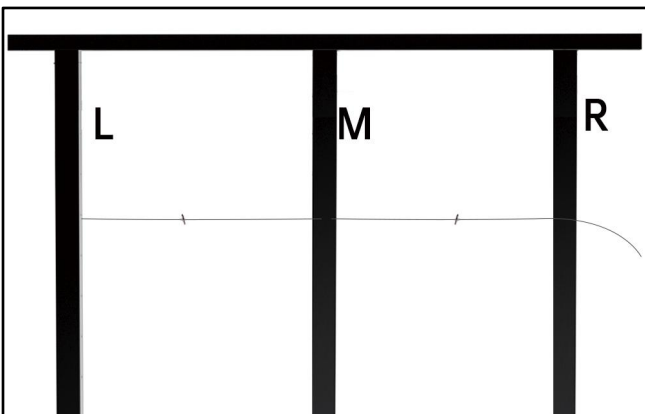

Step 1 - Pass the cable from the right post to the left post, put in adhesive washer **7** for both L&R posts.

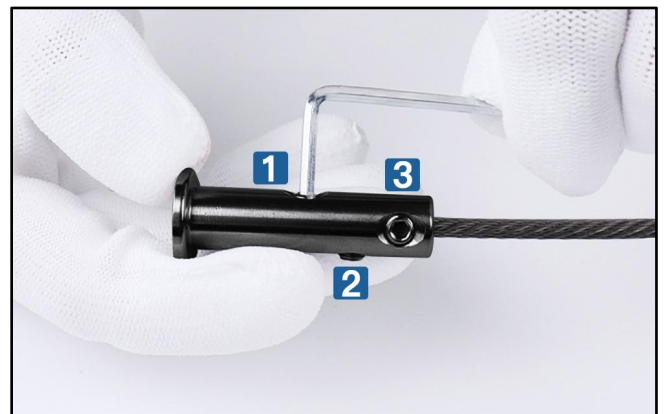

Step 2 - Put the cable **6** into the fixed end **5** and tighten the set screws in sequence with the 2.5mm Allen wrench.

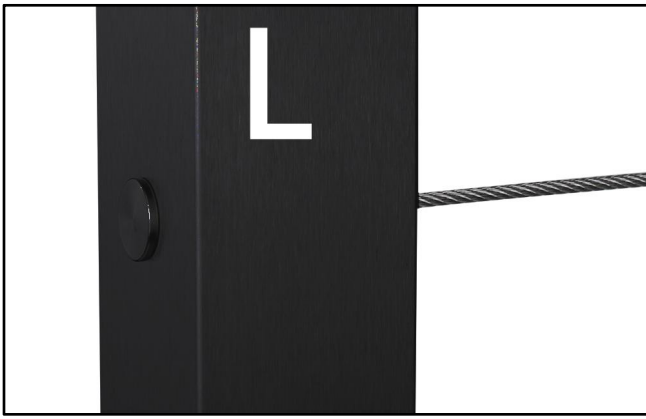

Step 3 - Install the fixed end **5** to the left end post.

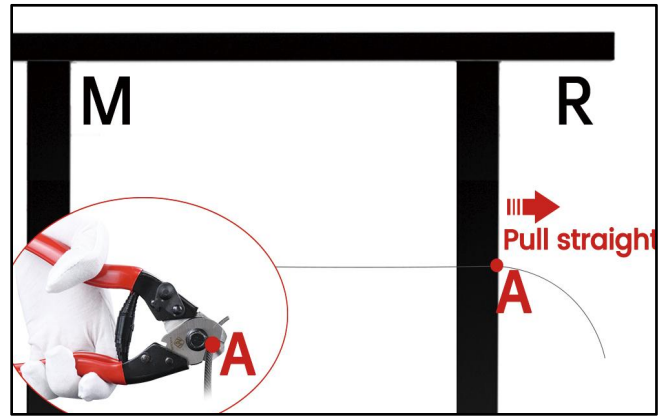

Step 4 - Pull the cable against the right end post, mark point A from the outside of R post, and cut cable on point A with cable cutter **9**.

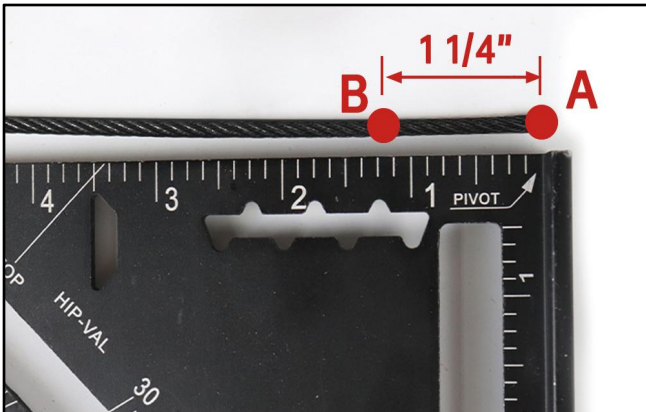

Step 5 - Cut at point B with cable cutter **9**, which is 1 1/4" away from point A.



Step 6 - Put the cable into the tensioner **5** and tighten the set screws in sequence with the 2.5mm Allen wrench.

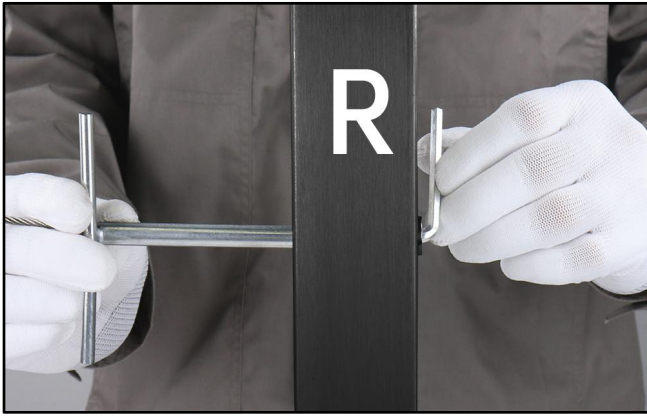

Step 7 - Tighten the tensioner with socket wrench **8** and 5mm Allen wrench on the right end post.



Step 8 - Install the adhesive washers **7**.



Step 9 - Follow the sequence to install other cable runs.

4.2 [For RC03] Stair Installation

4.2.1 Cable Railing Posts Installation

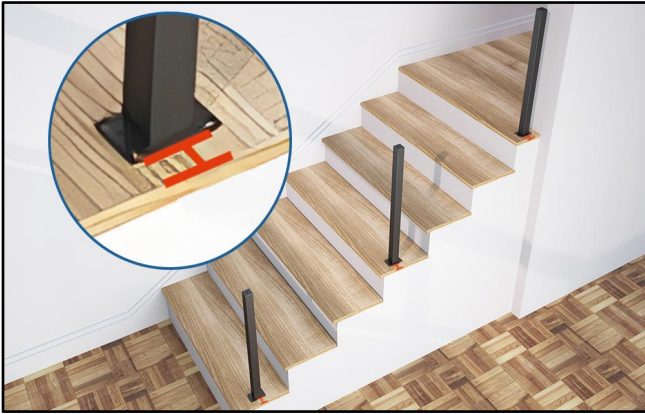

Step 1 - Determine the distance between the foot plate and the edge of the deck.



Step 2 - Draw a horizontal line to ensure that the posts **10** are aligned.

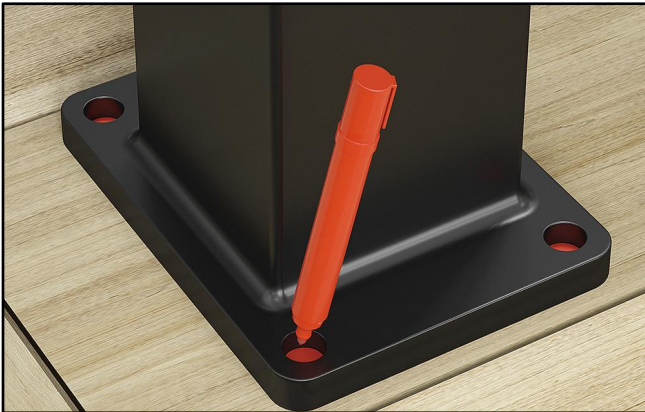

Step 3 - Mark the hole positions.



Step 4 - Drill 1/4" pilot holes.



Step 5 - Thread the four screws through the washer and tighten them with a wrench.



Step 6 - Install the foot cover.

4.2.2 Brackets Installation



Step 1 - Install the bracket base **12** to the post **10** with 5mm Allen wrench.

4.2.3 Handrails Installation

(1) Installation of Two Handrail Connectors



Step 1 - Cover the connector cover onto the base **13** and screw the set screws into the base.

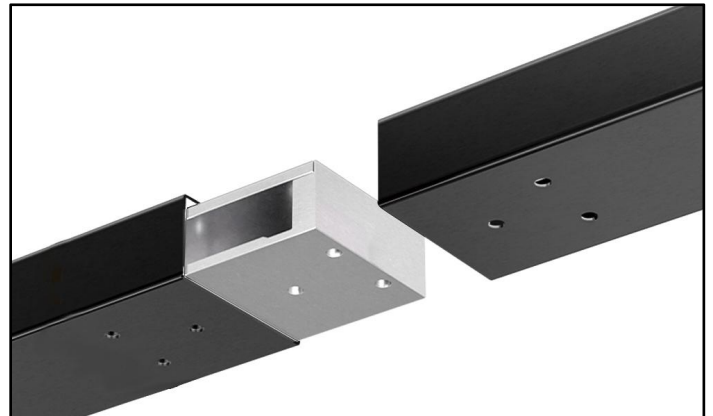

Step 2 - Insert the extension connector **13** and align the holes in two handrails **11**.

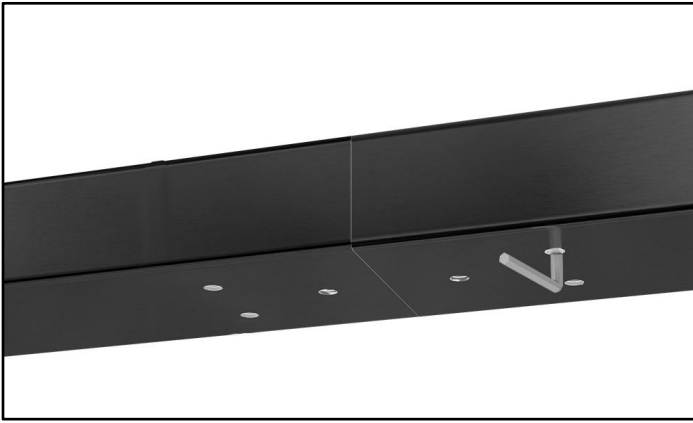

Step 3 - Tighten the set screws until the connector **13** is completely tapped in handrails **11**.

(2) Install The Handrails on The Posts



Step 1 - Connect the adjustable bracket **12** to the handrails **11**.



Step 2 - Place the installed handrails **11** onto the bracket **12** with holes aligned and tighten the screws.



Step 3 - Install the M5x14mm bolts.

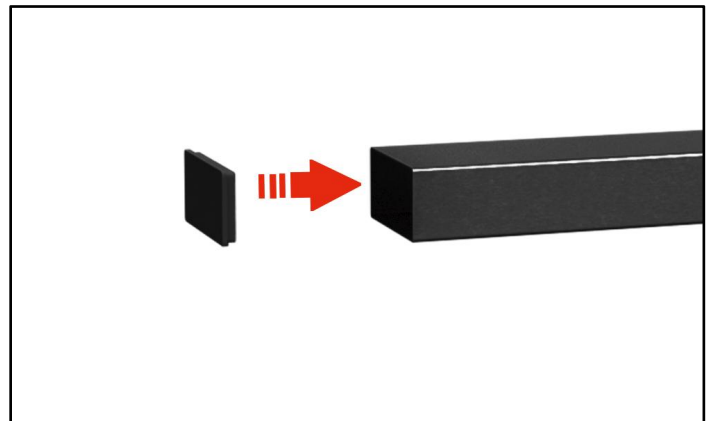

Step 4 - Install the end caps **15**.

4.2.4 Terminal and Cable Installation

We will install the tensioner on the right end post as an example. Actually, you can install it on either side according to your need.

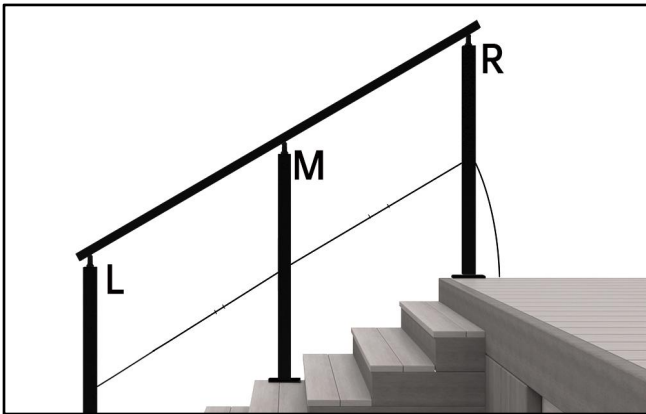

Step 1 - Pass cable **16** from the right post to the left post, put in adhesive washers **17** for all posts.

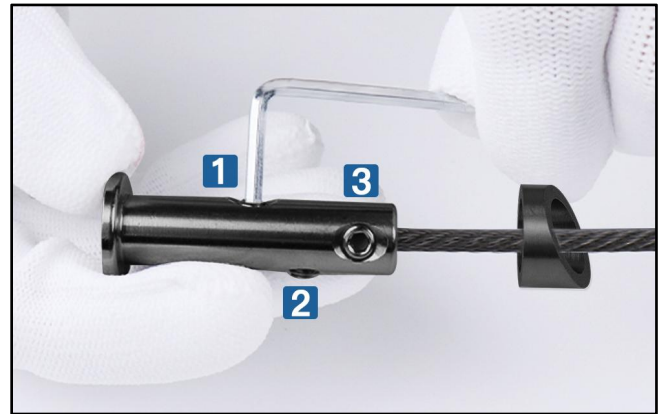

Step 2 - Put in angle washer **18** before tightening the set screws in sequence with the 2.5mm Allen wrench.

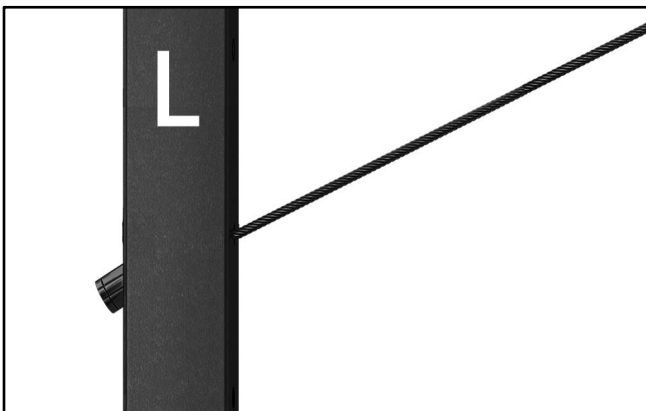

Step 3 - Install the fixed end **14** to the left end post.

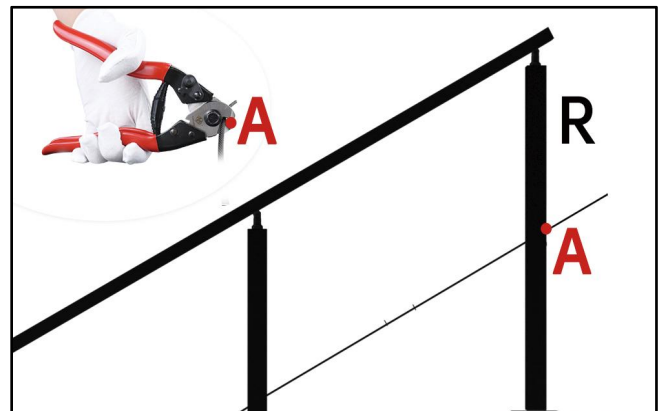

Step 4 - Pull the cable against the right end post, mark point A from outside of the right post, and cut cable on point A with cable cutter **20**.

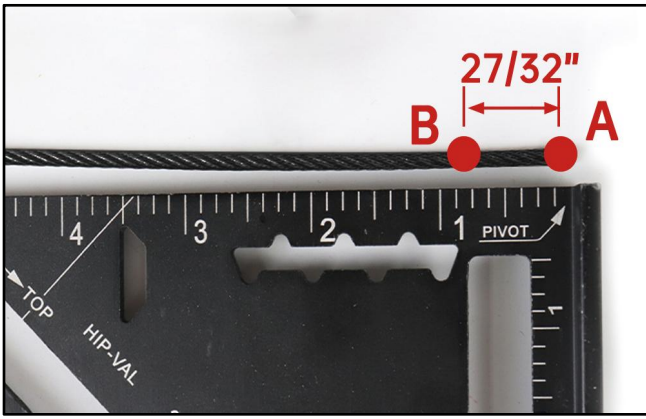

Step 5 - Mark and cut at B, which is $27/32$ " away from point A, with cable cutter **20**.

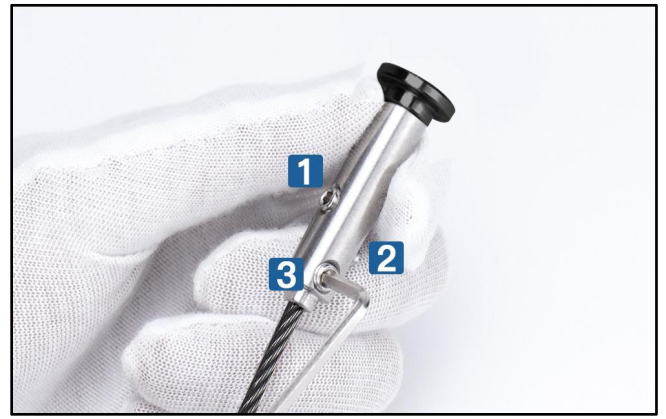

Step 6 - Put the cable into the tensioner **14** and tighten the set screws in sequence with 2.5mm Allen wrench.

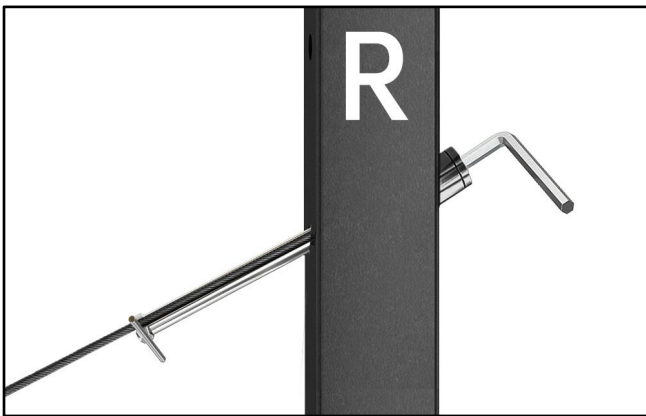

Step 7 - Put in angle washer **18** before tightening the tensioner **14** with socket wrench **19** and 5mm Allen wrench on the right end post.



Step 8 - Install adhesive washers **17**.

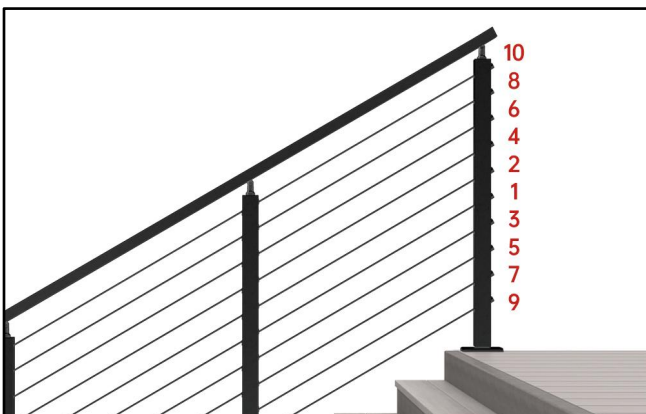

Step 9 - Follow the sequence to install other cable runs.

Please note that installation videos are available on our product pages for further details if needed.

5. Tips

- (1) Ensure that your posts and handrail are properly installed before you start cable installation.
- (2) Our all-in-one system accessories can be purchased separately, if your DIY system requires more related accessories, please search Muzata and the corresponding model number for additional purchase.
- (3) The recommended post spacing between two posts is 3ft-4ft, no more than 4ft. For our 6'6" handrails, it would be best to adopt 3'3" post spacing.
- (4) The overall height of the railing, which is the structure of the post and handrail, should be equal to or higher than 36" to meet the residential building codes of most states.
- (5) 3" cable spacing and 200 lbs tension on each cable line are recommended to pass the 4" sphere test (required by most states). You can buy a tension gauge online or from local stores.

6. Free design service

We offer custom cable railing design services for free. If you are a beginner or not sure about how to do it, please reach us. Our experts can do all the planning, designing, and budget work for you without extra charge.

7. About Muzata

Muzata has helped millions of families with their cable railing projects during the past years. We believe that home renovation should be easy and affordable. So we work with every effort to provide quality products and professional service, to make Muzata a reliable brand.

Follow us



@Muzata railing



@muzata_official



@muzata_official



@muzata_official