

Heretic

BEYOND LUMENS

Ford Bronco 21+ Interior // Axis Mount Install Guide



Heretic

1168 West 500 North Suite 500
Centerville UT, 84014
801-725-4824
Support@hereticstudio.com

Heretic

BEYOND LUMENS

IMPORTANT: Please read all instructions before beginning installation. These guidelines are provided in good faith to help prevent any issues arising from errors during installation. The manufacturer of this product shall not be held responsible for any user actions taken or not taken during installation. There are many details of the installation that are assumed to be general mechanical knowledge to experienced installers; which are not detailed in these instructions. These installation guidelines are intended to serve as professional recommendations and are not as a step-by-step, fail-safe installation checklist. Selection of an experienced installer is the sole responsibility of the project owner. Buyer is solely responsible for (and will indemnify and hold seller harmless for) any claims, losses, damages, fines, fees, costs, or other amounts arising out of Buyer's non-compliance with these installation instructions.

Always disconnect any power sources connected to your vehicle before servicing fuses or electrical systems.

Tools Needed for Install:

- T25, T30 Torx screw driver
- 8mm, 10mm socket wrench
- Panel Pry tool
- Wire Running Tool
- Tape / Zip Ties
- Crimp Tool
- Wire Cutters

Kit Contents:

- 1x Power Switch Harness
- 2x 84 Inch Extension
- 2x 42 Inch Extension
- 2x Y Splitter
- 3x Diffused Dome Light
- 1x Axis Mount
- 2x 45° Bracket
- 1x M6 Nyloc and washer
- 2x M6 - 40mm bolt and washer
- 2x 3/4" Inch Spacer
- 1x M5 Torx screw
- 2x M5 Washers

Ford Bronco ('21+)

Step 1: Pop the hood of the Bronco and location the positive and negative terminals on the battery. Route the "power Switch Harness" along existing wires and zip tie in place. Don't connect the ring terminal to the battery or run the switch, that will be done at the end of the install.

Next, Route the wires along the fender towards the fire wall. Attach one of the "84 Inch Extensions" to the "Power Switch Harness." Take note to attach it correctly by matching the colors and bullet style connector as indicated in the image below.

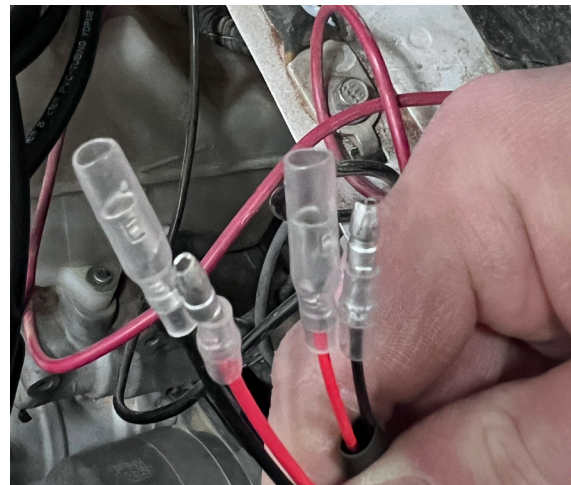
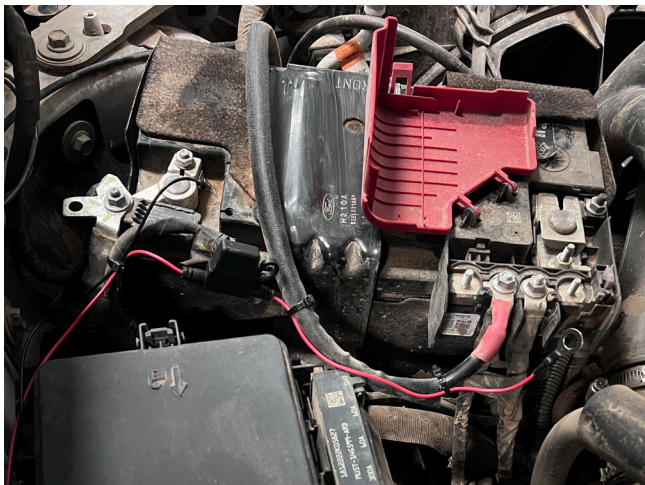

Step 2: Locate the OEM wire grommet. The wires will need to run through that grommet. We recommend using a large plastic zip tie (picture on the Left). Be careful to avoid any of the factory wiring when running through the firewall.

When routing the wire through the grommet, use electrical tape and tape a generous portion of the other end of the extension to the large plastic zip tie or wire running tool. Before pulling the wire, thoroughly apply some glass cleaner to the taped area. The glass cleaner will lubricate the wire going through the grommet and make it significantly easier to pull through.

NOTE - Some Broncos come with an unused grommet that can also be used. That grommet is indicated with an arrow.



Step 3: With the wires ran through the firewall, the next step is to route them to the back of the vehicle. The door seal panel and dash handle will need to removed.

Start by removing four T30 Torx screws from the handle located on the side of the dash. Then remove the plastic trim panel along the door seal by pulling it the towards the back of the vehicle. With the panel removed, route the harness away from the firewall towards the door seal.



Next, pull the seal that runs up the A-pillar, remove the trim covering the roof latch, and remove the trim panel that covers the air bag. Taking off the driver side roof might be necessary to get the latch cover off, due to the stiffness of the clips. The air bag trim panels are held in by five 8mm bolts that will need to be removed. Once all of the panels are removed, route the wire up the A-pillar, keeping the wire behind the air bag.

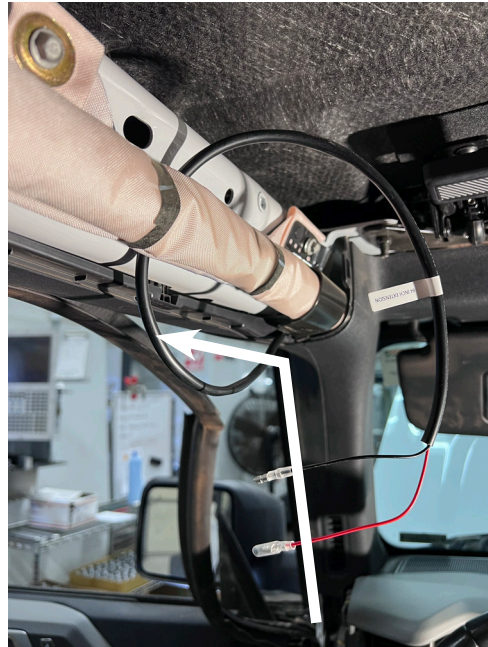

With the wires run, connect the one of the "Y Splitters" to the "84 Inch Extension" followed by the dome light and one of the "42 Inch Extensions." Route the "42 Inch Extension" toward the rear keeping the wire behind the air bag. Connect the rear interior light using another "Y Splitter" followed by an "84 Inch Extension" and route the wire down the B pillar and back towards the rear cargo area.

When mounting the dome lights all of the air bag panels will need to be re-installed. We recommend, first, getting the wires tucked away and set to right lengths before re-installing the panels and mounting the dome lights.

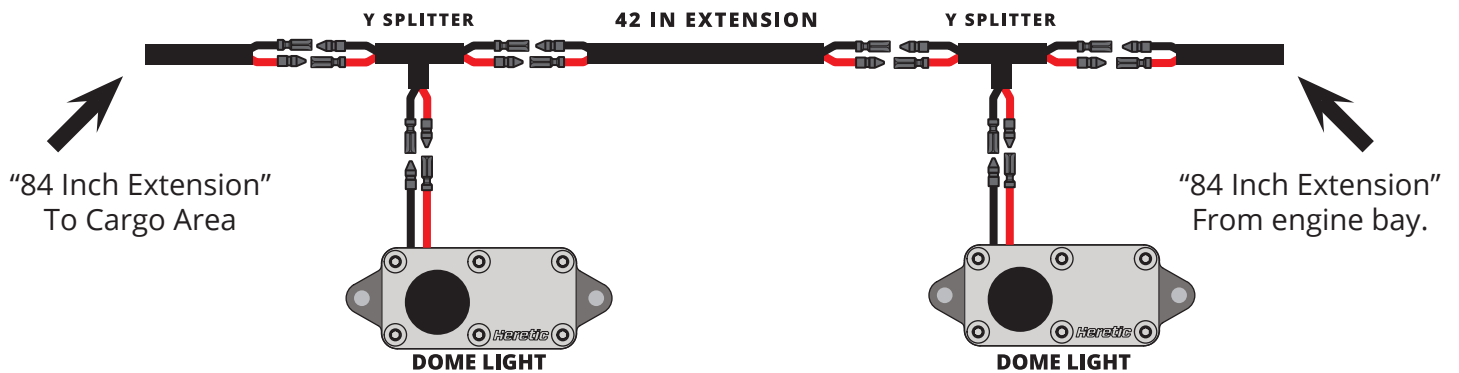

MOUNTING BRACKET

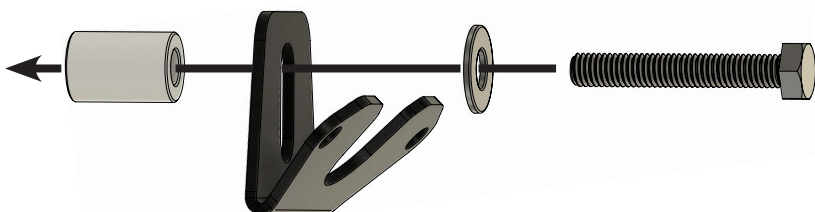

Next, route the wires behind the cargo area panels and zip tie the end next to the plug indicated in the image. Excess wire can be hidden behind the cargo area panels.

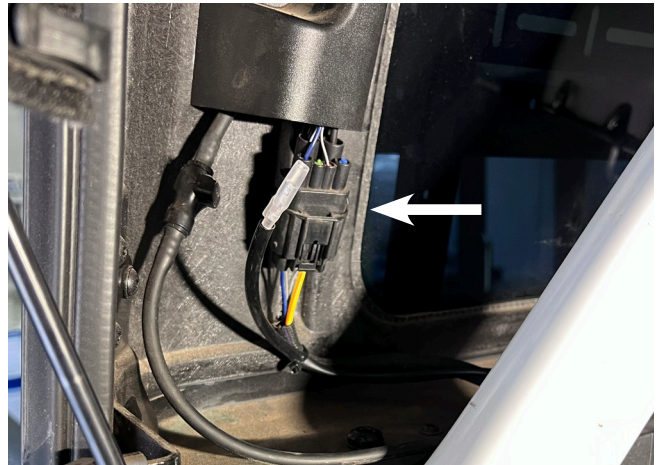

Step 4: With the wire routed to the back, the next step will be to removed the trim panels around the rear windshield and mounting the lights. The rear panels can removed by taking out six T25 Torx screws.



Once the panels are removed, attach the "42 Inch Extension" to the "84 Inch Extension." Route the wire following the OEM wiring, bundling the wire behind th panel. Next, mount the light in the lower cutout with the provided hardware. The washers can be used if the bolts bottom out before getting tight.

NOTE- If installing additional lights connect the "Y-Splitter" at the first light followed by the "42 Inch Extension" and then to the additional light.



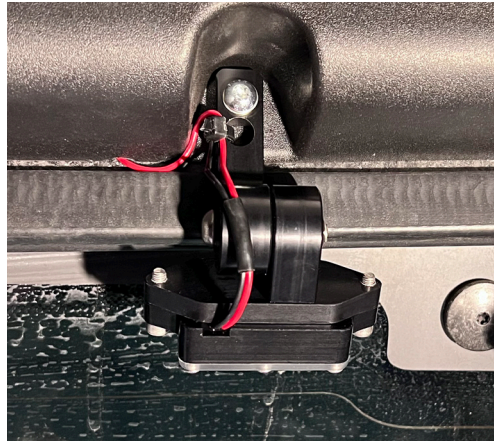

Step 5: Connecting the power. To supply constant power to the lights the on and off switch will need to be cut off. Cut the switch as indicated in the diagram and connect the 2 red wires together using the barrel connector.

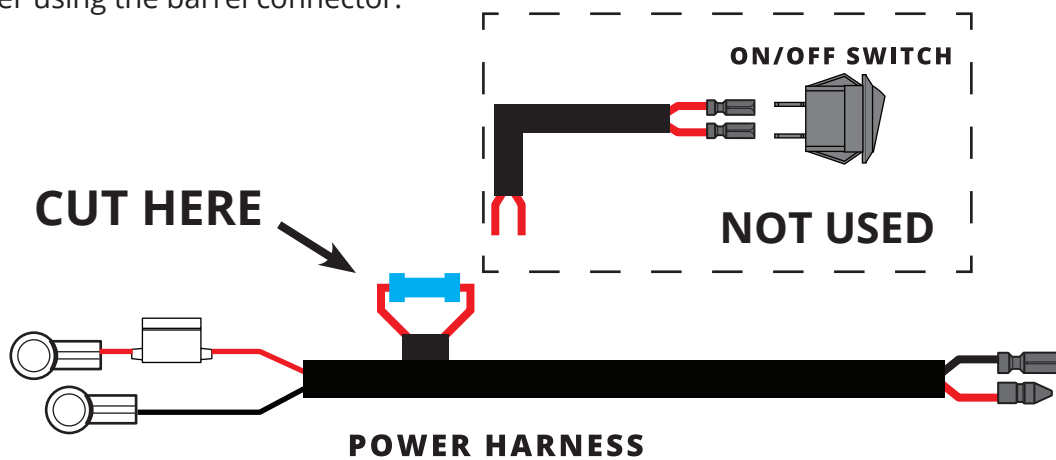

Step 6: Connect the ring terminals to the battery using the supplied M6 nut/washer and test the functionality of the lights. Once the functionality is checked, re-install any remaining panels in the reverse order.

Your install is now complete! Thanks for choosing Heretic!



@hereticstudio

Heretic
BEYOND LUMENS