

CERT NEWSLETTER

August 2018 “*Training And News For The Monterey COMMUNITY EMERGENCY RESPONSE TEAM*”. A citizen based, volunteer emergency response team!
CERT IS FUNDED BY THE CITY OF MONTEREY!



Prepare as if your life depends upon it, because it does!

Monterey CERT is establishing a Firefighter Re-habilitation service. During the course of a major incident, firefighters exert heavily and need periodic relief where they can cool their body temperatures, rest and hydrate. This vital function is covered in the National Fire Protection Association (NFPA) Standard 1584. There is a complete FEMA/CERT supplemental module on instruction in providing firefighter rehab. We already have all the tools and equipment necessary to provide this service in the trailer. **Training will occur August 11th from 8:30-11:30. IF YOU WISH TO PARTICIPATE IN THE TRAINING AND HAVE UNDERGONE CERT BACKGROUND CHECKS, REPLY HEREIN BY EMAIL. WE WILL SEND A CONFIRMATION.**



Training Refresher: CERT Traffic Management.

Blocked roadways are a common occurrence during storms and other emergencies. CERT members can be called upon to provide traffic management when Police, Fire and other resources are overwhelmed. It is vital to remember **CERT Priority #1: EVERYONE HOME SAFE!** With this in mind, **it is critical that we do not place CERT members in a roadway or traffic pattern.** We have 20 large orange/reflective safety cones in the CERT trailer, more are available. **We use the cones to block the roadway, with CERT members remaining in a safe zone.** In the patterns shown below, cones are used to designate a traffic detour on the roadway, with CERT members off the roadway (shown below with the designation “Flaggers”) but still able to direct the flow of vehicles. Flaggers need to maintain radio contact, using one of the MURS radio channels. MURS are found in channel settings 11-15 in all CERT radios. Direct the traffic to flow one direction at a time.

Straight Roads (cont'd)

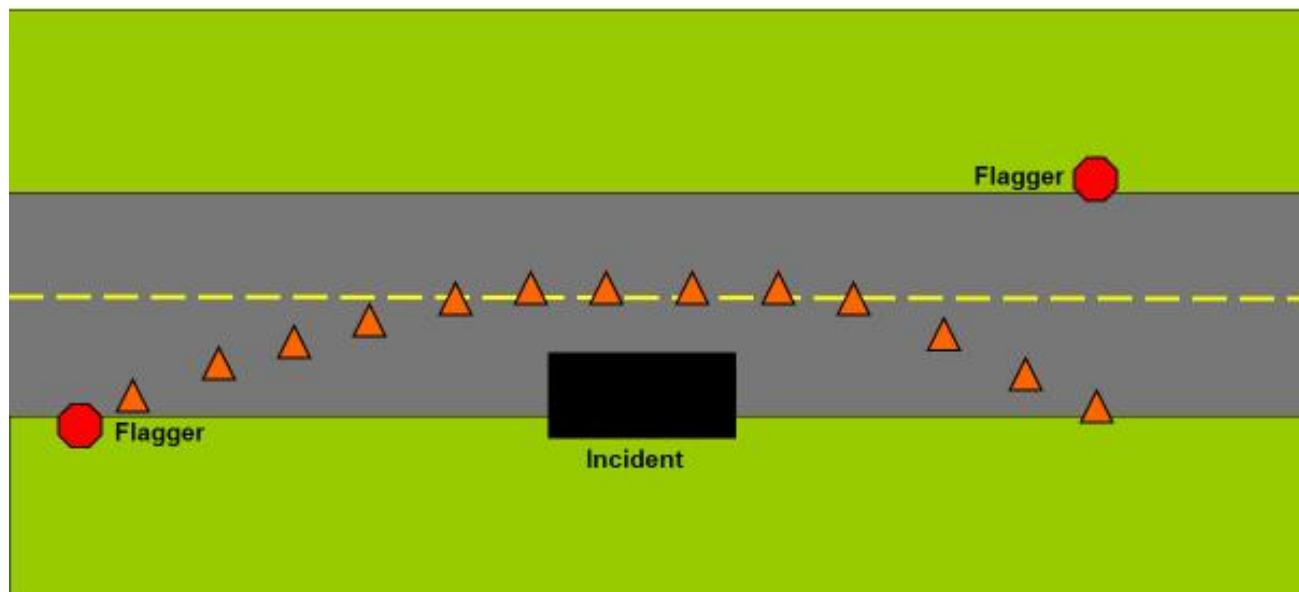

Curved Roads

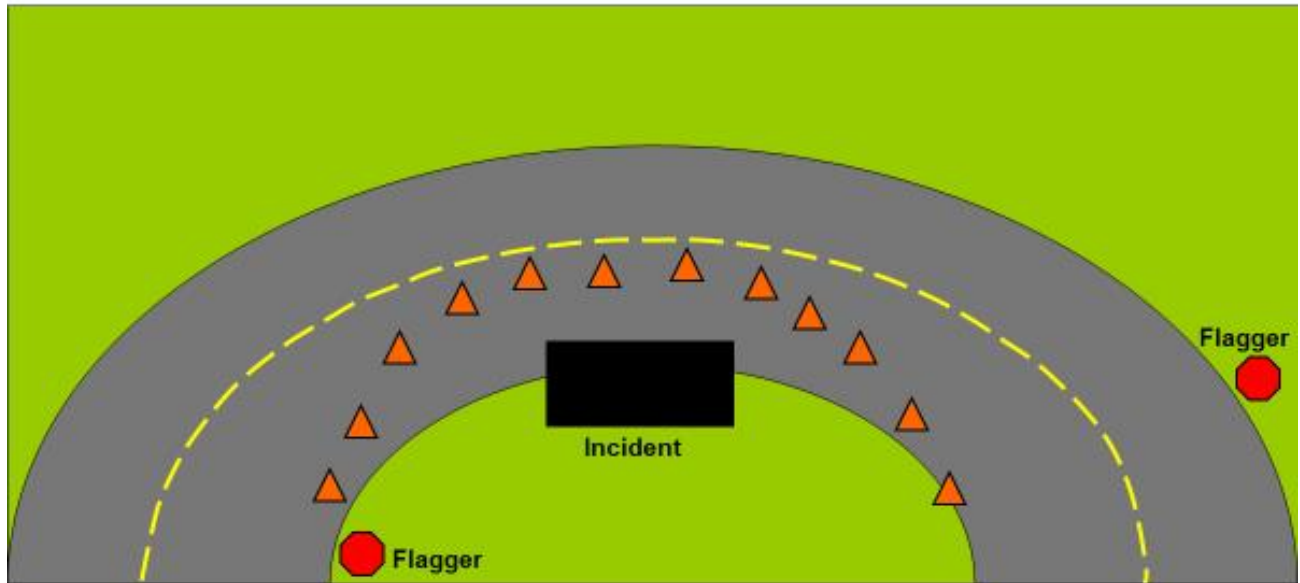

When asked who we are or who gave us authority to effect traffic management, put the responsibility on law enforcement, i.e. “Monterey Police have closed the road. They requested CERT to provide traffic management until the roadway can be cleared”.



Always wear your CERT safety clothing to include your reflective, yellow vest and helmet. CERT is often called upon at night where visibility is vital for safety.

Improvements Made To CERT Trailer! Our sincerest thanks to CERT Zone Captain **Gene Rizzo** for manufacturing and installing a gasoline can container on the trailer. Custom made of stainless steel, this was no small task! This addition allows us to safely carry and transport gasoline, thus allowing us to begin and maintain generator operations for quite some time. Thank-you Gene!



CERT Across America: Fresno, CA CERT provides Firefighter Re-had at a fire scene (Home St. & 1st).



Fresno California CERT provides a robust Firefighter Rehabilitation service which delivers tools and equipment to emergency scenes. The service sets-up a location for firefighters to rest, cool their body temperatures and hydrate. **Monterey CERT will soon provide the same locally!**

CERT CLASS STARTS SEPTEMBER 6th



The Community Emergency Response Team (CERT) Program uses a FEMA curriculum to educate people about disaster preparedness for hazards that may impact their area and trains them in basic disaster response skills, such as fire safety, light search and rescue, team organization, and disaster medical operations. Using the training learned in the classroom and during exercises, CERT members can assist their families and others in their neighborhood or workplace following an event when professional responders are not immediately available to help. CERT also participates in searches for missing persons, serves as coastal spotters for persons swept out to sea, storm response and other emergencies.

Learn These Skills and Many More:

Emergency Medicine
Use of a fire extinguisher
Disaster Preparedness
Shutting your utilities
Rescue

Communications when phones fail
Assessing your home or workplace after an
earthquake or storm

All classes are taught in Monterey. **Anyone** may enroll by sending an e-mail of interest to: training@montereycert.org You will receive a confirmation with class details.

This class provides 24 hours of community service credit to High School Students!

The next CERT class begins Thursday, September 6, 2018 and continues each Thursday night through October 18th. Class time each day is 6:20-9:30 P.M.

Attendance at all seven sessions is necessary to complete the training and graduate. To enroll, send an email to: training@montereycert.org



You're invited to a

POTLUCK BARBECUE

Come, enjoy, and celebrate our communities and our collective efforts to promote preparedness, a timely response, and resilience.



Let us know what you plan to bring!

- Appetizer
- Burgers and rolls
- Side Dishes
- Desserts
- Beverage (non-alcoholic)

<https://www.signupgenius.com/go/20f0c4da9a82fa20-summer>

Where: CONA Park

735 Ramona in Monterey CA

**PLEASE SIGN UP before August
15, 2018**

<https://www.signupgenius.com/go/20f0c4da9a82fa20-summer>

Questions? Contact Sarah Blackstone
at sarahblack@aol.com or
call 649-3050

Who:

CERT team members, families, friends,
professional first responders,
neighbors, public officials, emergency
workers, community members

When: August 18, 2018

11:00 to 2:00 PDT

Monterey County Office Of Emergency Services (OES) Has An Updated Website.

The Monterey County Office of Emergency Services is responsible for the following:

- Ensure all phases of emergency management are addressed in strategic planning efforts, building the core capabilities and disaster resiliencies within the communities of Monterey County;
- Organizing, staffing and operating the OA EOC;
- Provide information and guidance to the public and elected officials including emergency warning and alerting
- Provide resource management inventories of critical assets, supplies and equipment necessary to support emergency response and recovery operations;
- Reviewing and maintaining internal and external emergency operations plans and preparedness programs for the Operational Area
- Ensure that emergency planning follows state and federal guidance.
- Identifying and analyzing potential hazards and recommending appropriate mitigation measures
- Conduct on-going emergency preparedness and educational campaigns
- Serving as the emergency management point of contact for government officials, public safety, organizations, nonprofit and community based organizations, city, county and private industry partner and stakeholders.

This link will take you to the site:

<http://www.co.monterey.ca.us/residents/find/advanced-components/office-of-emergency-services-3697>

CERT TEAM LEADER LIST

TEAM	LAST NAME	FIRST NAME	E-MAIL
CONA	Ruccello	Richard	rruccello@aol.com
CONA	Brassfield	Michael	monami@redshift.com
Crml	Leighton	Hunter	hunterhunterhunter@gmail.com
DMB	Blackstone	Sarah	sarahblack@aol.com
DMB	Swisher	Gerald	concretescarecrow@gmail.com
DV	Rose	Connie	constancerose05@gmail.com
DV	Hanson	Scott	stanh831@gmail.com
FH	Jones	Sherman L.	shermj831@gmail.com
FH	Weber	Forest	fweber1965@yahoo.com
MH	Mastrangelo	John	jmastrangelo@mpusd.k12.ca.us
MV	Alameda	Lisa	alameda738@att.net
NM	Rizzo	Gene	tangorizz@aol.com
OG	Dawson	Mike	mike@dawsonmonterey.com
OG	Whitney	Lee	lwhitney306@gmail.com
OT	Netzorg	Greg	thezorgs1@comcast.net
OT	Rasmussen	Thor	thor@mbay.net
OT	Preti	Isabelle	Isapreti@sbcglobal.net
PG	Oder	Broeck	bnoder@gmail.com
SL	Kastros	Demetrius	demekastros@msn.com
SL	Duke	Dennis	dduke01@sbcglobal.net
SL	Pasquinelli	Art	pasquin@redshift.com

Key: **CRML** Carmel **CONA** Casanova/Oak Knoll **DMB** Del Monte Beach **FH** Foothill **MH** Monterey High
MV Monte Vista **NM** New Monterey **OG** Oak Grove **OT** Old Town **PG** Pacific Grove **DV** Dela Vina **SL** Skyline

If you live in Seaside, Fort Ord, Marina or areas north along Highway 1, report to Dela Vina. If you live in Salinas or along the Monterey/Salinas Highway, report to Foothill. If you're in Pebble Beach and use the PG gate, report to Pacific Grove, if you use the Carmel Hill gate, report to Skyline. If you live South of Hwy. 1 & Carpenter Streets, report to Carmel.

Be prepared! Maintain home emergency supplies, hold regular smoke detector drills, know where your neighborhood CERT container is and be familiar with the contents. If it's been more than two years since you took CERT training, refresh your skills at the next final exercise October 18th at 6:20 P.M. Staging is the EOC. Reply to this email to enroll: training@montereycert.org