



DUCABIKE

Kit istruzioni/installation kit - **Streefighter V4**

art. TTV402

Ducabike consiglia di far effettuare il montaggio da un meccanico specializzato
Ducabike recommends to have the installation done by a specialized mechanic

MADE IN ITALY

N. - COD.	Qt.
-----------	-----

- | | |
|----------------------|---|
| ① - VISPO3 | 2 |
| ② - RTT40X7.5 | 2 |
| ③ - VITE/SCREW M5x16 | 1 |
| ④ - VITE/SCREW M5x35 | 1 |

NOTE

ATTENZIONE:

Prima di RIMUOVERE la vite OEM, tenere il motore in appoggio su un supporto

ATTENTION:

Before REMOVING the OEM bolt, keep the engine raised by a stand

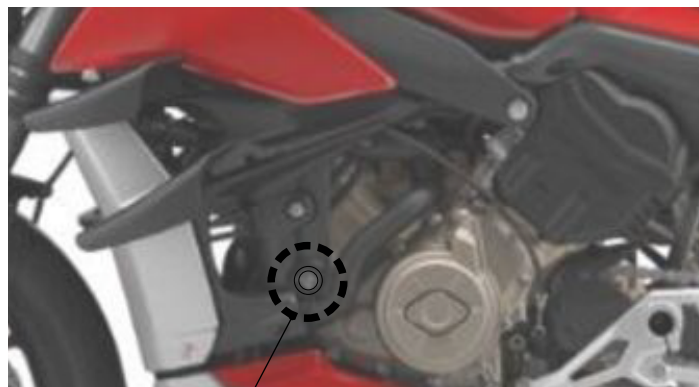

LATO SX/LEFT SIDE

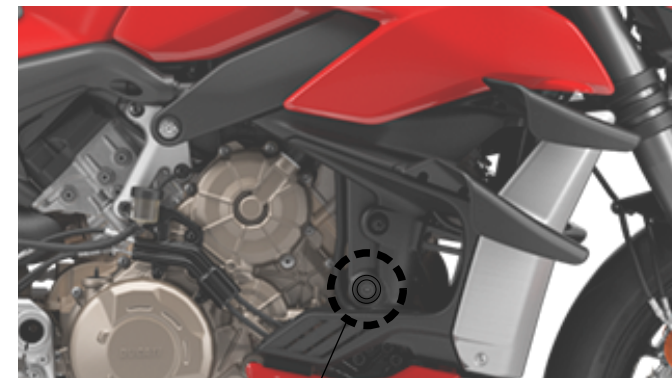

LATO DX/RIGHT SIDE

1^a - Operazione
1st - Operation

2^a - Operazione
2nd - Operation

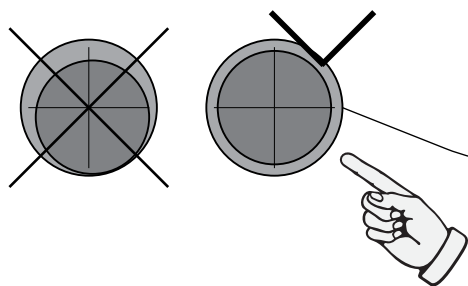

Utensili/Tools

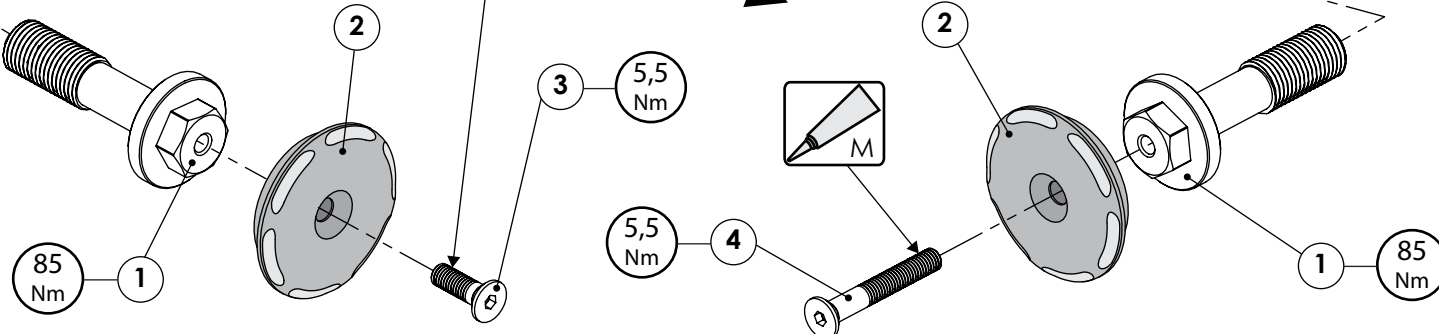
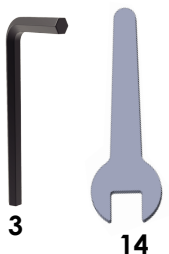



DUCABIKE

Kit istruzioni/installation kit - **Streetfighter V4**

art. TTV402

Ducabike consiglia di far effettuare il montaggio da un meccanico specializzato
Ducabike recommends to have the installation done by a specialized mechanic

MADE IN ITALY

N. -	COD.	Qt.
① -	VISP03	2
② -	RTT40X7.5	2
③ -	VITE/SCREW M5x16	1
④ -	VITE/SCREW M5x35	1

- ① - VISP03 2
 ② - RTT40X7.5 2
 ③ - VITE/SCREW M5x16 1
 ④ - VITE/SCREW M5x35 1

NOTE

ATTENZIONE:

Prima di RIMUOVERE la vite OEM, tenere il motore in appoggio su un supporto

ATTENTION:

Before REMOVING the OEM bolt, keep the engine raised by a stand

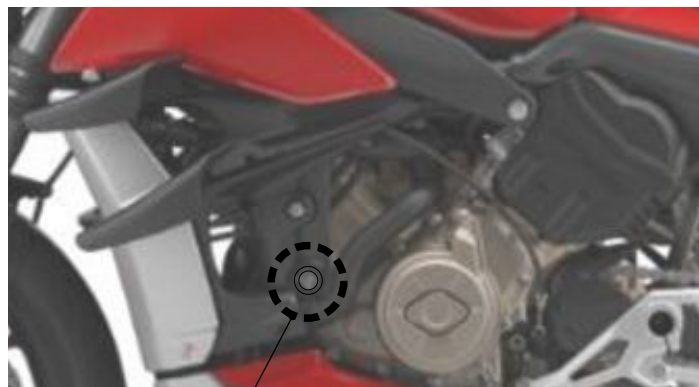

LATO SX/LEFT SIDE

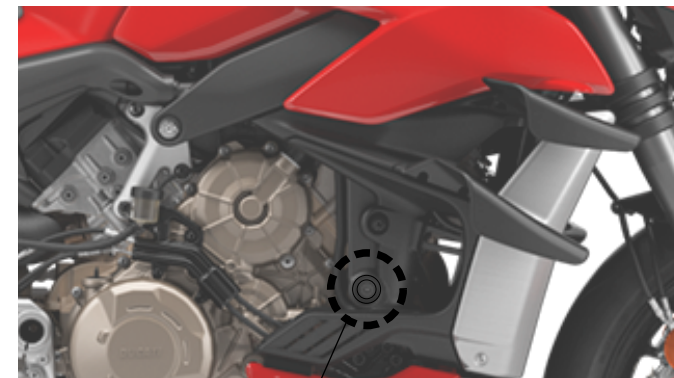

LATO DX/RIGHT SIDE

1^a - Operazione
1st - Operation

2^a - Operazione
2nd - Operation

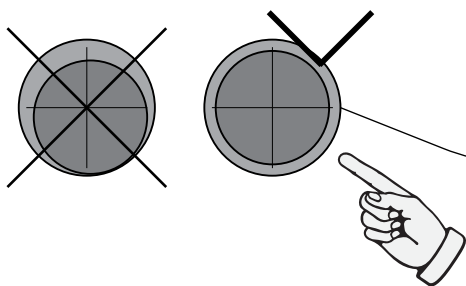

Utensili/Tools

