

👁 Note!

Before installing this product, check the contents of the kit. If anything is missing, please contact an Öhlins dealer.

Kit Contents

Description	Part No	Pcs
Shock absorber	YA 761	
Sticker Öhlins	00192-01	2
C-spanner	60710-02	1
Owner's manual	07421-02	1
Bracket footrest	60006-01	1
Bracket reservoir	03102-15	1
Screw M6x14	00382-16	1
Screw M6x12	01046-36	2

👁 Note!

Please note that this image is a general representation of the product and may differ slightly from your product.

👁 Note!

Please note that during storage and transportation, especially at high ambient temperature, some of the oil and grease used for assembling may leak and stain the packaging. This is in no way detrimental to the product, wipe off the excessive oil/grease with a cloth.

⚠ Warning!

Before installing this product, read the Öhlins Owner's Manual. The shock absorber is an important part of your vehicle and will affect the stability.

Shock Absorber for Yamaha Spark 135i

YA 761

Mounting Instructions



MOUNTING INSTRUCTIONS

⚠ Warning!

It is advisable to have an Öhlins dealer install the shock absorber.

⚠ Warning!

If working on a raised vehicle, ensure it is securely supported so that it will not tip over.

👁 Note!

Before mounting this product clean the vehicle thoroughly.

👁 Note!

When working on this product, always see the Vehicle Service Manual for vehicle specific procedures and important data.

1

Put the motorcycle on a work stand, so that the rear shock can be safely removed.

1

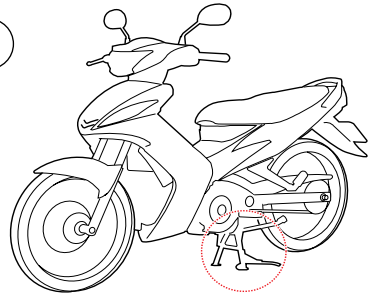

MOUNTING INSTRUCTIONS

2

Open the seat and remove the rear panel by loosening the two screws.

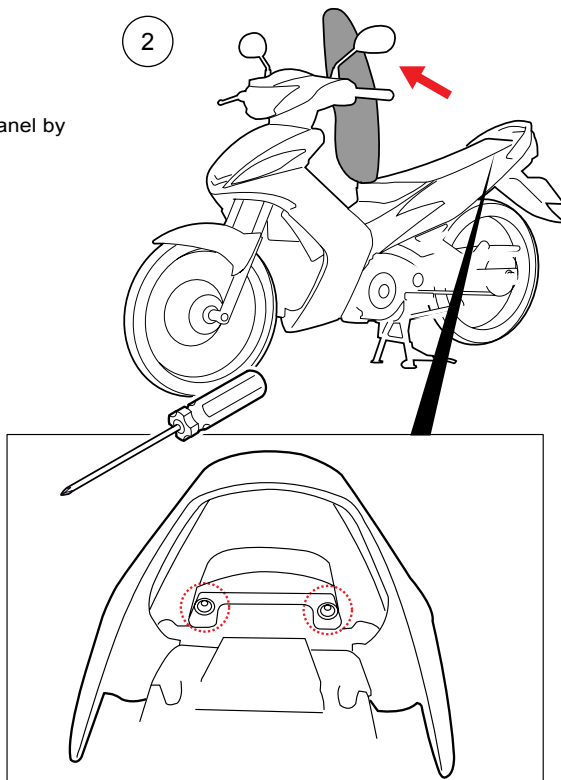

MOUNTING INSTRUCTIONS

3

Remove the center panel (lower) by loosening the screw and the two bolts.

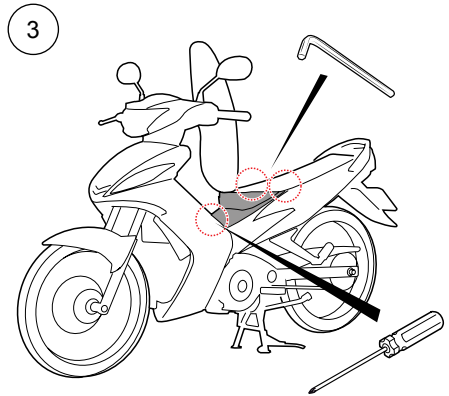

MOUNTING INSTRUCTIONS

4

Remove the cover on both side by loosening the five bolts.

4

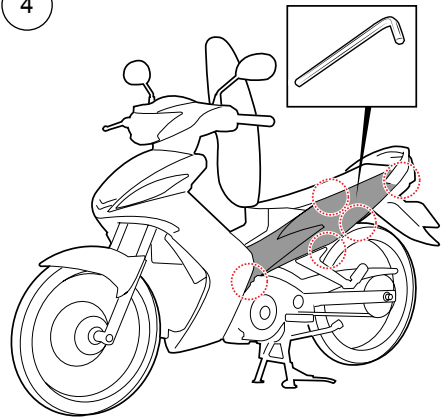

MOUNTING INSTRUCTIONS

5

Remove the standrad shock by loosening the upper and the lower shock absorber bolts.

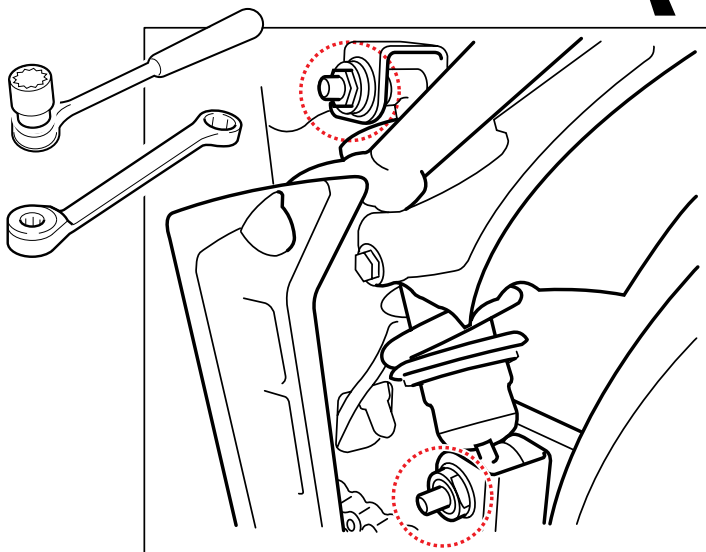
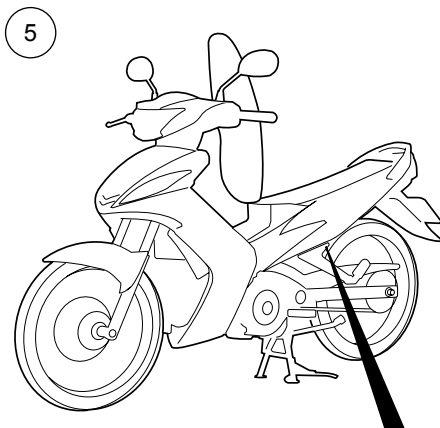

MOUNTING INSTRUCTIONS

6

Remove the passenger footrest.

Assembly the reservoir clamp on to the bracket.

Reassembly the passenger footrest together with the reservoir bracket.

Install Öhlins shock absorber with the reservoir and hose as in the picture.

Tighten the bolts according to the vehicles work shop manual.

Reverse all procedures to reassembly the vehicle.

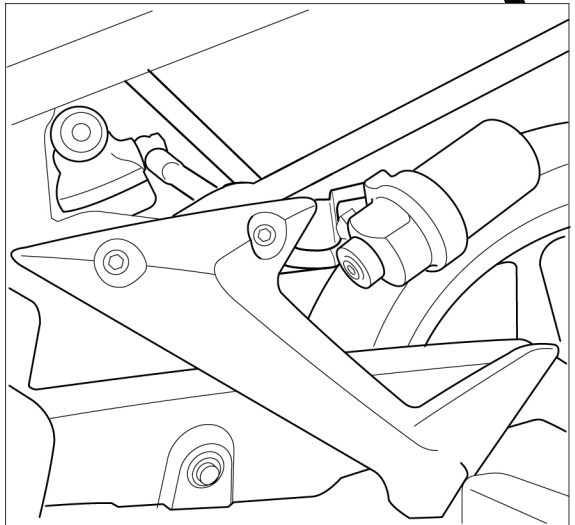
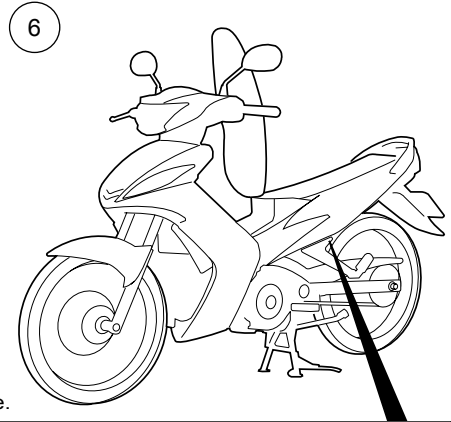

Note!

Lower the vehicle so that the suspension is slightly compressed before tightening the screws.



Caution!

Ensure that all screws are tightened to the correct torque and that nothing fouls or restricts movement of the shock absorber when the suspension is fully compressed or extended.

ADJUSTMENTS

⚠ Warning!

Before riding, always make sure that the basic settings made by Öhlins are according to recommended Set-up Data. Read about adjustments and setting up in the Öhlins Owner's Manual before you make any adjustments. Contact an Öhlins dealer if you have any questions about setting up.

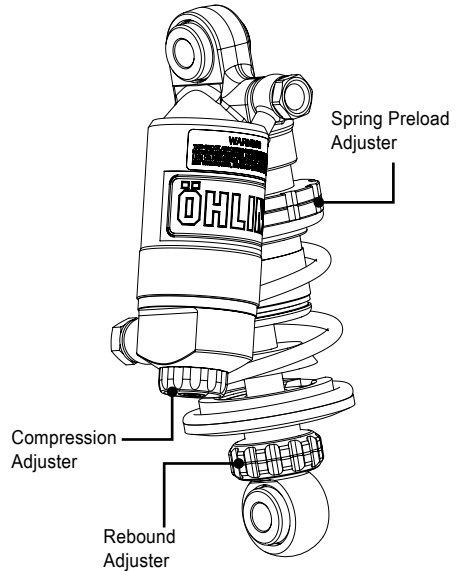

SET-UP DATA

Recommended set-up

Spring Preload	3 mm
Compression Adjuster	12 clicks
Rebound Adjuster	14 clicks

Shock absorber data

Length	197 mm
Stroke	30 mm

Spring

Part No	60015-01
Free spring length	85 mm

👁 Öhlins products are subject to continuous improvement and development, therefore, although these instructions include the most up-to-date information available at the time of printing, minor updates may occur.

To find the latest information contact an Öhlins distributor. Please contact Öhlins if you have any questions regarding the contents in this document.

Part no. MI_YA 761_EN_0
Issued 2018-02-05

© Öhlins Asia Co. Ltd. All rights reserved. Any reprinting or unauthorized use without the written permission of Öhlins Racing AB is prohibited.

Öhlins Asia Co. Ltd
700/937 Moo5, Tambol Nongkhaga,
Amphur Phantong, Chonburi Province
20160 Thailand



www.ohlins.com