



FP0199

FITTING INSTRUCTIONS FOR FP0199BK FORK PROTECTORS
BMW K1600GT SE 2017-

Page | 1



THE ABOVE PICTURES MAY BE REPRESENTATIVE ONLY

THIS KIT CONTAINS THE ITEMS PICTURED AND LABELLED BELOW.
DO NOT PROCEED UNTIL YOU ARE SURE ALL PARTS ARE PRESENT.

Please note that the way the kit is packed does not necessarily represent the way of mounting to the bike

Please note that in cases where kits are packed with a plastic tube separating components on the spindle bar (this tube should be discarded).

THE PARTS SHOWN MAY BE REPRESENTATIVE ONLY (FOR CLARITY OF INSTRUCTIONS ONLY)

Digital copies of these instructions are available to download from www.rg-racing.com

GENERAL TORQUE SETTINGS

M4 BOLT = 8Nm
M5 BOLT = 12Nm
M6 BOLT = 15Nm
M8 BOLT = 20Nm
M10 BOLT = 40Nm



FP0199

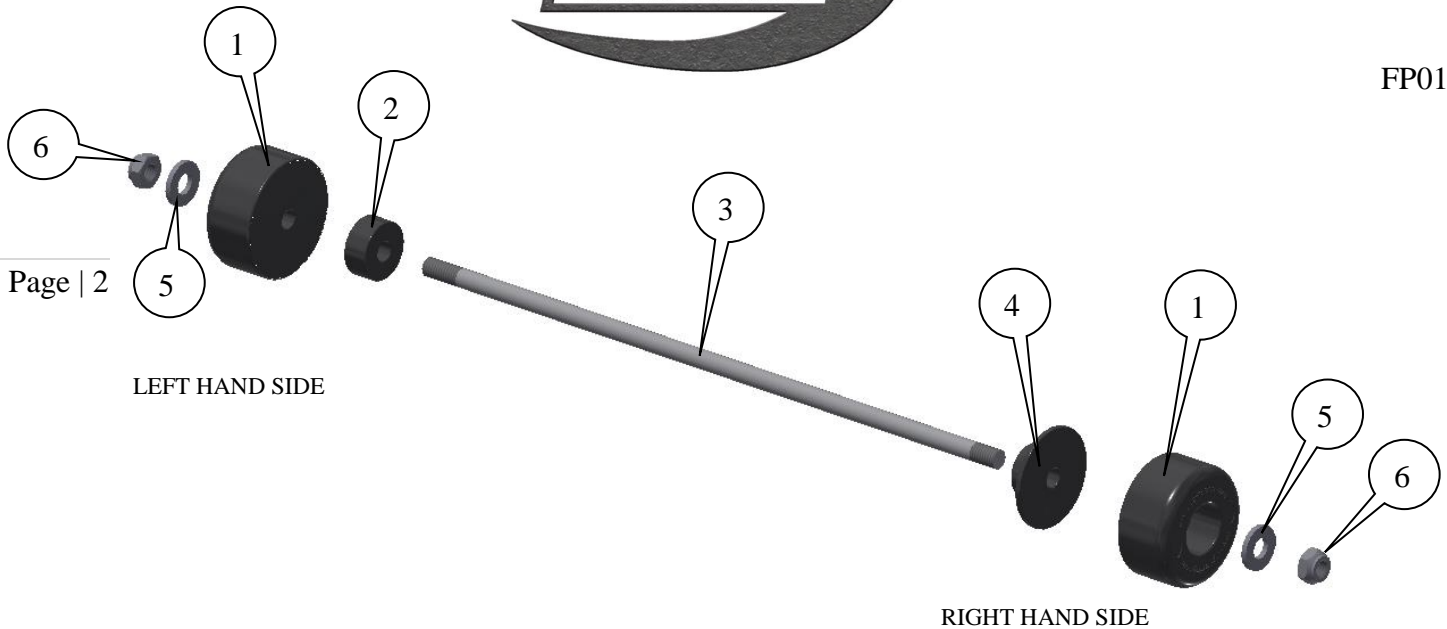

LEGEND

- ITEM 1 = CRASH PROTECTORS (L & R-H-S) (B0442 M8) (x2).
- ITEM 2 = SPACER (L-H-S) (S1057 – 10.75mm LONG) (x1).
- ITEM 3 = SPINDLE BAR (SB013 – 290mm LONG) (x1).
- ITEM 4 = SPACER (R-H-S) (S1058 – 13mm LONG) (x1).
- ITEM 5 = M8 NYLOC NUTS (x2).
- ITEM 6 = M8 WASHERS (x2).

TOOLS REQUIRED

- Socket set to include 2x13mm A/F sockets and wrenches.

FITTING INSTRUCTIONS

- Fit one nut (item 6) and washer (item 5) onto the shorter thread of the spindle-bar (item 3), engage the nut so the plastic insert of nut is fully engaged.
- Feed spindle-bar with nut and washer through either crash protector (item 1) and through the smaller spacer (item 2), as shown above.
- Place this assembly through the front wheel spindle from the left-hand side (as you sit on the motorcycle), so the spacer locates into the spindle recess.
- Place the remaining larger spacer (item 4) over the exposed end of the spindle bar on the right-hand side so that the spigot end locates into the spindle as shown above.
- Place the remaining crash protector (item 1) over the exposed end of the spindle bar on the right-hand side.
- Fit the remaining washer and nut (items 5 and 6) from kit onto thread and tighten until both nuts are engaged in nylon and equal amounts protrude from either side (please ensure the logo is located at the top of the crash protector). Do not overtighten – the nyloc nuts will hold it tight.

ISSUE 1 08/08/2017 (NSY)

**CONSUMER NOTICE**

The catalogue description and any exhibition of samples are only broad indications of the Products and R&G may make design changes which do not diminish their performance or visual appeal and supplying them in such state shall conform to the order. The Buyer acknowledges no representation or warranty (other than as to title) has been given or will apply to the Products other than those in R&G's order or confirmation and the Buyer confirms it has chosen the Products as being of merchantable quality and suitable for its particular purposes. Where R&G fits the Products or undertakes other services it shall exercise reasonable skill and care and rectify any fault free of charge unless the workmanship has been disturbed. The Buyer is responsible for ensuring that the warranty on the motorcycle is not affected by the fitting of the Products. On return of any defective Products R&G shall at its option either supply a replacement or refund the purchase money but shall not be liable if the Products have been modified or used or maintained otherwise than in accordance with R&G's or manufacturer's instructions and good engineering practice or if the defect arises from accident or neglect. Other than identified above and subject to R&G not limiting its liability for causing death and personal injury, it shall not be liable for indirect or consequential loss and otherwise its liability shall be limited to the amounts paid by the Buyer for the Products or the fitting or service concerned. These terms do not affect the Buyer's statutory rights.

R&G RACING RETURNS POLICY (NON-FAULTY GOODS)

Returns must be pre-authorised (if not pre-authorised the return will be rejected). Goods may only be returned direct to us if they were purchased direct from us (customer must prove if necessary). Otherwise to be returned to original vendor. Goods must be in resellable condition, in the opinion of R&G Racing. All returns are subject to a 25% restocking and handling fee (25% of the gross value exc. P&P – at the prevailing price at time of purchase). The customer must pay any and all carriage charges. No returns of discontinued products, unless within 14 days of purchase. This policy does not affect your statutory rights and does not refer to faulty goods.

R&G Racing

Unit 1, Shelley's Lane, East Worldham, Alton, Hampshire, GU34 3AQ

Tel: +44 (0)1420 89007 Fax: +44 (0)1420 87301 www.rg-racing.com Email: info@rg-racing.com



FP0199

NOTICE DE MONTAGE POUR FP0199BK PROTECTIONS FOURCHE
BMW K1600GT SE 2017-

Page | 4



LES PHOTOS CI-DESSUS SONT UNIQUEMENT REPRÉSENTATIVES

LE KIT CONTIENT LES ARTICLES EXPOSES CI-DESSOUS, VERIFIER QUE TOUTES LES PIECES SOIENT PRESENTES AVANT DE PROCEDER AU MONTAGE.

LA FAÇON DONT LE KIT EST EMBALLE NE CORRESPOND PAS FORCEMENT A LA FAÇON DE MONTER LES PIECES SUR LA MOTO.

NOTEZ QUE SI LES KITS SONT EMBALLES AVEC UN TUBE EN PLASTIQUE QUI SEPRE LES COMPOSANTS SUR L'AXE, CE TUBE DOIT ETRE JETE.

LES PARTIES PRESENTEES PEUVENT ETRE UNIQUEMENT REPRESENTATIVES
(POUR LA CLARTE DES INSTRUCTIONS UNIQUEMENT)

Notice disponible au téléchargement sur www.rg-racing.com

VALEURS DE SERRAGE

M4 BOULON = 8Nm
M5 BOULON = 12Nm
M6 BOULON = 15Nm
M8 BOULON = 20Nm
M10 BOULON = 40Nm



FP0199

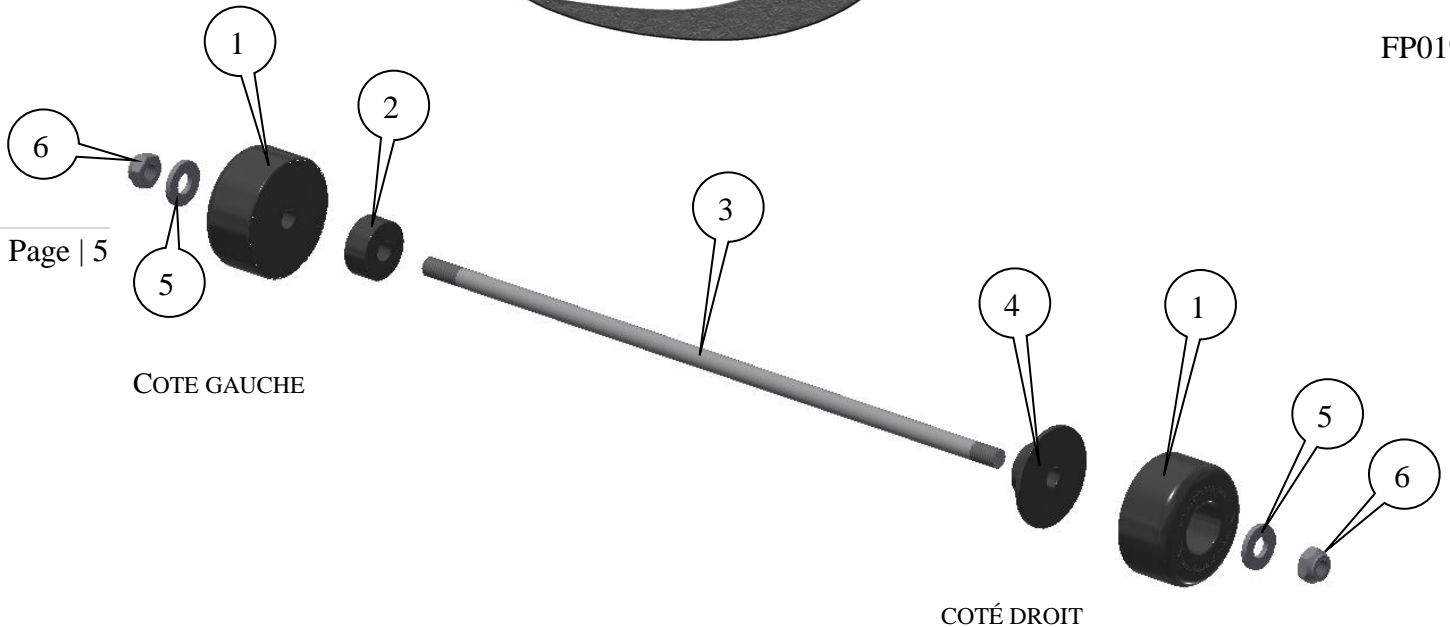

Page | 5

LÉGENDE

- ARTICLE 1 = PROTECTION CRASH (GAUCHE ET DROITE) (B0442 M8) (x2).
- ARTICLE 2 = ENTRETOISE (GAUCHE) (S1057 – 10.75mm DE LONG) (x1).
- ARTICLE 3 = AXE (SB013 – 290mm DE LONG) (x1).
- ARTICLE 4 = ENTRETOISE (DROITE) (S1058 – 13mm DE LONG) (x1).
- ARTICLE 5 = M8 ÉCROUS (x2).
- ARTICLE 6 = M8 RONDELLES (x2).

OUTILS REQUIS

- Clé à cliquet + douilles de 2x13mm.

NOTICE DE MONTAGE

- Insérer un écrou (article 6) et une rondelle (article 5) sur le filetage le plus court de l'axe (article 3), engager l'écrou de façon à ce que l'insert en plastique de l'écrou soit complètement engagé.
- Passer l'axe avec écrou et rondelles dans la protection crash (article 1) et dans la petite entretoise (article 2), voir ci-dessus.
- Placer cet ensemble dans l'axe de roue avant depuis le côté gauche (lorsqu'on est assis sur la moto), de façon à ce que l'entretoise se place dans le creux de l'axe.
- Placer l'entretoise restante la plus large (article 4) sur l'extrémité de l'axe du côté droit de façon à ce que l'extrémité du robinet se place dans l'axe, voir ci-dessus.
- Placer la protection crash restante (article 1) sur l'extrémité de l'axe du côté droit.
- Insérer la rondelle restante et l'écrou (articles 5 et 6) du kit sur le filetage puis serrer jusqu'à ce que les 2 écrous soient engagés dans le nylon et que les longueurs dépassant de chaque côté soient égales (veiller à ce que le logo soit placé sur le haut de la protection crash). Ne pas trop bloquer – les écrous fixent l'ensemble.

ISSUE 1 08/08/2017 (NSY)

**CONSUMER NOTICE**

The catalogue description and any exhibition of samples are only broad indications of the Products and R&G may make design changes which do not diminish their performance or visual appeal and supplying them in such state shall conform to the order. The Buyer acknowledges no representation or warranty (other than as to title) has been given or will apply to the Products other than those in R&G's order or confirmation and the Buyer confirms it has chosen the Products as being of merchantable quality and suitable for its particular purposes. Where R&G fits the Products or undertakes other services it shall exercise reasonable skill and care and rectify any fault free of charge unless the workmanship has been disturbed. The Buyer is responsible for ensuring that the warranty on the motorcycle is not affected by the fitting of the Products. On return of any defective Products R&G shall at its option either supply a replacement or refund the purchase money but shall not be liable if the Products have been modified or used or maintained otherwise than in accordance with R&G's or manufacturer's instructions and good engineering practice or if the defect arises from accident or neglect. Other than identified above and subject to R&G not limiting its liability for causing death and personal injury, it shall not be liable for indirect or consequential loss and otherwise its liability shall be limited to the amounts paid by the Buyer for the Products or the fitting or service concerned. These terms do not affect the Buyer's statutory rights.

R&G RACING RETURNS POLICY (NON-FAULTY GOODS)

Returns must be pre-authorized (if not pre-authorized the return will be rejected). Goods may only be returned direct to us if they were purchased direct from us (customer must prove if necessary). Otherwise to be returned to original vendor. Goods must be in resellable condition, in the opinion of R&G Racing. All returns are subject to a 25% restocking and handling fee (25% of the gross value exc. P&P – at the prevailing price at time of purchase). The customer must pay any and all carriage charges. No returns of discontinued products, unless within 14 days of purchase. This policy does not affect your statutory rights and does not refer to faulty goods.