



FP0192BK

**FITTING INSTRUCTIONS FOR FP0192BK FORK PROTECTORS**  
**KAWASAKI Z650 2017-**



*LEFT SIDE*



*RIGHT SIDE*

**THIS KIT CONTAINS THE ITEMS PICTURED AND LABELLED BELOW.**  
**DO NOT PROCEED UNTIL YOU ARE SURE ALL PARTS ARE PRESENT.**

**Please note that the way the kit is packed does not necessarily represent the way of mounting to the bike.**

Please note that in cases where kits are packed with a plastic tube separating components on the spindle bar (this tube  
THE PARTS SHOWN MAY BE REPRESENTATIVE ONLY (FOR CLARITY OF INSTRUCTIONS ONLY)

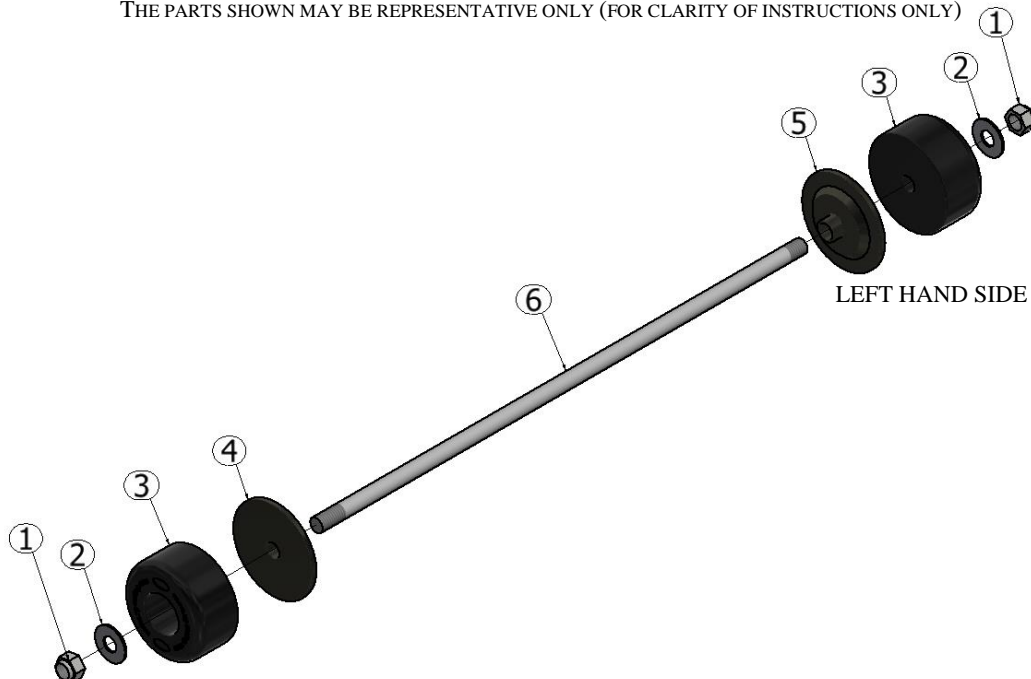

R&G Racing

Unit 1, Shelley's Lane, East Worldham, Alton, Hampshire, GU34 3AQ

Tel: +44 (0)1420 89007 Fax: +44 (0)1420 87301 [www.rg-racing.com](http://www.rg-racing.com) Email: [info@rg-racing.com](mailto:info@rg-racing.com)



FP0192BK

RIGHT HAND SIDE

### **LEGEND**

ITEM 1 = M8 NYLOC NUTS (x2)  
ITEM 2 = M8 WASHERS (x2)  
ITEM 3 = R&G CRASH BOBBINS (B0442) (x2)  
ITEM 4 = R/H SPACER 15mm LONG (S1004) (x1)  
ITEM 5 = L/H SPACER 18mm LONG (S1003) (x1)  
ITEM 6 = SPINDLE BAR (SB015) (x1)

### **TOOLS REQUIRED**

- Socket set to include 2x 13mm sockets.
  - Wrenches

### **FITTING INSTRUCTIONS**

- Starting from the L/H, as you sit on the bike, fit L/H spacer S1003 (Item 5) into the round shaped OEM spindle head on the left hand side of the front spindle.
- Fit one R&G Bobbin (Item 3), M8 washer (Item 2) and M8 nut (Item 1) onto the end with shorter thread of the Spindle bar (Item 6) from the kit. Engage the nut so the nylon insert of the nut is fully engaged.
- Feed the spindle bar assembly through the spacer just fitted on the front wheel on the left hand side.
- Place the remaining spacer (S1004 – Item 4) over the exposed protruded end of the spindle bar so the spacer fits inside the hexagon shaped recess on the front spindle. Then slide the remaining R&G bobbin (Item 3) onto the spindle bar.
- Fit the remaining M8 washer (Item 2) and nyloc nut (Item 1) from the kit onto the thread and tighten both nyloc nuts using 13mm sockets and wrenches.
- Do not overtighten – the nyloc nuts will hold it tight

ISSUE 1 07/02/2017 (HH)

### **CONSUMER NOTICE**

The catalogue description and any exhibition of samples are only broad indications of the Products and R&G may make design changes which do not diminish their performance or visual appeal and supplying them in such state shall conform to the order. The Buyer acknowledges no representation or warranty (other than as to title) has been given or will apply to the Products other than those in R&G's order or confirmation and the Buyer confirms it has chosen the Products as being of merchantable quality and suitable for its particular purposes. Where R&G fits the Products or undertakes other services it shall exercise reasonable skill and care and rectify any fault free of charge unless the workmanship has been disturbed. The Buyer is responsible for ensuring that the warranty on the motorcycle is not affected by the fitting of the Products. On return of any defective Products R&G shall at its option either supply a replacement or refund the purchase money but shall not be liable if the Products have been modified or used or maintained otherwise than in accordance with R&G's or manufacturer's instructions and good engineering practice or if the defect arises from accident or neglect. Other than identified above and subject to R&G not limiting its liability for causing death and personal injury, it shall not be liable for indirect or consequential loss and otherwise its liability shall be limited to the amounts paid by the Buyer for the Products or the fitting or service concerned. These terms do not affect the Buyer's statutory rights.

### **R&G RACING RETURNS POLICY (NON-FAULTY GOODS)**

Returns must be pre-authorised (if not pre-authorised the return will be rejected). Goods may only be returned direct to us if they were purchased direct from us (customer must prove if necessary). Otherwise to be returned to original vendor. Goods must be in resellable condition, in the opinion of R&G Racing. All returns are subject to a 25% restocking and handling fee (25% of the gross value exc. P&P – at the prevailing price at time of purchase). The customer must pay any and all carriage charges. No returns of discontinued products, unless within 14 days of purchase. This policy does not affect your statutory rights and does not refer to faulty goods.

R&G Racing

Unit 1, Shelley's Lane, East Worldham, Alton, Hampshire, GU34 3AQ

Tel: +44 (0)1420 89007 Fax: +44 (0)1420 87301 [www.rg-racing.com](http://www.rg-racing.com) Email: [info@rg-racing.com](mailto:info@rg-racing.com)



FP0192BK

**NOTICE DE MONTAGE POUR FP0192BK PROTECTIONS FOURCHE**  
**KAWASAKI Z650 2017-**



COTE GAUCHE



COTE DROIT

**Le kit contient les articles exposés ci-dessous, vérifier que toutes les pièces soient présentes avant de procéder au montage.**

**LA FAÇON DONT LE KIT EST EMBALLE NE CORRESPOND PAS FORCEMENT A LA FAÇON DE MONTER LES PIÈCES SUR LA MOTO.**

**NOTEZ QUE SI LES KITS SONT EMBALLÉS AVEC UN TUBE EN PLASTIC QUI SEPARÉ LES COMPOSANTS SUR L'AXE, CE TUBE DOIT ÊTRE JETÉ.**

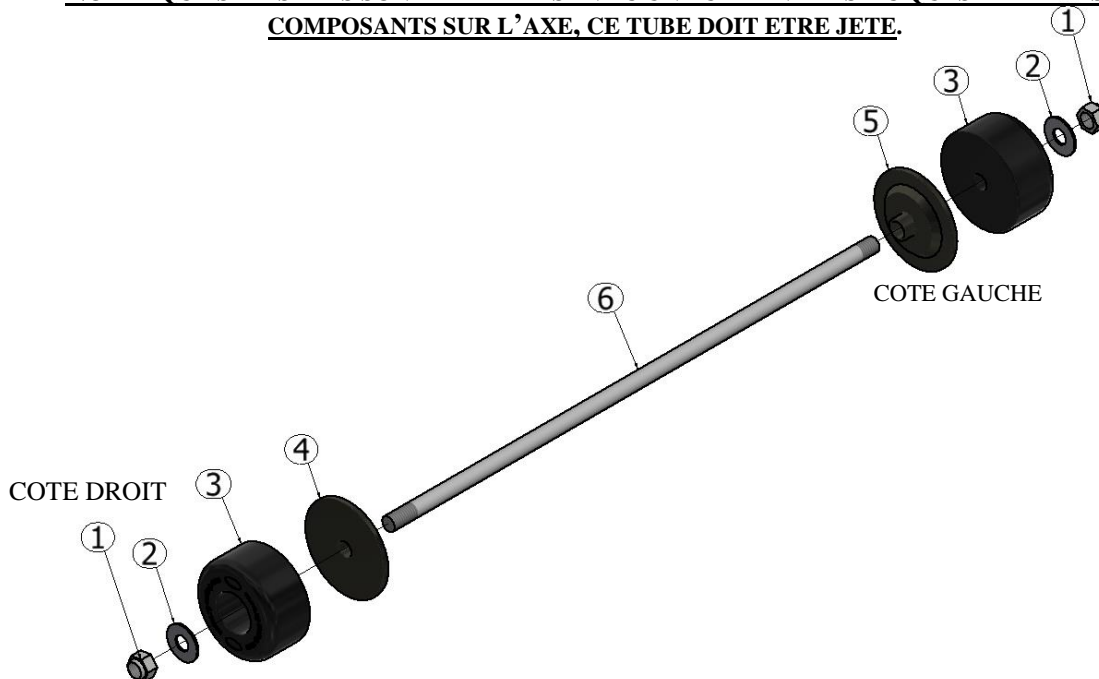



FP0192BK

## LEGENDE

- ARTICLE 1 = M8 ECROUS (x2)
- ARTICLE 2 = M8 RONDELLES (x2)
- ARTICLE 3 = R&G BOBINES DE PROTECTION CRASH (B0442) (x2)
- ARTICLE 4 = ENTRETOISE COTE DROIT 15mm DE LONG (S1004) (x1)
- ARTICLE 5 = ENTRETOISE COTE GAUCHE 18mm DE LONG (S1003) (x1)
- ARTICLE 6 = AXE (SB015) (x1)

## OUTILS REQUIS

- Clé à cliquet 2x 13mm
- Clés en croix.

## NOTICE DE MONTAGE

- En commençant du côté gauche, lorsqu'on est assis sur la moto, insérer une entretoise du côté gauche S1003 (Article 5) dans la tête de l'axe d'origine du côté gauche de l'axe avant.
- Insérer une bobine de protection R&G (Article 3), une rondelle M8 (Article 2) et un écrou M8 nut (Article 1) sur l'extrémité avec le filetage le plus court de l'axe (Article 6) du kit. Engager l'écrou de façon à ce que l'insert de l'écrou soit complètement engagé.
- Passer l'axe dans l'entretoise tout juste insérée dans la roue avant du côté gauche.
- Placer l'entretoise restante (S1004 – Article 4) sur l'extrémité dépassante de l'axe afin que l'entretoise se place dans le creux hexagonal de l'axe avant. Enfin, glisser la bobine de protection crash restante R&G (Article 3) sur l'axe.
- Insérer la rondelle restante et l'écrou (article 2 et 1) du kit sur le filetage puis serrer les 2 écrous à l'aide d'une clé de 13mm.
- **NE PAS TROP SERRER – Les écrous bloquent suffisamment.**

ISSUE 1 07/02/2017 (HH)

## CONSUMER NOTICE

The catalogue description and any exhibition of samples are only broad indications of the Products and R&G may make design changes which do not diminish their performance or visual appeal and supplying them in such state shall conform to the order. The Buyer acknowledges no representation or warranty (other than as to title) has been given or will apply to the Products other than those in R&G's order or confirmation and the Buyer confirms it has chosen the Products as being of merchantable quality and suitable for its particular purposes. Where R&G fits the Products or undertakes other services it shall exercise reasonable skill and care and rectify any fault free of charge unless the workmanship has been disturbed. The Buyer is responsible for ensuring that the warranty on the motorcycle is not affected by the fitting of the Products. On return of any defective Products R&G shall at its option either supply a replacement or refund the purchase money but shall not be liable if the Products have been modified or used or maintained otherwise than in accordance with R&G's or manufacturer's instructions and good engineering practice or if the defect arises from accident or neglect. Other than identified above and subject to R&G not limiting its liability for causing death and personal injury, it shall not be liable for indirect or consequential loss and otherwise its liability shall be limited to the amounts paid by the Buyer for the Products or the fitting or service concerned. These terms do not affect the Buyer's statutory rights.

## R&G RACING RETURNS POLICY (NON-FAULTY GOODS)

Returns must be pre-authorized (if not pre-authorized the return will be rejected). Goods may only be returned direct to us if they were purchased direct from us (customer must prove if necessary). Otherwise to be returned to original vendor. Goods must be in resellable condition, in the opinion of R&G Racing. All returns are subject to a 25% restocking and handling fee (25% of the gross value exc. P&P – at the prevailing price at time of purchase). The customer must pay any and all carriage charges. No returns of discontinued products, unless within 14 days of purchase. This policy does not affect your statutory rights and does not refer to faulty goods.

R&G Racing

Unit 1, Shelley's Lane, East Worldham, Alton, Hampshire, GU34 3AQ

Tel: +44 (0)1420 89007 Fax: +44 (0)1420 87301 [www.rg-racing.com](http://www.rg-racing.com) Email: [info@rg-racing.com](mailto:info@rg-racing.com)