



FITTING INSTRUCTIONS FOR FP0149BK FORK PROTECTORS
YAMAHA MT-09 '13-



THIS KIT CONTAINS THE ITEMS PICTURED AND LABELLED BELOW.
DO NOT PROCEED UNTIL YOU ARE SURE ALL PARTS ARE PRESENT.

Please note that the way the kit is packed does not necessarily represent the way of mounting to the bike

Please note that in cases where kits are packed with a plastic tube separating components on the spindle bar (this tube should be discarded).

THE PARTS SHOWN MAY BE REPRESENTATIVE ONLY (FOR CLARITY OF INSTRUCTIONS ONLY)

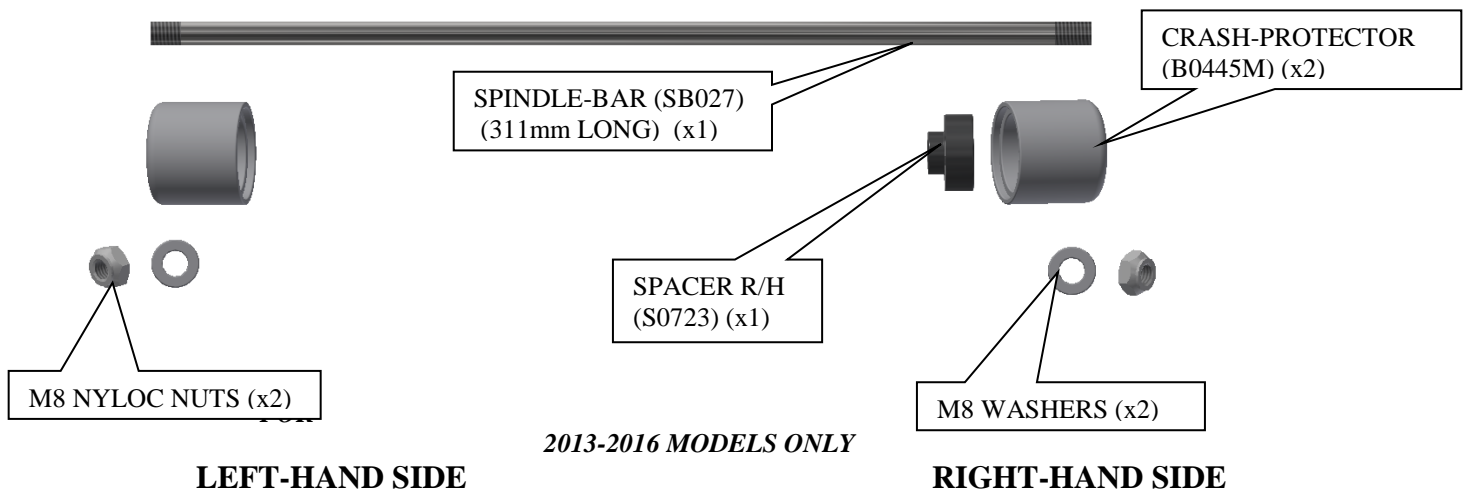

TOOLS REQUIRED

- Socket set to include 2x 13mm sockets



FITTING INSTRUCTIONS

If fitting to '13-'16 bikes:

- Fit one nut and washer on spindle-bar (SB027) (the end with shorter thread), engage the nut so the plastic insert of nut is fully engaged.
- Feed spindle-bar with nut and washer through either crash protector (B0445M) and through the metal spacer (S0723), as shown in the above picture.
- Place this assembly through the front wheel spindle from the right side, ensuring the metal spacer fits into the spindle.
- Place the remaining crash protector over the exposed end of the spindle bar on the left side of the bike. The crash protector should fit over the boss on the fork leg bottom.
- Fit the washer and nut from the kit onto the thread and tighten until both nuts are engaged in nylon and equal amounts protrude from either side (please ensure the logo is located at the top and bottom of the crash protector). Do not overtighten – the nyloc nuts will hold it tight.

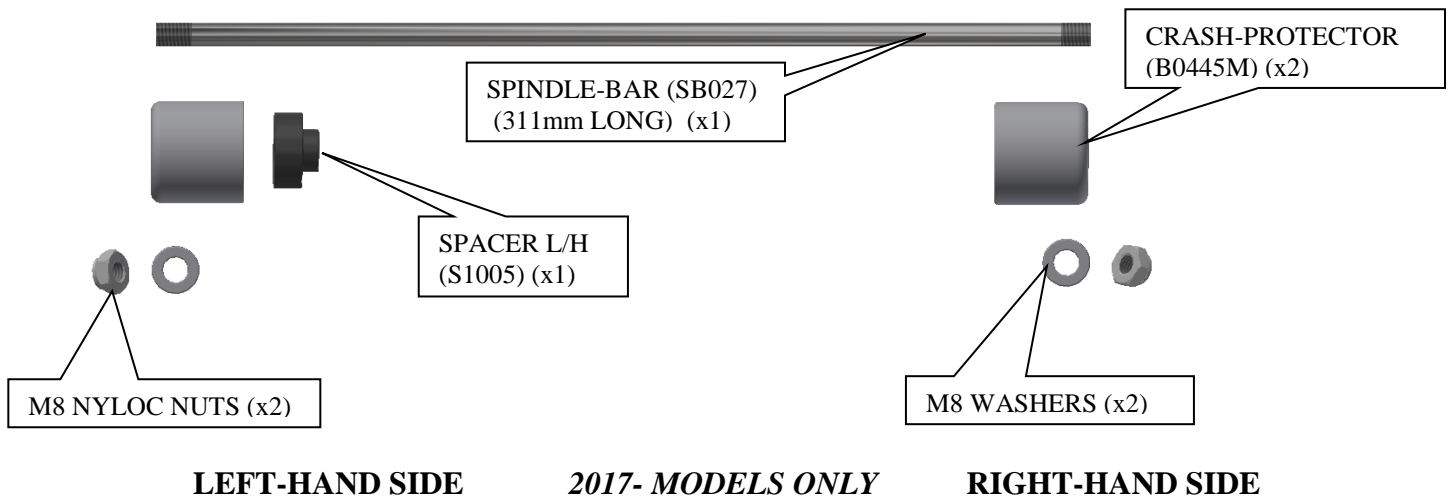

If fitting to '17- bikes:

- Fit one nut and washer on spindle-bar (SB027) (the end with shorter thread), engage the nut so the plastic insert of nut is fully engaged.
- Feed spindle-bar with nut and washer through either crash protector (B0445M) and through the metal spacer (S1005), as shown in the above picture.
- Place this assembly through the front wheel spindle from the left side, ensuring the metal spacer fits into the hex on the spindle.
- Place the remaining crash protector over the exposed end of the spindle bar on the right side of the bike. The crash protector should fit over the boss on the fork leg bottom.
- Fit the washer and nut from the kit onto the thread and tighten until both nuts are engaged in nylon and equal amounts protrude from either side (please ensure the logo is located at the top and bottom of the crash protector). Do not overtighten – the nyloc nuts will hold it tight.

ISSUE 3 01/07/2019 (NSY)

**CONSUMER NOTICE**

The catalogue description and any exhibition of samples are only broad indications of the Products and R&G may make design changes which do not diminish their performance or visual appeal and supplying them in such state shall conform to the order. The Buyer acknowledges no representation or warranty (other than as to title) has been given or will apply to the Products other than those in R&G's order or confirmation and the Buyer confirms it has chosen the Products as being of merchantable quality and suitable for its particular purposes. Where R&G fits the Products or undertakes other services it shall exercise reasonable skill and care and rectify any fault free of charge unless the workmanship has been disturbed. The Buyer is responsible for ensuring that the warranty on the motorcycle is not affected by the fitting of the Products. On return of any defective Products R&G shall at its option either supply a replacement or refund the purchase money but shall not be liable if the Products have been modified or used or maintained otherwise than in accordance with R&G's or manufacturer's instructions and good engineering practice or if the defect arises from accident or neglect. Other than identified above and subject to R&G not limiting its liability for causing death and personal injury, it shall not be liable for indirect or consequential loss and otherwise its liability shall be limited to the amounts paid by the Buyer for the Products or the fitting or service concerned. These terms do not affect the Buyer's statutory rights.

R&G RACING RETURNS POLICY (NON-FAULTY GOODS)

Returns must be pre-authorized (if not pre-authorized the return will be rejected). Goods may only be returned direct to us if they were purchased direct from us (customer must prove if necessary). Otherwise to be returned to original vendor. Goods must be in re-sellable condition, in the opinion of R&G Racing. All returns are subject to a 25% restocking and handling fee (25% of the gross value exc. P&P – at the prevailing price at time of purchase). The customer must pay any and all carriage charges. No returns of discontinued products, unless within 14 days of purchase. This policy does not affect your statutory rights and does not refer to faulty goods.



**NOTICE DE MONTAGE POUR FP0149BK PROTECTIONS FOURCHE
YAMAHA MT-09 '13-**



Le kit contient les articles exposés ci-dessous, vérifier que toutes les pièces soient présentes avant de procéder au montage.

La façon dont le kit est emballé ne correspond pas forcément à la façon de monter les pièces sur la moto

Notez que si les kits sont emballés avec un tube en plastique qui sépare les composants sur l'axe, ce tube doit être jeté.

LES PARTIES PRÉSENTÉES PEUVENT ÊTRE UNIQUEMENT REPRESENTATIVES (POUR LA CLARTE DES INSTRUCTIONS UNIQUEMENT)

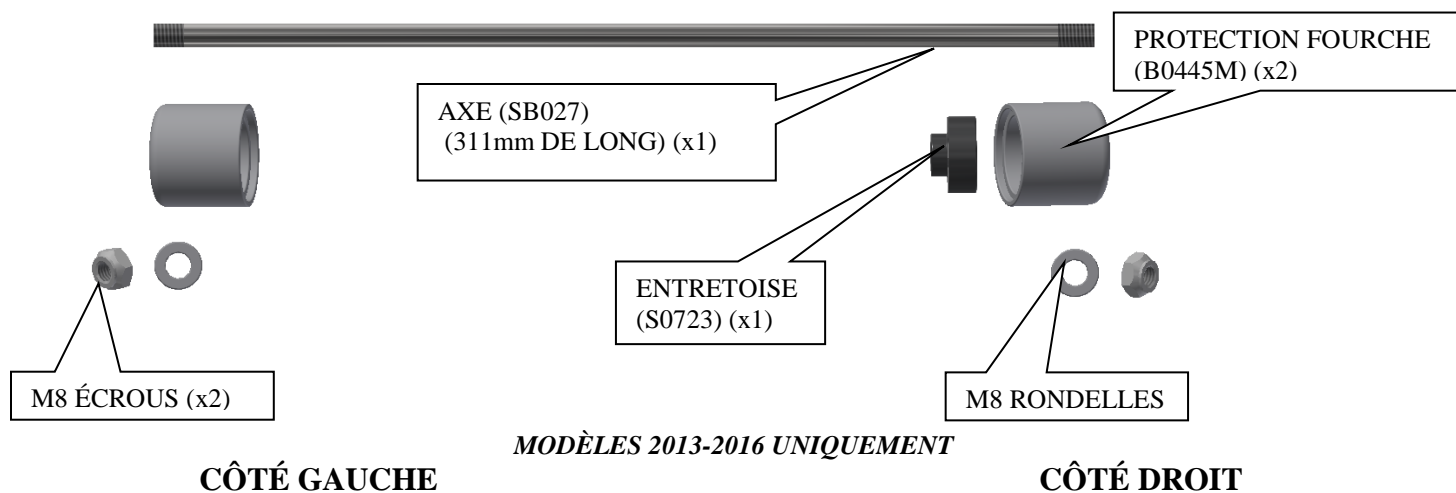



OUTILS REQUIS

- Clé à cliquet + douilles 2x 13mm

NOTICE DE MONTAGE

Si installation se fait sur des modèles de '13 à'16:

- Montez un écrou et une rondelle sur l'axe (SB027) (l'extrémité avec le filetage le plus court), engagez l'écrou de sorte que l'insert en plastique de l'écrou soit complètement engagé.
- Introduisez l'axe avec écrou et rondelle dans l'une ou l'autre des protections crash (B0445M) et dans l'entretoise (S0723), comme indiqué sur l'image ci-dessus.
- Placez cet assemblage du côté droit dans l'axe de la roue avant, en veillant à ce que l'entretoise en métal s'adapte à l'axe.
- Placez la protection crash restante sur l'extrémité exposée de l'axe sur le côté gauche de la moto. La protection crash doit s'adapter sur le bossage au bas de la jambe de fourche.
- Installez la rondelle et l'écrou du kit sur le filetage et serrez jusqu'à ce que les deux écrous soient engagés dans du nylon et que des quantités égales dépassent des deux côtés (veuillez vous assurer que le logo soit situé en haut et en bas de la protection crash). Ne serrez pas trop - les écrous le maintiendront serré.

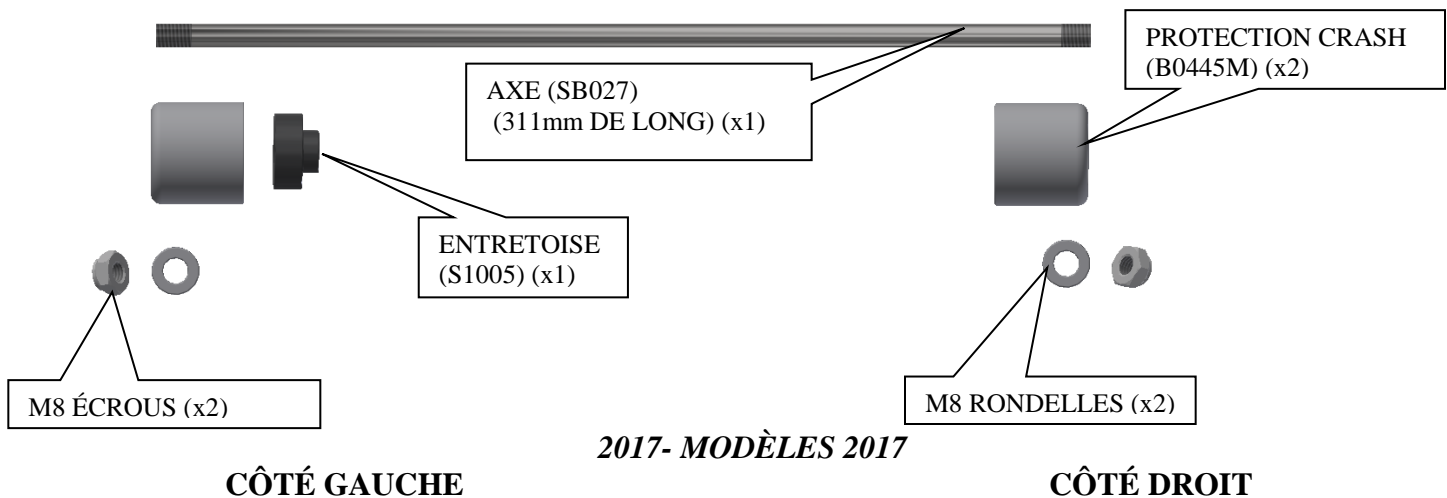

Si installation se fait sur des modèles de 2017:

- Montez un écrou et une rondelle sur l'axe (SB027) (l'extrémité avec le filetage le plus court), engagez l'écrou de sorte que l'insert en plastique de l'écrou soit complètement engagé.
- Faites passer l'axe avec l'écrou et la rondelle dans l'une ou l'autre des protections crash (B0445M) et dans l'entretoise en métal (S1005), comme indiqué sur l'image ci-dessus.
- Placez cet assemblage du côté gauche dans l'axe de la roue avant, en veillant à ce que l'entretoise en métal s'insère dans sur l'axe.
- Placez la protection crash restante sur l'extrémité exposée de l'axe, du côté droit de la moto. La protection crash doit s'adapter sur le bossage situé au bas de la jambe de fourche.



- Placez la rondelle et l'écrou du kit sur le filetage et serrez jusqu'à ce que les deux écrous soient engagés et que des quantités égales dépassent des deux côtés (veuillez vous assurer que le logo soit situé en haut et en bas du pare-chocs). Ne serrez pas trop - les écrous le maintiendront serré.

ISSUE 3 01/07/2019 (NSY)

CONSUMER NOTICE

The catalogue description and any exhibition of samples are only broad indications of the Products and R&G may make design changes which do not diminish their performance or visual appeal and supplying them in such state shall conform to the order. The Buyer acknowledges no representation or warranty (other than as to title) has been given or will apply to the Products other than those in R&G's order or confirmation and the Buyer confirms it has chosen the Products as being of merchantable quality and suitable for its particular purposes. Where R&G fits the Products or undertakes other services it shall exercise reasonable skill and care and rectify any fault free of charge unless the workmanship has been disturbed. The Buyer is responsible for ensuring that the warranty on the motorcycle is not affected by the fitting of the Products. On return of any defective Products R&G shall at its option either supply a replacement or refund the purchase money but shall not be liable if the Products have been modified or used or maintained otherwise than in accordance with R&G's or manufacturer's instructions and good engineering practice or if the defect arises from accident or neglect. Other than identified above and subject to R&G not limiting its liability for causing death and personal injury, it shall not be liable for indirect or consequential loss and otherwise its liability shall be limited to the amounts paid by the Buyer for the Products or the fitting or service concerned. These terms do not affect the Buyer's statutory rights.

R&G RACING RETURNS POLICY (NON-FAULTY GOODS)

Returns must be pre-authorized (if not pre-authorized the return will be rejected). Goods may only be returned direct to us if they were purchased direct from us (customer must prove if necessary). Otherwise to be returned to original vendor. Goods must be in re-sellable condition, in the opinion of R&G Racing. All returns are subject to a 25% restocking and handling fee (25% of the gross value exc. P&P – at the prevailing price at time of purchase). The customer must pay any and all carriage charges. No returns of discontinued products, unless within 14 days of purchase. This policy does not affect your statutory rights and does not refer to faulty goods.