



**FITTING INSTRUCTIONS FOR FP0144BK FORK PROTECTORS**  
**YAMAHA X-MAX 400 2013-**



**THIS KIT CONTAINS THE ITEMS PICTURED AND LABELLED BELOW.**  
**DO NOT PROCEED UNTIL YOU ARE SURE ALL PARTS ARE PRESENT.**

**Please note that the way the kit is packed does not necessarily represent the way of mounting to the bike**

Please note that in cases where kits are packed with a plastic tube separating components on the spindle bar (this tube should be discarded).

THE PARTS SHOWN MAY BE REPRESENTATIVE ONLY (FOR CLARITY OF INSTRUCTIONS ONLY)

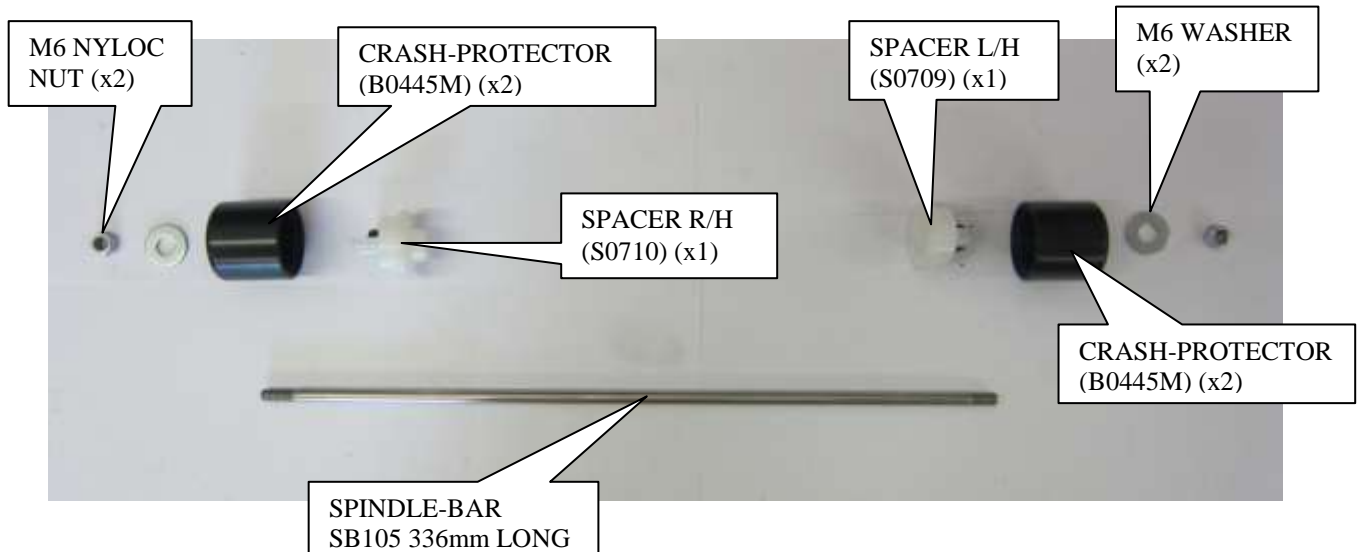

R&G Racing

Unit 1, Shelley's Lane, East Worldham, Alton, Hampshire, GU34 3AQ

Tel: +44 (0)1420 89007 Fax: +44 (0)1420 87301 [www.rg-racing.com](http://www.rg-racing.com) Email: [info@rg-racing.com](mailto:info@rg-racing.com)



### **TOOLS REQUIRED**

- Socket set to include 2x 10mm sockets and wrenches.

### **FITTING INSTRUCTIONS**

- Fit one nut and washer on spindle-bar (SB105) (the end with shorter turned down end), engage the nut so the plastic insert of nut is fully engaged.
- Feed spindle-bar with nut and washer through either crash protector (B0445M) and through the metal spacer (S0709), as shown in the above picture (the smaller diameter end of the spacer fits inside the hole through the crash protector).
- Place this assembly through the front wheel spindle from the left hand side, ensuring the recess on the spacer fits over the end of the wheel spindle.
- Place the remaining metal spacer (S0710) into the crash protector and locate into the head of the wheel spindle bolt on the right hand side.
- Fit washer and nut from kit onto thread and tighten until both nuts are engaged in nylon and equal amounts protrude from either side (please ensure the logo is located at the top of the crash protector). Do not overtighten – the nyloc nuts will hold it tight.

ISSUE 1 08/08/2013 (AR)

### **CONSUMER NOTICE**

The catalogue description and any exhibition of samples are only broad indications of the Products and R&G may make design changes which do not diminish their performance or visual appeal and supplying them in such state shall conform to the order. The Buyer acknowledges no representation or warranty (other than as to title) has been given or will apply to the Products other than those in R&G's order or confirmation and the Buyer confirms it has chosen the Products as being of merchantable quality and suitable for its particular purposes. Where R&G fits the Products or undertakes other services it shall exercise reasonable skill and care and rectify any fault free of charge unless the workmanship has been disturbed. The Buyer is responsible for ensuring that the warranty on the motorcycle is not affected by the fitting of the Products. On return of any defective Products R&G shall at its option either supply a replacement or refund the purchase money but shall not be liable if the Products have been modified or used or maintained otherwise than in accordance with R&G's or manufacturer's instructions and good engineering practice or if the defect arises from accident or neglect. Other than identified above and subject to R&G not limiting its liability for causing death and personal injury, it shall not be liable for indirect or consequential loss and otherwise its liability shall be limited to the amounts paid by the Buyer for the Products or the fitting or service concerned. These terms do not affect the Buyer's statutory rights.

### **R&G RACING RETURNS POLICY (NON-FAULTY GOODS)**

Returns must be pre-authorized (if not pre-authorized the return will be rejected). Goods may only be returned direct to us if they were purchased direct from us (customer must prove if necessary). Otherwise to be returned to original vendor. Goods must be in re-sellable condition, in the opinion of R&G Racing. All returns are subject to a 25% restocking and handling fee (25% of the gross value exc. P&P – at the prevailing price at time of purchase). The customer must pay any and all carriage charges. No returns of discontinued products, unless within 14 days of purchase. This policy does not affect your statutory rights and does not refer to faulty goods.

R&G Racing

Unit 1, Shelley's Lane, East Worldham, Alton, Hampshire, GU34 3AQ

Tel: +44 (0)1420 89007 Fax: +44 (0)1420 87301 [www.rg-racing.com](http://www.rg-racing.com) Email: [info@rg-racing.com](mailto:info@rg-racing.com)



**Instructions de montage pour FP0144BK Protections fourche**  
**YAMAHA X-MAX 400 2013-**



**Le kit contient les articles exposés ci-dessous, vérifier que toutes les pièces soient présentes avant de procéder au montage.**

La façon dont le kit est emballé ne correspond pas forcément à la façon de monter les pièces sur la moto.

Notez que si les kits sont emballés avec un tube en plastique séparant les composants de l'axe, *ce tube doit être jeté.*

Les pièces présentées peuvent n'être que représentatives, afin de faciliter et clarifier les instructions de montage.

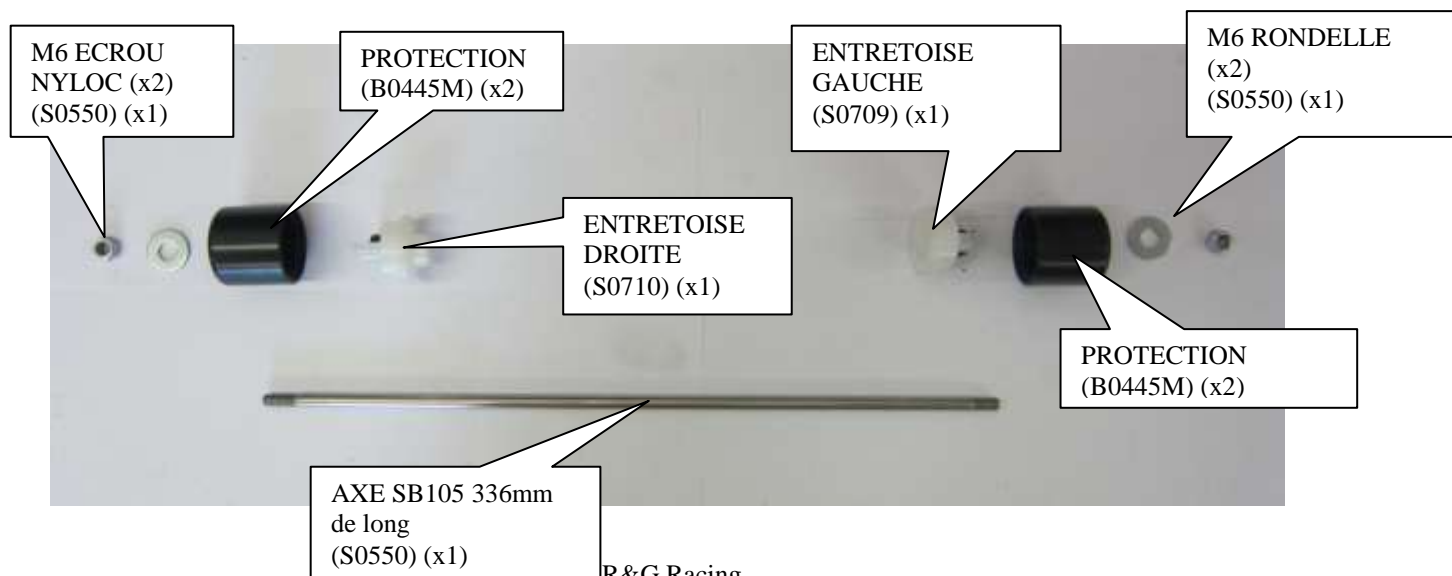

R&G Racing

Unit 1, Shelley's Lane, East Worldham, Alton, Hampshire, GU34 3AQ

Tel: +44 (0)1420 89007 Fax: +44 (0)1420 87301 [www.rg-racing.com](http://www.rg-racing.com) Email: [info@rg-racing.com](mailto:info@rg-racing.com)



#### **Outils requis**

- Jeu de clés de 2x 10mm.

#### **Instructions de montage :**

- Passer un écrou et une rondelle plate sur l'axe (SB105) (l'extrémité avec le filetage le plus court), engager l'écrou de façon à ce que l'insert en plastic de l'écrou soit complètement engagé.
- Passer l'axe avec écrou et rondelle à travers l'une des protections (B0445M) et à travers l'entretoise en métal (S0709), comme indiqué sur la photo du haut (Le plus petit diamètre d'extrémité de l'entretoise se place dans le trou à travers la protection).
- Placer cet ensemble à travers l'axe de roue avant depuis le coté gauche, en veillant à ce que le creux sur l'entretoise se place autour de l'extrémité de l'axe de roue.
- Placer l'entretoise en métal restante (S0710) dans la protection crash et sur la tête de boulon d'axe de roue du coté droit.
- Passer la rondelle et l'écrou du kit sur le filetage puis serrer jusqu'à ce que les 2 écrous soient engagés dans le Nylon et que les longueurs dépassants de chaque coté soient égales. (Veillez à ce que le logo soit placé vers le haut de la protection fourche). Ne pas trop serrer – Les écrous de Nyloc fixeront l'ensemble.