



## **FITTING INSTRUCTIONS FOR CP0564BL CRASH PROTECTORS**



**THIS KIT CONTAINS THE ITEMS PICTURED AND LABELLED OVER PAGE.**

SOME PARTS MAY BE SHOWN FOR CLARITY OF INSTRUCTIONS ONLY.

DO NOT PROCEED UNTIL YOU ARE SURE ALL PARTS ARE PRESENT.

**PLEASE READ ALL INSTRUCTIONS BEFORE PROCEEDING.**

**IF IN ANY DOUBT WHEN FITTING OUR PRODUCTS, CONSULT ONE OF OUR DEALERS  
OR HAVE FITTED BY A QUALIFIED TECHNICIAN.**

PLEASE NOTE THAT THE WAY THE KIT IS PACKED DOES NOT NECESSARILY REPRESENT THE WAY OF  
MOUNTING TO THE BIKE.

IN THE EVENT OF RUBBER WASHERS BEING USED TO HOLD COMPONENTS ONTO BOLTS,  
THESE RUBBER WASHERS CAN BE THROWN AWAY.



<b><u>TOOLS REQUIRED</u></b>	<b><u>GENERAL TORQUE SETTINGS</u></b>
<ul style="list-style-type: none"> <li>• 17mm &amp; 19mm SOCKET &amp; WRENCH</li> <li>• TORQUE WRENCH (UP TO 40Nm)</li> <li>• SUITABLE BIKE ENGINE SUPPORT JACK</li> <li>• METRIC SPANNER SET</li> </ul>	<p>M4 BOLT = 8Nm</p> <p>M5 BOLT = 12Nm</p> <p>M6 BOLT = 15Nm</p> <p>M8 BOLT = 20Nm</p> <p>M10 BOLT = 40Nm</p> <p>M12 BOLT = 40Nm</p>

### **LEGEND**

<b>ITEM NO.</b>	<b>DESCRIPTION</b>	<b>QTY</b>
ITEM 1	MOUNTING BRACKET	2
ITEM 2	BOBBIN SPACER	2
ITEM 3	BOBBIN	2
ITEM 4	BOBBIN CAP	2
ITEM 5	80mm HEX HEAD BOLT - MOUNTING PLATE	4
ITEM 6	90mm HEX HEAD BOLT - BOBBINS	2
ITEM 7	FLAT WASHER	6
ITEM 8	SHAKE PROOF WASHER	2
ITEM 9	HEX HEAD BOLT CAPS	5



**EXPLODED ASSEMBLY VIEW**

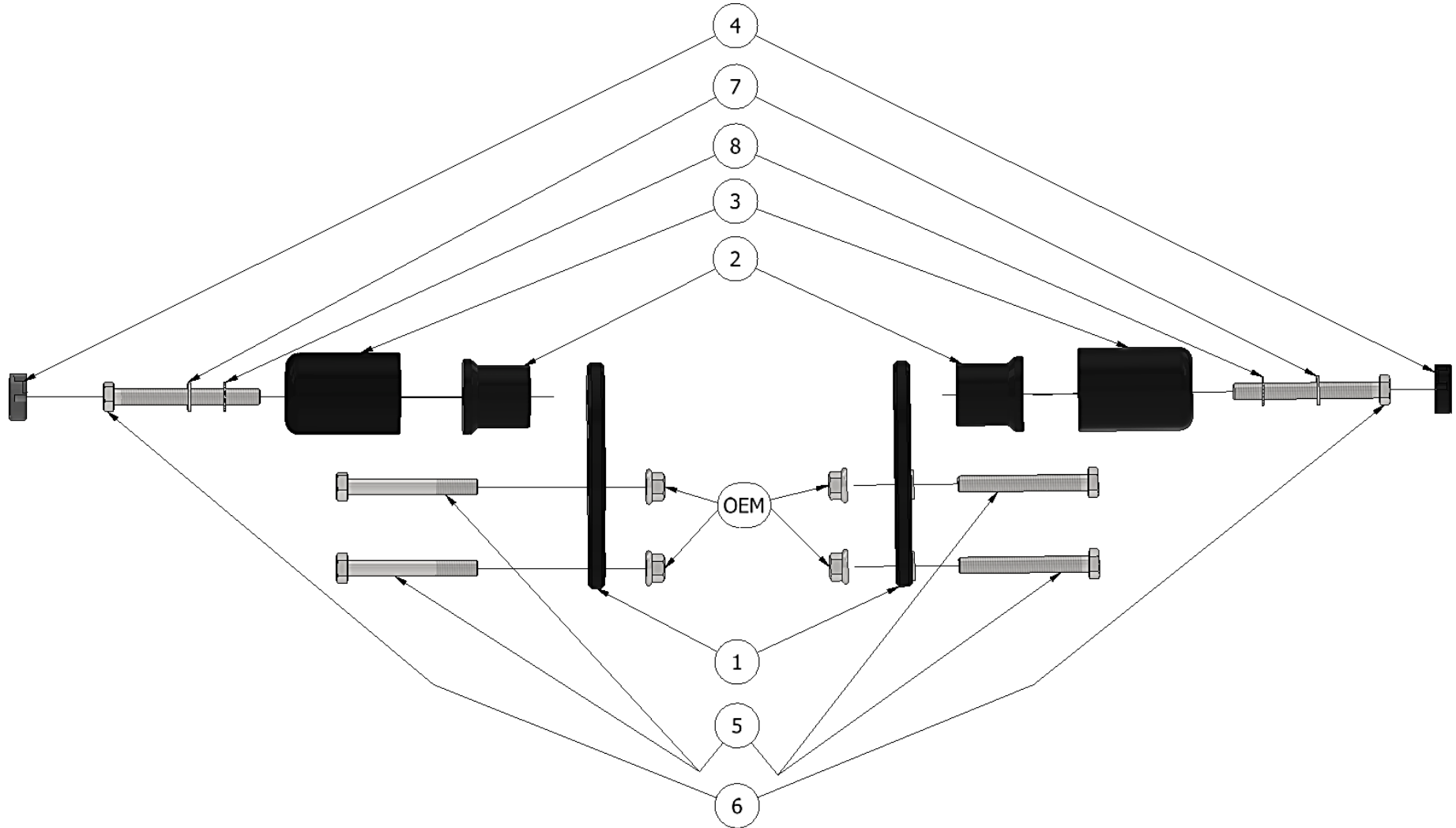



**FITTING PICTURES**

**Picture 1**





## **FITTING INSTRUCTIONS**

**BEFORE REMOVING ENGINE BOLTS, ENSURE THE BIKE IS UPRIGHT AND SUPPORTED BY A SUITABLE ENGINE STAND OR JACK PLACED UNDER THE SUMP OF THE MOTORBIKE TO SUPPORT THE WEIGHT OF THE ENGINE, THIS WILL PREVENT THE ENGINE FROM MOVING DURING FITTING. ENSURE THE BIKE IS SWITCHED OFF DURING FITTING.**

1. Place a jack under the engine with a flat piece of wood or other soft material between the jack and the sump.
2. Apply only gentle pressure with the jack or you risk the engine coming out of alignment with the frame once the bolts are removed.
3. Remove the two engine mounting bolts from one side of the bike, circled red in **Picture 1**. (There are 2X nuts on the back side of the bolts that will need to be held in place with a spanner or socket – once removed keep them to one side for use with the R&G kit)
4. Place 2x washers (**Item 7**) over 2X engine mounting bolts (**Item 5**), then pass both through the mounting bracket (**Item 1**).
5. Maneuver the bracket into position then push the bolts all the way through the frame and engine, then thread on the OEM nuts that were removed earlier and tighten to the manufacturer recommended torque setting.  
*Please refer to the exploded diagram and fitting pictures above for the mounting plate and bobbin orientation.*
6. Follow the same process on the other side of the bike.
7. Once both brackets are secure, pass the flat washer & shake proof washer (**Items 7 & 8**) over each of the bobbin mounting bolts (**Item 6**) then push them through the bobbins & spacers (**Items 3 & 2**).
8. Tighten the bolts until the bobbin no longer spins freely, adjust the angle of the bobbin so that the larger diameter is facing towards the front of the motorcycle, then while holding the bobbin in position tighten the bolt fully and repeat on the other side of the motorcycle.
9. Double check all bolts are torqued correctly then apply the supplied bolt caps to each of the mounting bracket bolts then the bobbin caps.

ISSUE 1 – 03/01/2024 TB

### **CONSUMER NOTICE**

The catalogue description and any exhibition of samples are only broad indications of the Products and R&G may make design changes which do not diminish their performance or visual appeal and supplying them in such state shall conform to the order. The Buyer acknowledges no representation or warranty (other than as to title) has been given or will apply to the Products other than those in R&G's order or confirmation and the Buyer confirms it has chosen the Products as being of merchantable quality and suitable for its particular purposes. Where R&G fits the Products or undertakes other services it shall exercise reasonable skill and care and rectify any fault free of charge unless the workmanship has been disturbed. The Buyer is responsible for ensuring that the warranty on the motorcycle is not affected by the fitting of the Products. On return of any defective Products R&G shall at its option either supply a replacement or refund the purchase money but shall not be liable if the Products have been modified or used or maintained otherwise than in accordance with R&G's or manufacturer's instructions and good engineering practice or if the defect arises from accident or neglect. Other than identified above and subject to R&G not limiting its liability for causing death and personal injury, it shall not be liable for indirect or consequential loss and otherwise its liability shall be limited to the amounts paid by the Buyer for the Products or the fitting or service concerned. These terms do not affect the Buyer's statutory rights.

### **R&G RACING RETURNS POLICY (NON-FAULTY GOODS)**

Returns must be pre-authorized (if not pre-authorized the return will be rejected). Goods may only be returned direct to us if they were purchased direct from us (customer must prove if necessary). Otherwise, to be returned to original vendor. Goods must be in re-sellable condition, in the opinion of R&G Racing. All returns are subject to a 25% restocking and handling fee (25% of the gross value exc. P&P – at the prevailing price at time of purchase). The customer must pay any and all carriage charges. No returns of discontinued products, unless within 14 days of purchase. This policy does not affect your statutory rights and does not refer to faulty goods.

R&G Racing

Unit 1, Shelley's Lane, East Worldham, Alton, Hampshire, GU34 3AQ

Tel: +44 (0)1420 89007 Fax: +44 (0)1420 87301 [www.rg-racing.com](http://www.rg-racing.com) Email: [info@rg-racing.com](mailto:info@rg-racing.com)



## **NOTICE DE MONTAGE POUR CP0564BL PROTECTIONS CRASH**



**CE KIT CONTIENT LES ARTICLES ILLUSTRÉS ET ÉTIQUETES SUR LA PAGE.**

CERTAINES PARTIES PEUVENT ÊTRE PRÉSENTES UNIQUEMENT POUR LA CLARTÉ DES INSTRUCTIONS.

NE PAS PROCÉDER AU MONTAGE TANT QUE VOUS N'ÊTES PAS SÛR QUE TOUTES LES PIÈCES SOIENT PRÉSENTES.

**VEUILLEZ LIRE TOUTES LES INSTRUCTIONS AVANT DE CONTINUER.**

**EN CAS DE DOUTE LORS DU MONTAGE DE NOS PRODUITS, CONSULTEZ UN DE NOS REVENDEURS OU FAITES APPEL À UN TECHNICIEN QUALIFIÉ.**

VEUILLEZ NOTER QUE LA FAÇON DONT LE KIT EST EMBALLÉ NE REPRÉSENTE PAS NECESSAIREMENT LA MANIÈRE DE LE MONTER SUR LA MOTO.

SI DES RONDELLES EN CAOUTCHOUC SONT UTILISÉES POUR MAINTENIR LES COMPOSANTS SUR LES BOULONS, ELLES PEUVENT ÊTRE JETÉES.

**NOTICE DISPONIBLE AU TÉLÉCHARGEMENT SUR :**

[WWW.RG-RACING.COM](http://WWW.RG-RACING.COM)

R&G Racing

Unit 1, Shelley's Lane, East Worldham, Alton, Hampshire, GU34 3AQ

Tel: +44 (0)1420 89007 Fax: +44 (0)1420 87301 [www.rg-racing.com](http://www.rg-racing.com) Email: [info@rg-racing.com](mailto:info@rg-racing.com)



<b><u>OUTILS REQUIS</u></b>	<b><u>VALEURS DE SERRAGE</u></b>
<ul style="list-style-type: none"> <li>• CLÉ À CLIQUET + DOUILLES 17mm &amp; 19mm</li> <li>• CLÉ DYNAMOMÉTRIQUE (JUSQU'À 40Nm)</li> <li>• CRIC SUPPORT MOTEUR MOTEUR ADAPTÉ</li> <li>• CLÉ MÉTRIQUE</li> </ul>	M4 BOULON = 8Nm M5 BOULON = 12Nm M6 BOULON = 15Nm M8 BOULON = 20Nm M10 BOULON = 40Nm M12 BOULON = 40Nm

### **LÉGENDE**

<b>ARTICLE NO.</b>	<b>DESCRIPTION</b>	<b>QTÉ</b>
ARTICLE 1	SUPPORT DE MONTAGE	2
ARTICLE 2	ENTRETOISE DE PROTECTION	2
ARTICLE 3	PROTECTION	2
ARTICLE 4	CAPUCHON DE LA PROTECTION	2
ARTICLE 5	80mm BOULON – PLAQUE DE MONTAGE	4
ARTICLE 6	90mm BOULON - PROTECTION	2
ARTICLE 7	RONDELLE PLATE	6
ARTICLE 8	RONDELLE ANTI-VIBRATION	2
ARTICLE 9	CAPUCHON DE BOULON	5



**Vue d'ensemble**

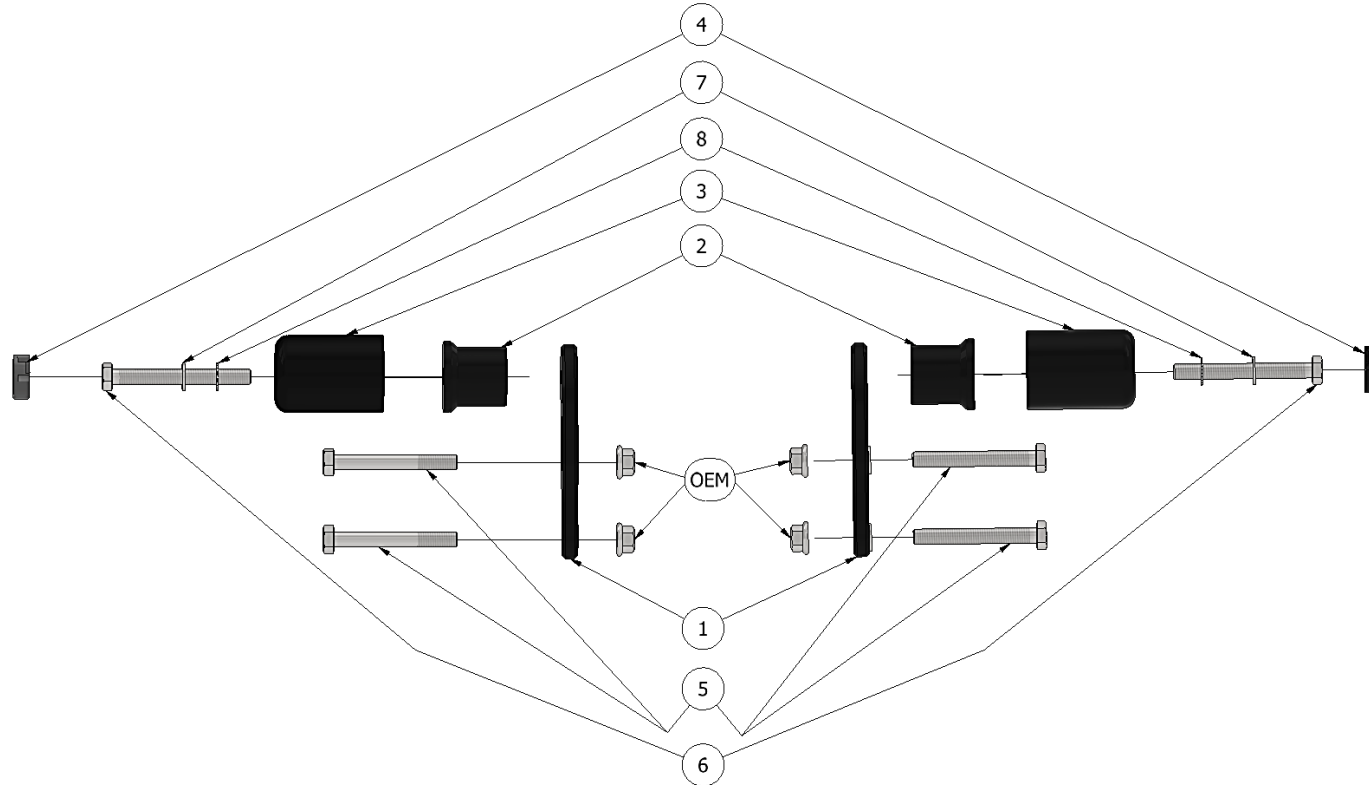





**Photos de montage**

**Photo 1**

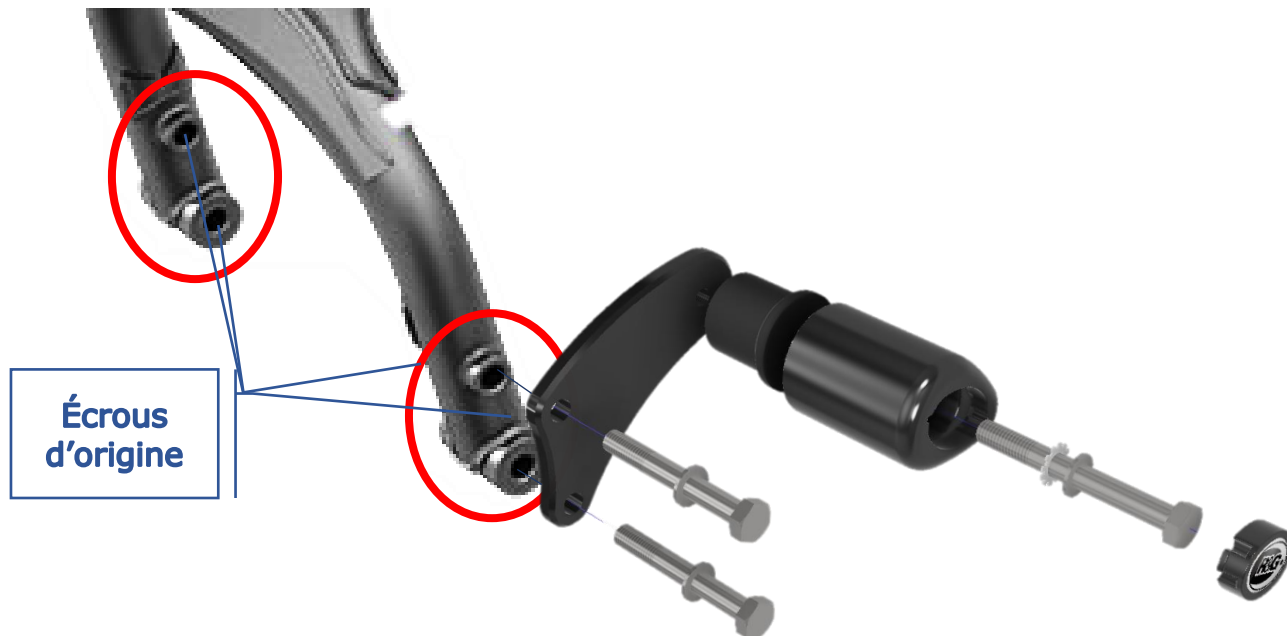



## **NOTICE DE MONTAGE**

**AVANT DE DÉPOSER LES BOULONS DU MOTEUR, ASSUREZ-VOUS QUE LA MOTO SOIT DROITE ET SOUTENUE PAR UN SUPPORT MOTEUR APPROPRIÉ OU UN CRIC PLACÉ SOUS LE CARTER DE LA MOTO POUR SUPPORTER LE POIDS DU MOTEUR, CELA EMPÊCHERA LE MOTEUR DE BOUGER PENDANT LE MONTAGE. ASSUREZ-VOUS QUE LA MOTO SOIT ÉTEINTE PENDANT LE MONTAGE.**

1. Placez un cric sous le moteur avec un morceau de bois plat ou un autre matériau souple entre le cric et le carter.
2. N'appliquez qu'une légère pression avec le cric, sinon vous risquez que le moteur ne soit plus aligné avec le cadre une fois les boulons retirés.
3. Retirez les deux boulons de montage du moteur d'un côté de la moto, entourés en rouge sur l'image 1. (Il y a 2 écrous à l'arrière des boulons qui devront être maintenus en place avec une clé ou une douille – une fois retirés, gardez-les. les mettre d'un côté pour une utilisation avec le kit R&G)
4. Placez 2x rondelles (Article 7) sur 2X boulons de montage du moteur (Article 5), puis passez les deux à travers le support de montage (Article 1).
5. Manœuvrez le support en position, puis poussez les boulons jusqu'au bout du cadre et du moteur, puis vissez les écrous d'origine qui ont été retirés précédemment et serrez au couple recommandé par le fabricant.
6. Veuillez vous référer au schéma d'ensemble et aux images de montage ci-dessus pour identifier la plaque de montage et l'orientation de la protection.
7. Suivez le même processus de l'autre côté de la moto.
8. Une fois les deux supports fixés, passez la rondelle plate et la rondelle anti-vibration (articles 7 et 8) sur chacun des boulons de montage de la protection (article 6), puis poussez-les à travers les protections et les entretoises (articles 3 et 2).
9. Serrez les boulons jusqu'à ce que la protection ne tourne plus librement, ajustez l'angle de la protection pour que le plus grand diamètre soit tourné vers l'avant de la moto, puis tout en maintenant la protection en position, serrez complètement le boulon et répétez de l'autre côté de la moto.
10. Vérifiez à nouveau que tous les boulons soient correctement serrés, puis appliquez les capuchons de boulons fournis sur chacun des boulons du support de montage, puis sur les capuchons de la protection.

ISSUE 1 – 03/01/2024 TB

### **CONSUMER NOTICE**

The catalogue description and any exhibition of samples are only broad indications of the Products and R&G may make design changes which do not diminish their performance or visual appeal and supplying them in such state shall conform to the order. The Buyer acknowledges no representation or warranty (other than as to title) has been given or will apply to the Products other than those in R&G's order or confirmation and the Buyer confirms it has chosen the Products as being of merchantable quality and suitable for its particular purposes. Where R&G fits the Products or undertakes other services it shall exercise reasonable skill and care and rectify any fault free of charge unless the workmanship has been disturbed. The Buyer is responsible for ensuring that the warranty on the motorcycle is not affected by the fitting of the Products. On return of any defective Products R&G shall at its option either supply a replacement or refund the purchase money but shall not be liable if the Products have been modified or used or maintained otherwise than in accordance with R&G's or manufacturer's instructions and good engineering practice or if the defect arises from accident or neglect. Other than identified above and subject to R&G not limiting its liability for causing death and personal injury, it shall not be liable for indirect or consequential loss and otherwise its liability shall be limited to the amounts paid by the Buyer for the Products or the fitting or service concerned. These terms do not affect the Buyer's statutory rights.

### **R&G RACING RETURNS POLICY (NON-FAULTY GOODS)**

Returns must be pre-authorized (if not pre-authorized the return will be rejected). Goods may only be returned direct to us if they were purchased direct from us (customer must prove if necessary). Otherwise, to be returned to original vendor. Goods must be in re-sellable condition, in the opinion of R&G Racing. All returns are subject to a 25% restocking and handling fee (25% of the gross value exc. P&P – at the prevailing price at time of purchase). The customer must pay any and all carriage charges. No returns of discontinued products, unless within 14 days of purchase. This policy does not affect your statutory rights and does not refer to faulty goods.

R&G Racing

Unit 1, Shelley's Lane, East Worldham, Alton, Hampshire, GU34 3AQ

Tel: +44 (0)1420 89007 Fax: +44 (0)1420 87301 [www.rg-racing.com](http://www.rg-racing.com) Email: [info@rg-racing.com](mailto:info@rg-racing.com)