



**EVOTECH**®  
P E R F O R M A N C E

Kawasaki Ninja 1000 SX  
Radiator Guard

Installation Instructions



Kit Contents PRN015093

Ⓐ 4 x Push Pins



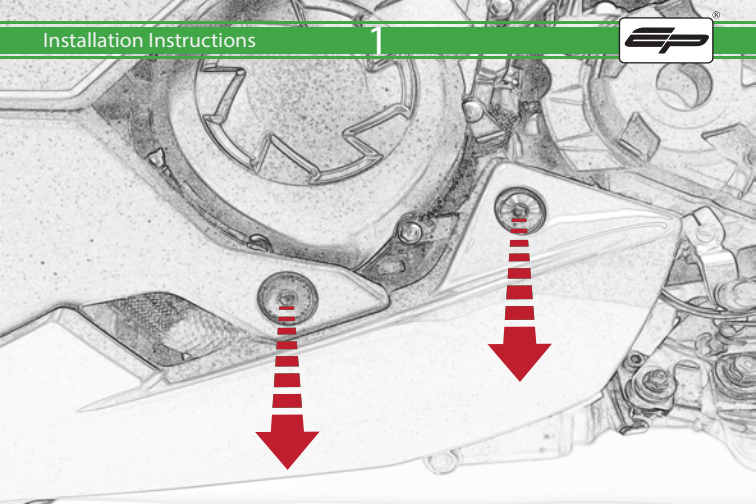

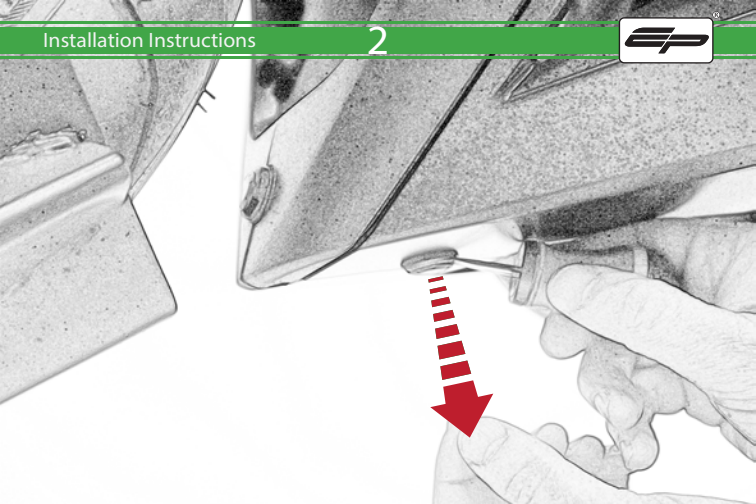

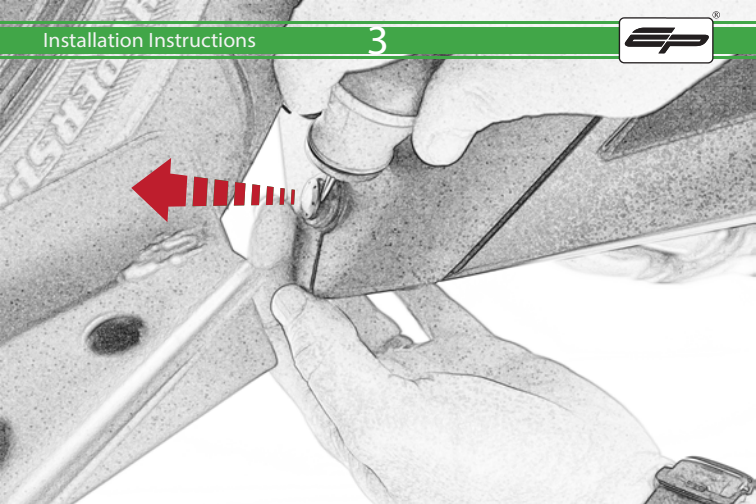

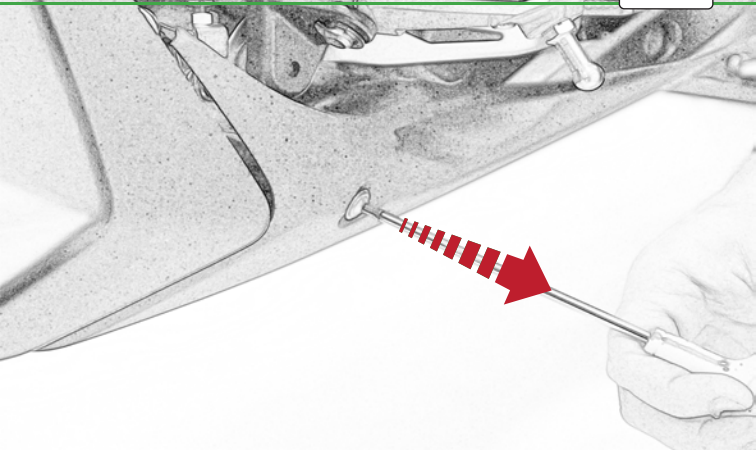

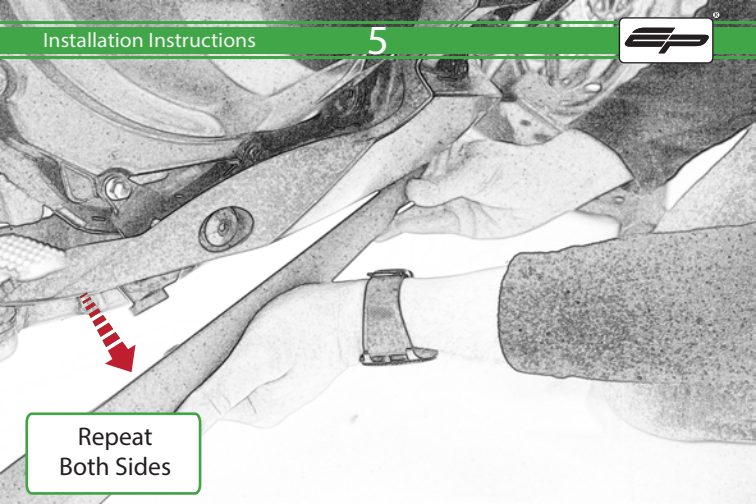

Repeat  
Both Sides

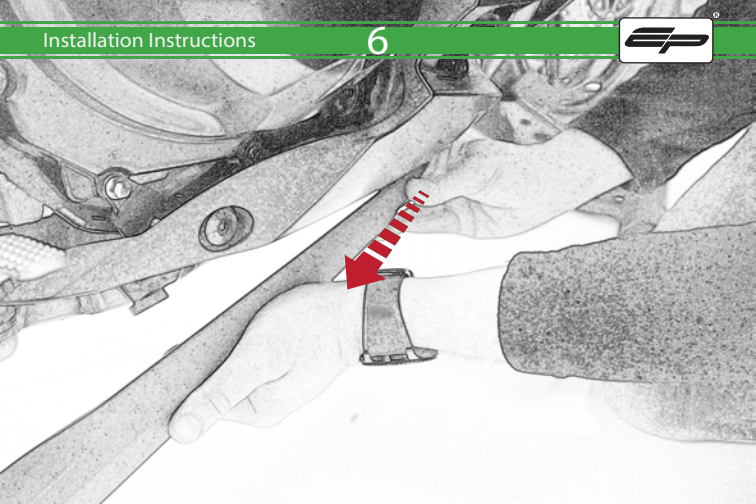





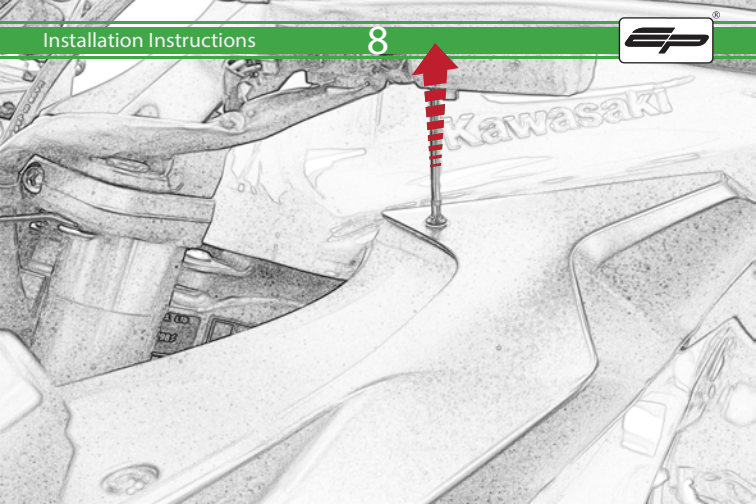

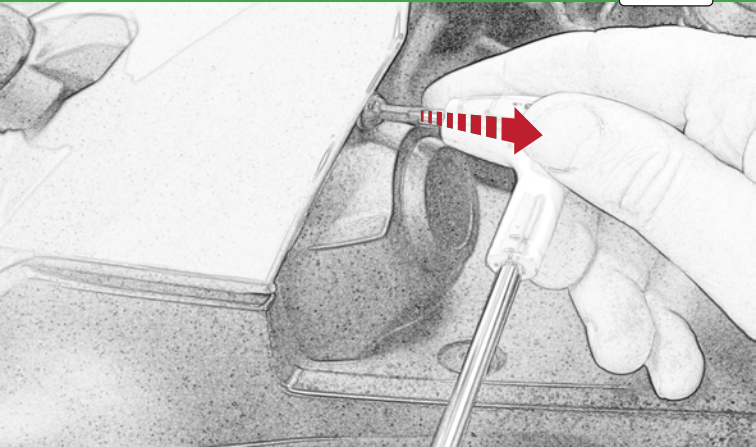

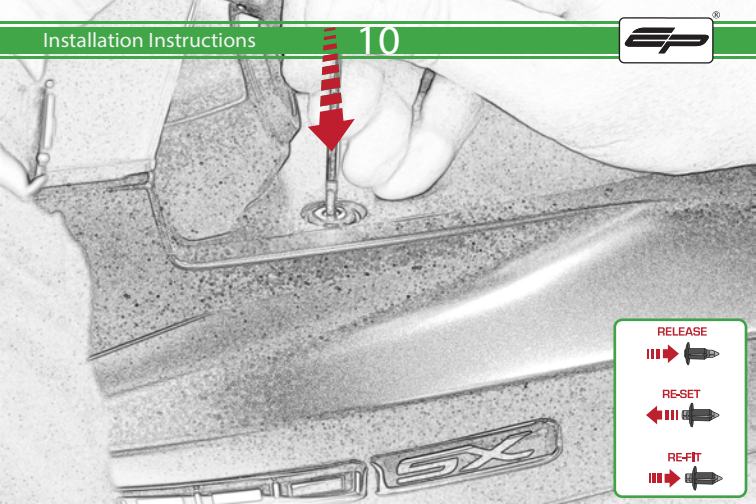

RELEASE



RE-SET



RE-FIT



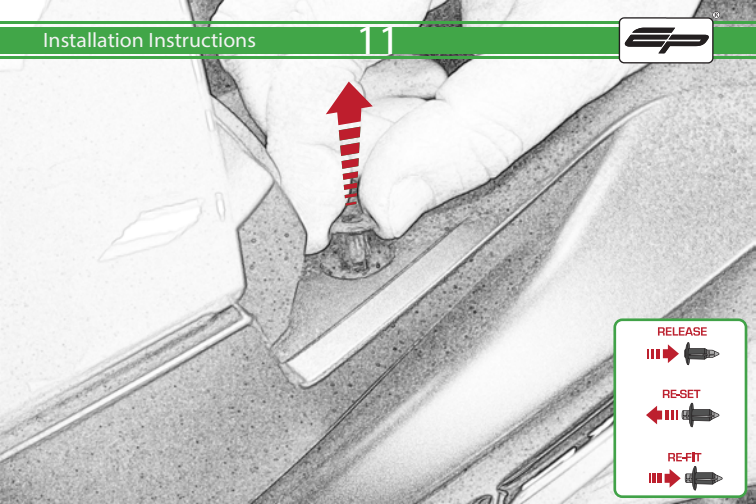

RELEASE



RE-SET



RE-FIT



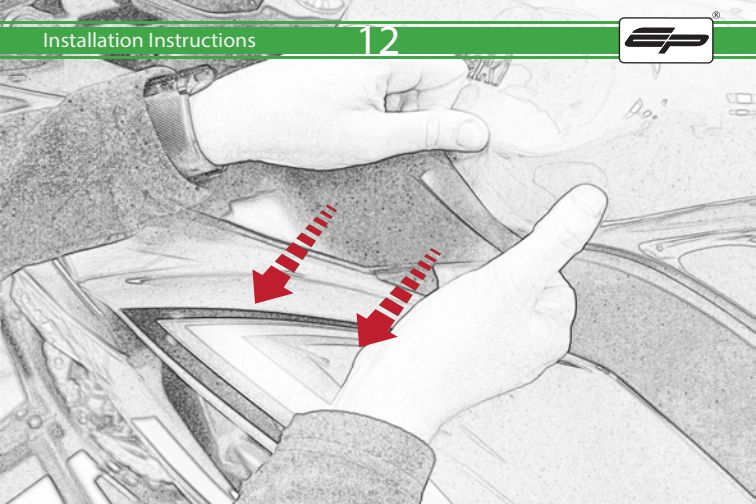

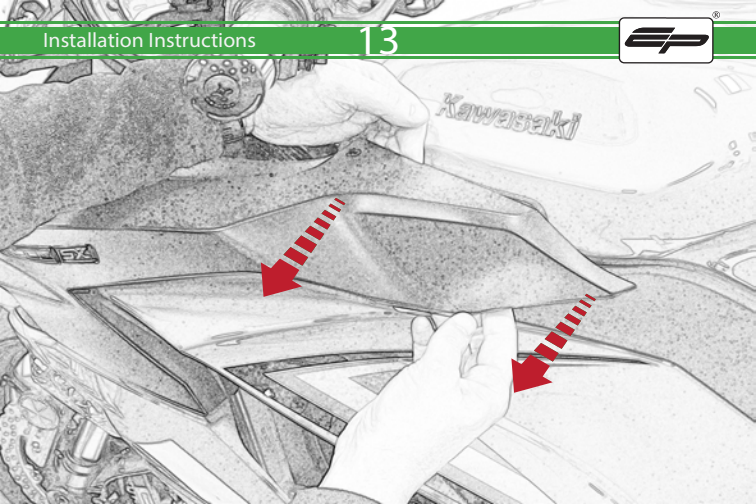

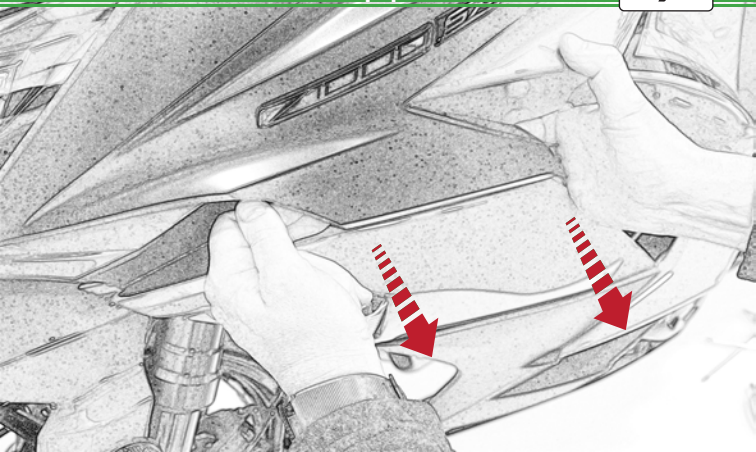



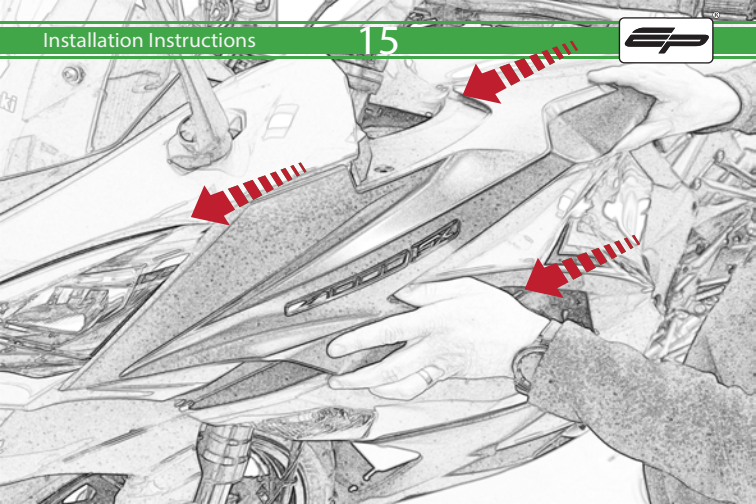

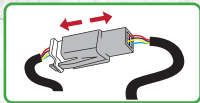
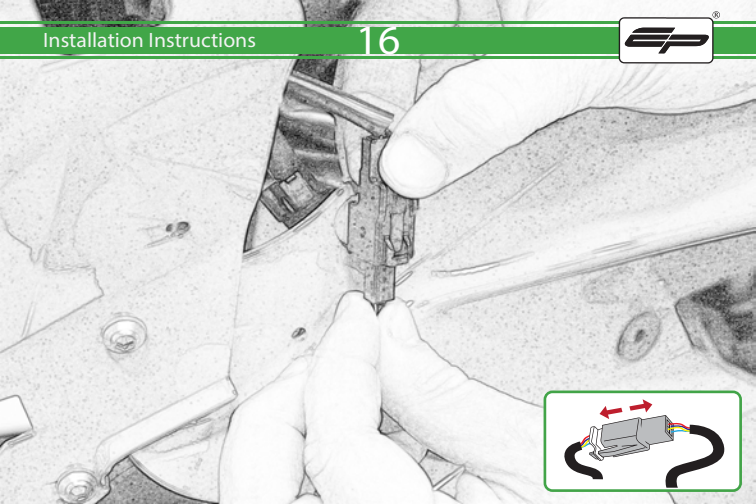

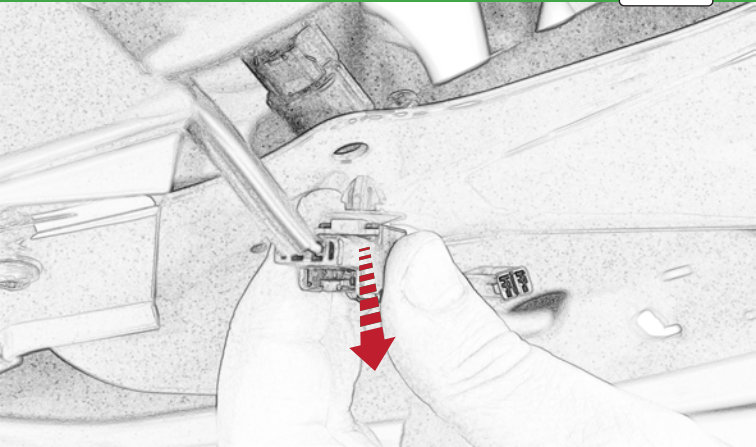



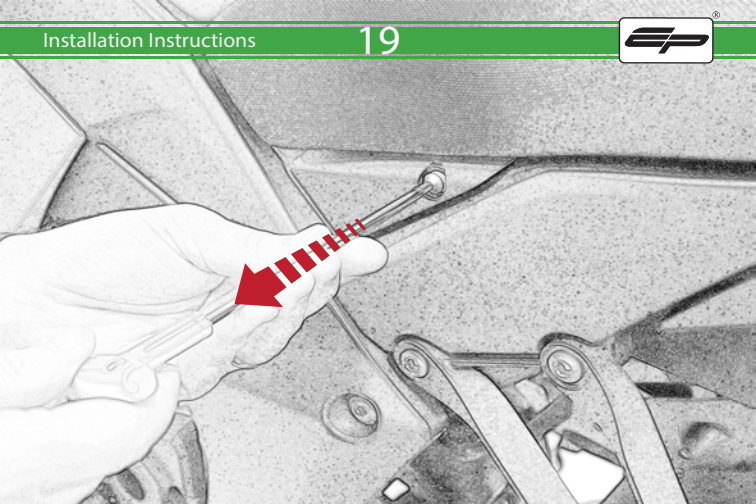

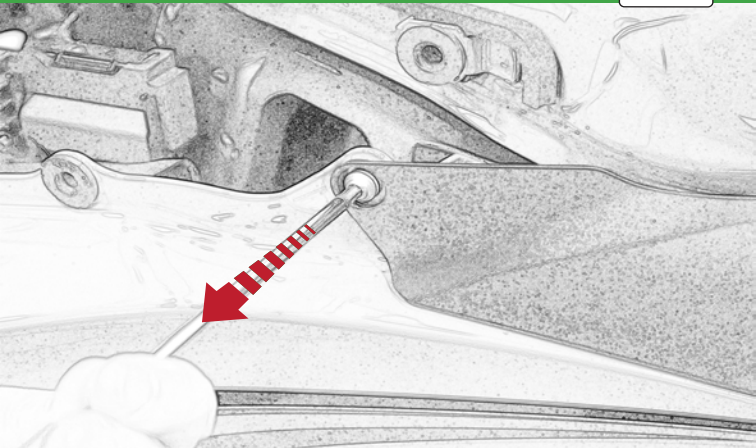



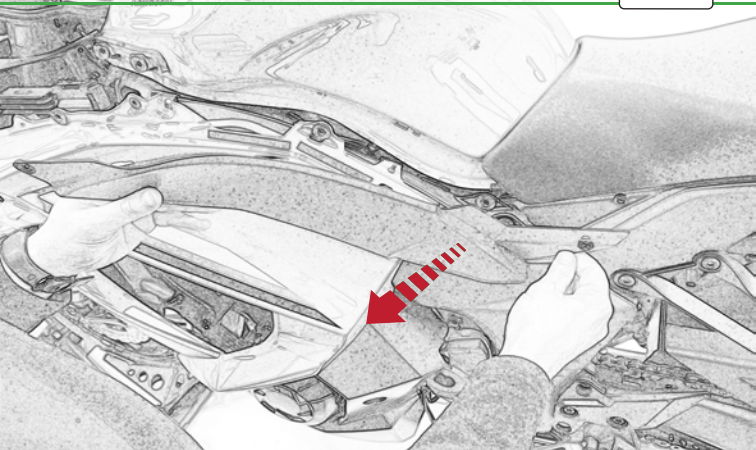



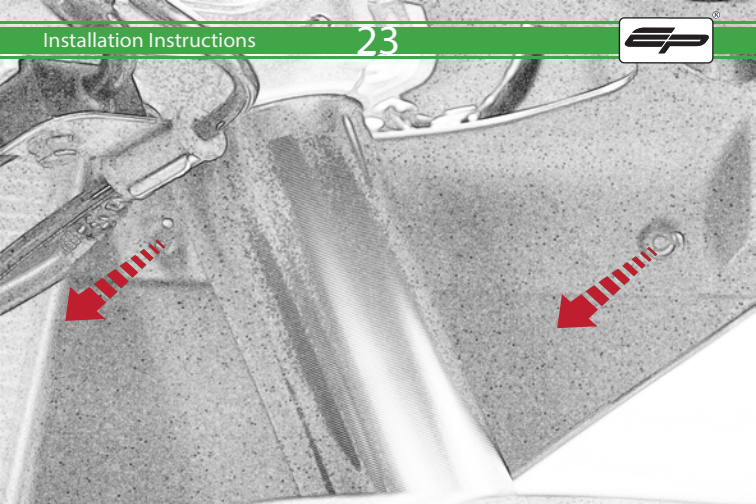



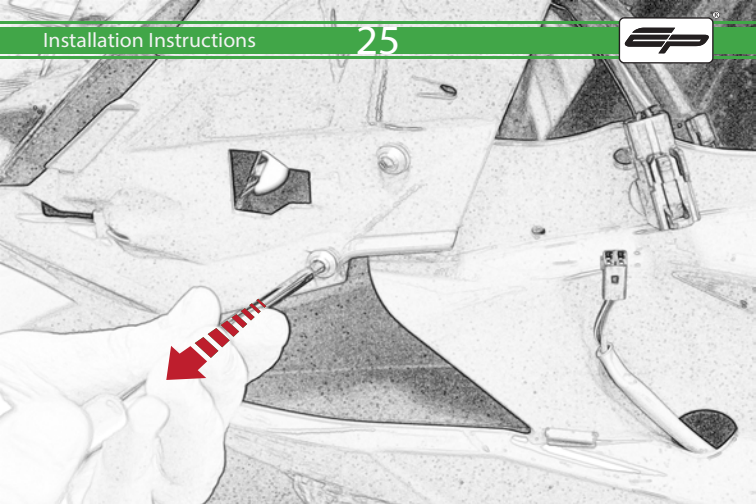

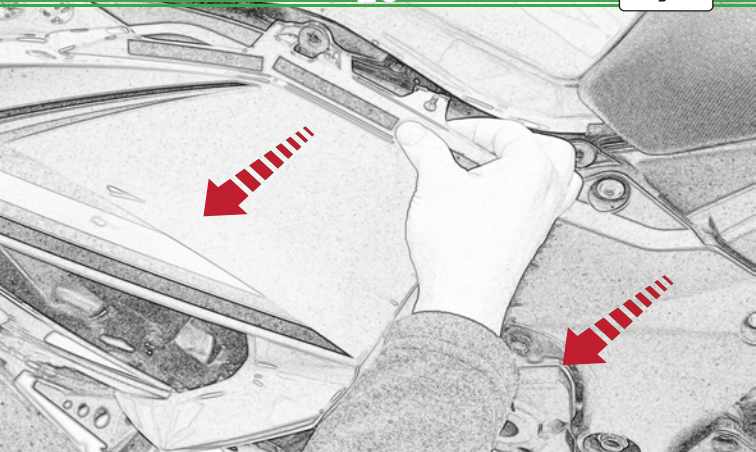

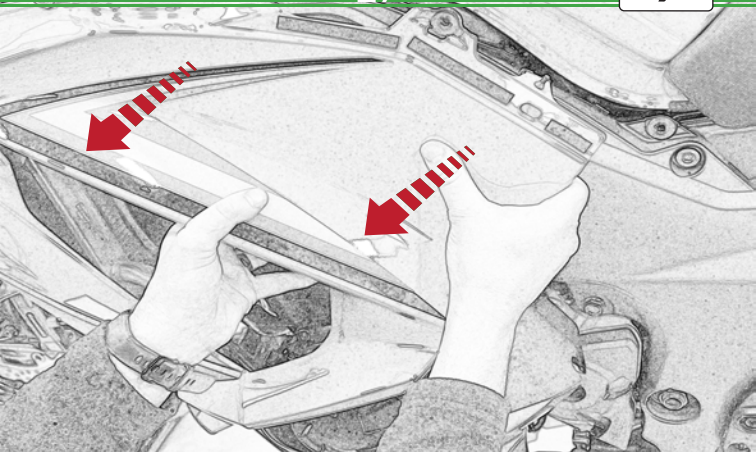

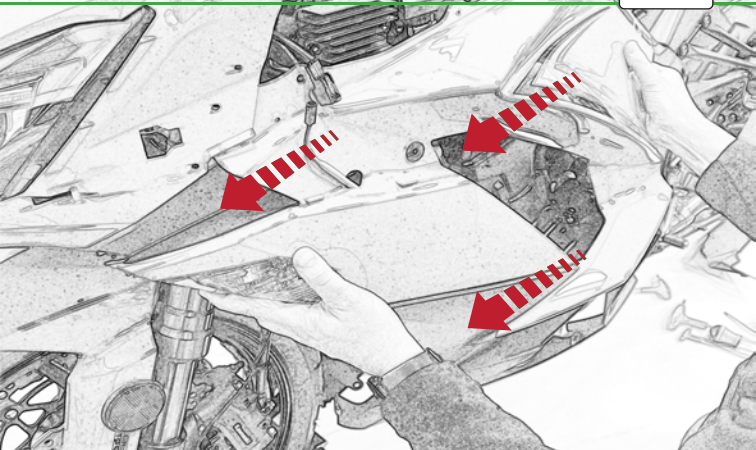

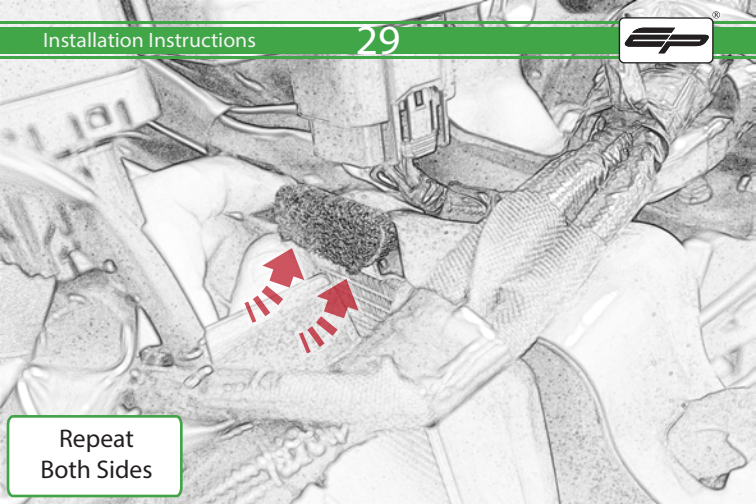

Repeat  
Both Sides



Repeat  
Both Sides



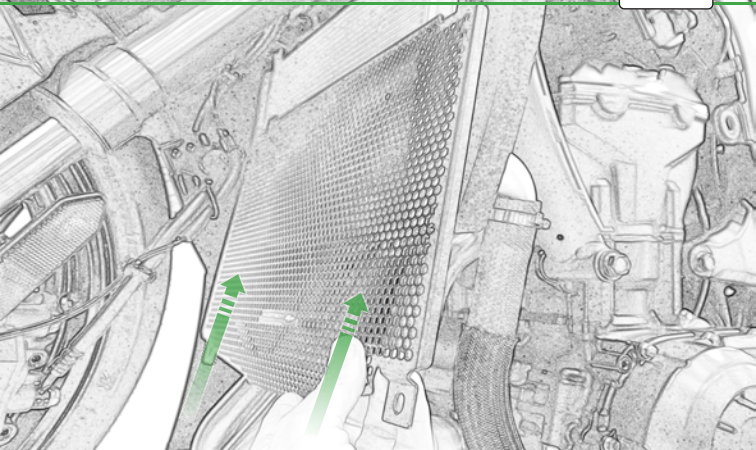





PUSH



Repeat  
Both Sides



PUSH

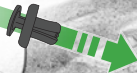

Repeat  
Both Sides



Reverse Stages

28 - 1



## ESSENTIAL CHECKS



It is recommended that periodic inspections are made to ensure that dirt and debris have not become trapped between the guard and the radiator/oil cooler. Such dirt and debris would reduce the cooling efficiency of the radiator/oil cooler.

It is recommended that periodic inspections are made to ensure that all fixings are fully tightend.



**EVOTECH**®  
P E R F O R M A N C E

[www.evotech-performance.com](http://www.evotech-performance.com)