

EVOTECH®
P E R F O R M A N C E

www.evotech-performance.com

Yamaha R1 /R1M / R6 Brake Protector Set Installation Instructions



Kit Contents PRN014760-014761

- (A) 1 x Bar End
- (B) 1 x Inner Spacer
- (C) 1 x O-Ring
- (D) 1 x Brake Protector Arm
- (E) 1 x Outer Spacer
- (F) 2 x M6 x 35 SS Caphead
- (G) 1 x Main Tail Tidy

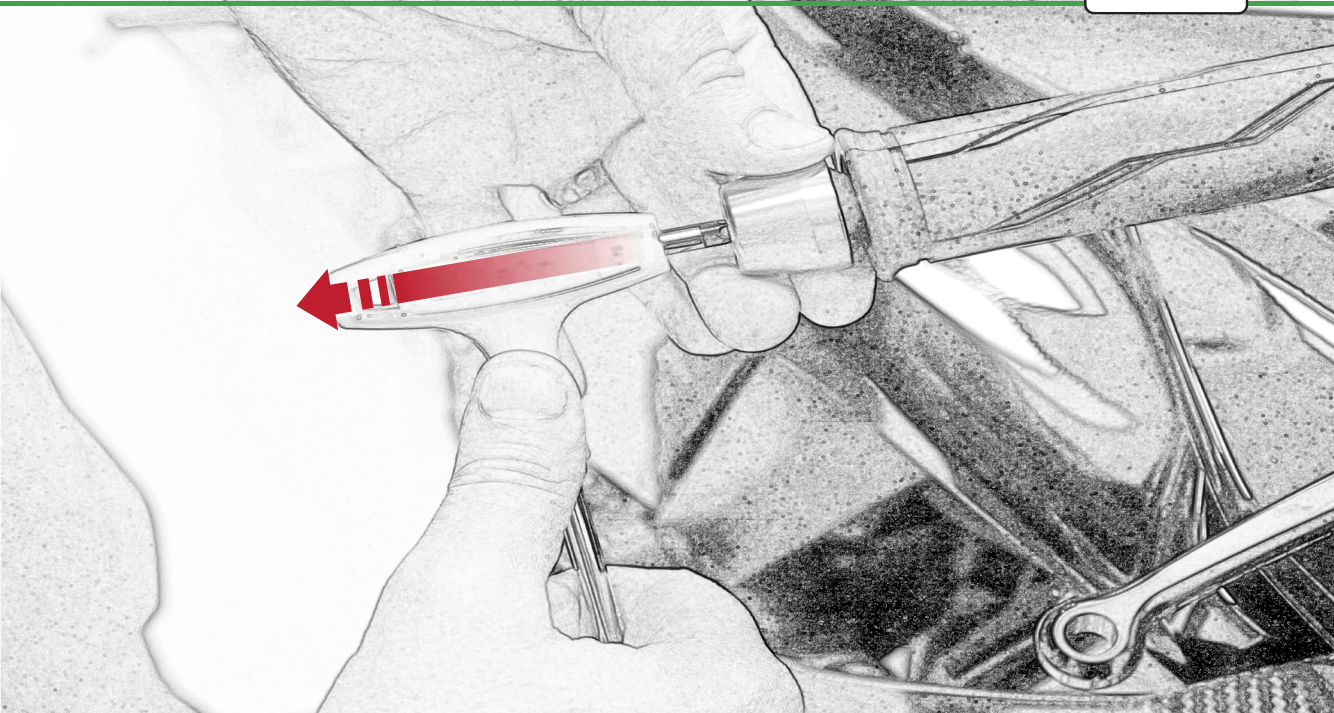

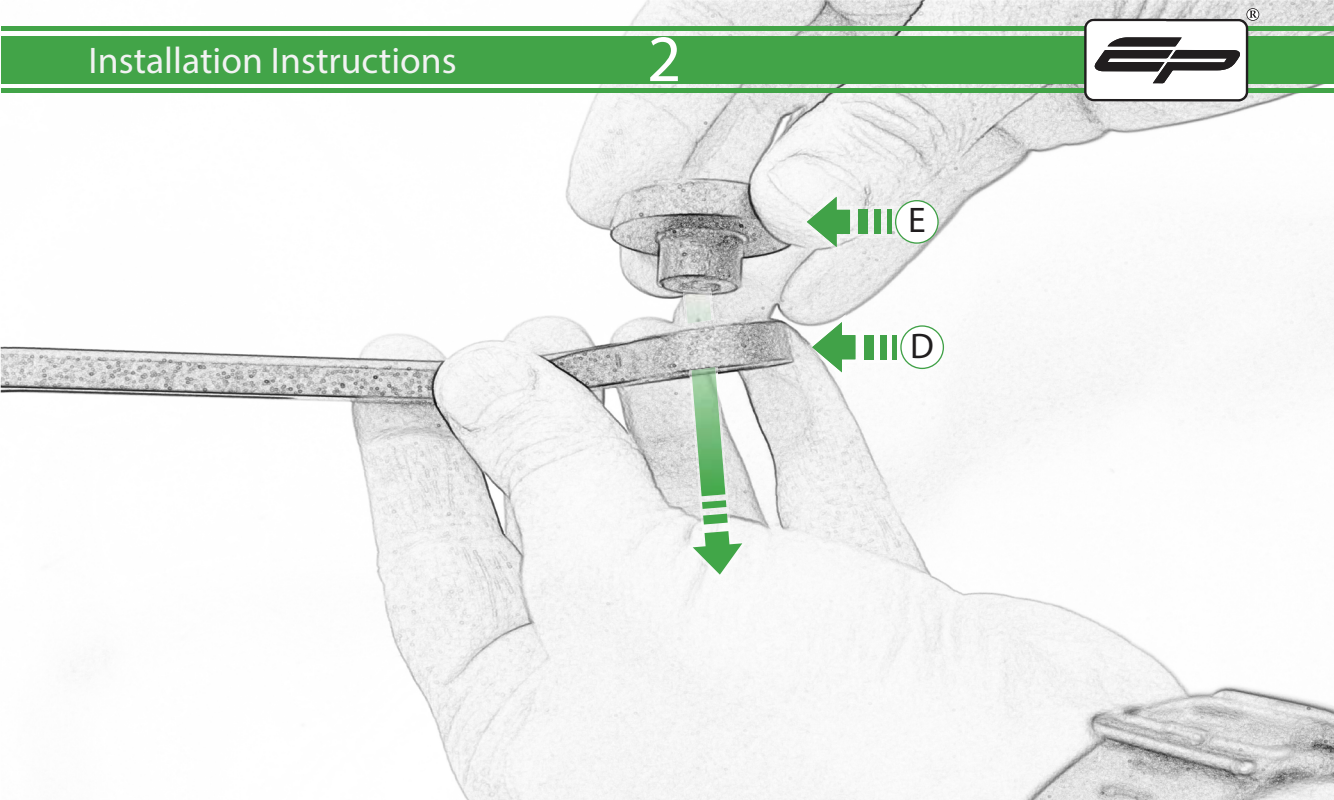

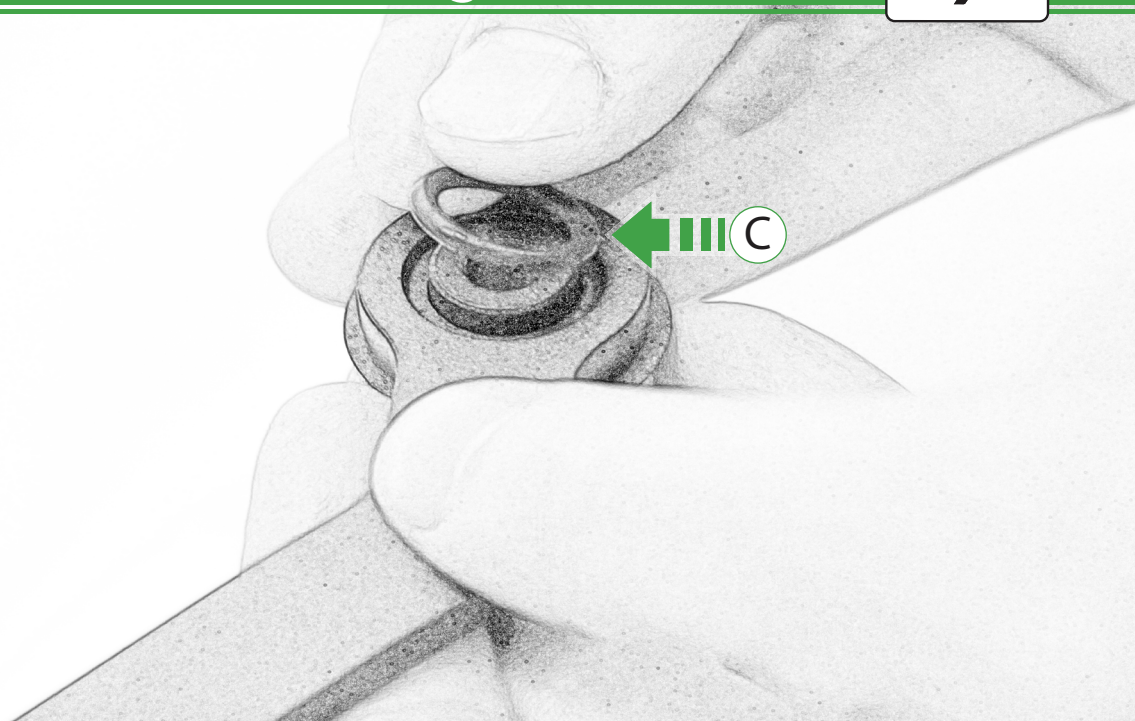

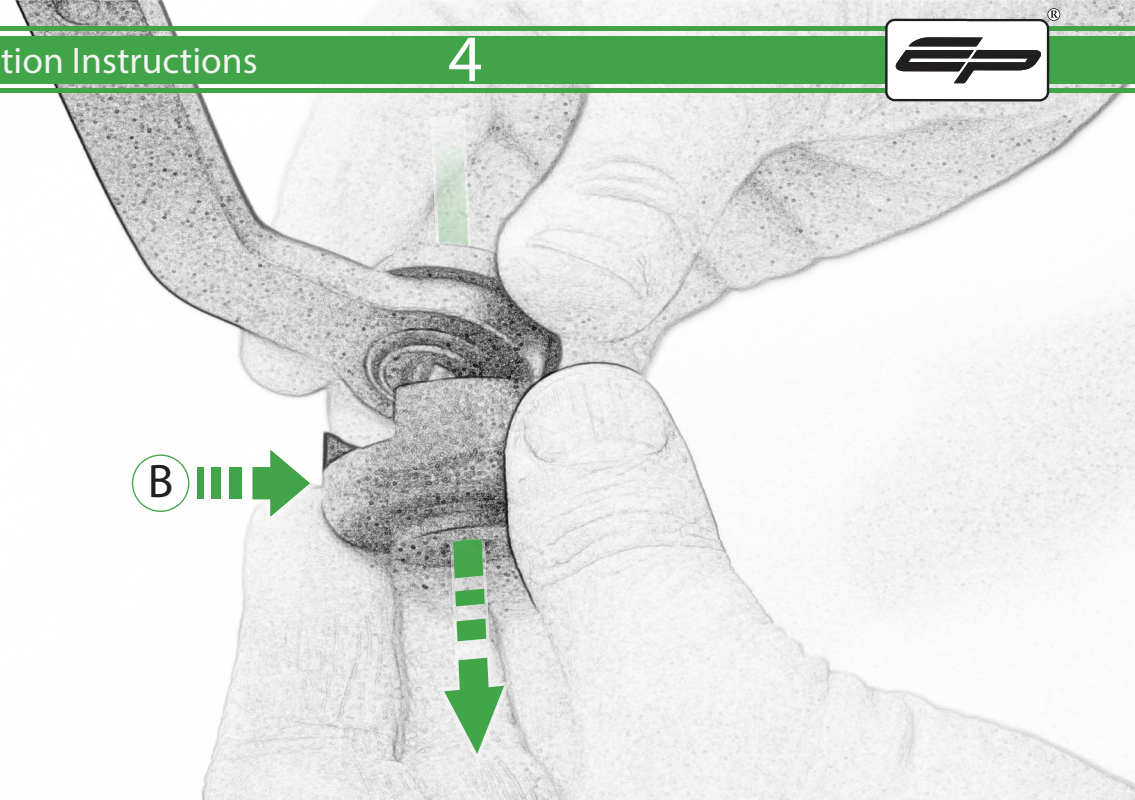

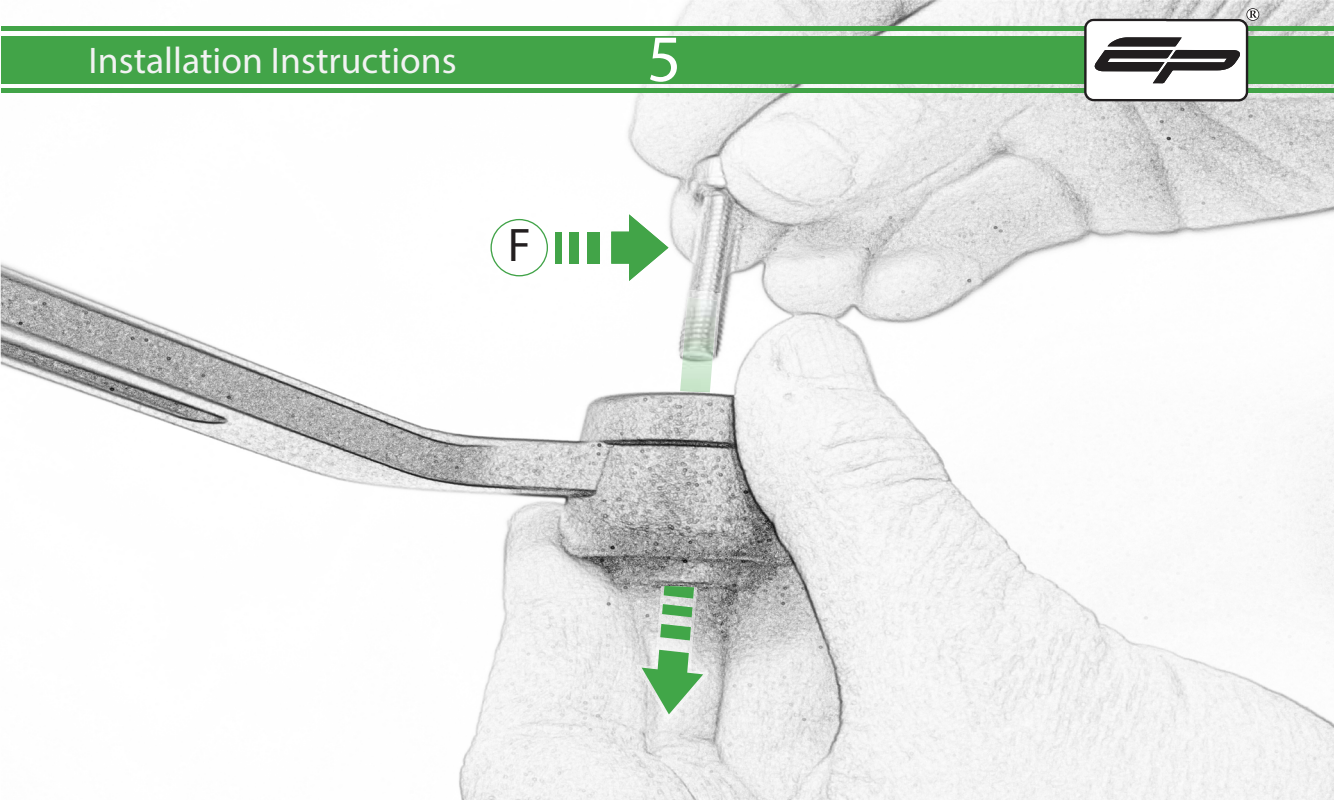

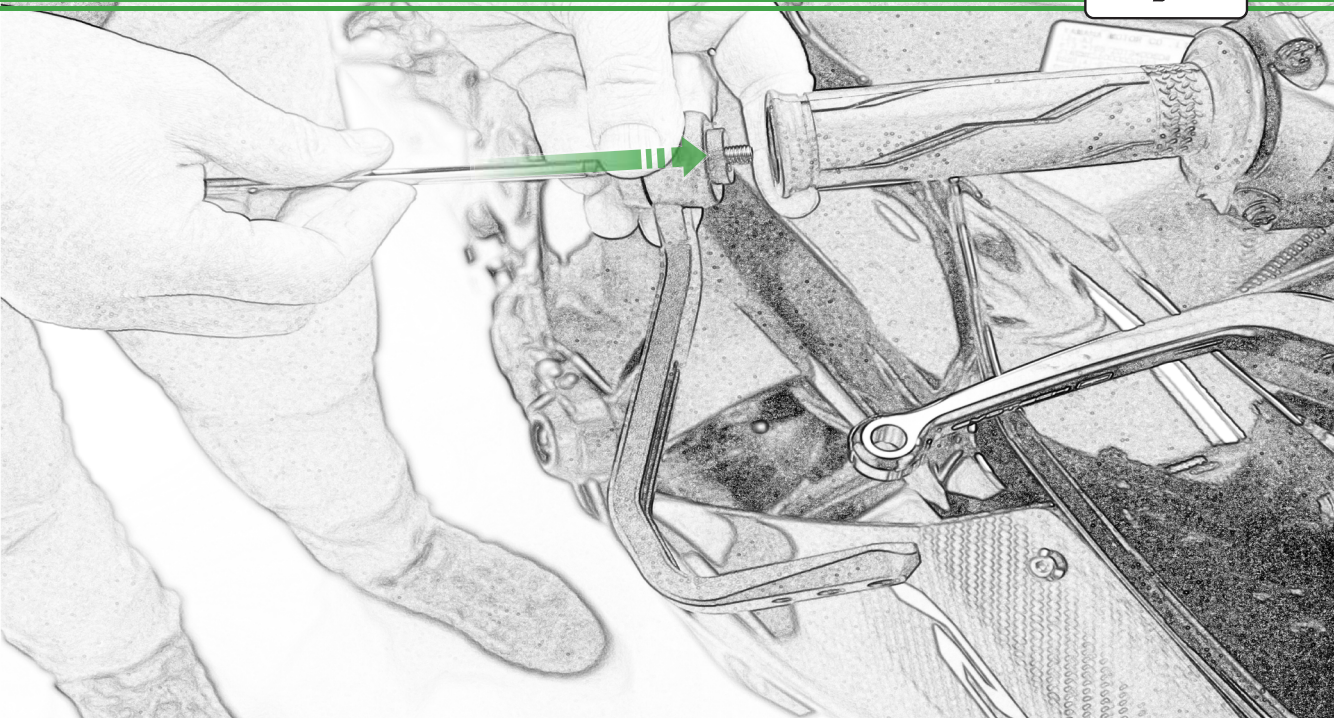

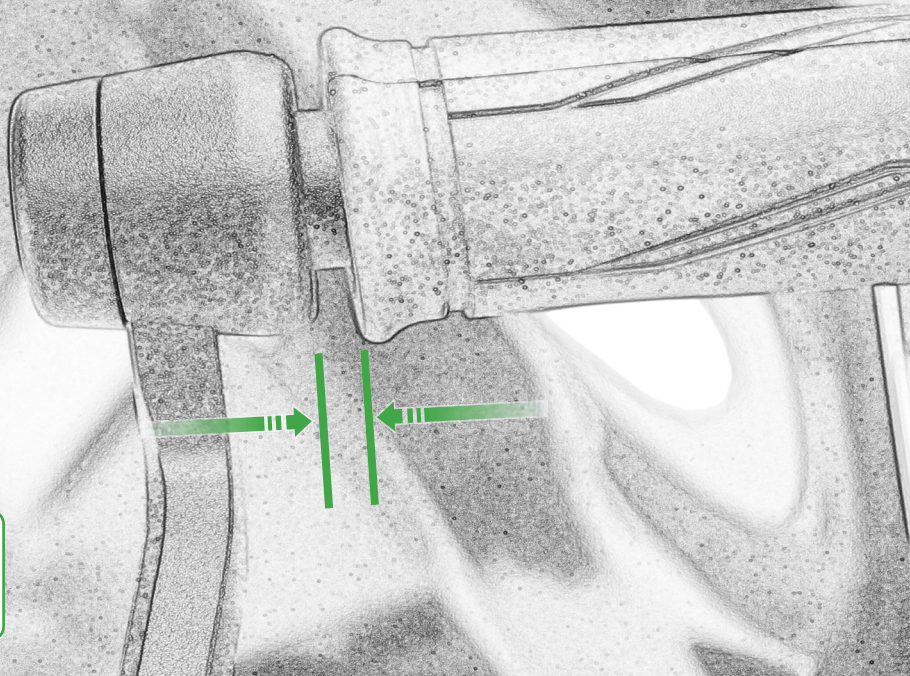

Caution

Ensure Gap is
4mm - 5mm



Caution

**Test Throttle
Free Play**

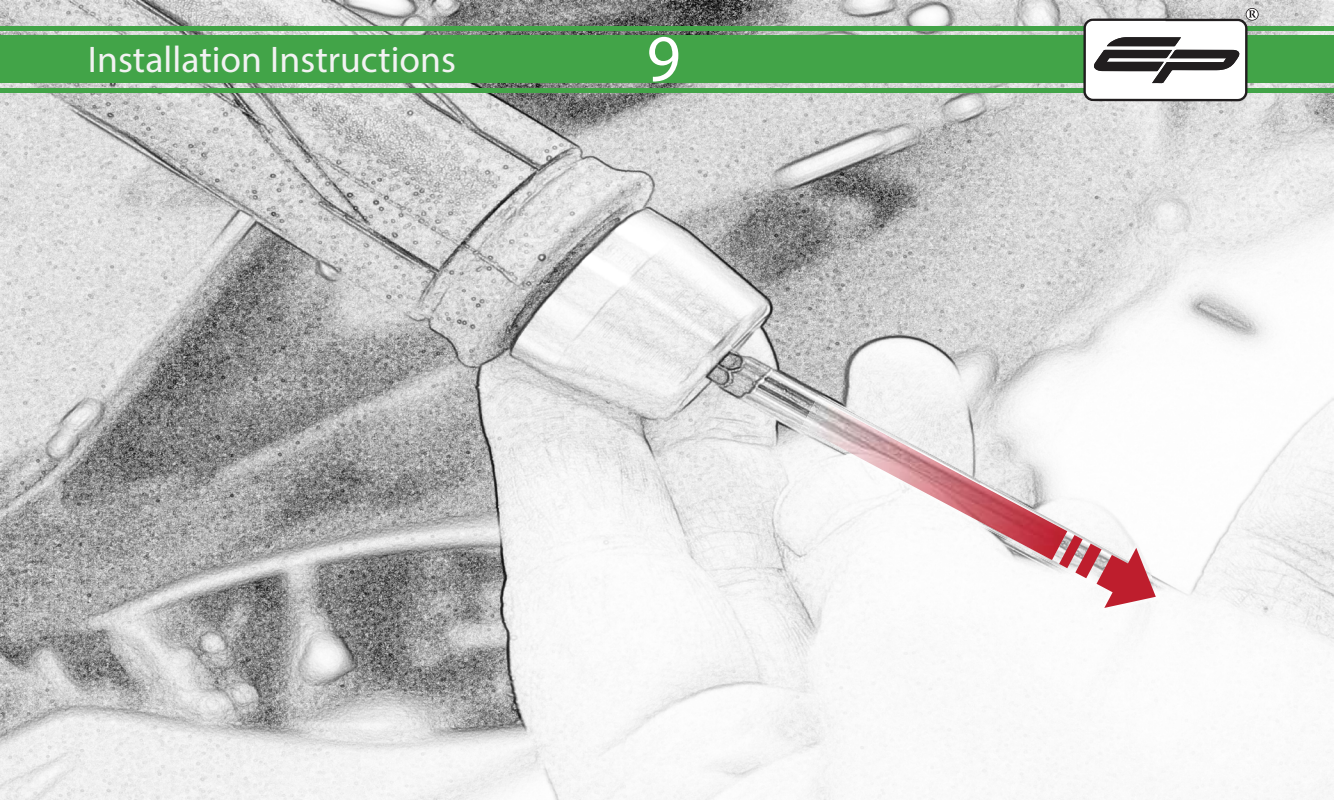



A

E



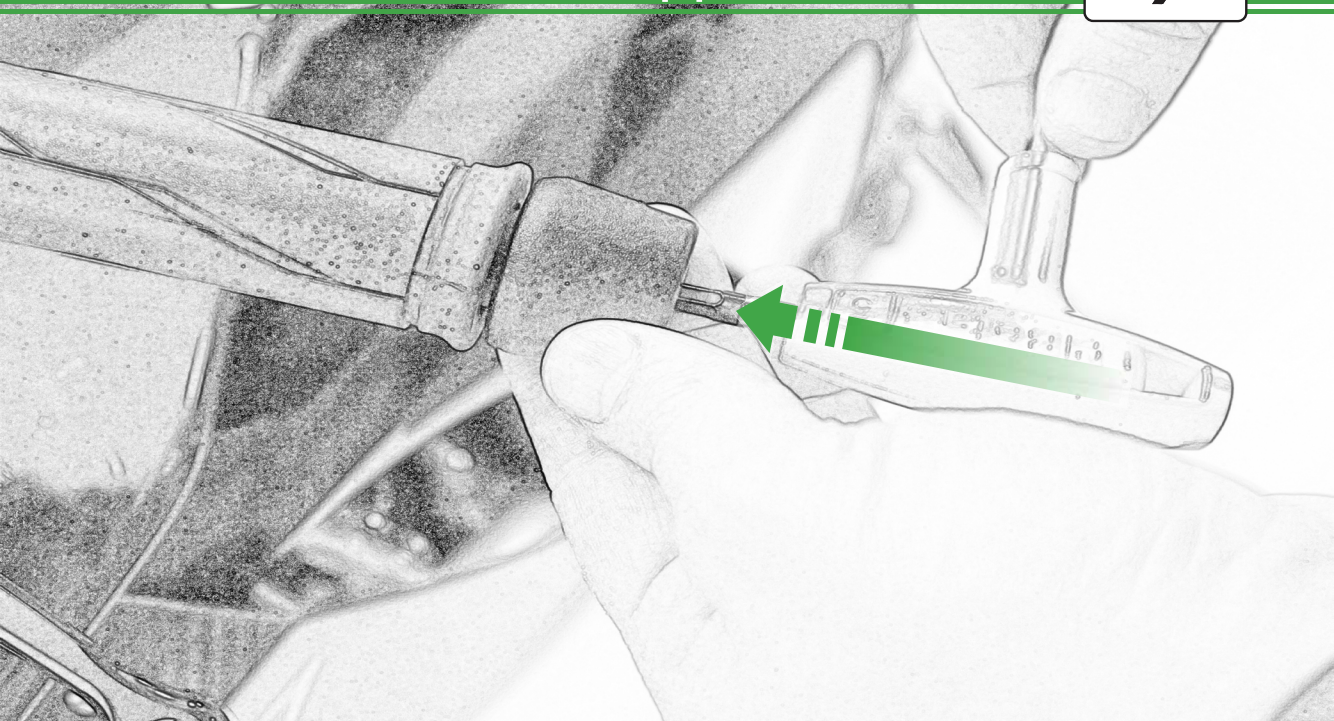

ESSENTIAL CHECKS

It is recommended that periodic inspections are made to ensure that all bolts are tightened to the specified torque settings.

Should the bike be involved in an accident a thorough inspection should be made and any components that have taken an impact, no matter how small, be replaced



EVOTECH®
P E R F O R M A N C E

www.evotech-performance.com