



EVOTECH®
P E R F O R M A N C E

Triumph
Crash Protection

Installation Instructions

Kit Contents PRN014714

- (A) 1 x L/H Inner Bracket
- (B) 1 x R/H Inner Bracket
- (C) 1 x M12 Cross Bar
- (D) 2 x Large Bobbin Head
- (E) 2 x Outer Bracket
- (F) 2 x Bobbin Spacer
- (G) 2 x M12 Washer
- (H) 2 x M12 x 180 x 1.25 Caphead
- (I) 2 x Frame Spacer
- (J) 2 x Polyurathane Washer

Installation Instructions

1



17mm Socket

Repeat
Both Sides

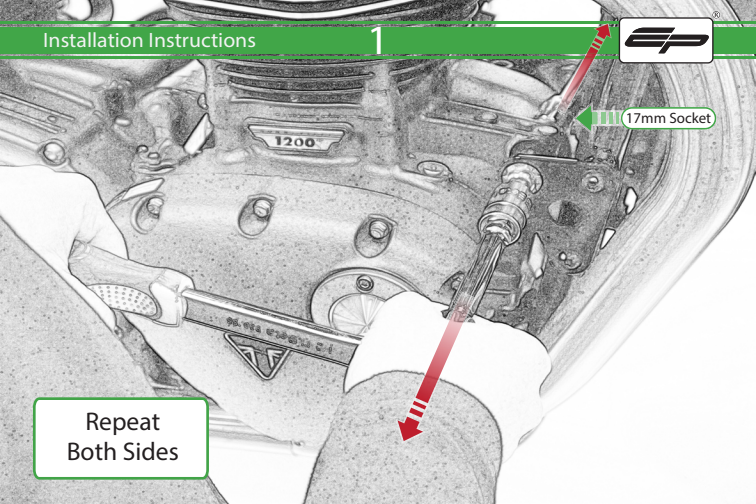

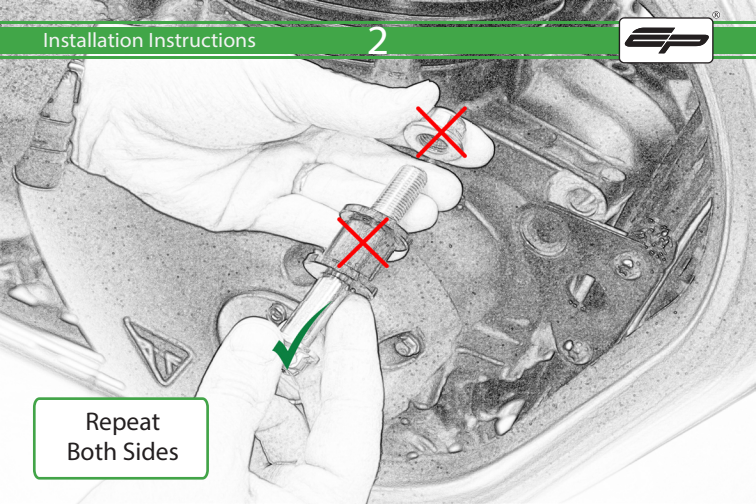

Repeat
Both Sides

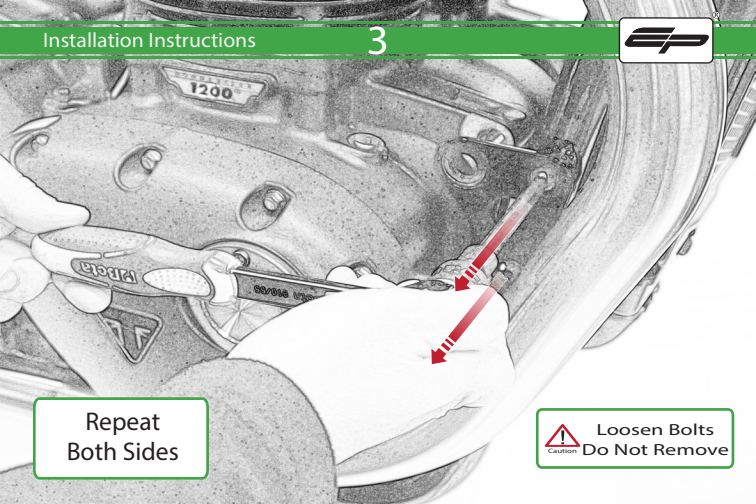

Repeat
Both Sides



Caution

Loosen Bolts
Do Not Remove

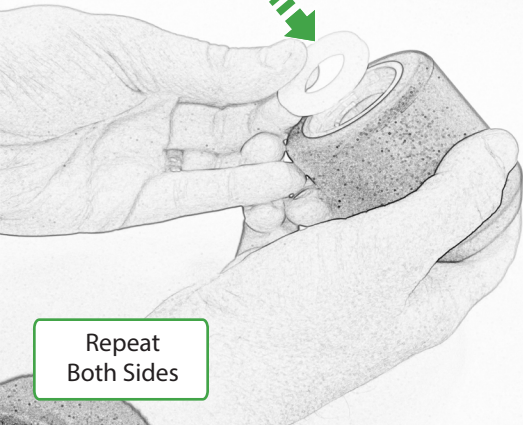

Repeat
Both Sides

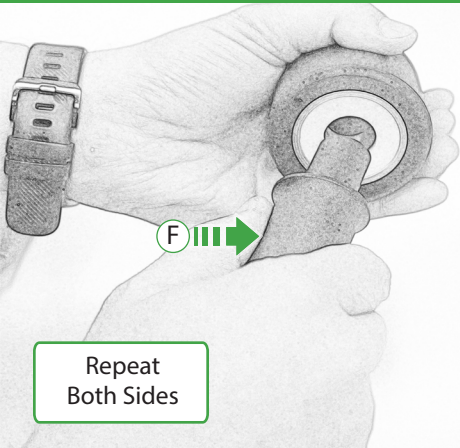

Repeat
Both Sides

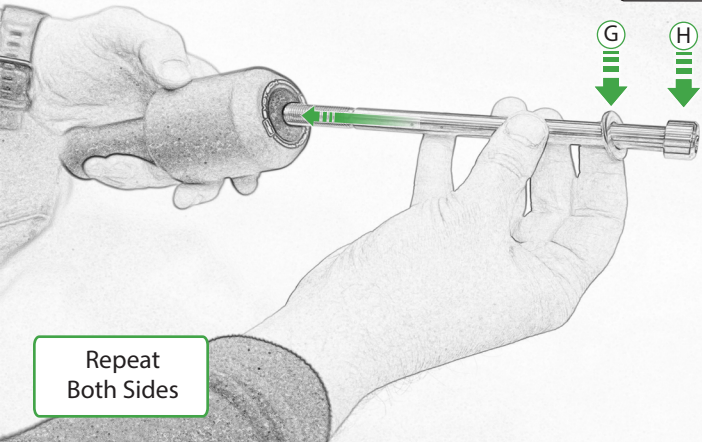

Repeat
Both Sides

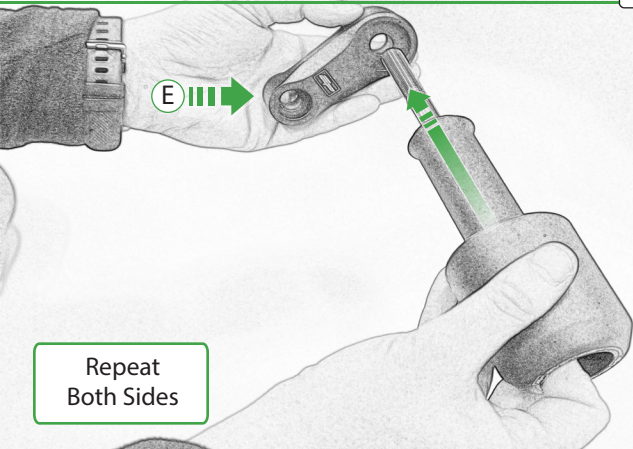

Repeat
Both Sides

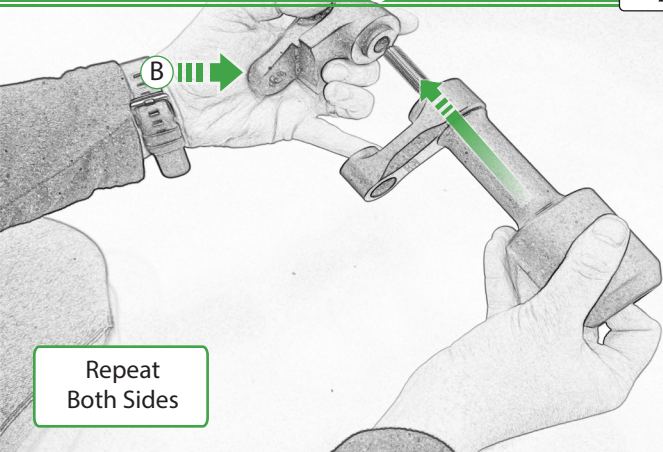

Repeat
Both Sides

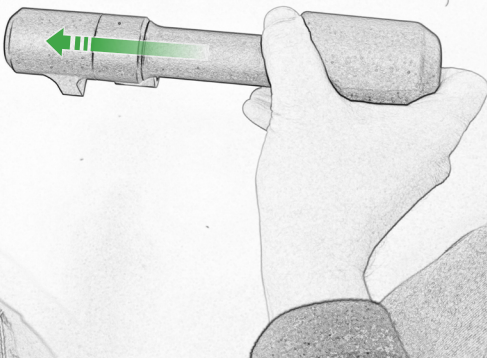
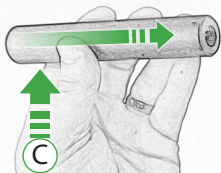

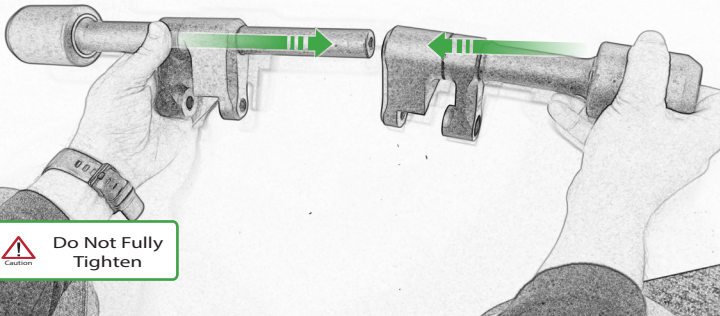

Caution

**Do Not Fully
Tighten**

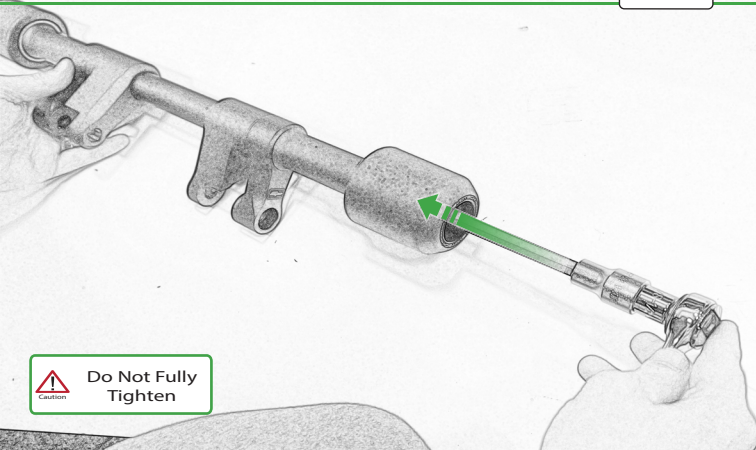

Caution

**Do Not Fully
Tighten**

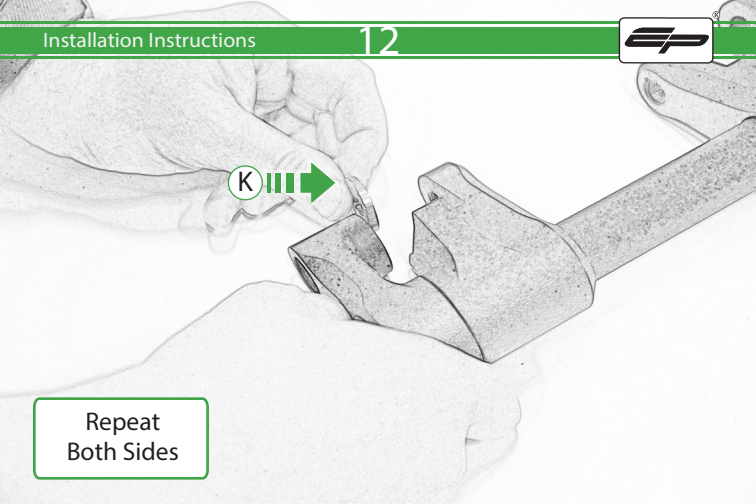

K →

Repeat
Both Sides

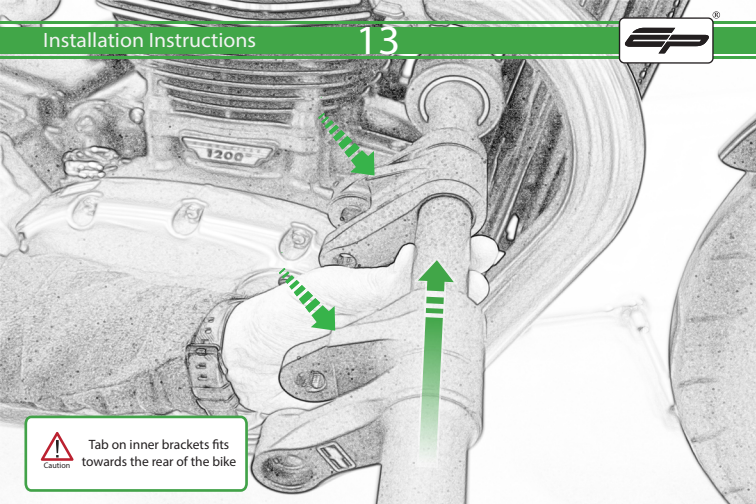

Caution

Tab on inner brackets fits towards the rear of the bike

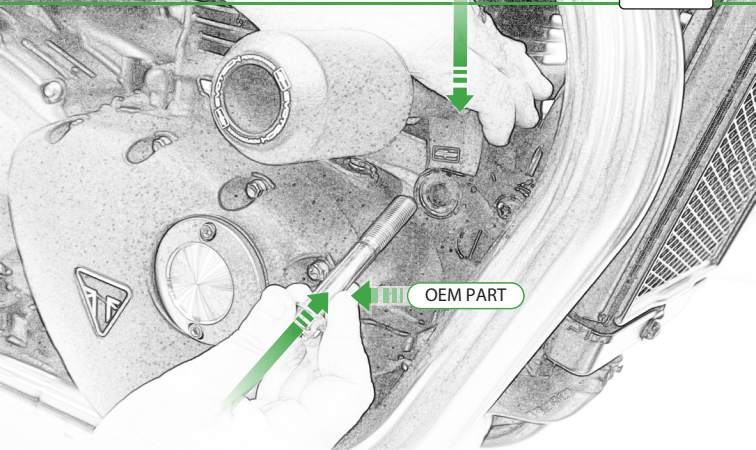

OEM PART

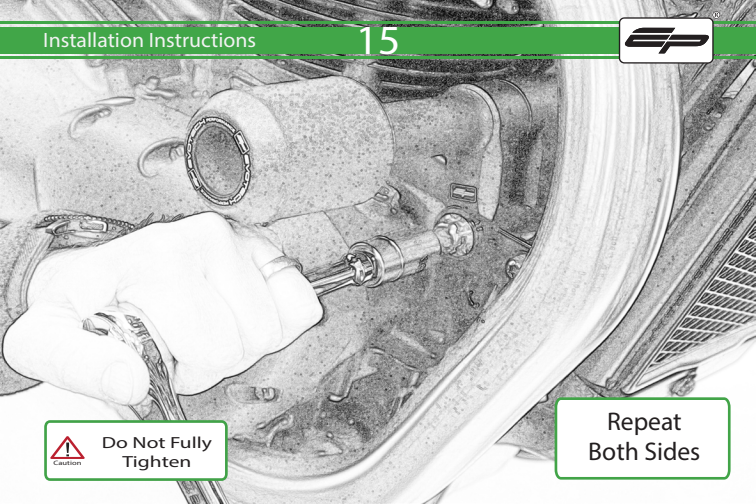

**Do Not Fully
Tighten**

**Repeat
Both Sides**

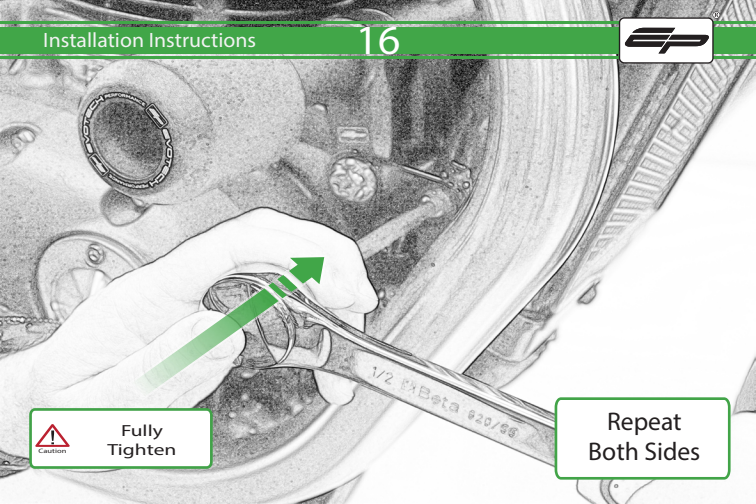

Caution

Fully
Tighten

Repeat
Both Sides

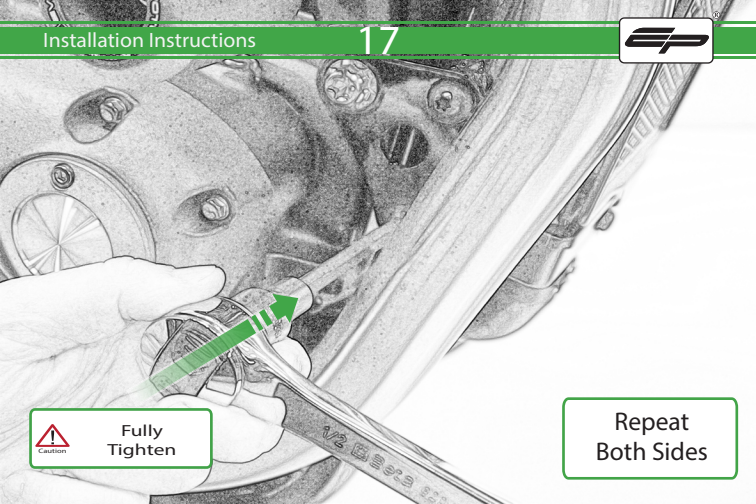

Fully
Tighten

Repeat
Both Sides

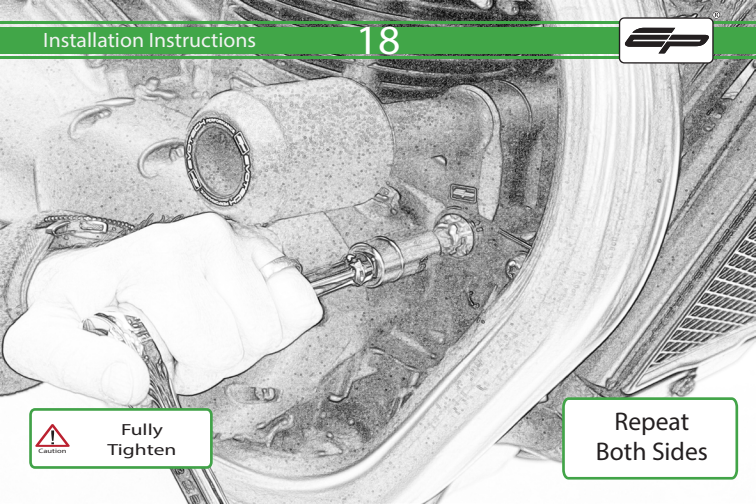

Caution

Fully
Tighten

Repeat
Both Sides

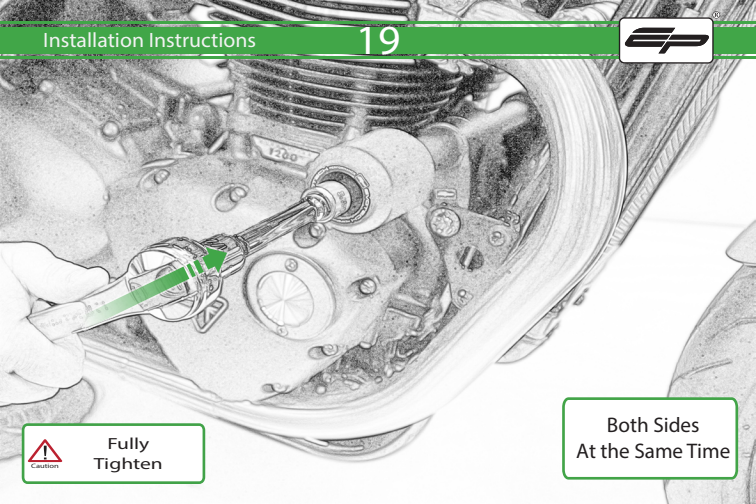

**Fully
Tighten**

**Both Sides
At the Same Time**

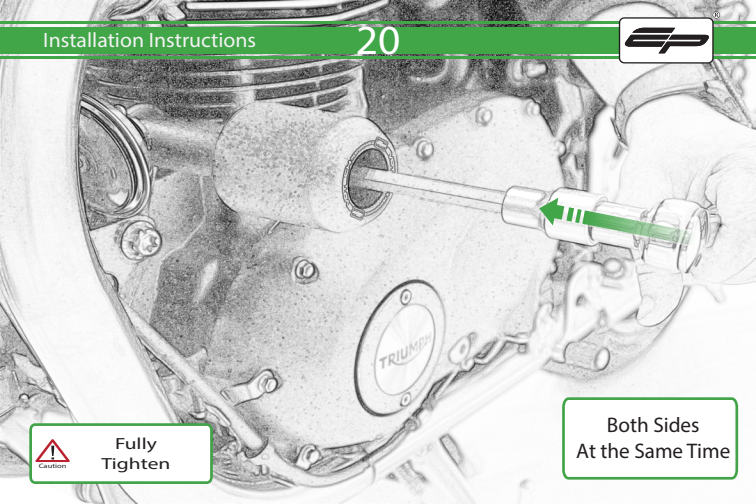

Fully
Tighten

Both Sides
At the Same Time



 **ESSENTIAL CHECKS** 

It is recommended that periodic inspections are made to ensure that all bolts are tightened to the specified torque settings.

Should the bike be involved in an accident a thorough inspection should be made and any components that have taken an impact, no matter how small, be replaced



EVOTECH®
P E R F O R M A N C E

www.evotech-performance.com