



EVOTECH®
P E R F O R M A N C E

www.evotech-performance.com

Suzuki V-Strom 1050

Tom Tom Sat Nav Mount Instruction



Kit Contents PRN014567-015140

- Ⓐ 1 x Upper Mounting Body
- Ⓑ 1 x Lower Mounting Body
- Ⓒ 1 x Mounting Plate
- Ⓓ 1 x Tom Tom Mounting Plate
- Ⓔ 2 x Spacer
- Ⓕ 2 x M4 x 30mm Caphead Bolts
- Ⓖ 2 x O-ring
- Ⓗ 2 x M5 x 8mm Black Button Head Bolts
- Ⓘ 4 x M5 x 12mm Black Button Head Bolts

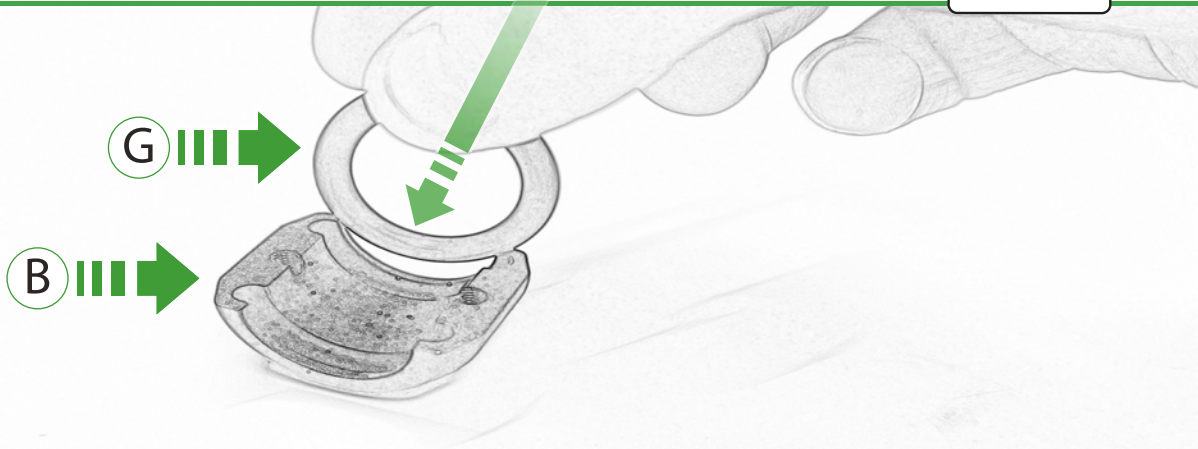

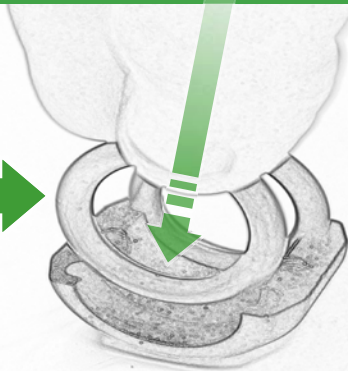

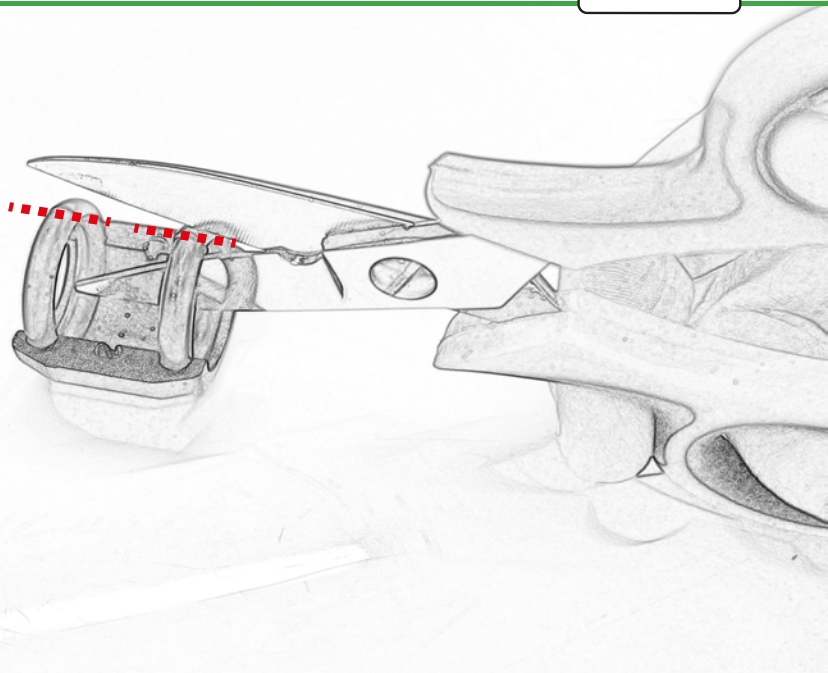

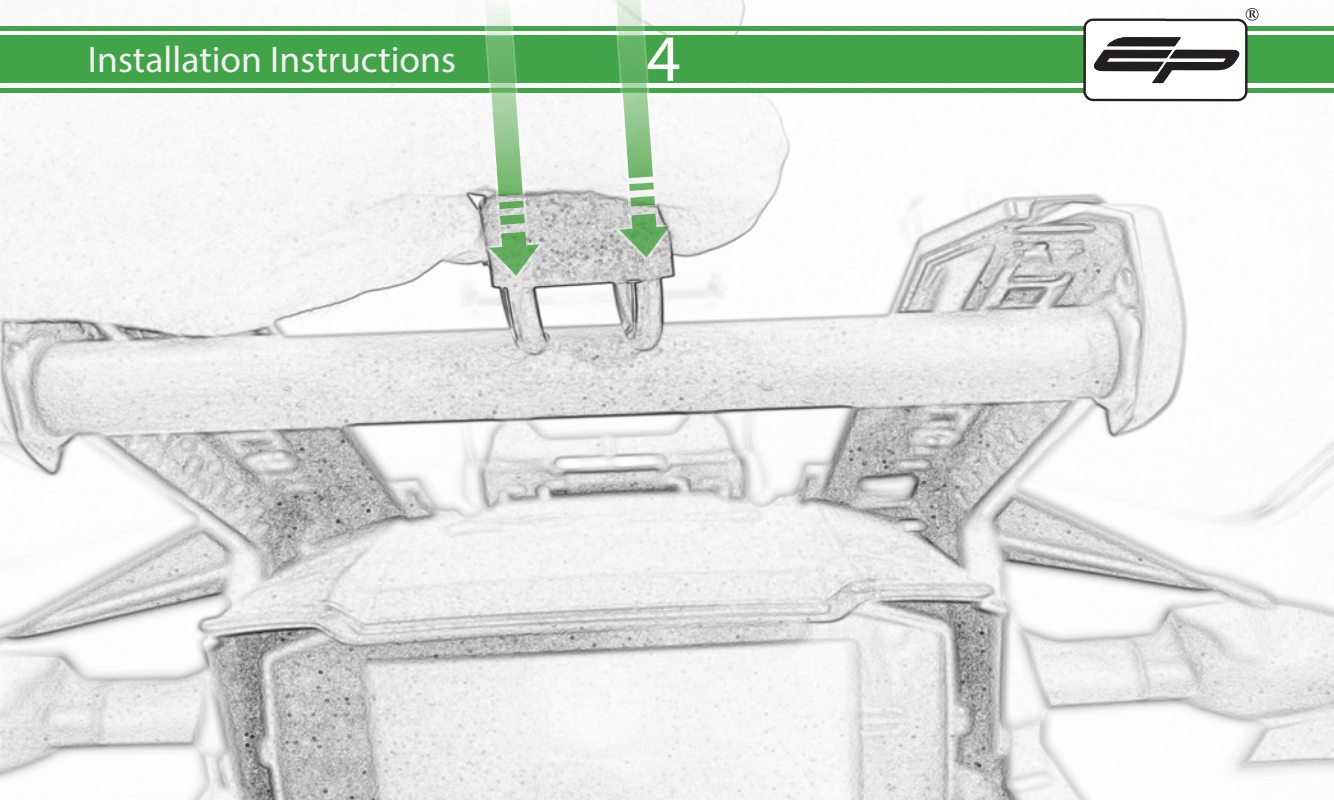

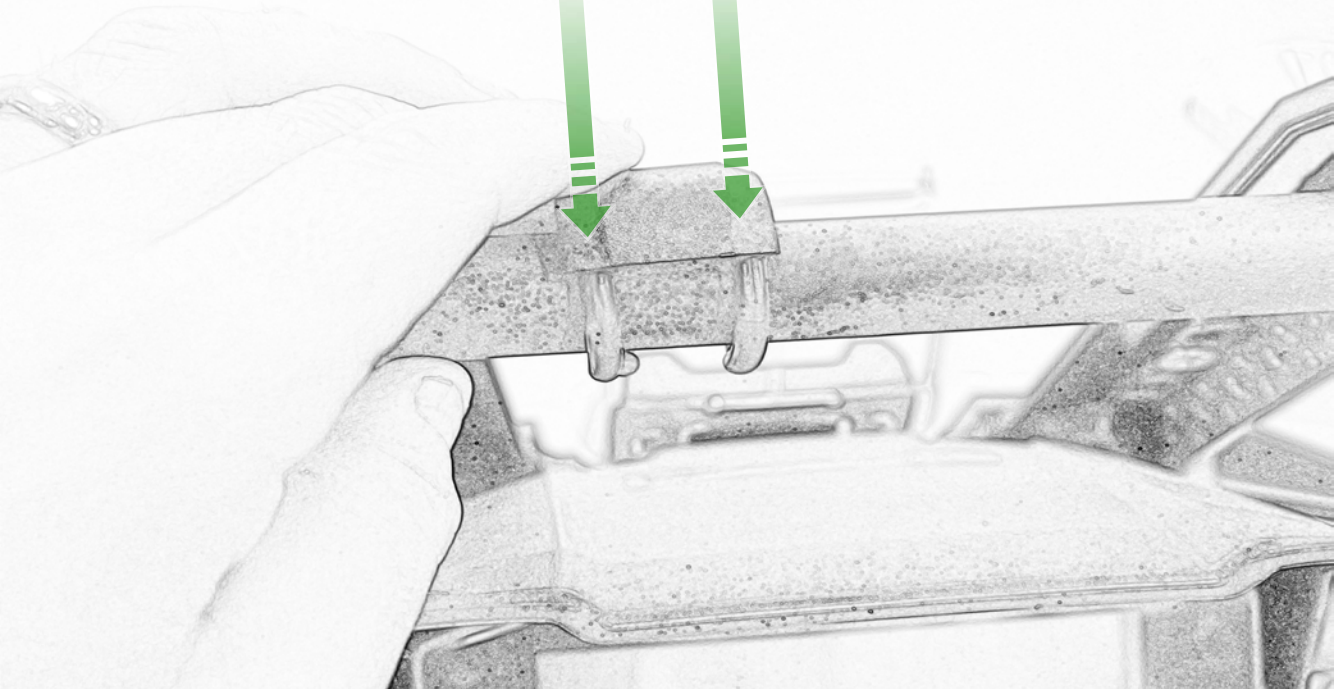



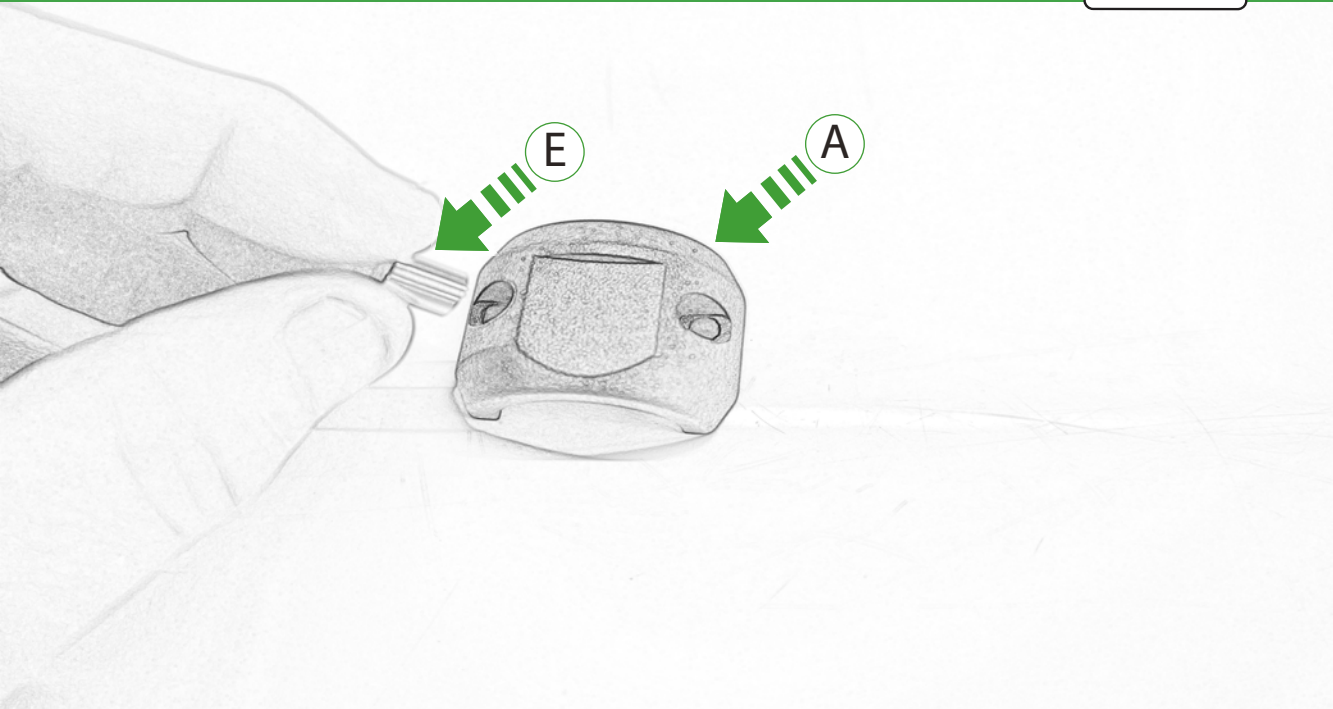

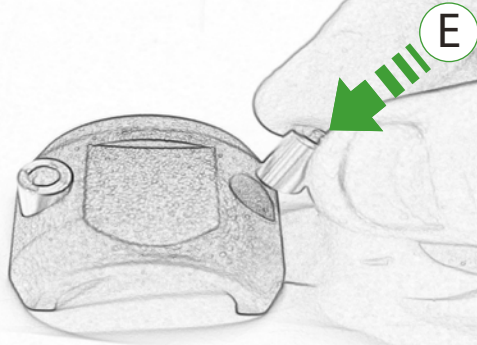

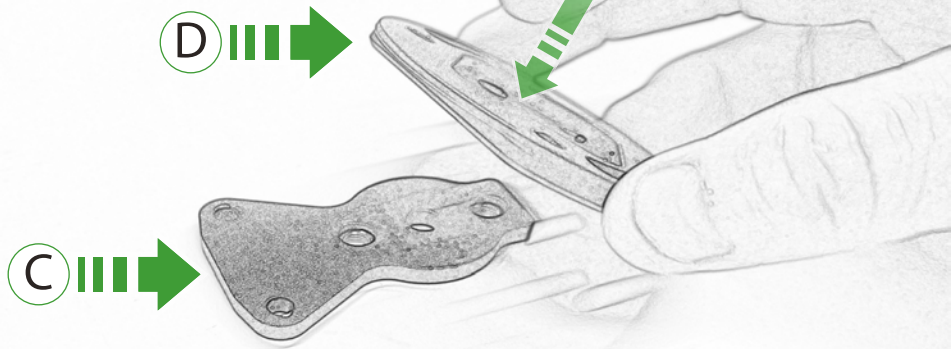



H

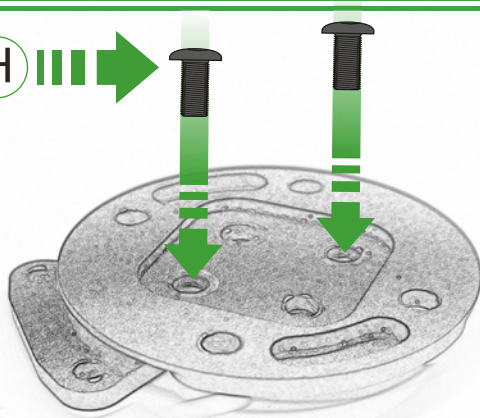

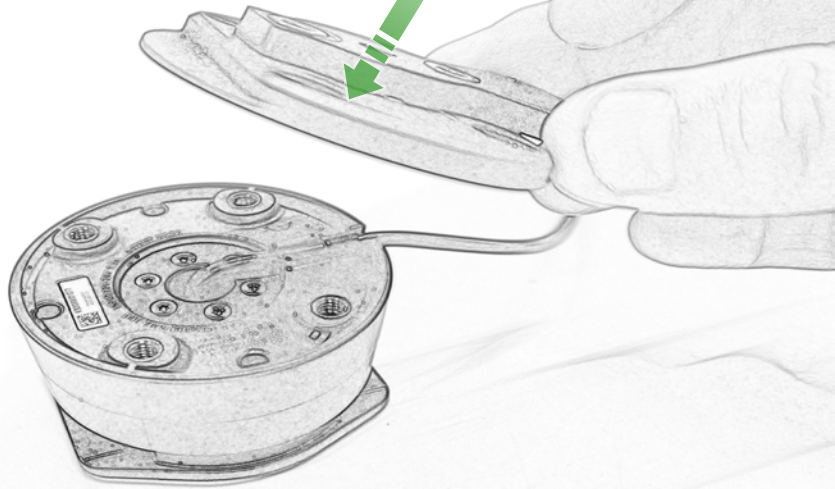

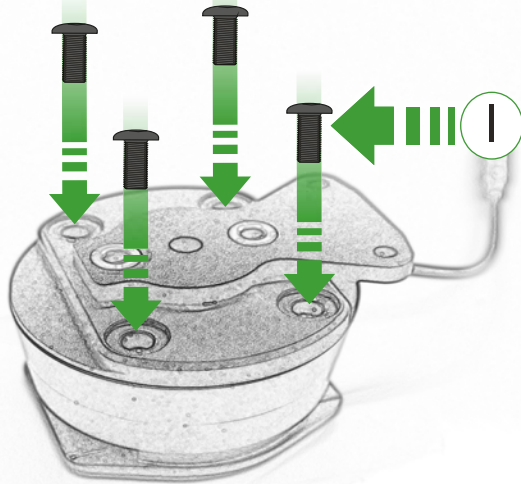

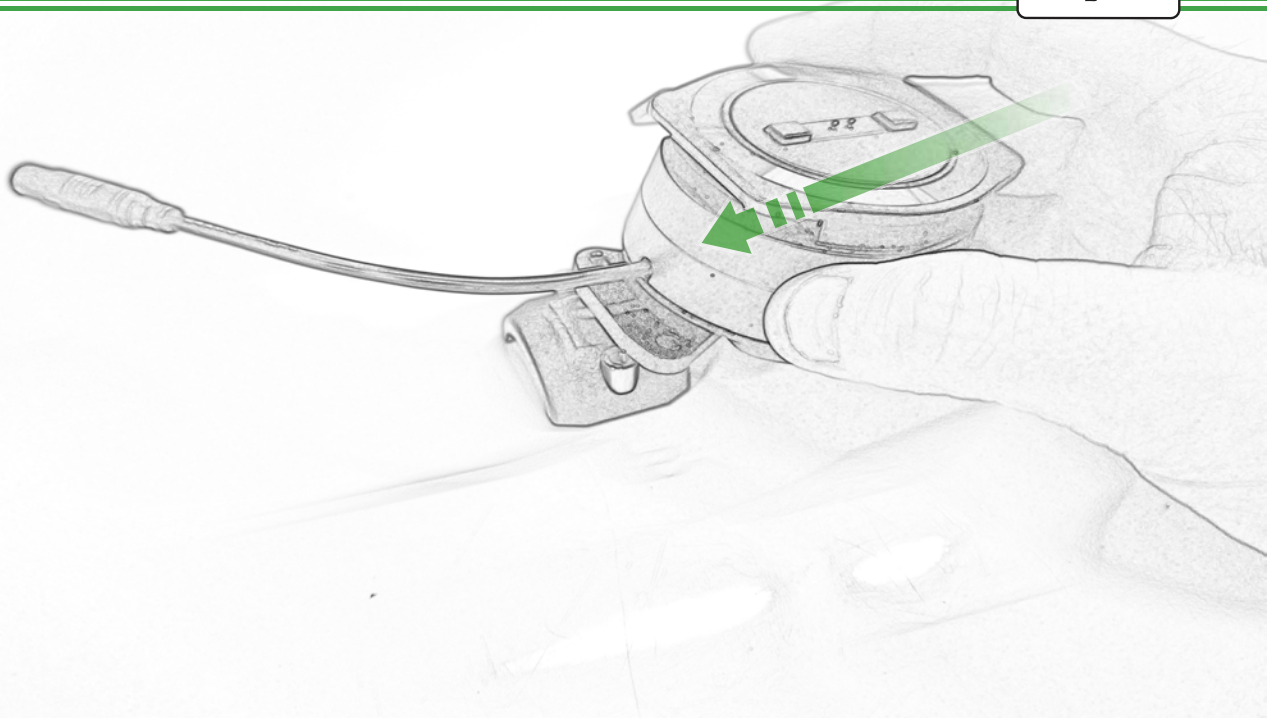

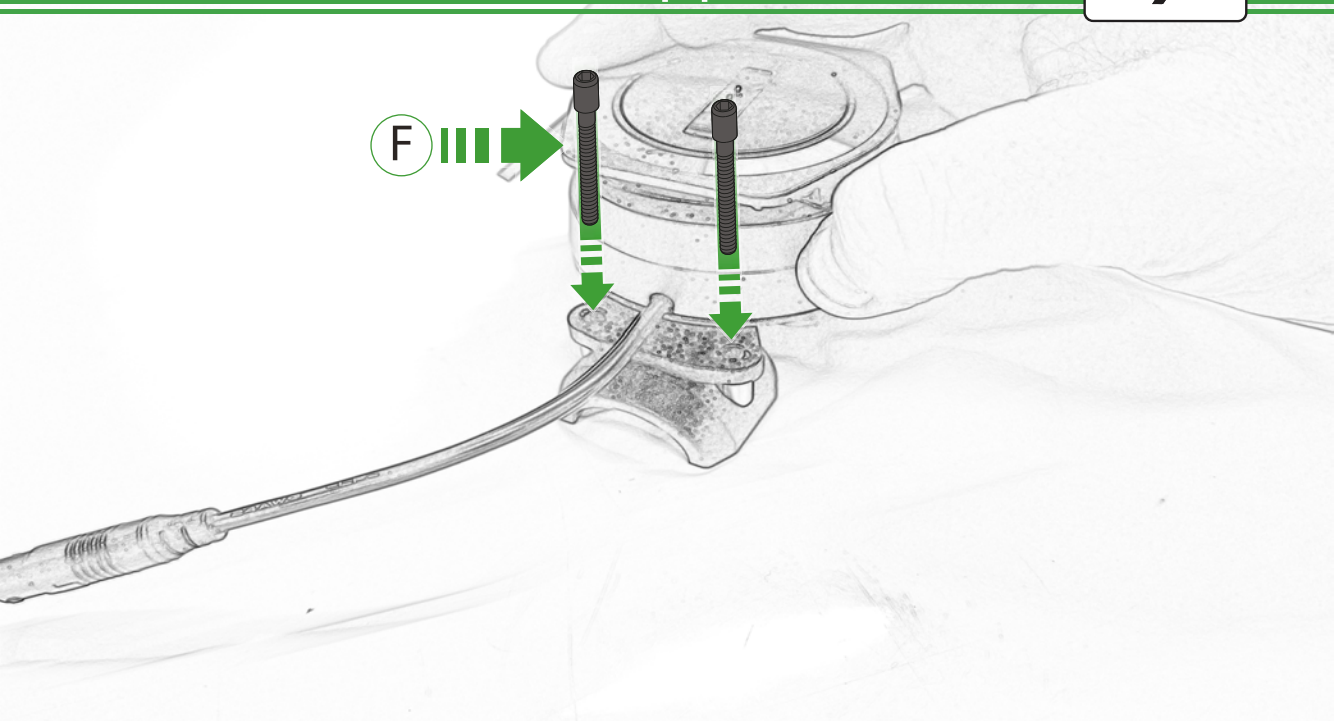

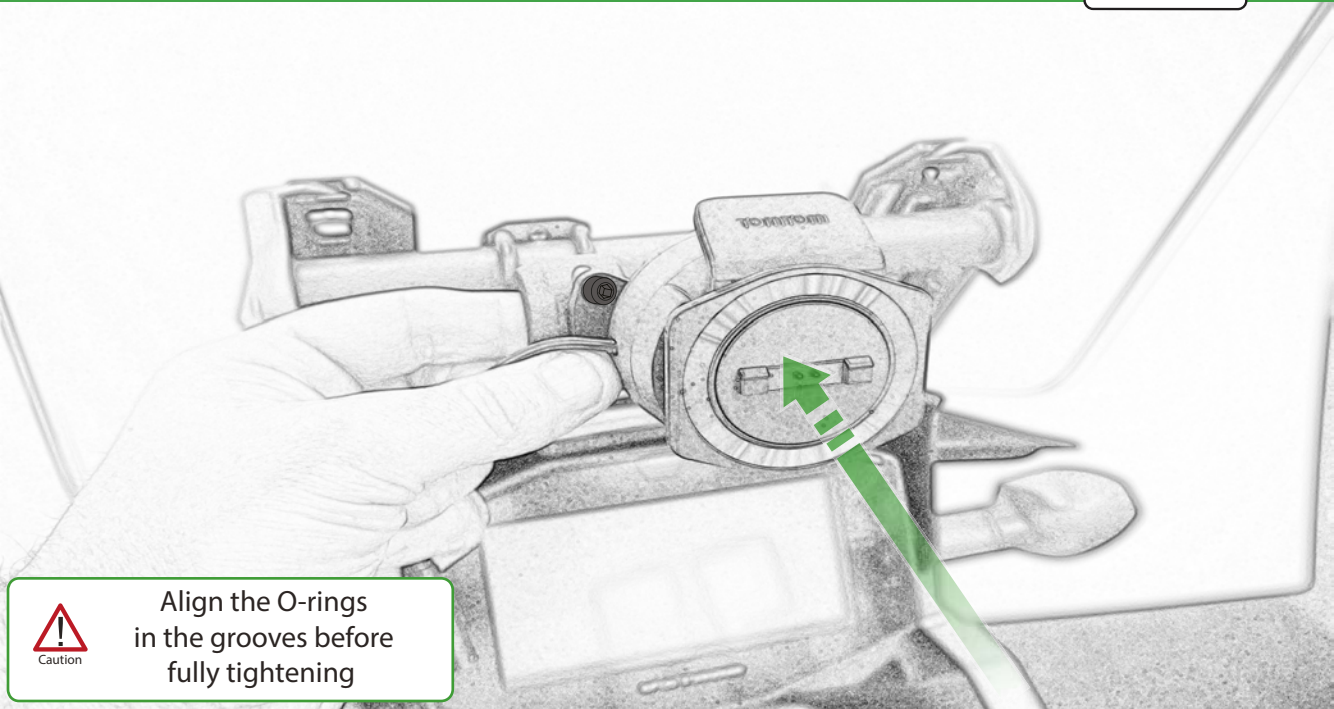

Caution

Align the O-rings
in the grooves before
fully tightening

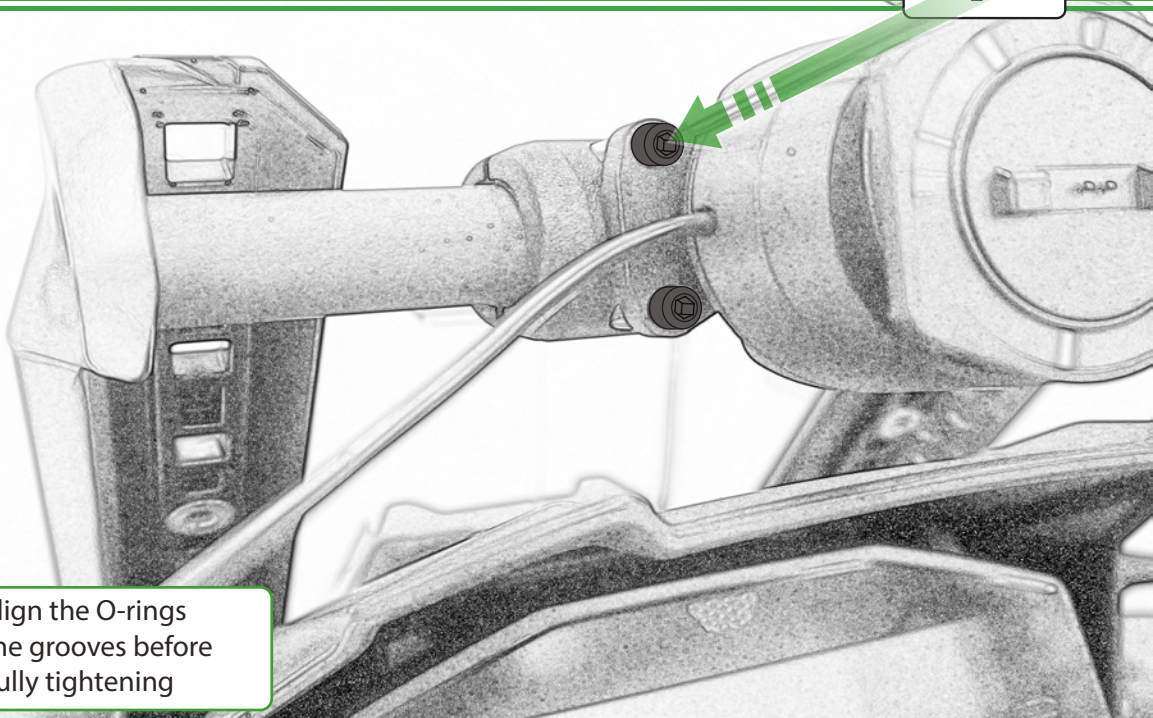

Caution

Align the O-rings
in the grooves before
fully tightening

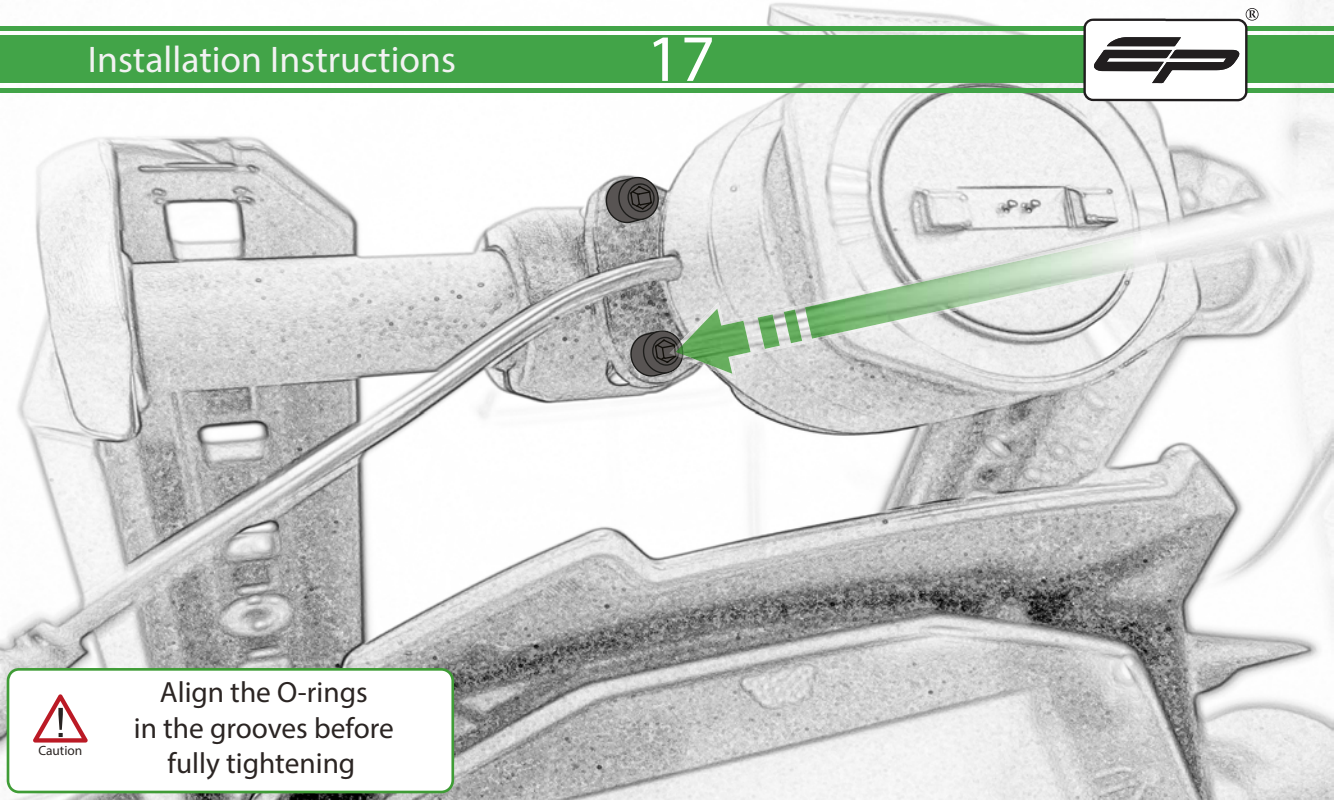

Caution

Align the O-rings
in the grooves before
fully tightening



ESSENTIAL CHECKS

It is recommended that periodic inspections are made to ensure that all bolts are tightened to the specified torque settings.

Should the bike be involved in an accident a thorough inspection should be made and any components that have taken an impact, no matter how small, be replaced



EVOTECH®
P E R F O R M A N C E

www.evotech-performance.com