



EVOTECH®
P E R F O R M A N C E

www.evotech-performance.com

Ducati Clutch Protector Kit

Installation Instructions



Kit Contents PRN014238-014397-014809

- (A) 1 x Bar End
- (B) 1 x Clutch Protector Blade
- (C) 1 x Clutch Protector Bar Outer
- (D) 1 x Clutch Protector Bar Inner
- (E) 1 x O Ring
- (F) 2 x M6 x 25mm Caphead
- (G) 2 x Bar End Inner

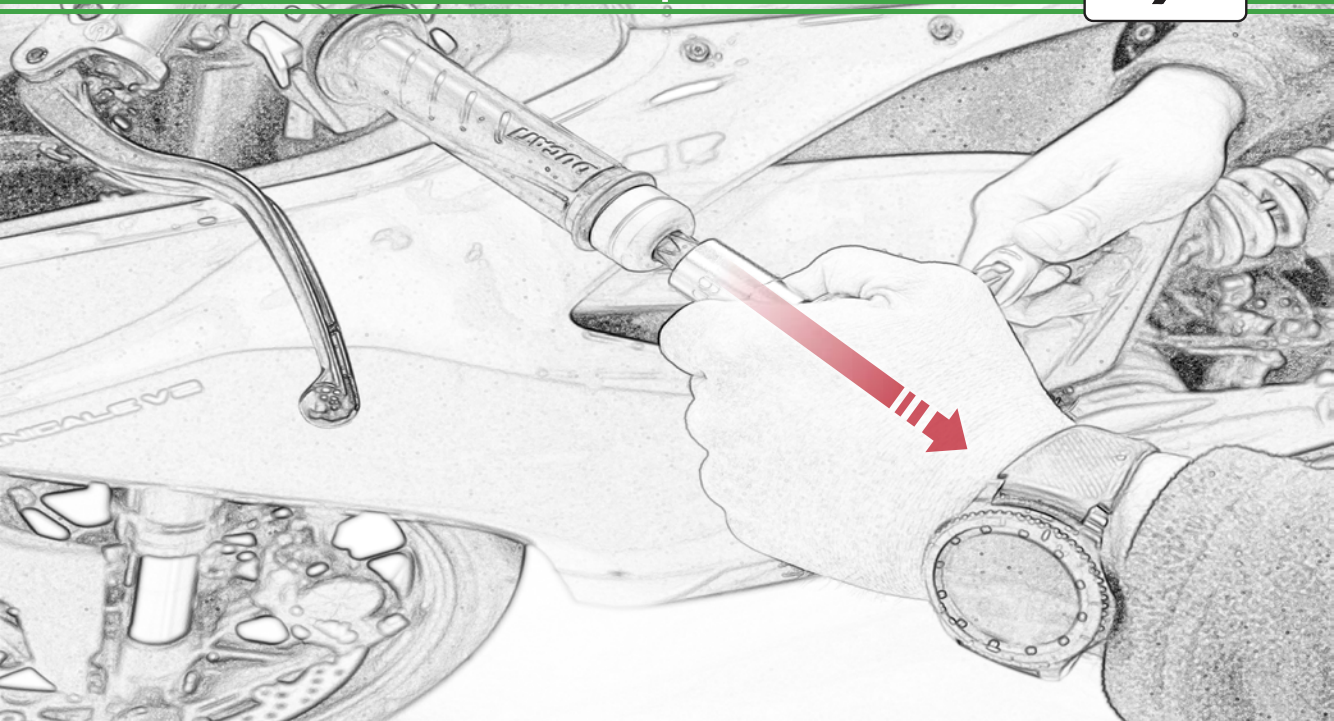

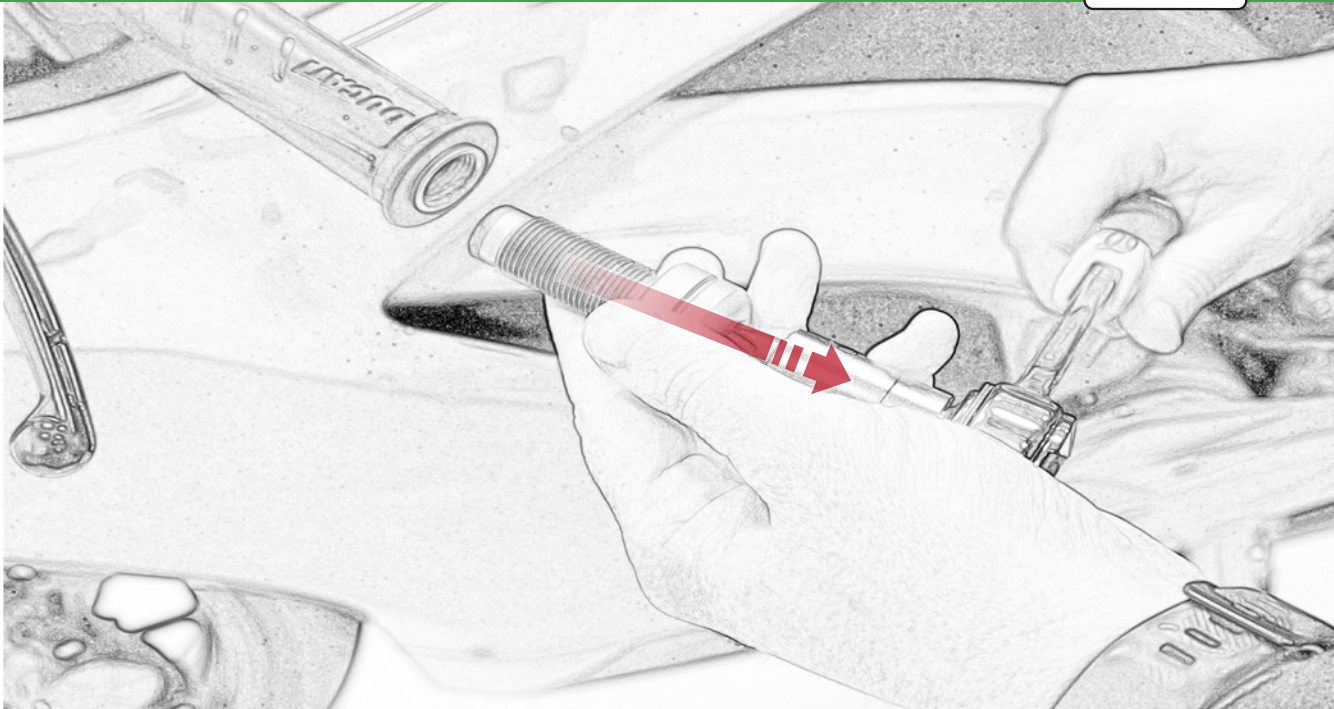

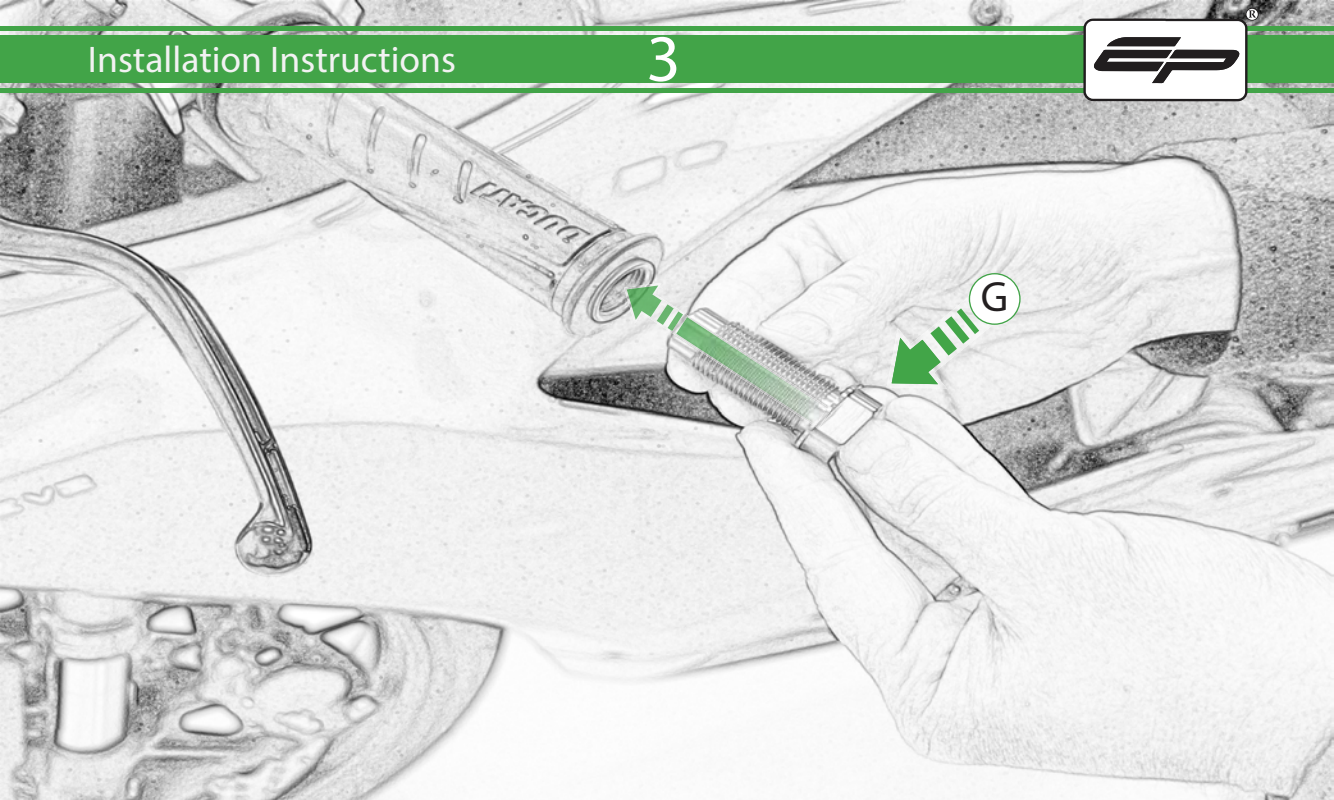



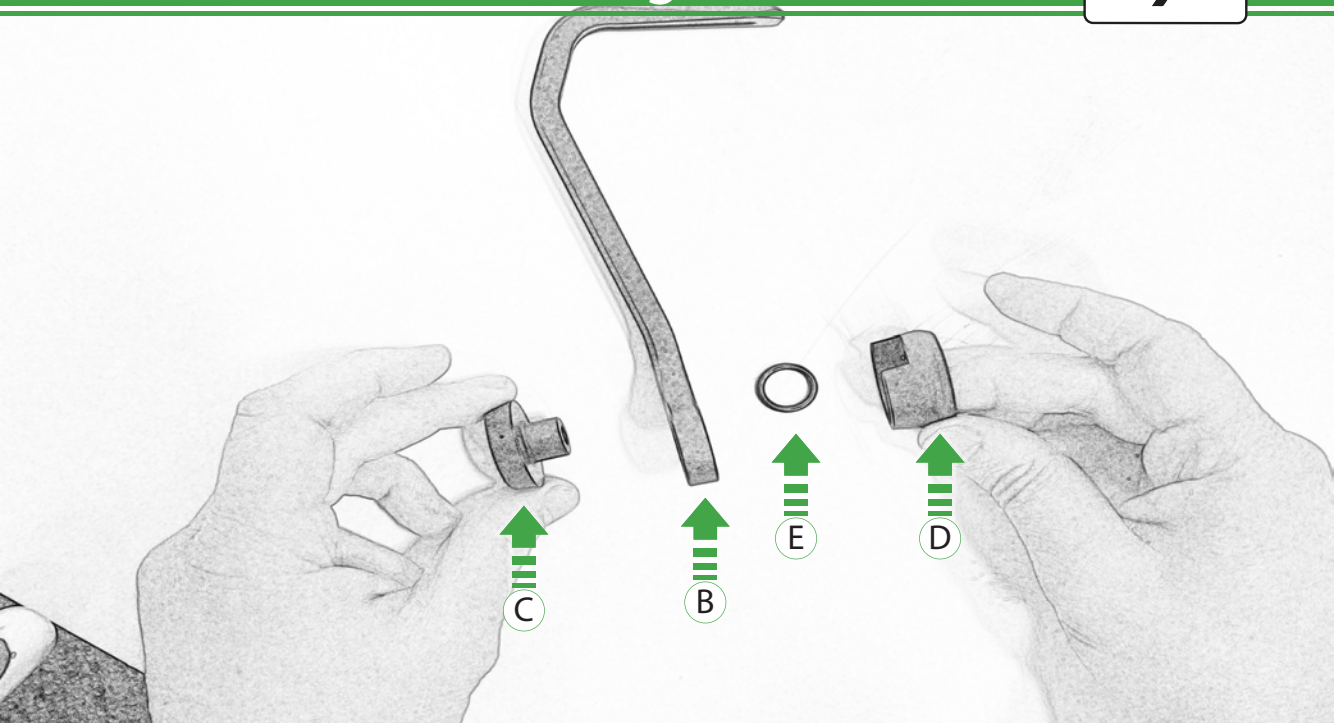

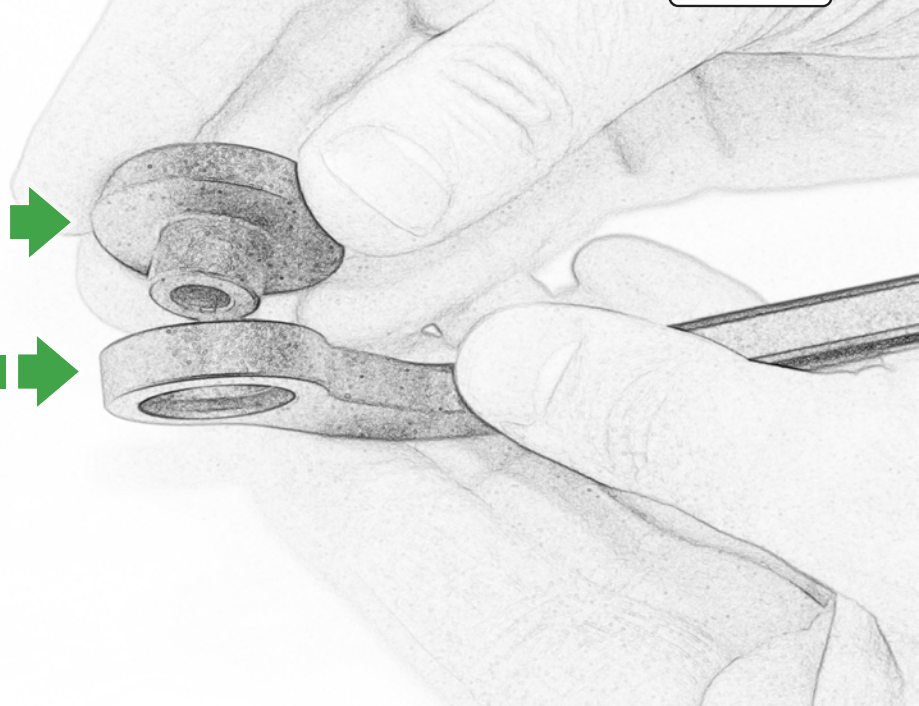



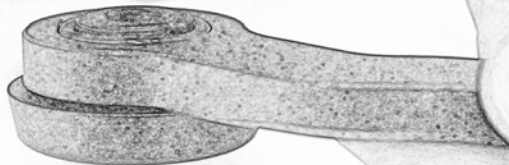
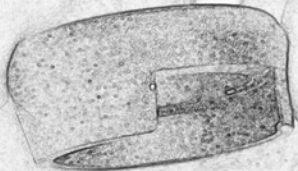

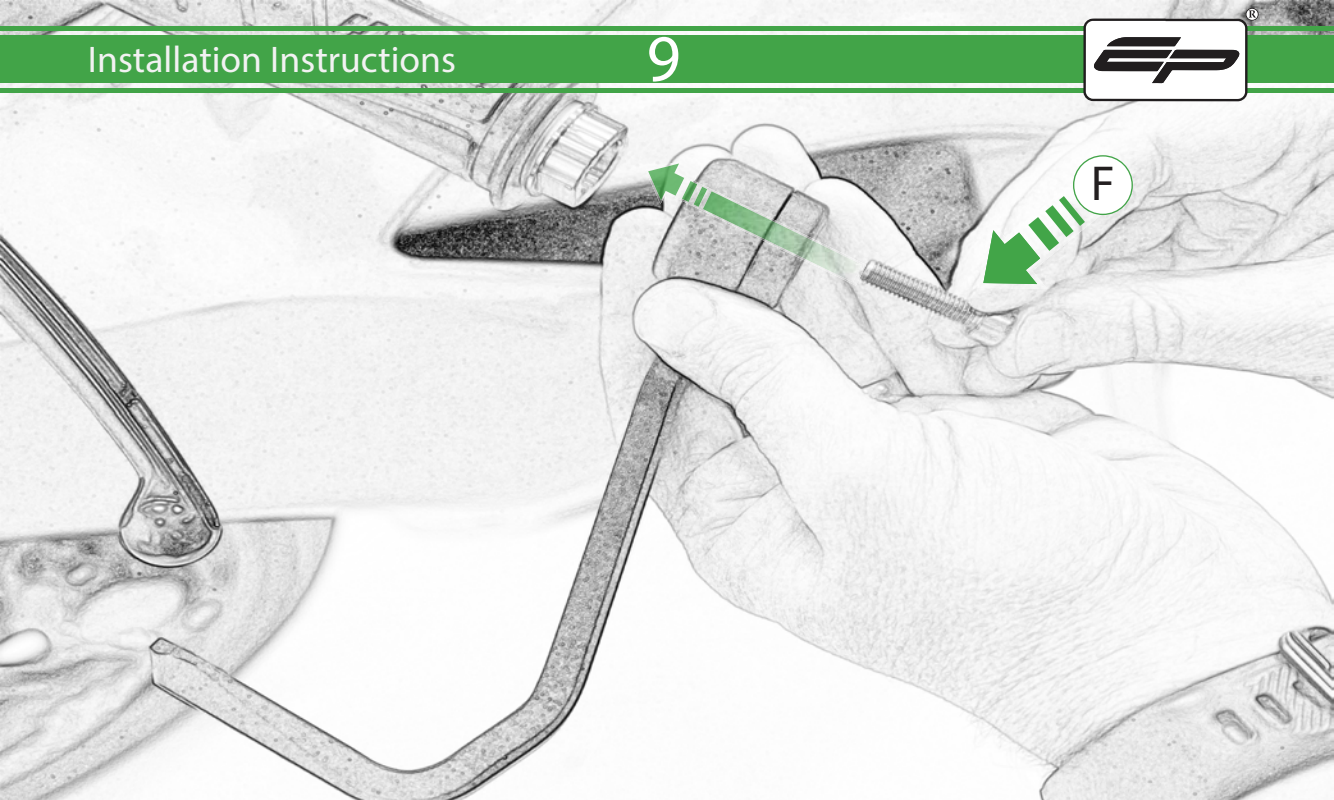

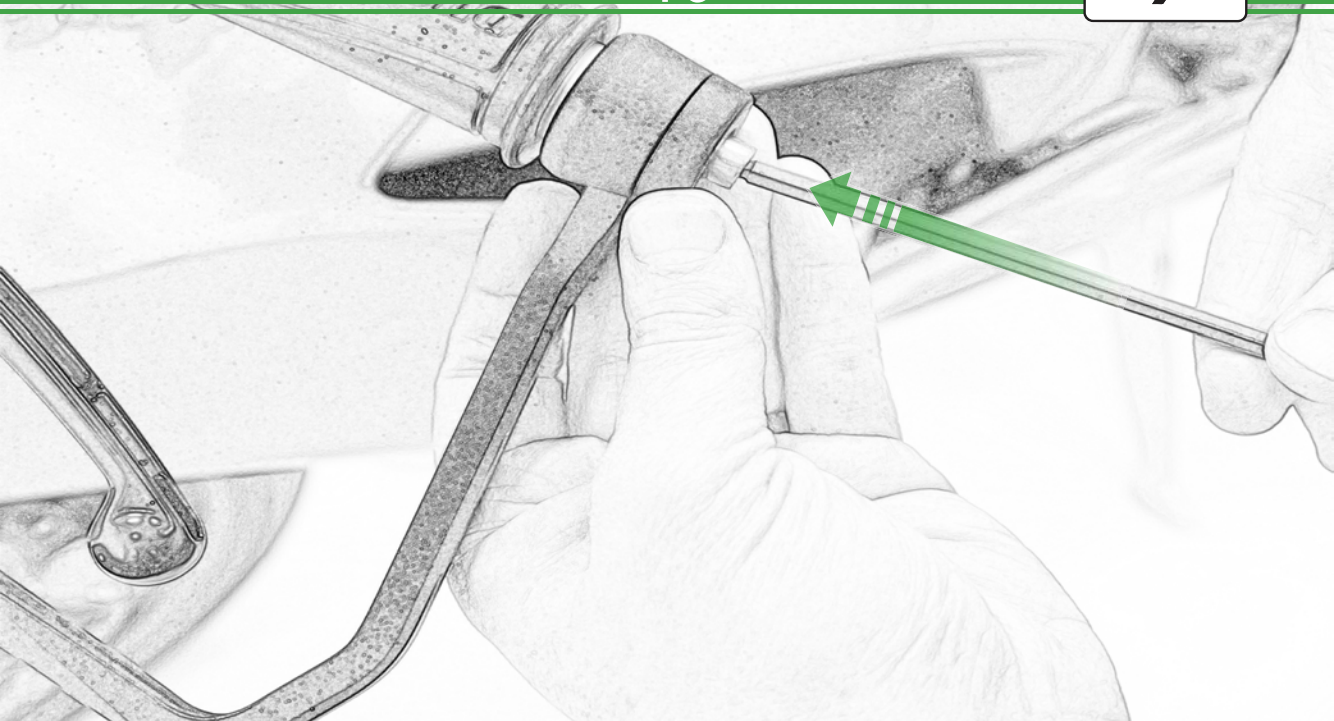

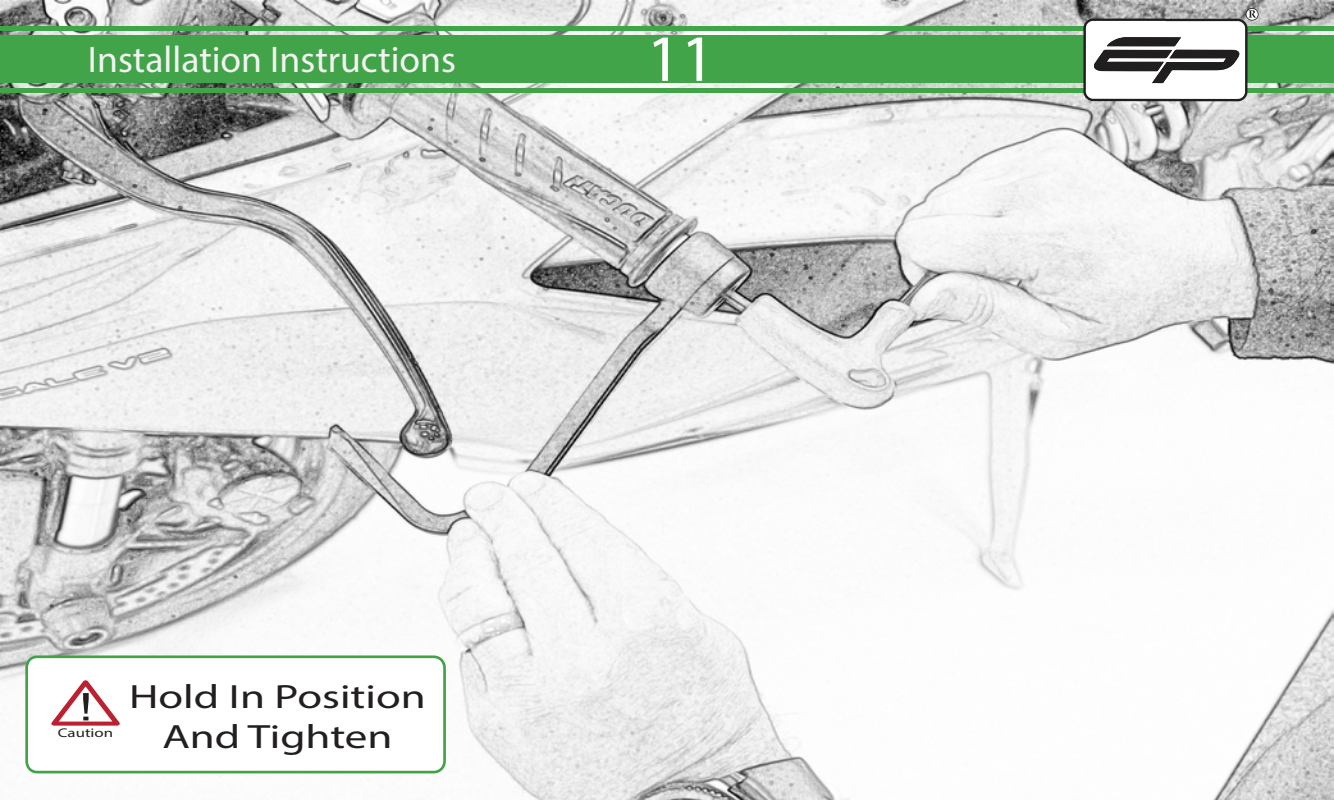

Caution

Hold In Position
And Tighten

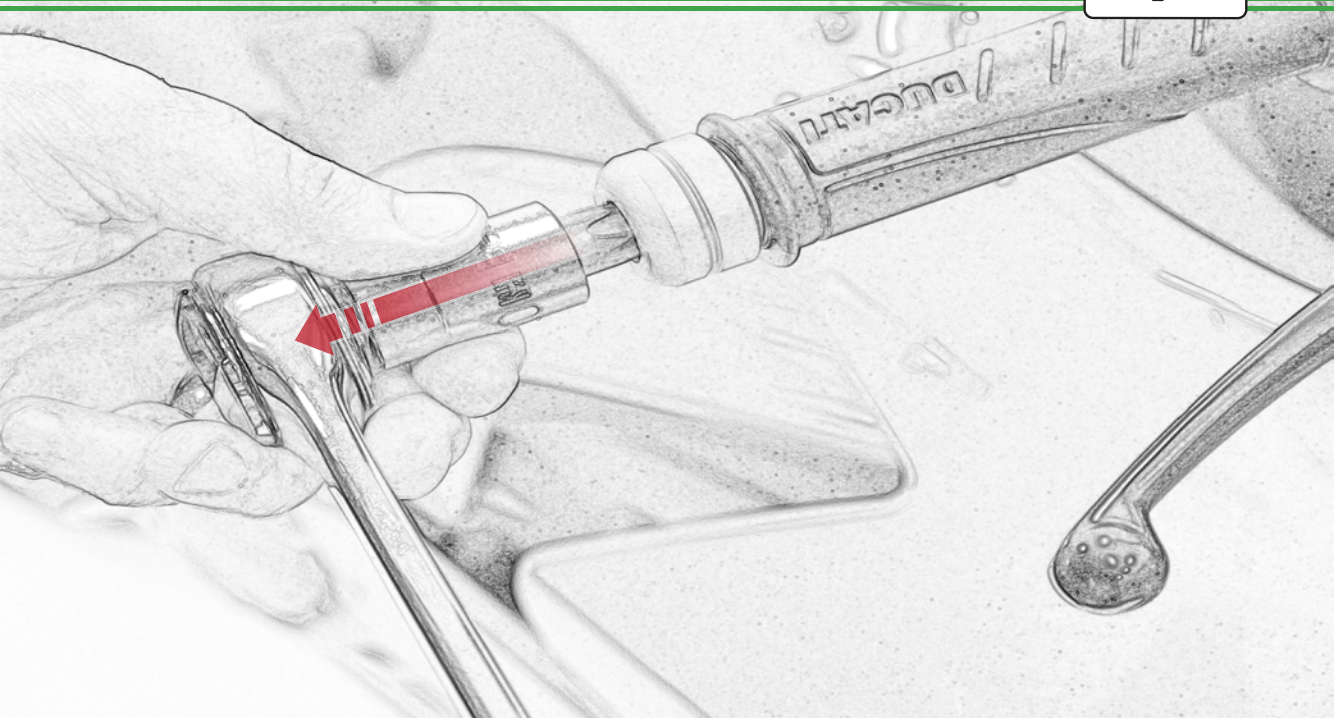

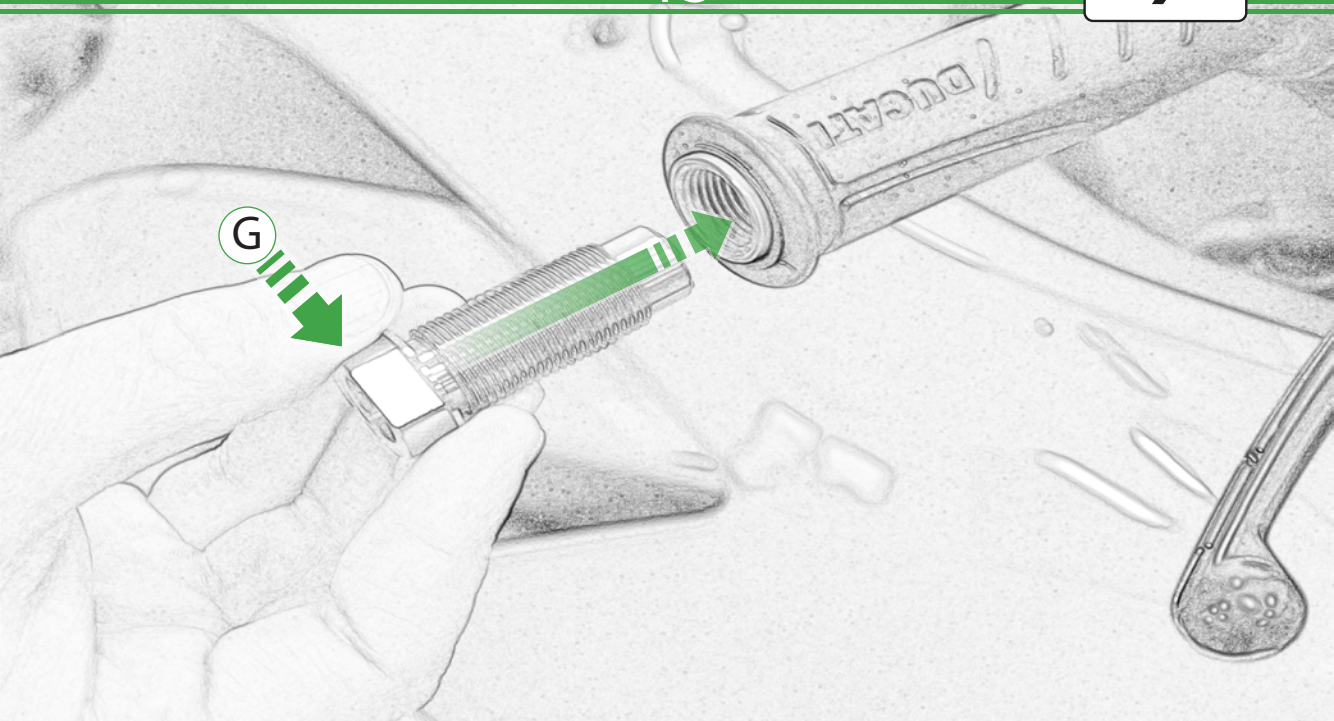

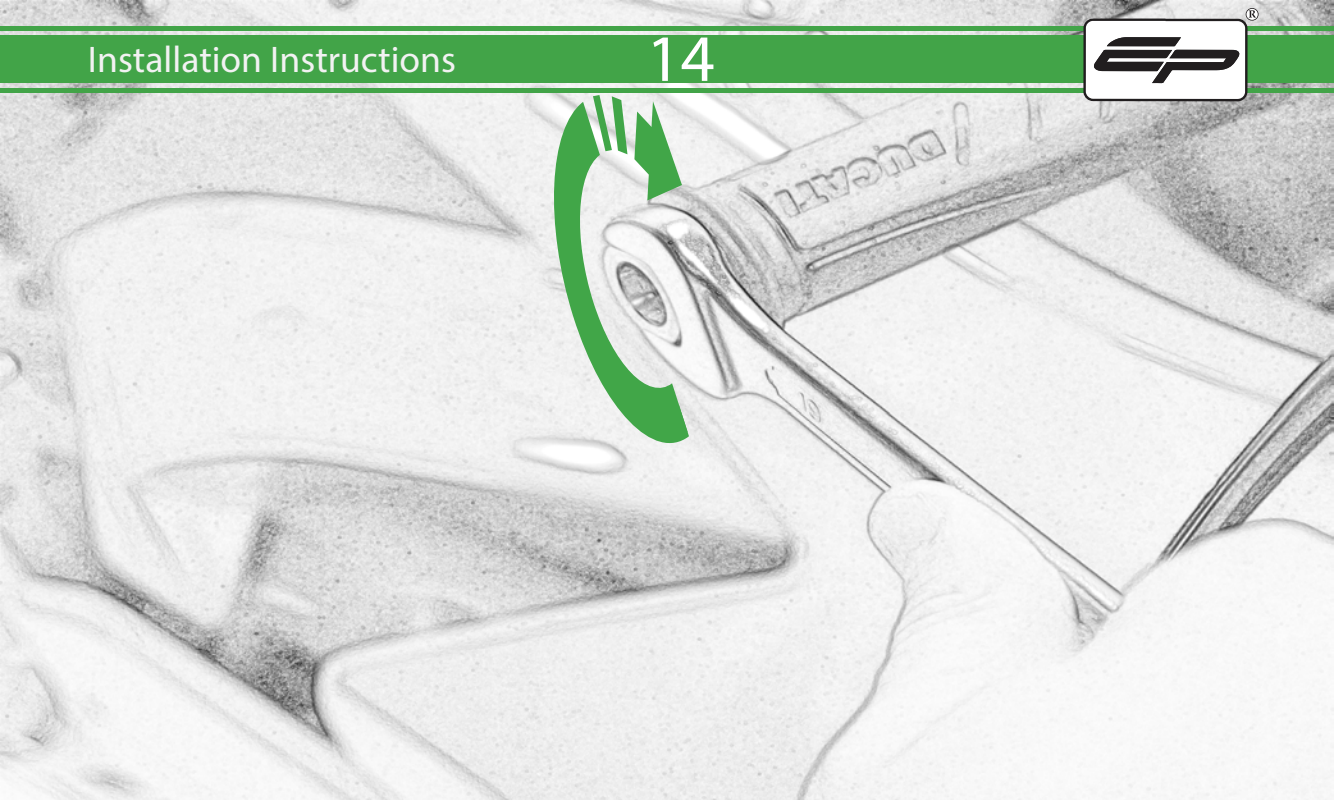

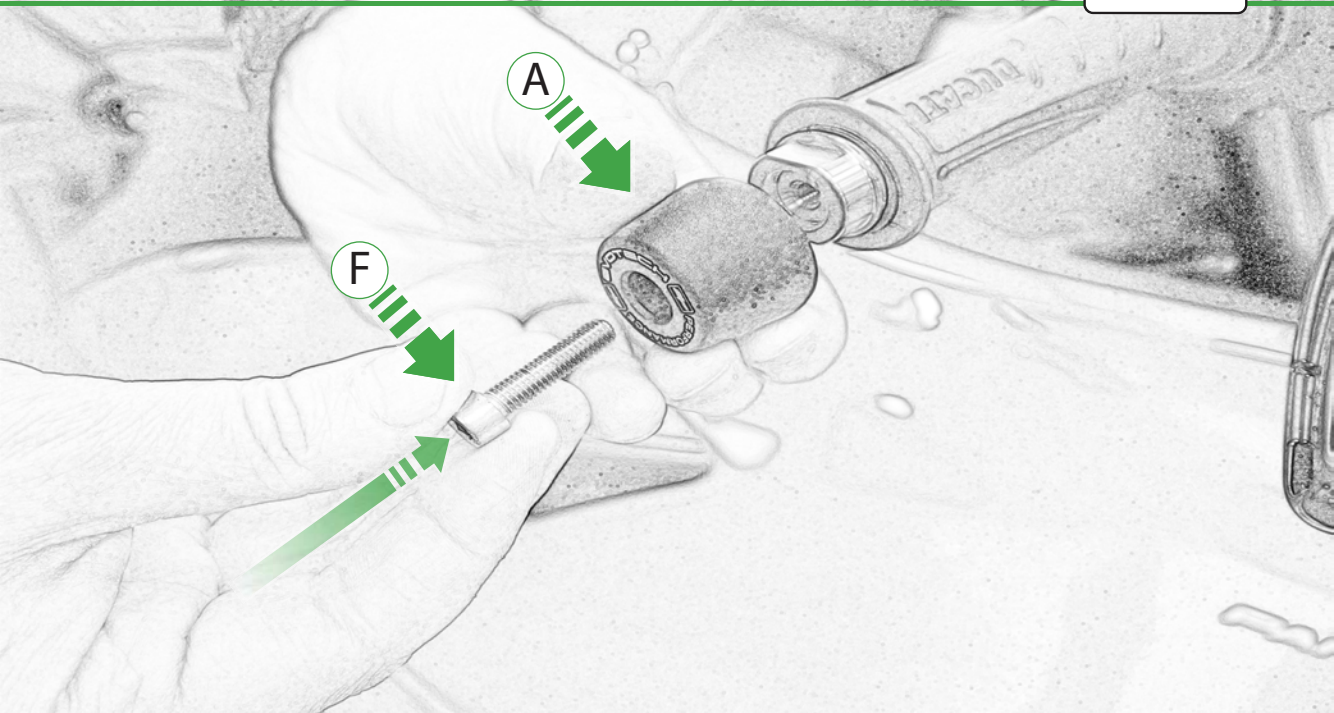

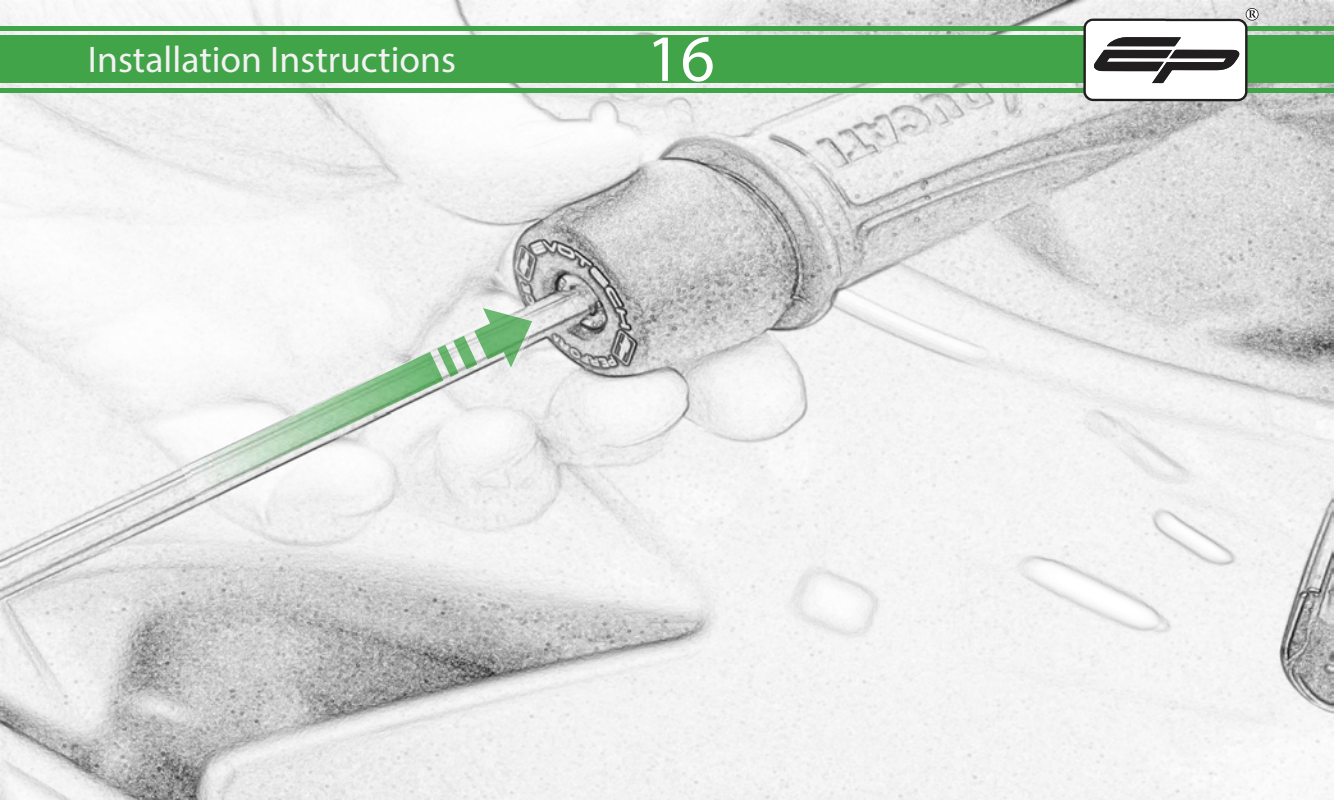

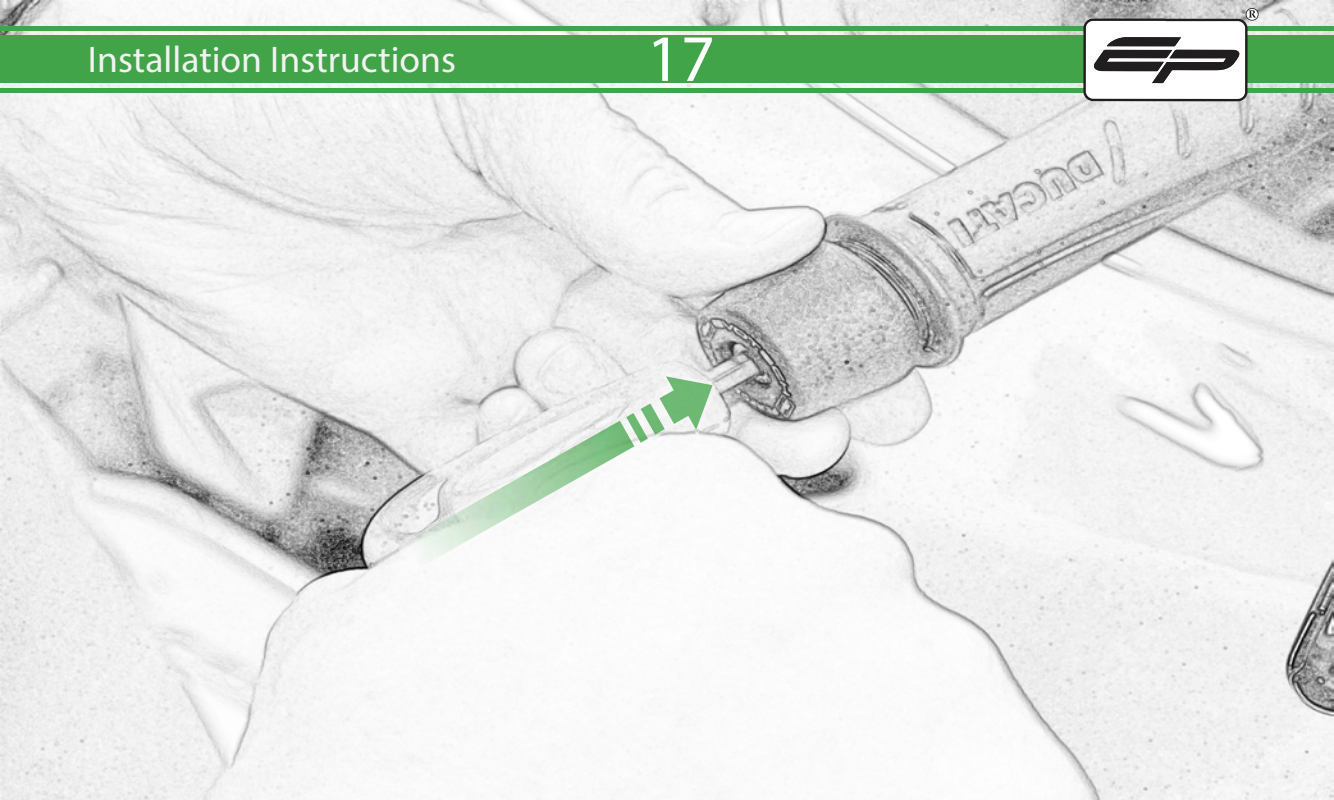

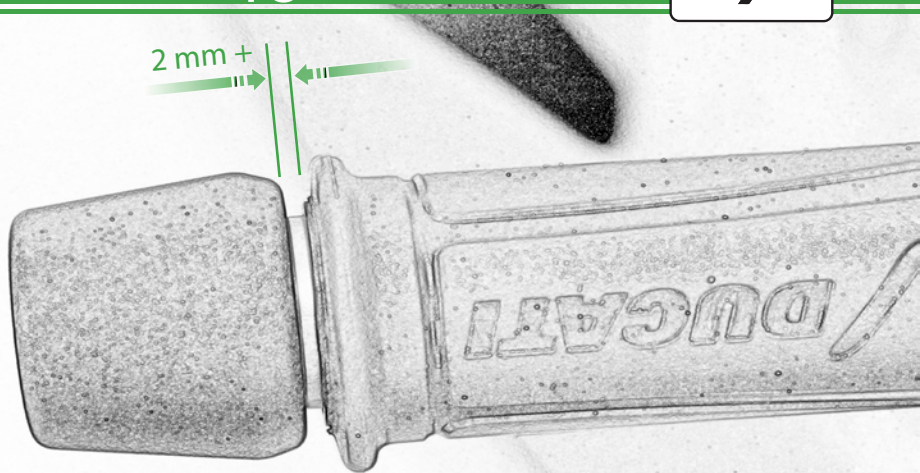

2 mm +



Caution

Check For Free Play
2 mm Minimum Gap



Caution

Check For Throttle
Free Play on Rotation



ESSENTIAL CHECKS

It is recommended that periodic inspections are made to ensure that all bolts are tightened to the specified torque settings.

Should the bike be involved in an accident a thorough inspection should be made and any components that have taken an impact, no matter how small, be replaced



EVOTECH®
P E R F O R M A N C E

www.evotech-performance.com