

## YAMAHA MT09 TRACER TAIL TIDY

Product Reference - 13163

### Kit Contents

- |                                    |                                      |
|------------------------------------|--------------------------------------|
| <b>A</b> 1 x Main Tail Tidy        | <b>H</b> 2 x M6 - 25 Screws          |
| <b>B</b> 1 x Licence Plate Bracket | <b>I</b> 2 x M3 - 12 Screws          |
| <b>C</b> 1 x LED Light Unit        | <b>J</b> 2 x Bullet Connectors       |
| <b>D</b> 1 x Wiring Connector      | <b>K</b> 2 x Plastic Screws and Nuts |
| <b>E</b> 1 x Reflector and Bracket | <b>L</b> 4 x M4 - 10 Screws          |
| <b>F</b> 2 x Mounting Spacers      | <b>M</b> 4 x M6 Washers              |
| <b>G</b> 2 x M6 - 35 Screws        | <b>N</b> 5 x Cable Ties              |

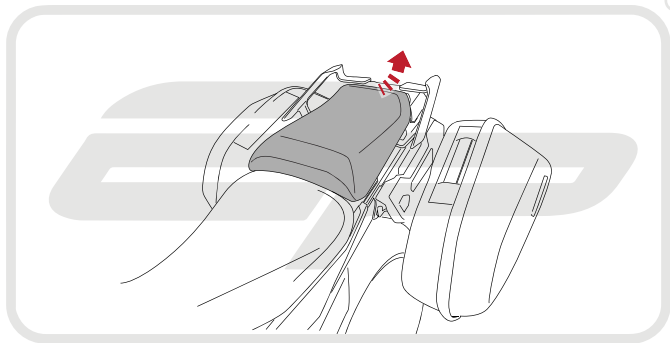

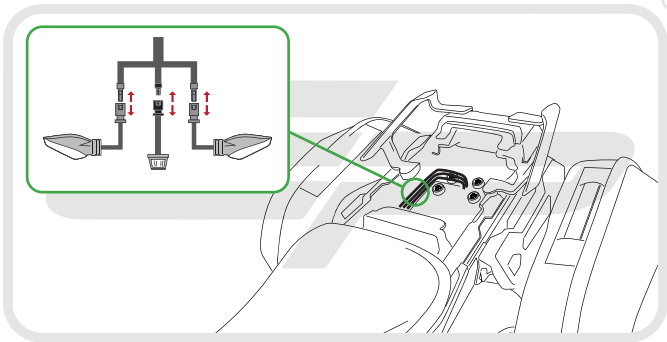

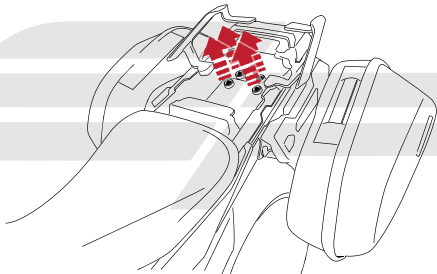

**EVOTECH**<sup>®</sup>  
P E R F O R M A N C E

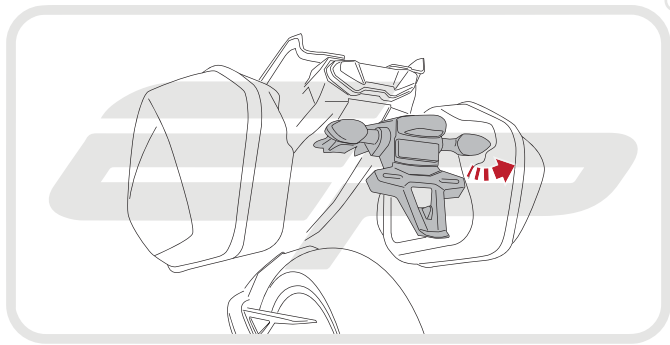

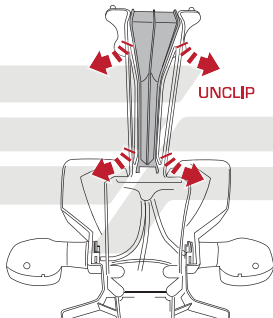

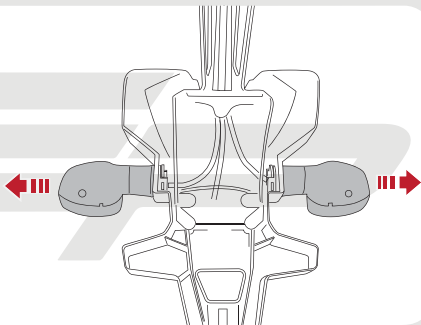
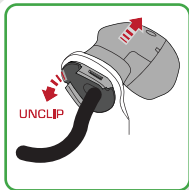

Fit indicators to new tail tidy in reverse order of removal in stage 6

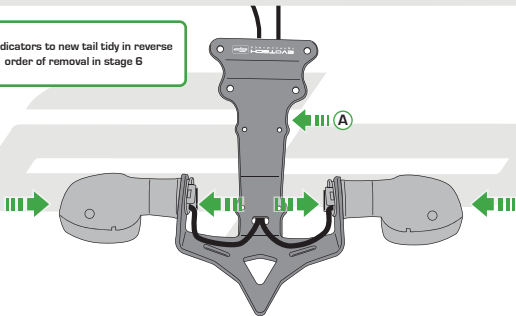





Feed cable tie through tail tidy  
so the head sits inside the  
slot on the outer face

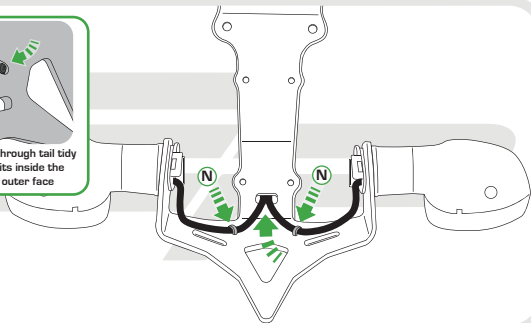

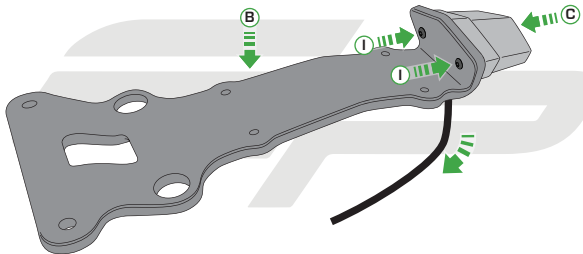

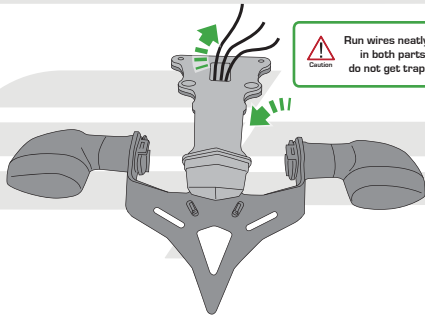

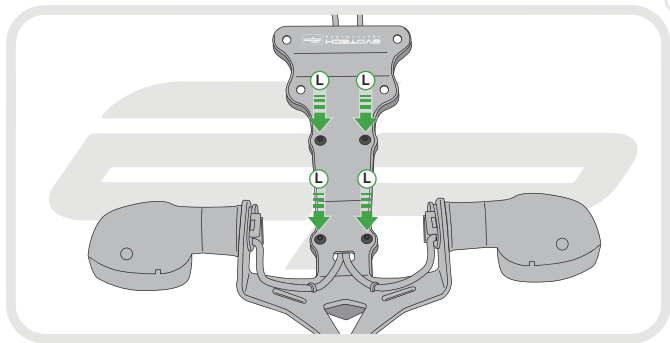

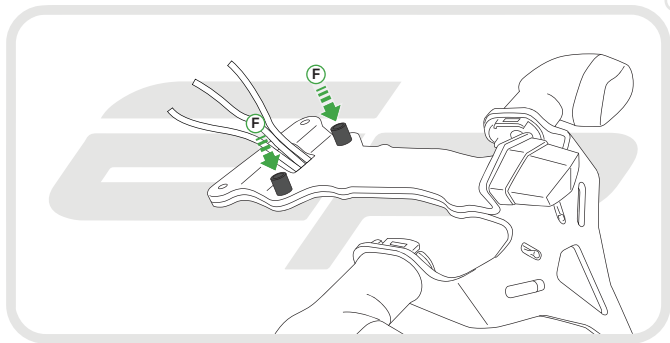

**EVOTECH**<sup>®</sup>  
P E R F O R M A N C E

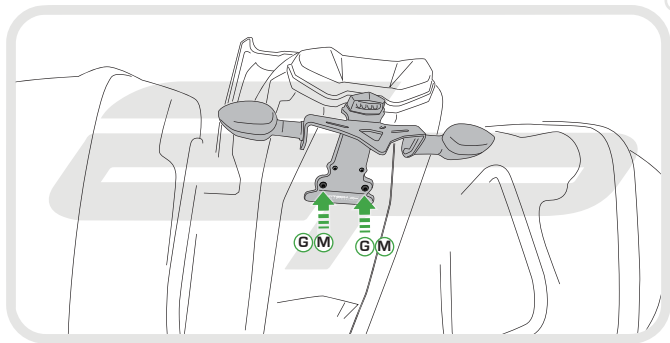

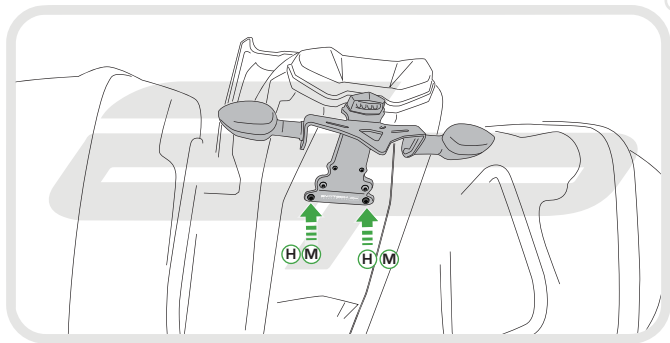

**EVOTECH**<sup>®</sup>  
P E R F O R M A N C E

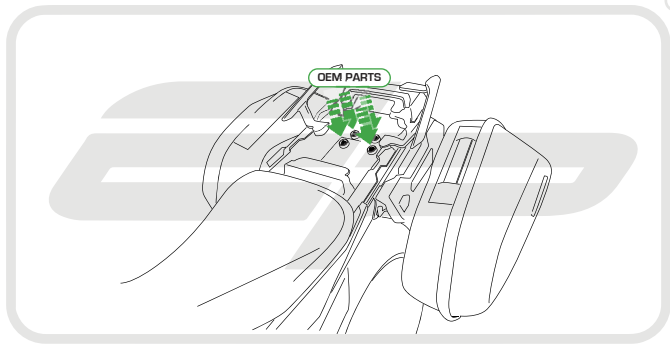



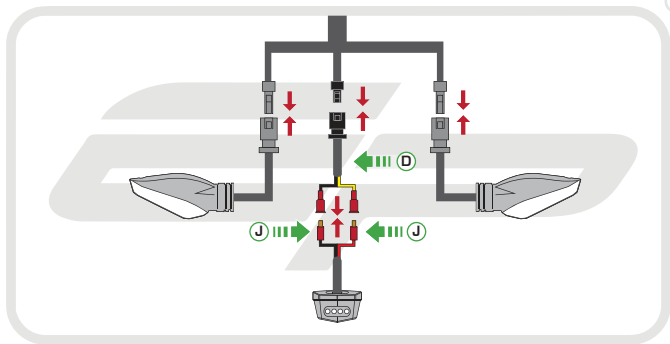



Reverse Stage 1

## Reflector Bracket Installation

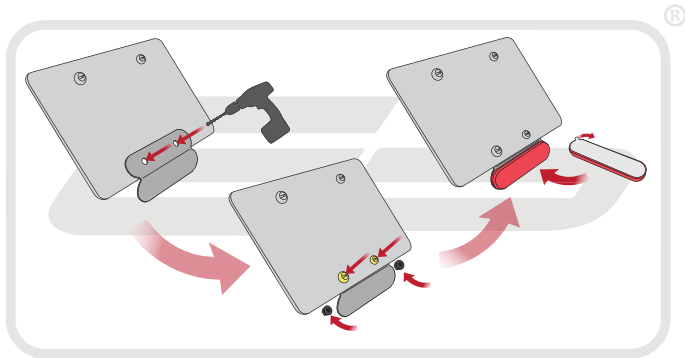

**EVOTECH**<sup>®</sup>  
P E R F O R M A N C E



## ESSENTIAL CHECKS



After installation of your tail tidy ensure that the licence plate does not contact the rear tyre when suspension is fully compressed.

Ensure all electrics including indicators, tail light, brake light and licence plate light lights are working correctly before riding the motorcycle.

It is recommended that periodic inspections are made to ensure that all fixings are fully tightend.