



STEEDA

Steeda 2021 Bronco

Panhard/Track bar

555-2553

Tool required:

15/16" Socket and wrench

1/2 Drive ratchet

Large flat blade screwdriver

Optional floor jack

Note: We strongly recommend that a factory shop manual be available for reference during the installation. If you are not confident you can complete the job safely, have the work performed by a certified technician.

Removal of factory bar:

1. Lift the Bronco, by the frame, on a vehicle lift or on jack stands to work on the rear suspension. Use caution operating a lift or jack stands to ensure the car is stable and safe to work around and underneath.
2. The body will need to be raised to allow removal of the driver side Panhard/Track bar bolt. The driver side bolt has a flag retainer that aligns with a hole in the bracket. Passenger side nut sits in a captured bracket on the front side of the mount. Figure 1 & 2.

NOTE: When removing the driver and passenger side bolt, it goes in same orientation of the mounting bracket. Do not reverse the bolts.

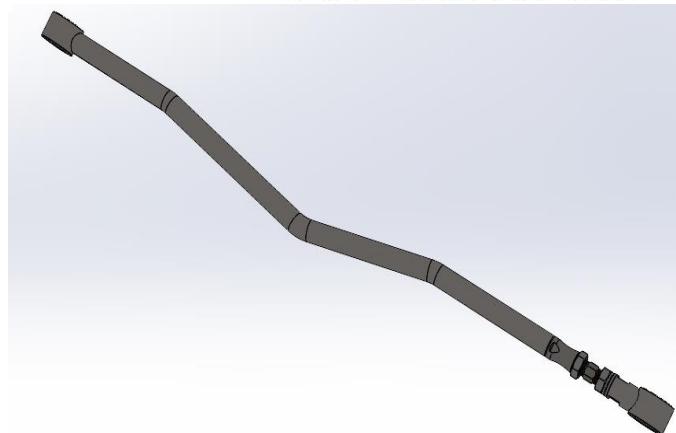



Installation of Steeda bar:

3. Once the factory bar has been removed, place it and the Steeda bar together, using the factory bolts, adjust the Steeda bar (using the center adjuster so the threads are even on each side) to the same length as the factory bar (the bolts should be able to pass through both holes). Do not tighten the locking nuts at this point. See Figure 3.
4. Install the Steeda bar as shown in figure 4, it may be necessary to use a large screwdriver to align the bolt holes through the bar and mount and or raise the axle.
5. Torque the bolts to 160 ft-lb. for both sides. See Figure 5 & 6.
6. Tighten the jam nuts after final adjustments have been made. Any changes to the factory ride height will require the bar to be adjusted to center the rear axle under the vehicle. If serious off roading is planned use blue Loctite on the jam nuts.
7. Inspect bolts and jam nuts after first 100 miles of driving, periodically after that.

