



**STRENGTH TRAINING SERIES LEG PRESS**  
**NO. 54035 WHITE 55035 SILVER**

**Check Item Qty Description**

1	1	Left Base Frame
2	1	Right Base Frame
3	1	Back Base Frame
4	1	Front Base Frame
5	2	Brace Frame
6	1	Right Guide Frame
7	1	Left Guide Frame
8	2	Inner Barbell Rack
9	2	Outer Barbell Rack
10	1	Left Safety Arm
11	1	Right Safety Arm
12	1	Top Connector
13	1	Base Connector
14	2	Guide Rods
15	1	Slide Frame
16	1	Left Barbell Rack
17	1	Right Barbell Rack
18	2	Support board
19	1	Fastness Frame
20	1	Back Pad Axis Of Rotation
21	1	Support Axis Of Rotation
22	1	Back Pad Support Frame
23	1	Foot Frame
24	1	Left Bound Frame
25	1	Right Bound Frame
26	2	Safety Axis
27	2	Plastic Board1
28	2	Cushion
29	2	Plastic Board2
30	2	Plastic Board3
31	1	Seat Pad
32	1	Back Pad
33	1	Head Pad
34	8	1/2" Large Flat washer
35	4	1/2"x3/4" Bolt
36	8	1/2"x1-1/2" Bolt
37	6	1/2"x1-1/2" Bolt
38	4	1-1/2"IDx4-1/2" Plastic Tube
39	4	1-1/2"IDx8-1/2" Plastic Tube
40	4	1"IDx5"Hand Ghp
41	4	1"IDx6"Hand Ghp
42	4	1"ID Metalurgy Bushing
43	4	Foot Pad
44	12	1/2"x3-3/4" Bolt
45	78	1/2"Flat washer
46	28	1/2"Nylon Locknut
47	12	1/2"x4-1/2" Bolt
48	2	Idler Wheel

**Check Item Qty Description**

49	2	Spring Pin
50	12	1/4 x1/2"Subsidence Bolt
51	3	5/16"x4-1/4" Bolt
52	2	5/16" x2-1/4" Bolt
53	2	5/16"x1-1/2" Bolt
54	7	5/16"Flat washer
55	4	5/16"Lock washer
56	4	Plastic Bushing
57	2	Collar
58	2	Screw
59	12	Rubber Doughnut
60	4	Needle Roller Bearing
61	4	1/4"x3/4" Allen Bolt
62	16	1/2" X1-1/4" Allen Bolt
63	4	1/4" X1-1/4" Allen Bolt
64	2	Large York Decal
65	1	Warning Label
66	1	Warranty Packet
67	1	Serial # Sticker
68	1	Hardware Card
69	1	Assembly Instruction
70	2	Bear- Shaft Bolt
71	6	Large Washer

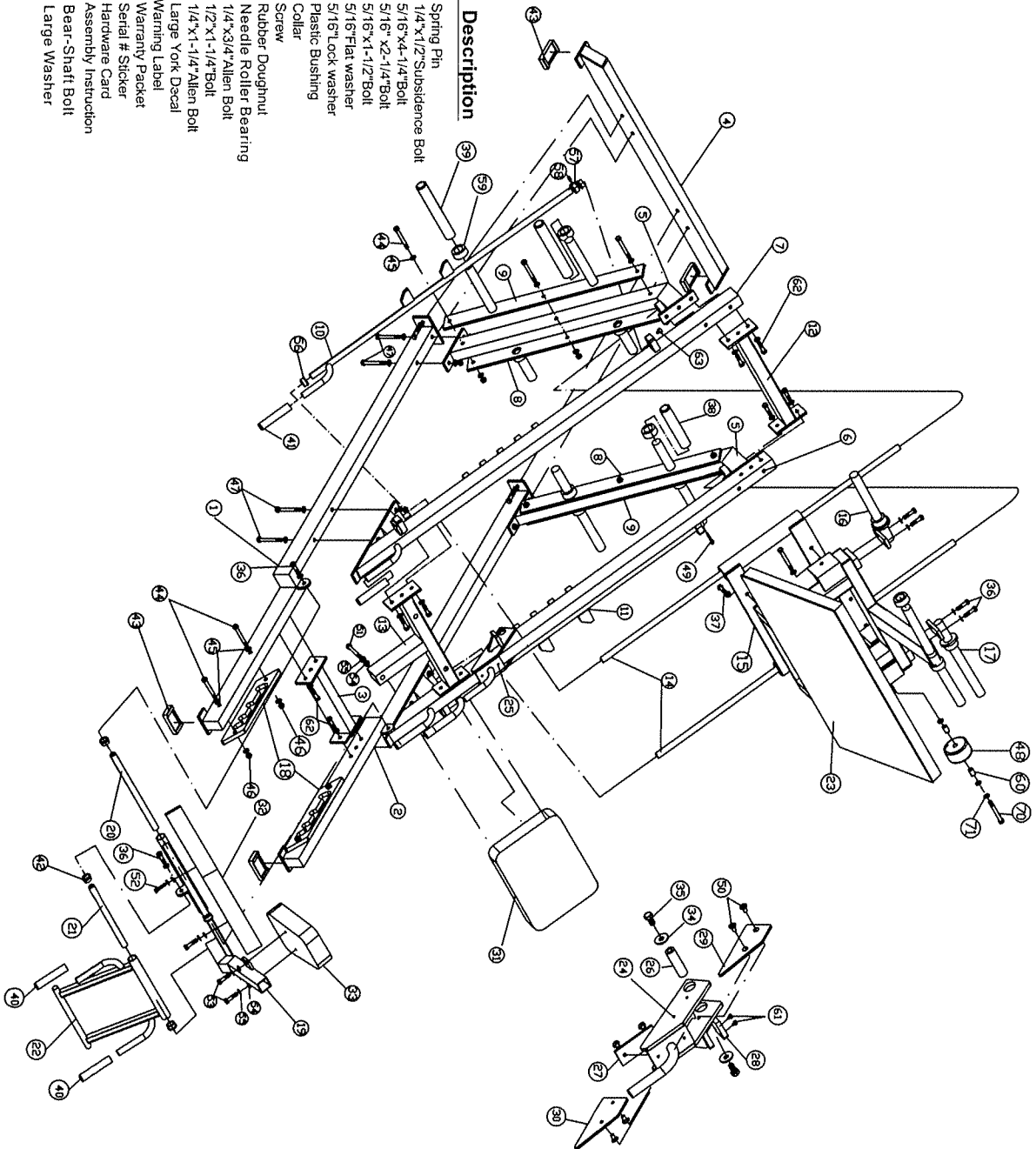

**\*\*IF PARTS ARE MISSING, DO NOT CALL THE STORE WHERE YOU PURCHASED THIS ITEM - THEY DO NOT STOCK PARTS. PLEASE CONTACT YORK BARBELL CUSTOMER SERVICE AT (800)358-9675 OR (717)767-6481**

REV. 03/09/2009