



BASIC TRAINING SERIES POWER FRONT SQUAT

No. 54036 WHITE

55036 SILVER

PAGE 1 OF 2

CHECK	ITEM	QTY	DESCRIPTION	CHECK	ITEM	QTY	DESCRIPTION
_____	1	1	Left Rotational Frame	_____	35	1	2-3/8" x 1-3/4" x 3/16" Rubber Bumper
_____	2	1	Handle Frame	_____	36	1	5-7/8" x 1-9/16" x 3/16" Rubber Bumper
_____	3	3	Handgrip	_____	37	1	5-7/8" x 1-3/4" x 3/16" Rubber Bumper
_____	4	2	Brass Bushing	_____	38	1	Pedal Frame
_____	5	2	Big Weight Holder	_____	39	4	3/8" Nylon Locknut
_____	6	28	1/2" Nylon Locknut	_____	40	4	3/8" Flatwasher
_____	7	78	1/2" Flatwashes	_____	41	1	Sporting Plate
_____	8	8	1/2" x 2" Bolt	_____	42	4	3/8" x 2-9/16" Allen Flat Head Bolt
_____	9	1	Right Rotational Frame	_____	43	2	1/2" x 3-3/8" Bolt
_____	10	1	Connecting Board	_____	44	2	1/2" x 4-11/16" Bolt
_____	11	1	Big Handle Frame	_____	45	4	4-7/16" x 2-1/4" Foot Pad
_____	12	6	Steel Bushing	_____	46	6	1/2" Lockwasher
_____	13	16	1/2" x 1" Bolt	_____	47	1	Pedal Connection
_____	14	1	Upper Cross Frame	_____	48	4	Brass Bushing
_____	15	1	5/16" Nylon Locknut	_____	49	1	Adjustment Frame
_____	16	26	5/16" Flatwasher	_____	50	1	Seat Adjustment frame
_____	17	1	5/16" x 2" Bolt	_____	51	1	Pop Pin
_____	18	3	Sleeve	_____	52	1	Back Pad
_____	19	5	3/8" x 3/8" Screw	_____	53	12	5/16" x 1-3/8" Bolt
_____	20	1	Low Cross Frame	_____	54	24	5/16" Lockwasher
_____	21	1	Rotational Frame	_____	55	2	Long plastic tube
_____	22	1	Connecting Pin	_____	56	6	Rubber bumper
_____	23	4	1/2" x 4-1/2" Bolt	_____	57	4	Short plastic tube
_____	24	2	Bearing	_____	58	12	5/16" x 1-3/4" Bolt
_____	25	1	Right Upright Frame	_____	59	2	Front Shoulder Pad
_____	26	18	1/2" x 2-15/16" Bolt	_____	60	2	Back shoulder Pad
_____	27	1	Rear Base Frame	_____	61	2	Upper Shoulder Pad
_____	28	1	Cross Frame	_____	62	2	Down Shoulder Pad
_____	29	1	Connecting Frame	_____	63	2	Large York Decal
_____	30	4	Weight Holder	_____	64	1	Warning Label
_____	31	1	Front Base Frame	_____	65	1	Warranty Card
_____	32	1	Left Upright Frame	_____	66	1	Serial # Sticker
_____	33	1	7-1/2" x 4" x 3/16" Rubber Bumper	_____	67	1	Hardware Card
_____	34	1	2-3/8" x 1-9/16" x 3/16" Rubber Bumper	_____			

Rev. 08/08/2007

****IF PARTS ARE MISSING, DO NOT CALL THE STORE WHERE YOU PURCHASED THIS ITEM THEY DO NOT STORK PARTS.
PLEASE CONTACT YORK BARBELL CUSTOMER SERVICE AT (800) 358-9675 OR (717) 767-6481 .**



STRENGTH TRAINING SERIES POWER FRONT SQUAT
NO. 54036 WHITE 55036 SILVER

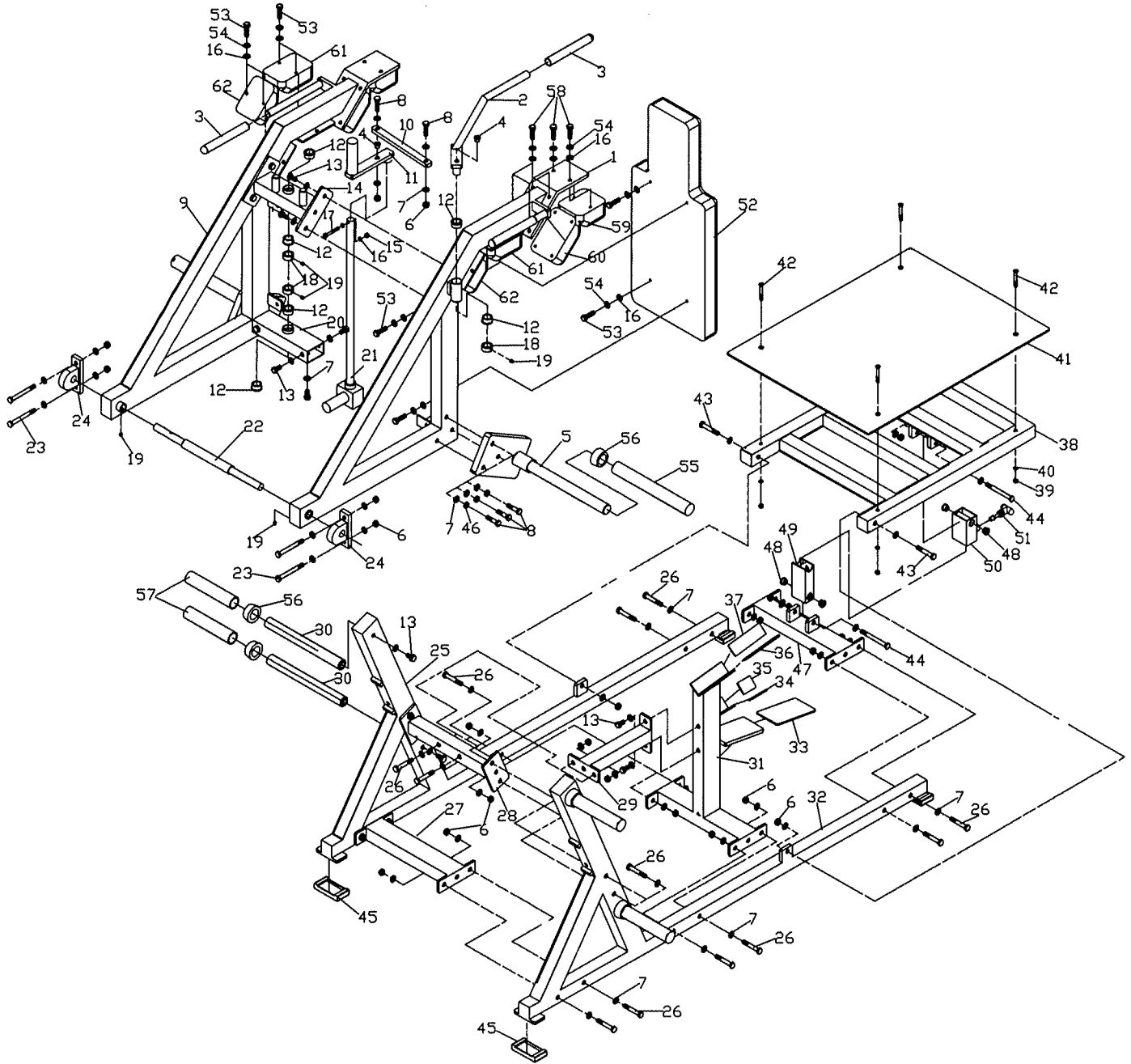

**IF PARTS ARE MISSING, DO NOT CALL THE STORE WHERE YOU PURCHASED THIS ITEM - THEY DO NOT STOCK PARTS. PLEASE CONTACT YORK BARBELL CUSTOMER SERVICE AT (800)358-9675 OR (717)767-6481