

- NOTE(S):
 1. PART NUMBER, "/00" DENOTES PART SHALL HAVE FINISH.
 2. APPLY NSF COMPLIANT GREASE TO ANY O-RING, SEALING JOINTS, AND/OR PIVOTAL POINTS. G
 3. APPLY NSF COMPLIANT LOCTITE TO THREADED AREA. L
 4. APPLY NSF COMPLIANT REMOVABLE (BLUE) LOCTITE TO THREADED AREA. B
 5. SILVER SOLDER JOINTS SHALL BE FULLY WETTED VIA CAPILLARY ACTION AND COMPLETELY NON-POROUS. S

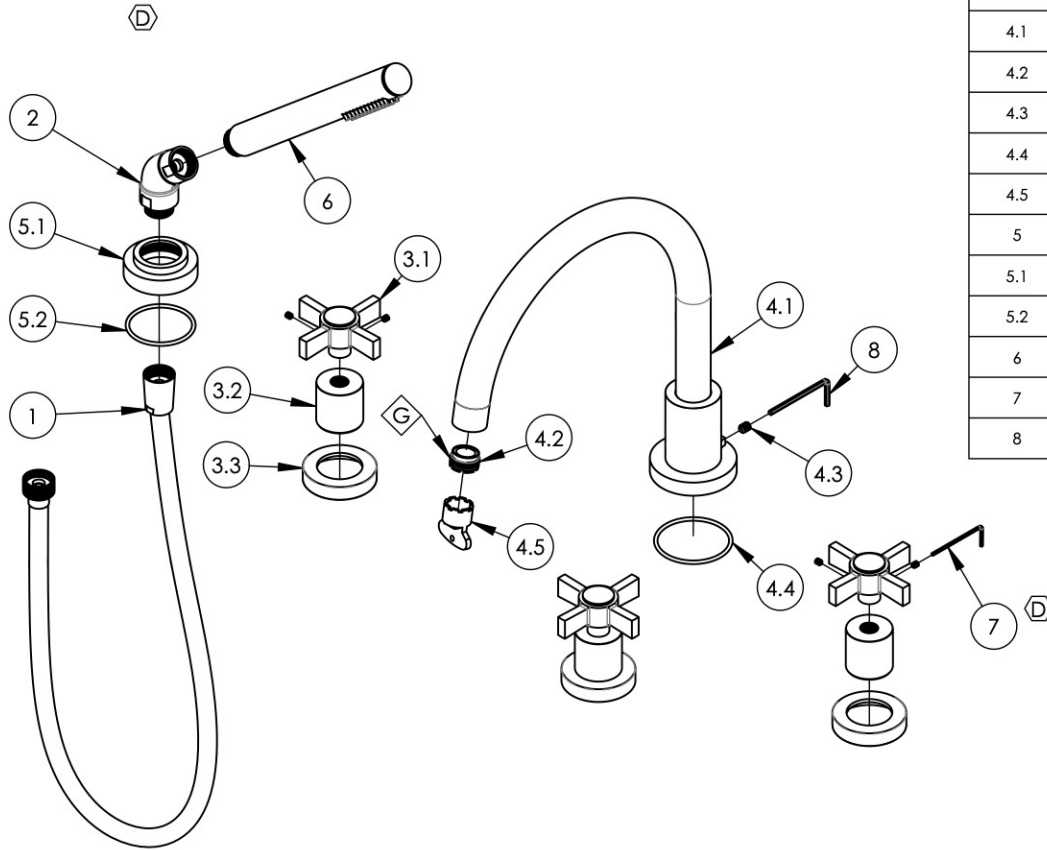

ITEM NO.	PART NUMBER	DESCRIPTION	QTY.
1	3-049/00	ASSY. HOSE KIT, HANDSHOWER	1
2	3-050/00	ELBOW ASSEMBLY	1
3	3-187/00	BLADE CROSS HANDLE FOR DECK TUB, BASIC SERIES	3
3.1	3-440/00	ASSY. BLADE HANDLE, BASIC SERIES	1
3.2	11107/00	HUB LARGE FOR RT, BASIC SERIES	1
3.3	11108/00	ESCUTCHEON LARGE ID FOR RT/PB, BASIC SERIES	1
4	3-190/00	DECK TUB, SPOUT ONLY, HIGH SPOUT, BASIC	1
4.1	2-167/00	SUB ASSY. HIGH ARC TUB SPOUT, DECK TUB BASIC	1
4.2	P05024	AERATOR CACHE COIN SLOT, M21.5X1.0 FULL FLOW	1
4.3	92127	SET SCREW, CUP PT, 1/4"-20 X 5/16"L, SS	1
4.4	90137	O-RING, 2-1/16"ID X 3/32"THK., AS-568-137	1
4.5	P05025	AERATOR, BASIC KEY, PLASTIC RED	1
5	3-211/00	ESCUTCHEON BASE, HANDSHOWER, BASIC	1
5.1	P18030/00	ESCUTCHEON BASE, DECK TUB, HANDSHOWER, BASIC	1
5.2	90133	1 3/4"O-RING, 1-13/16ID X 3/32THK, AS-568-133	1
6	3-471/00	ASSY. ROUND HANDSHOWER, CONTEMPORARY	1
7	92021	HEX KEY 5/64, FOR 8-32 SET SCREW	1
8	92216	HEX L-KEY 1/8" HEX x 2-5/16"L	1

ZONE	REV.	DESCRIPTION	DATE	APPROVED
D5, B3	D	DISSOLVE HANDSHOWER SUBASSEMBLY, UPDATE HEX KEY	11/10/2021	AMM
REVISIONS				

1261 LOGAN AVENUE
 COSTA MESA, CALIFORNIA 92626
 PHONE: 714.361.4800
 FAX: 714.617.3120

PHYLIRICH[®]
 Defining Luxury Since 1959

PROPRIETARY AND CONFIDENTIAL
 THE INFORMATION CONTAINED IN THIS DRAWING IS THE SOLE PROPERTY OF PHYLIRICH. ANY REPRODUCTION IN PART OR AS A WHOLE WITHOUT THE WRITTEN PERMISSION OF PHYLIRICH IS PROHIBITED.
DO NOT SCALE DRAWING

DECK TUB W/ HANDSHOWER SET, HIGH SPOUT W/ CROSS BLADE, BASIC, (132-48)

SIZE A	ASM/PRT NO. D2137C1/00	REV D
SCALE: 1:5.5	WEIGHT: lbs.	SHEET 1 OF 2