

- NOTE(S):
- PART NUMBER, "/00" DENOTES PART SHALL HAVE FINISH.
  - APPLY NSF COMPLIANT GREASE TO ANY O-RING, SEALING JOINTS, AND/OR PIVOTAL POINTS. G
  - APPLY NSF COMPLIANT LOCTITE TO THREADED AREA. L
  - APPLY NSF COMPLIANT REMOVABLE (BLUE) LOCTITE TO THREADED AREA. B
  - SILVER SOLDER JOINTS SHALL BE FULLY WETTED VIA CAPILLARY ACTION AND COMPLETELY NON-POROUS. S
  - FOR DEEPEER ESCUTCHEON:
    - 3-587/00 C
    - 92401 C

ITEM NO.	PART NUMBER	DESCRIPTION	QTY.
1	3-584/00	ASSY, BLADE HANDLE, ROND	2
1.1	11749/00	ESCUTCHEON, HANDLE, ROND	1
1.2	11748/00	HANDLE, BLADE, ROND	1
1.3	92005	SET SCREW, CUP PT 6-32 UNC THREAD 3/16"L	1
1.4	92176	WEAR WASHER	2
1.5	92177	RETAINING RING, 7/16" SHAFT	1
2	11003	SLEEVE MOUNT, WALL MT WIDESPREAD	2
3	11672/00	TRIM PLATE, TWO HANDLE, ROND	1
4	90029	O-RING, 1-5/8"ID X 1-3/4"OD X 1/16"THK, AS-568-029	2

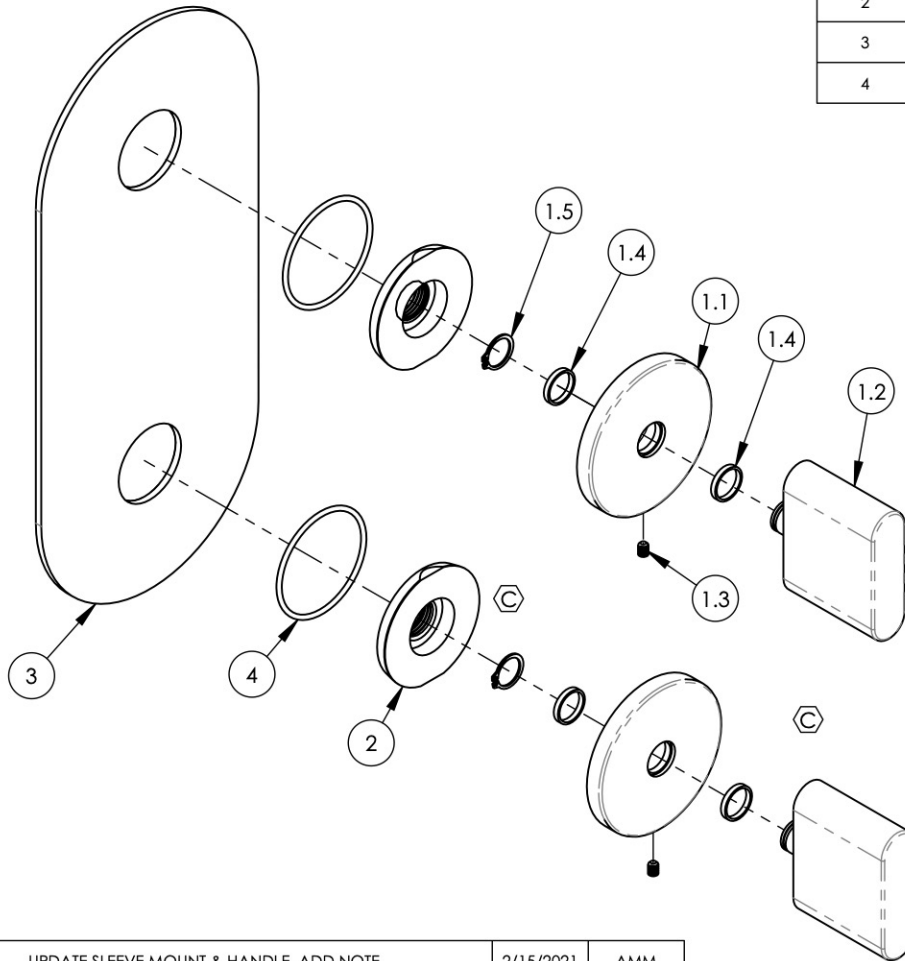

ZONE	REV.	DESCRIPTION	DATE	APPROVED
B4, B3	C	UPDATE SLEEVE MOUNT & HANDLE, ADD NOTE	2/15/2021	AMM
REVISIONS				

1261 LOGAN AVENUE  
COSTA MESA, CALIFORNIA 92626  
PHONE: 714.361.4800  
FAX: 714.617.3120

**PHYL RICH**<sup>®</sup>  
Defining Luxury Since 1959

**PROPRIETARY AND CONFIDENTIAL**  
THE INFORMATION CONTAINED IN THIS DRAWING IS THE SOLE PROPERTY OF PHYL RICH. ANY REPRODUCTION IN PART OR AS A WHOLE WITHOUT THE WRITTEN PERMISSION OF PHYL RICH IS PROHIBITED.  
**DO NOT SCALE DRAWING**

ASSY, 2 HANDLE, BLADE, TRIM ONLY,  
ROND

SIZE	ASM/PRT NO.	REV
<b>A</b>	4-575/00	<b>C</b>
SCALE: 1:2.5	WEIGHT: lbs.	SHEET 1 OF 2