

NOTE(S):
 1. ALL DIMENSIONS SHOWN ARE FOR REFERENCE ONLY

2. APPLY NSF COMPLAINT GREASE TO ANY O-RING AND/OR SEALING JOINTS. G

3. APPLY NSF COMPLAINT LOCTITE TO THREADED AREA. L

ITEM NO.	PART NUMBER	DESCRIPTION	QTY.
1	10986	CENTERING PLATE SLEEVE	2
2	11202/00	PLATE, TWO HANDLE BEVELED EDGE	1
3	3-1428/00	CROSS HANDLE, WALL/SHOWER, 500 SERIES	2
3.1	10538/00	CAP RING FOR 500 SERIES BUTTON	1
3.2	10622/00	HUB FOR HANDLE, CROSS	1
3.3	10623/00	HANDLE FINIAL CROSS	4
3.4	92008	SET SCREW, CUP POINT 8-32	2
3.5	10621/00	BASE HUB NUT	1
3.6	10618/00	ESCUTCHEON, TRADITIONAL 500	1
3.7	11097	PLASTIC BUTTON, BLANK	1
4	90537	1/16" TAPE FOR WALL PLATE	1

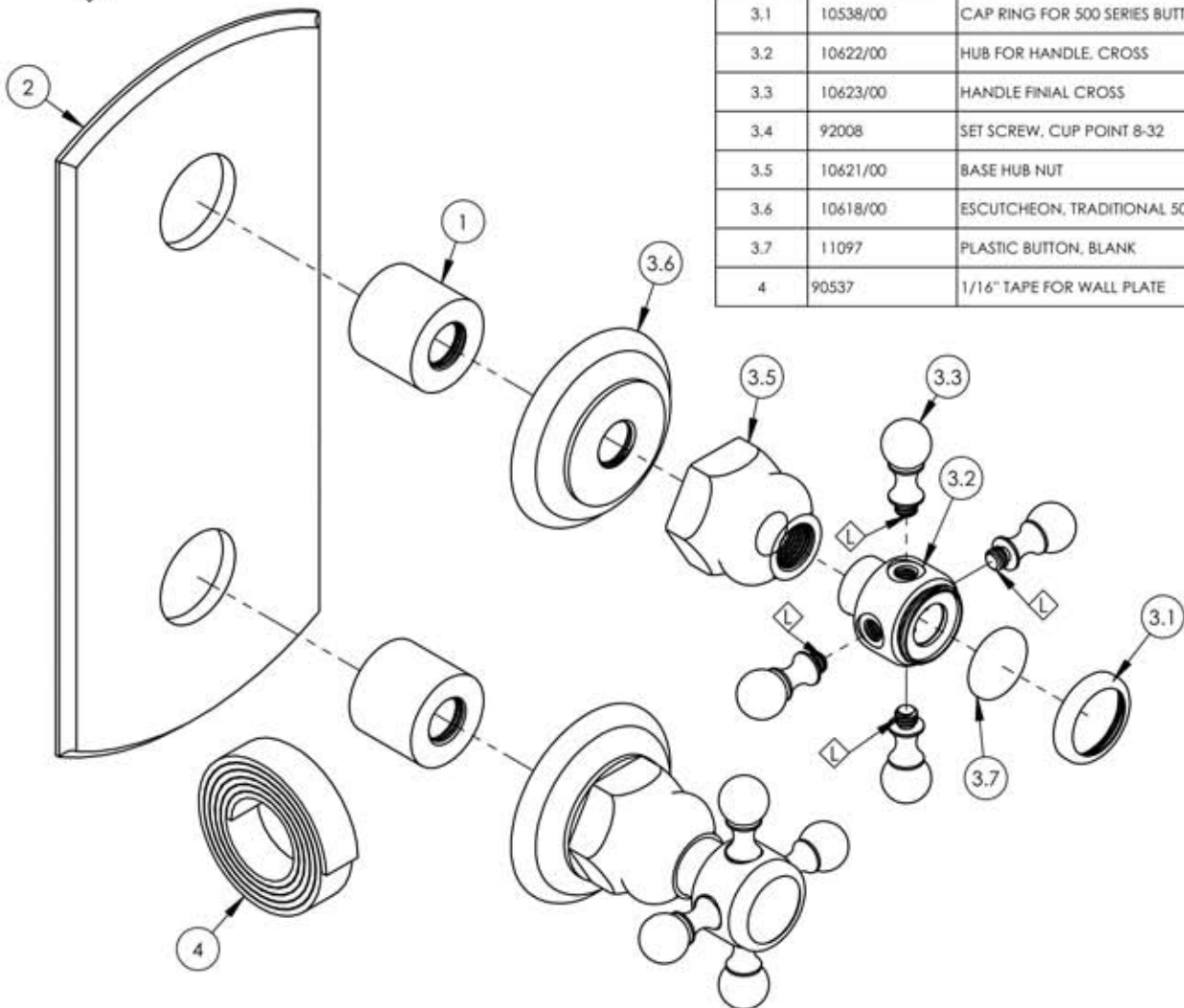

ZONE	REV.	DESCRIPTION	DATE	APPROVED
		REVISIONS		

1261 LOGAN AVENUE
 COSTA MESA, CALIFORNIA 92626
 PHONE: 714.361.4800
 FAX: 714.617.3120

PHYLORICH®
 Defining Luxury Since 1959

PROPRIETARY AND CONFIDENTIAL
 THE INFORMATION CONTAINED IN THIS DRAWING IS THE SOLE PROPERTY OF RSS MANUFACTURING. ANY REPRODUCTION IN PART OR AS A WHOLE WITHOUT THE WRITTEN PERMISSION OF RSS MANUFACTURING IS PROHIBITED.

INTERPRET GEOMETRIC DIMENSIONING & TOLERANCING IN ACCORDANCE WITH ASME Y14.5-2009 & ASME Y14.41-2003 STANDARDS, UNLESS OTHERWISE SPECIFIED. DIMENSIONS ARE IN INCHES. TOLERANCES ARE:	FRACTIONS ±1/64"	DECIMALS X.X: ±.1 X.XX: ±.01 X.XXX: ±.005	ANGULAR ±.5°
NEXT ASSY	USED ON	APPLICATION	
MATERIAL			
FINISH	DRAWN	LLO	10/23/2015
DO NOT SCALE DRAWING	CHECKED	GRE	

**1/2" MINI THERMOSTATIC VALVE W/
 VOLUME CONTROL OR DIVERTER, CROSS
 HANDLES**

SIZE	ASM/PRT NO.	REV
A	4-099/00	-
SCALE: 1:4	WEIGHT: lbs.	SHEET 1 OF 2

5

4

3

2

1