

NOTE(S):  
 1. PART NUMBER, "/00" DENOTES PART SHALL HAVE FINISH.

2. APPLY NSF-COMPLIANT GREASE TO ANY O-RING, SEALING JOINTS, AND/OR PIVOTAL POINTS.

3. APPLY NSF-COMPLIANT LOCTITE TO THREADED AREA.

4. APPLY NSF-COMPLIANT REMOVABLE (BLUE) LOCTITE TO THREADED AREA.

5. SILVER SOLDER JOINTS SHALL BE FULLY WETTED VIA-CAPILLARY ACTION AND COMPLETELY NON-POROUS.

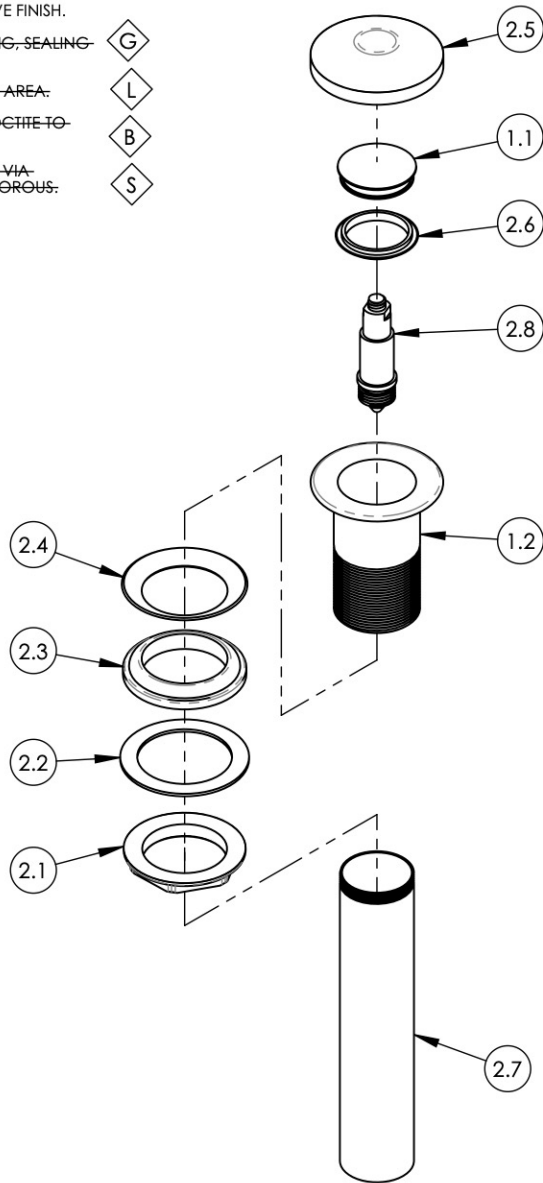

ITEM NO.	PART NUMBER	DESCRIPTION	QTY.
1	2-257/00	CLICK CLACK DRAIN, FINISH COMPONENTS	1
1.1	11945/00	CENTER CAP, SMALL, DRAIN,	1
1.2	11601/00	DRAIN RIM, NO OVERFLOW	1
2	2-258	CLICK CLACK DRAIN, ASSEMBLY COMPONENTS	1
2.1	92350	MOUNTING NUT, DRAIN	1
2.2	90577	NYLON WASHER, DRAIN	1
2.3	90576	CONICAL GASKET , RUBBER DRAIN	1
2.4	90575	RIM GASKET, DRAIN	1
2.5	92349	PLASTIC PROTECTIVE CAP, DRAIN	1
2.6	90591	RUBBER GASKET	1
2.7	11602	TAIL TUBE, DRAIN	1
2.8	11603	CLICK CLACK	1

ALL	B	ADD SPEC SHEET	4/13/2022	AMM
ZONE	REV.	DESCRIPTION	DATE	APPROVED
REVISIONS				

1261 LOGAN AVENUE  
 COSTA MESA, CALIFORNIA 92626  
 PHONE: 714.361.4800  
 FAX: 714.617.3120



**RSS MANUFACTURING**

**PROPRIETARY AND CONFIDENTIAL**  
 THE INFORMATION CONTAINED IN THIS DRAWING IS THE SOLE PROPERTY OF RSS MANUFACTURING. ANY REPRODUCTION IN PART OR AS A WHOLE WITHOUT THE WRITTEN PERMISSION OF RSS MANUFACTURING IS PROHIBITED.

-	-	INTERPRET GEOMETRIC DIMENSIONING & TOLERANCING IN ACCORDANCE WITH ASME Y14.5-2009 & ASME Y14.41-2003 STANDARDS, UNLESS OTHERWISE SPECIFIED. DIMENSIONS ARE IN INCHES. TOLERANCES ARE:
-	-	
-	-	
NEXT ASSY	USED ON	<b>FRACTIONS</b> ±1/64"
APPLICATION		<b>DECIMALS</b> X.X: ±.1 X.XX: ±.01 X.XXX: ±.005
MATERIAL		<b>ANGULAR</b> ±.5°
FINISH	DRAWN	NAME DATE
	RAH	10/9/2017
<b>DO NOT SCALE DRAWING</b>		CHECKED

<b>PUSH TO CLOSE DRAIN, NO OVERFLOW</b>		
SIZE	ASM/PRT NO.	REV
<b>A</b>	3-517/00	<b>B</b>
SCALE: 1:3.25	WEIGHT: lbs.	SHEET 1 OF 2

5

4

3

2

1

E

E

D

D

C

C

B

B

A

A

5

4

3

2

1