

- NOTE(S):
1. PART NUMBER, "/00" DENOTES PART SHALL HAVE FINISH.
 2. APPLY NSF COMPLIANT GREASE TO ANY O-RING, SEALING JOINTS, AND/OR PIVOTAL POINTS.
 3. APPLY NSF COMPLIANT LOCTITE TO THREADED AREA.
 4. APPLY NSF COMPLIANT REMOVABLE (BLUE) LOCTITE TO THREADED AREA.
 5. SILVER SOLDER JOINTS SHALL BE FULLY WETTED VIA CAPILLARY ACTION AND COMPLETELY NON-POROUS.

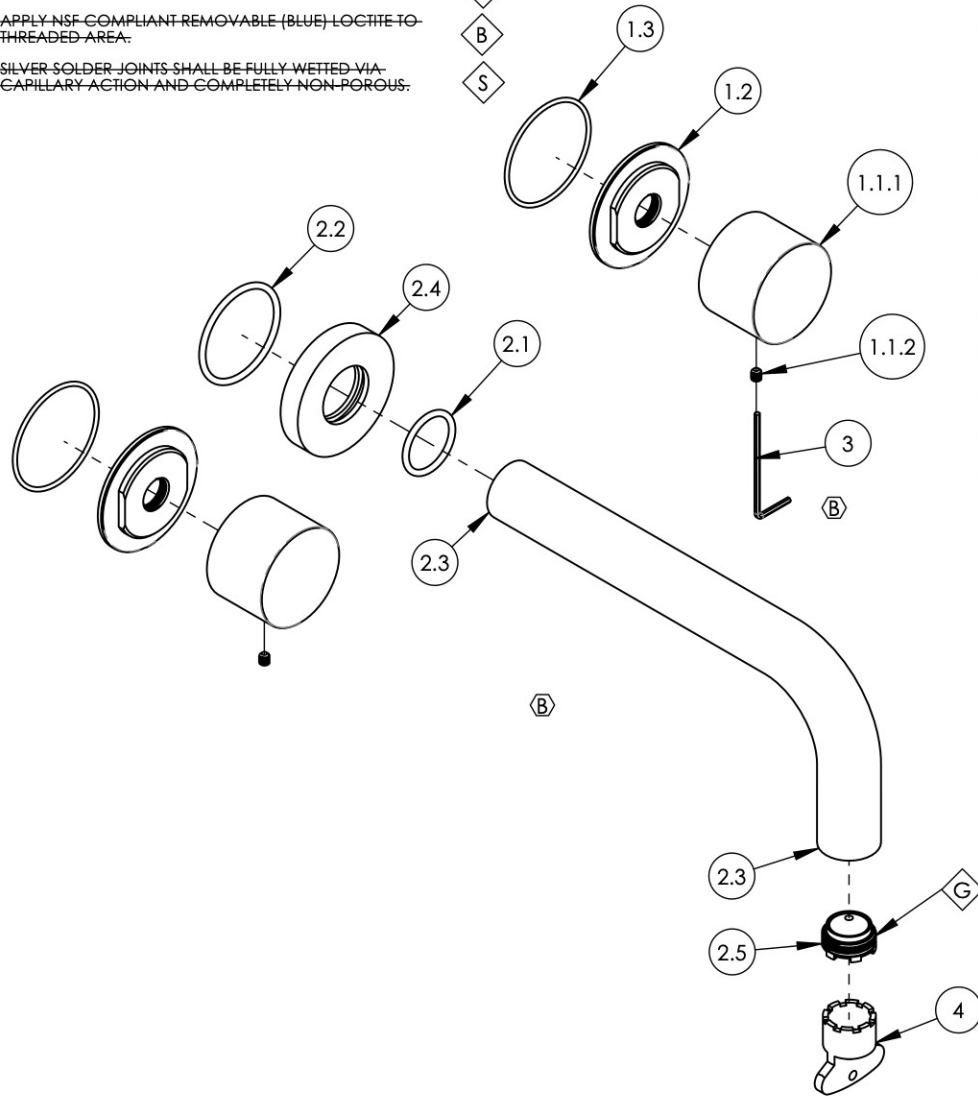

| ITEM NO. | PART NUMBER | DESCRIPTION | QTY. |
|----------|-------------|--|------|
| 1 | 3-386/00 | SUB ASSY. SMOOTH HANDLE, BASIC II | 2 |
| 1.1 | 2-248/00 | HANDLE SMOOTH, BASIC II | 1 |
| 1.1.1 | 10433/00 | BASE HANDLE, CONTEMP. BASIC II | 1 |
| 1.1.2 | 92008 | SET SCREW, CUP POINT 8-32, 3/16" L. | 1 |
| 1.2 | 11164/00 | ESCUTCHEON BASE, CONTEMP. BASIC II | 1 |
| 1.3 | 90031 | O-RING, 1-3/4"ID X 1/16"THK, AS-568-031 | 1 |
| 2 | 3-414/00 | WALL LAV, SPOUT ONLY, 7-1/2" L, BASIC | 1 |
| 2.1 | 90119 | O-RING, 15/16"ID X 1-1/8"OD X 3/32"THK, AS-568-119 | 1 |
| 2.2 | 90129 | O-RING, 1-9/16"ID X 3/32"THK, AS-568-129 | 1 |
| 2.3 | P19018/00 | 7-1/2" WALL LAV SPOUT, BASIC SERIES | 1 |
| 2.4 | P19017/00 | ESCUTCHEON, FOR SPOUT | 1 |
| 2.5 | 11429 | AERATOR CACHE JR, 1.2GPM, M21.5X1.0, 42.2260.450 | 1 |
| 3 | 92021 | HEX KEY 5/64, FOR 8-32 SET SCREW | 1 |
| 4 | P05025 | AERATOR, BASIC KEY, PLASTIC RED | 1 |

| ALL | B | UPDATE SPOUT ASSEMBLY, ADD HEX KEY | 2/22/2022 | AMM |
|-----------|------|------------------------------------|-----------|----------|
| ZONE | REV. | DESCRIPTION | DATE | APPROVED |
| REVISIONS | | | | |

1261 LOGAN AVENUE
COSTA MESA, CALIFORNIA 92626
PHONE: 714.361.4800
FAX: 714.617.3120

PHYLIRICH[®]
Defining Luxury Since 1959

PROPRIETARY AND CONFIDENTIAL
THE INFORMATION CONTAINED IN THIS DRAWING IS THE SOLE PROPERTY OF PHYLIRICH. ANY REPRODUCTION IN PART OR AS A WHOLE WITHOUT THE WRITTEN PERMISSION OF PHYLIRICH IS PROHIBITED.
DO NOT SCALE DRAWING

WALL LAV SET, SPOUT 7-1/2" W/ SMOOTH, BASIC II

| SIZE | ASM/PRT NO. | REV |
|------------|--------------|--------------|
| A | 230-12/00 | B |
| SCALE: 1:3 | WEIGHT: lbs. | SHEET 1 OF 2 |