

SCALE: 1:6

SEE NEXT PAGE FOR,  
Blow Out Nozzle/Flare For Empty Bottles

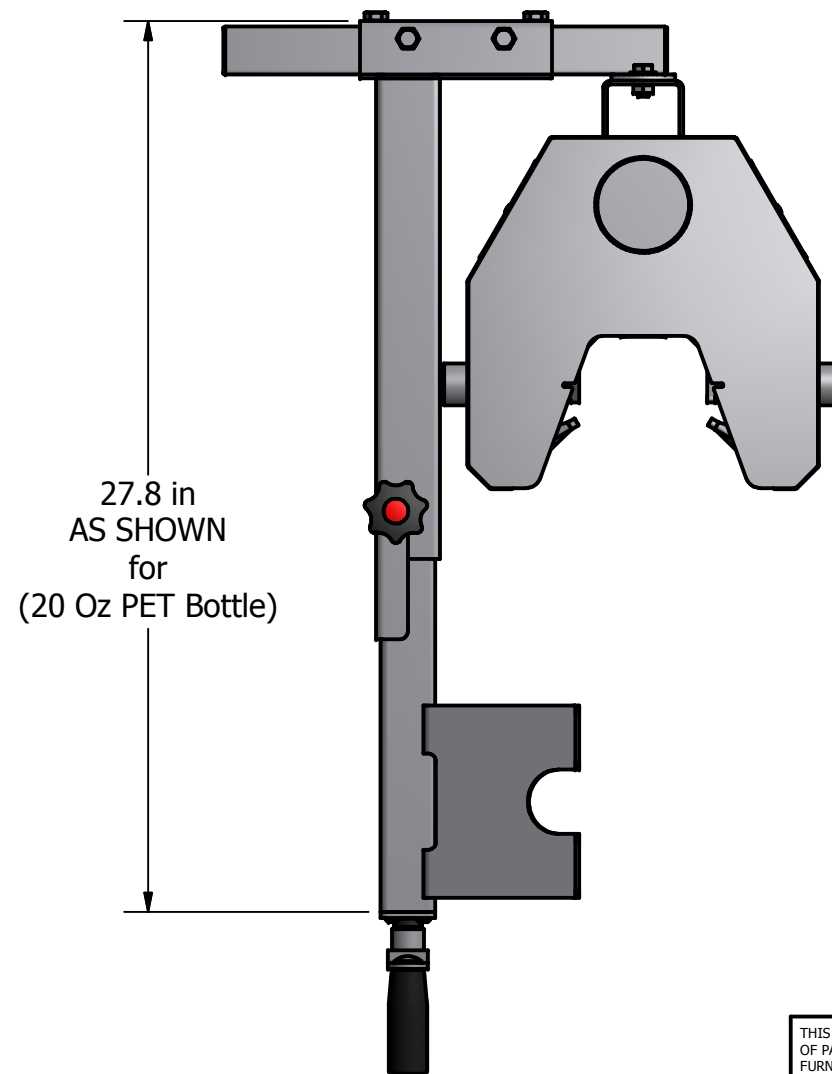

ASSEMBLY WEIGHT: 52lbs

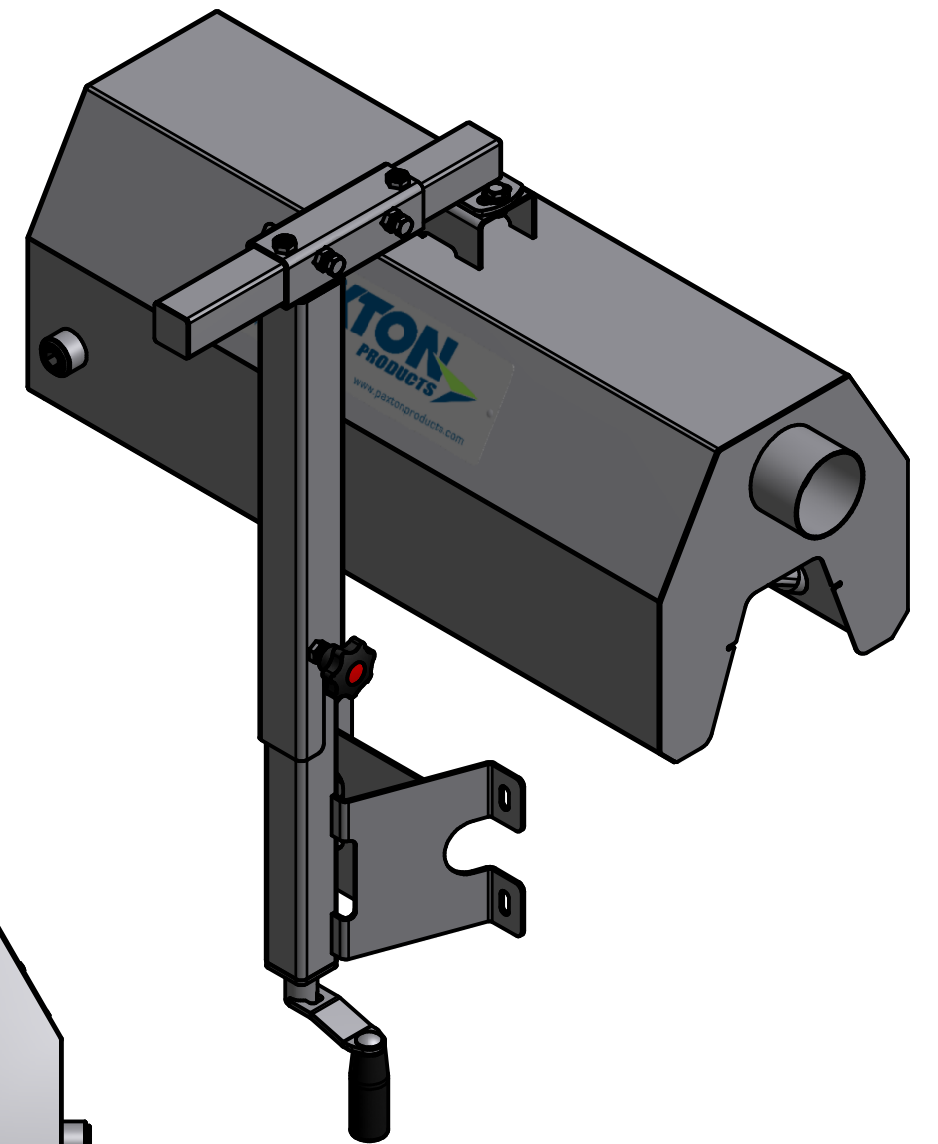

**OPERATING HEIGHT=**  
2" CONVEYOR OFF SET  
+ BOTTLE OVERALL HT  
- CAP HEIGHT (0.7")

**Example, 20oz Bottle**  
HT = 2" + 8.7" - 0.7"  
**HT = 10in**

**Maximum HT = 16in**  
(2" higher than 2-Liter PET)

**Minimum HT = 6in**  
(2" lower than 12oz PET)

**PATENT PENDING**

THIS DOCUMENT IS THE PROPERTY OF PAXTON PRODUCTS AND IS FURNISHED ON THE CONDITION THAT IT IS TO BE USED ONLY BY PAXTON CUSTOMERS FOR INTEGRATING PAXTON EQUIPMENT. THIS DOCUMENT MAY BE USED BY CUSTOMERS TO CREATE THEIR OWN EQUIPMENT DOCUMENTATION. OTHERWISE THIS DOCUMENT IS NOT TO BE USED IN ANY SHAPE OR FORM TO CREATE DOCUMENTS, PARTS, OR EQUIPMENT.



10125 Carver Road Phone: (800) 441-7475  
Cincinnati, OH 45242 (513) 891-7474

www.paxtonproducts.com

CapDryer SYSTEM, WITH ADJ. MNT  
304SS, (24) FLARES, 3" INLET, 1-1/4" OUTLET

DATE  
3/21/2013

INVENTOR DWG No.  
**OA-8007290-CapDryer**

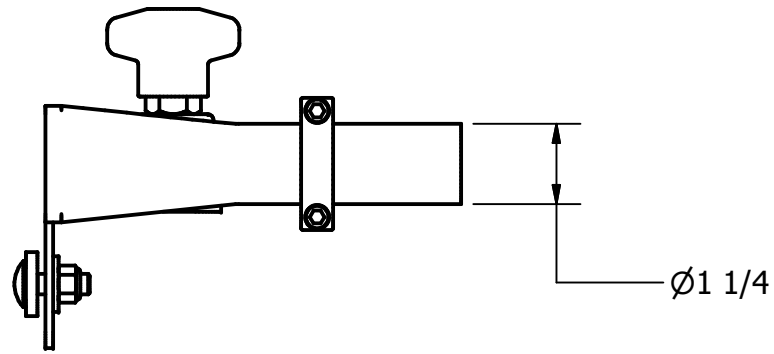

HORIZONTAL ADJUSTMENT +/- 1"

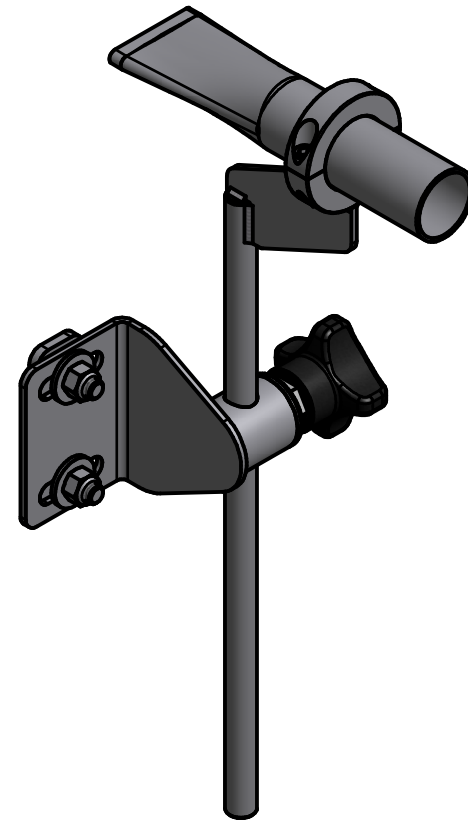
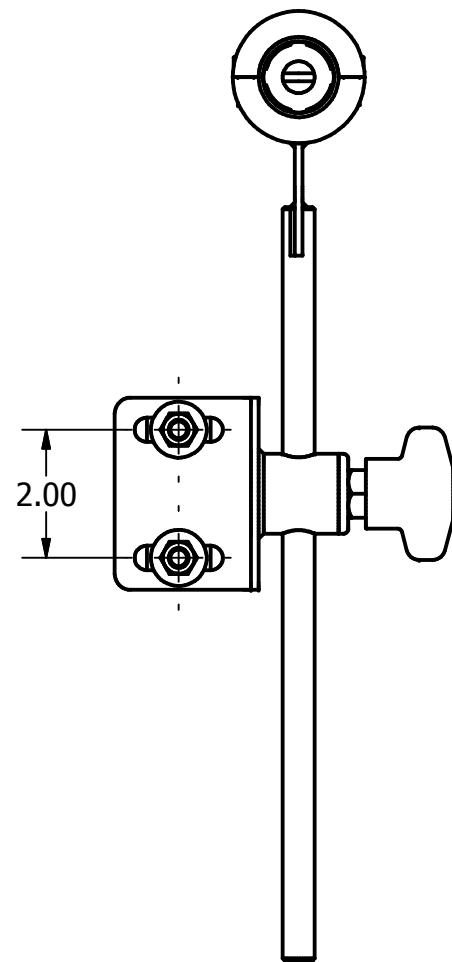
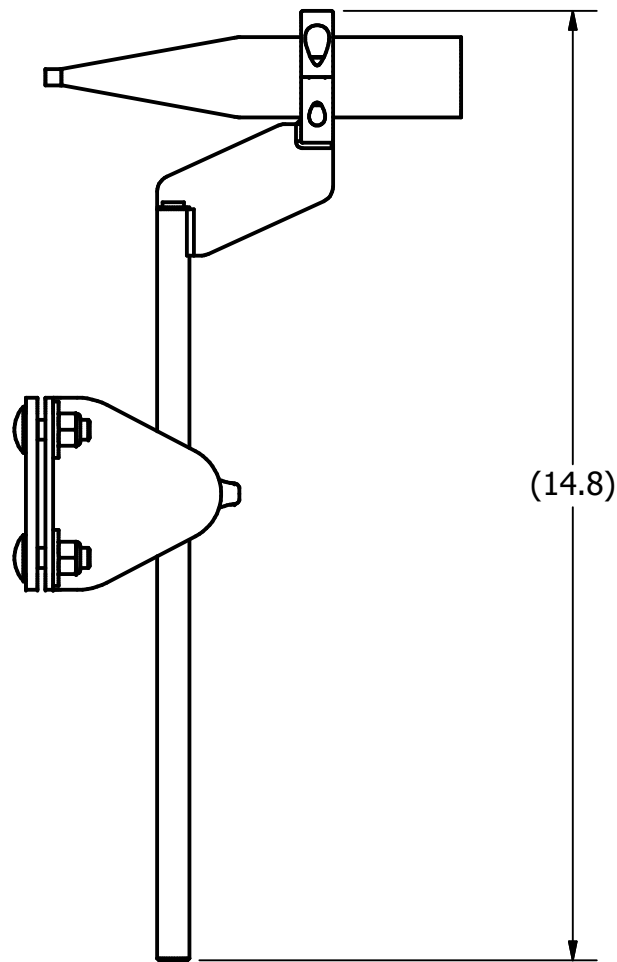

**Blow Out Nozzle/Flare**

For Empty Bottles, with 5' of 1-1/4" hose  
 (McMasterCarr 5314K31)  
 and (2) 1-1/4" Hose Clamps

SCALE: 1:3

**PATENT PENDING**

THIS DOCUMENT IS THE PROPERTY OF PAXTON PRODUCTS AND IS FURNISHED ON THE CONDITION THAT IT IS TO BE USED ONLY BY PAXTON CUSTOMERS FOR INTEGRATING PAXTON EQUIPMENT. THIS DOCUMENT MAY BE USED BY CUSTOMERS TO CREATE THEIR OWN EQUIPMENT DOCUMENTATION. OTHERWISE THIS DOCUMENT IS NOT TO BE USED IN ANY SHAPE OR FORM TO CREATE DOCUMENTS, PARTS, OR EQUIPMENT.

	10125 Carver Road Cincinnati, OH 45242 <a href="http://www.paxtonproducts.com">www.paxtonproducts.com</a>	Phone: (800) 441-7475 (513) 891-7474
	CapDryer SYSTEM, WITH ADJ. MNT 304SS, (24) FLARES, 3" INLET, 1-1/4" OUTLET	
DATE 3/21/2013	INVENTOR DWG No. <b>OA-8007290-CapDryer</b>	