

- Easy to use
- PIN authenticated (7-15 digits)
- FIPS 140-3 Level 3 compliant
- Common Criteria EAL5+ (Hardware Certified) secure microprocessor
- USB Type A & C cables and carry case included
- Ultra-portable and lightweight
- Rugged, shockproof & crushproof
- Wear resistant keypad
- IP68 certified Water & Dust Resistant
- Ultra fast transfer speeds
- Brute Force protection
- Independent User & Admin PINs
- One-time User recovery PIN
- Read only (write product) - Dual mode
- OS & platform independent



Our smallest, lightest, fastest and most rugged FIPS compliant encrypted portable SSD

The diskAshur M² PIN authenticated, hardware encrypted SSD has a new, ultra-portable, rugged and sleek design, incorporating the most advanced security attributes that iStorage is renowned for.

The diskAshur M² encrypts data using FIPS PUB 197 validated, AES-XTS 256-bit hardware encryption and incorporates a Common Criteria EAL5+ (Hardware Certified) secure microprocessor, which employs built-in physical protection mechanisms designed to defend against external tamper, bypass physical attacks and more.

The drive features ultra-fast backwards compatible USB 3.2 data transfer speeds and is available in capacities ranging from 120GB to 2TB. The diskAshur M² is lightweight, dust and waterproof (IP68 certified), shock proof (survives a drop of 4m on to a concrete surface) and crush-proof (withstands the weight of a 2.7 ton vehicle), making it extremely rugged and ultra-portable.

KEY FEATURES

Easy to use

Simply enter a 7-15 digit PIN to authenticate and use as a normal portable SSD. When the drive is disconnected, all data is encrypted using AES-XTS 256-bit hardware encryption (no software required).

FIPS 140-3 Level 3 compliant, tamper proof & evident design

All data stored on the diskAshur M² is encrypted using FIPS PUB 197 validated, AES-XTS 256-bit hardware encryption. All components incorporated within the diskAshur M² are completely covered by a layer of super tough epoxy resin, which is virtually impossible to remove without causing permanent damage to the components. The drive is also designed to be tamper evident making it obvious to the User if it has been pried open and tampered with.

Rugged, Shockproof & Crushproof

The diskAshur M² is extremely rugged, surviving a drop of up to 4m onto a concrete surface. The drive is also crushproof, withstands the weight of a 2.7 ton vehicle.

No need to worry about spills

The drive's IP68 accreditation means it will survive being submerged under 1.5m of water for 30 minutes and deemed fit enough to withstand dust, dirt and sand.

Slim & sleek design

Lightweight and smaller than the size of a phone, making it ultra-portable.

Weights: 86 grams (with sleeve fitted)

Weights 65 grams (without sleeve)

Wear resistant keypad

The onboard keypad is covered with a layer of polymer coating that protects the keys and hides key usage to avoid tipping off a potential hacker to commonly used keys.

Independent User and Admin PINs

Which makes it perfect for corporate and government deployment. If the User forgets their PIN, the drive can be unlocked using the Admin PIN. The Administrator can then allow the User to set a new User PIN.

User PIN enrolment

The Admin can set a restriction policy for the User PIN. This includes setting the minimum length of the PIN, as well as requiring the input of one or more 'Special Characters'. The 'Special Character' functions as 'SHIFT + digit'.

Transfer your files in seconds

Lightning fast backwards compatible USB 3.2 data transfer speeds.

Up to 370MB/s Read speeds

Up to 370MB/s Write speeds

One-time User recovery PIN

Admin configurable, extremely useful in situations where a User has forgotten their PIN, allowing the User to unlock the device and set a new User PIN.

Incorporates a Common Criteria EAL5+ (Hardware Certified) secure microprocessor

Which enhances security through true random number generation and built-in cryptography. The data encryption key is protected by FIPS and Common Criteria validated wrapping algorithms.

Offers ultimate security against hackers, detecting and responding to tampering with features such as:

- Dedicated hardware for protection against SPA/DPA/SEMA, DEMA attacks
- Advanced protection against physical attacks, including Active Shield, Enhance Protection Object, CStack checker, Slope Detector and Parity Errors
- Environmental Protection Systems protecting against voltage monitor, frequency monitor, temperature monitor and light protection
- Secure Memory Management/Access Protection

Read only (write protect) - Dual Mode

Both the Admin and User can configure the diskAshur M² as a read only (write protect) drive. If configured by the Admin, the drive cannot be modified or disabled by the User, allowing the Admin to pre-provision a drive with pre-loaded content as read-only for the User.

OS & Host independent - works across any host and embedded systems

No software required; the drive will work on any device with a USB port.

USB Type C and Type A connectivity (included)

Compatible with: MS Windows, macOS, Linux, Android, Chrome, Thin Clients, Zero Clients, Embedded Systems, Citrix and VMware

Bootable feature

Install an OS on the diskAshur M² and boot directly from it.

Brute force hack defence mechanism

Intelligently programmed to protect against all forms of brute force attacks.

If the User PIN is entered incorrectly 10 consecutive times, the User PIN will be deleted and the drive can only be accessed by entering the Admin PIN or One-time User recovery PIN. (Admin can change this from the default 10 incorrect PIN entries, to 1-9, for the User only)

If the Admin PIN is entered incorrectly 10 consecutive times, all data, PINs and the encrypted encryption key will be lost forever.

Auto-lock

Automatically locks when unplugged from the host computer or when power to the USB port is turned off. It can also be set to automatically lock after a predetermined amount of time.

Self-destruct feature

Pre-program the diskAshur M² with a self-destruct PIN, once entered, the data, encrypted encryption key and all PINs are deleted and rendered as lost forever.

Device reset feature

Deletes the encrypted encryption key, all PINs and renders all data as lost forever. The drive can then be redeployed which randomly generates a new encrypted encryption key, a process that can be repeated as many times as required.

Whitelisting on networks

Configured with a unique VID/PID and internal/external serial number with barcode, allowing easy integration into standard end-point management software (white-listing), to meet internal corporate requirements.

Customisation services available

Offering an in-house PIN configuration and laser-etching service whereby the diskAshur M² sleeve or side of the device can be customised with your name, company name and/or logo, web/email address, phone number.

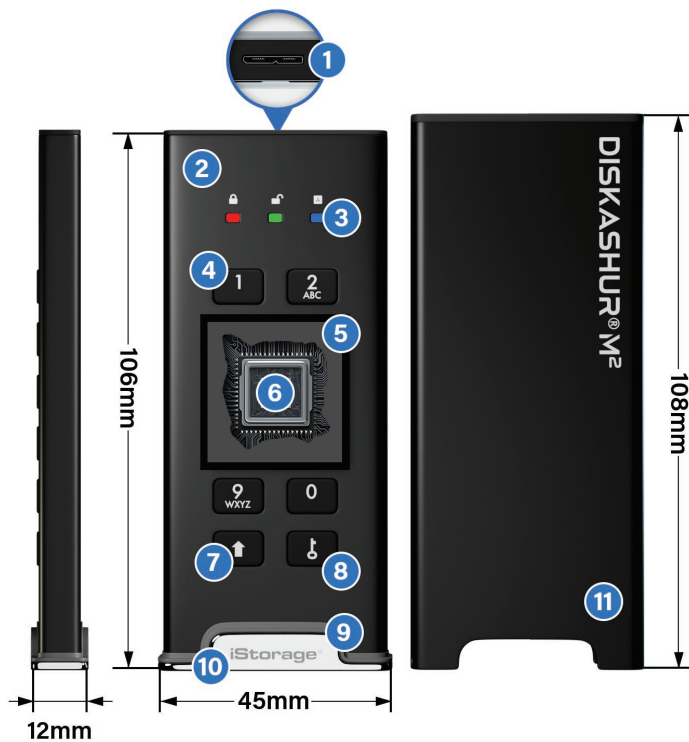

1. Micro B connector
2. Hard anodised and ruggedised extruded aluminium housing
3. LED lights (Red: standby/locked - Green: User mode/unlocked - Blue: Admin mode)
4. Polymer coated, wear resistant alphanumeric keypad
5. Epoxy coating
6. Common Criteria EAL5+ (Hardware Certified) secure microprocessor
7. Key button
8. Shift button
9. Rubber gasket - making the drive waterproof when sleeve is fitted
10. Zinc alloy base
11. Hard anodised and ruggedised extruded aluminium sleeve

Technical specifications

Hardware	Hardware encrypted portable SSD	
Interface	USB 3.2 SuperSpeed - up to 5Gbps. Backwards compatible with USB 3.0/2.0/1.1	
Data transfer rates²	Read: 370 MB/s Write: 370 MB/s	
Cables	USB Type C and Type A cables (included)	
Dimension - H/W/D	Without sleeve: 106 x 45 x 12mm With sleeve: 111 x 45 x 12mm	
Weight	Without sleeve: approx. 65 grams With sleeve: approx. 86 grams	
Compatibility	MS Windows, macOS, Linux, Chrome, Android, Thin Clients, Zero Clients, Embedded Systems, Citrix and VMware	
Hardware data encryption	AES-XTS 256-bit full disk hardware encryption	
Certifications	FIPS 140-3 Level 3 (pending)	
Approvals		
Capacities¹	120 / 240 / 500GB - 1 / 2TB	
Ordering information	IS-DAM2-256-XX	XX = Capacity
Warranty	3 year warranty with free lifetime technical support	
Box contents	diskAshur M ² portable SSD & Protective Sleeve, Protective Carry Case, USB C & USB A Cables, Quick Start Guide & Product Disclaimer	



¹ - Some of the listed capacity on a data storage device is used for formatting and other functions and is thus not available for data storage. As such, the actual available capacity for data storage is less than what is listed on the products.

² - Speed may vary due to host hardware, software and usage.



Designed, developed and assembled in the UK



GDPR Compliant



Compliant