

Loose Convertible Table Cover Assembly

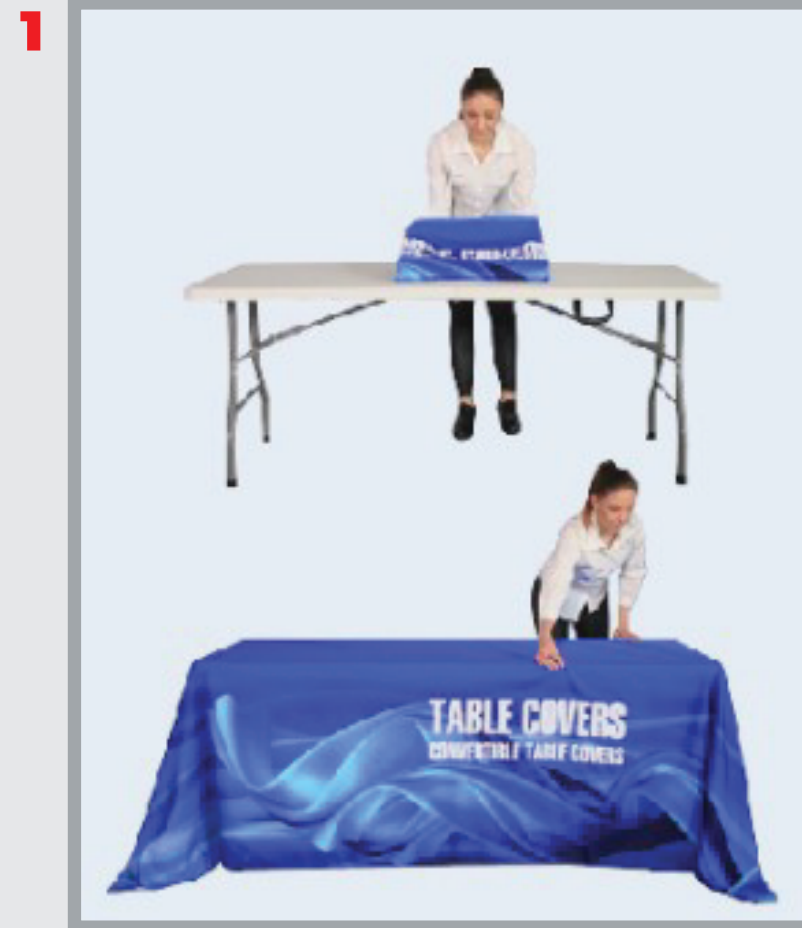

1 Unfold the table cover and spread it to cover the table (6ft).

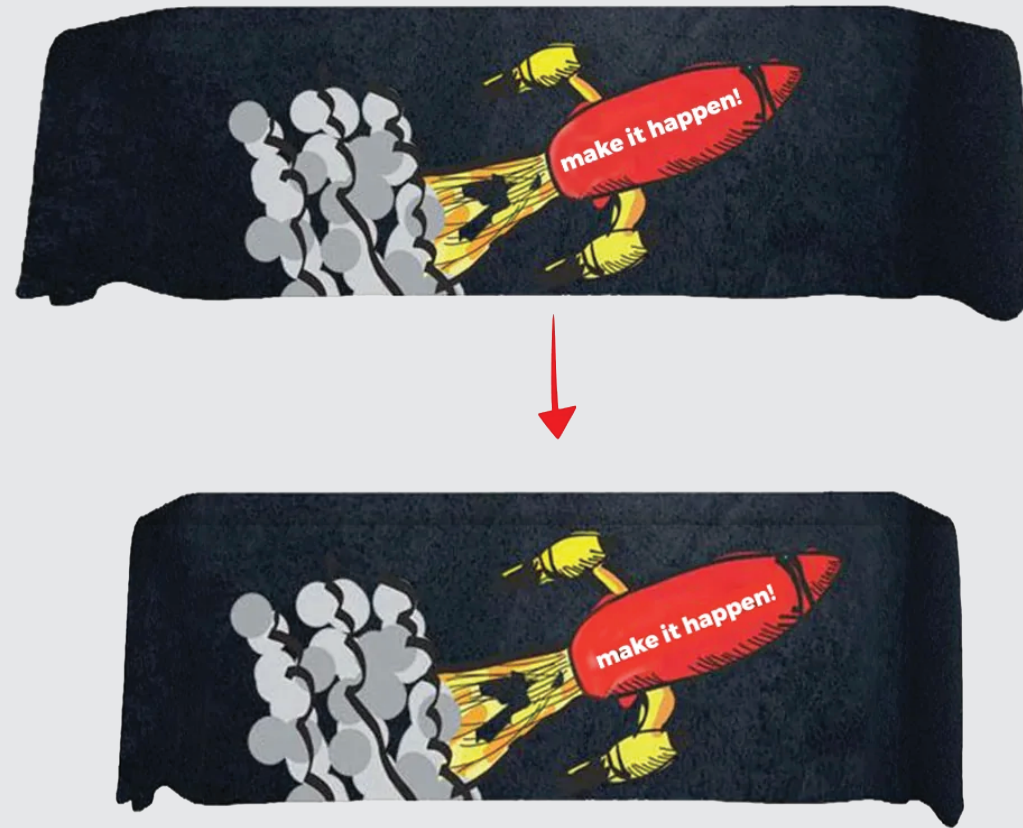
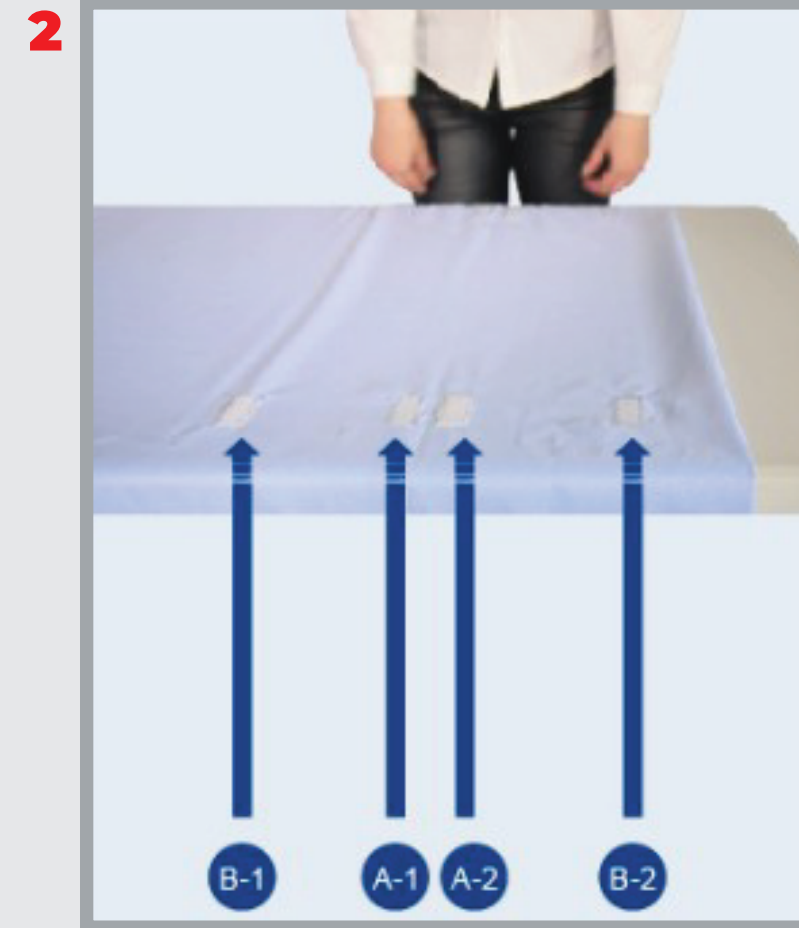

2 Lift one side of the cover and you can find four velcros at the edge of the fabric.

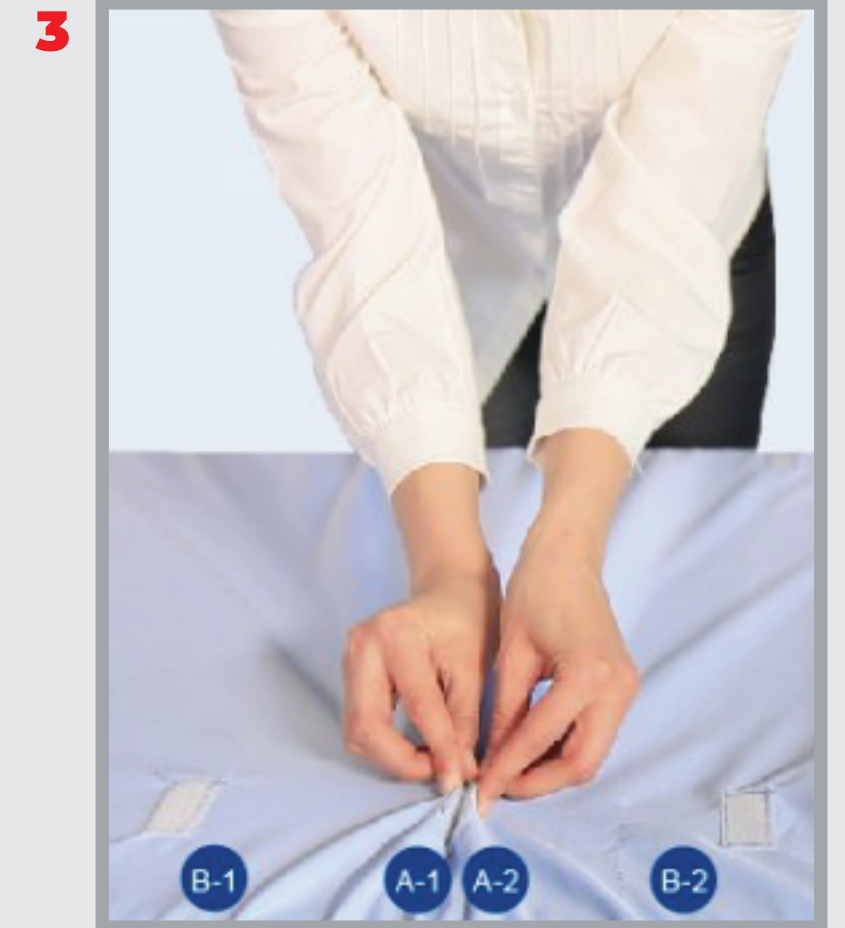

3 Paste the velcros A-1 with A-2, and B-1 with B-2 separately and hang down the pleats.



4 Repeat the spte 3 to paste the velcros on the other side.

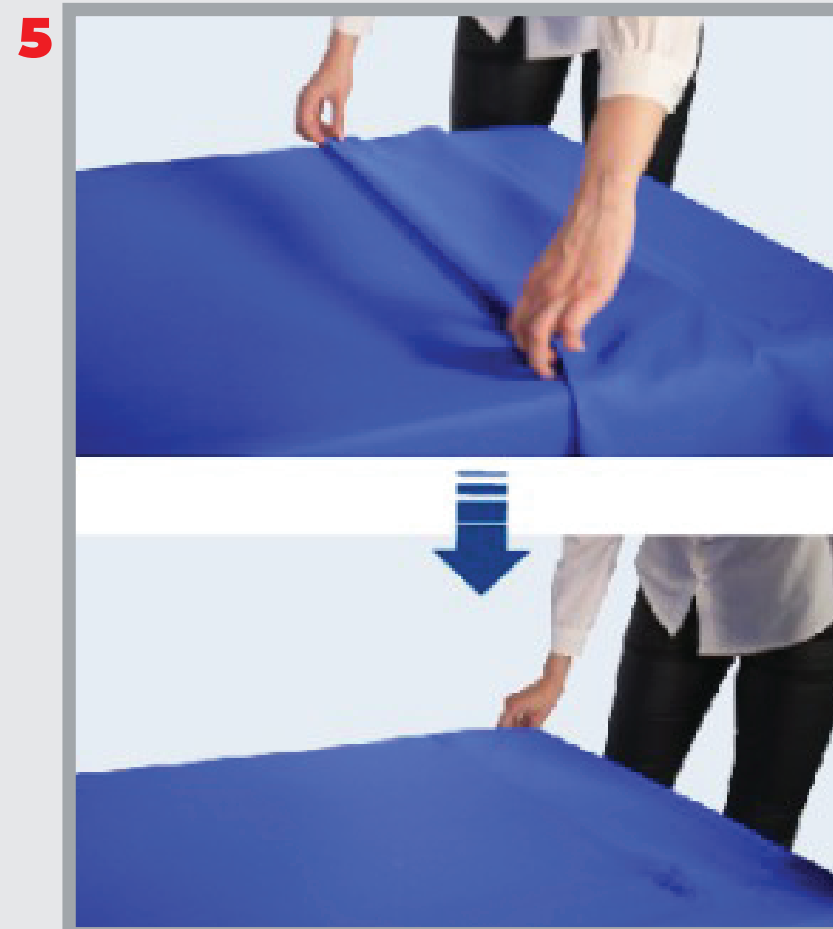

5 Neaten the pleats to make the table cover look smooth.

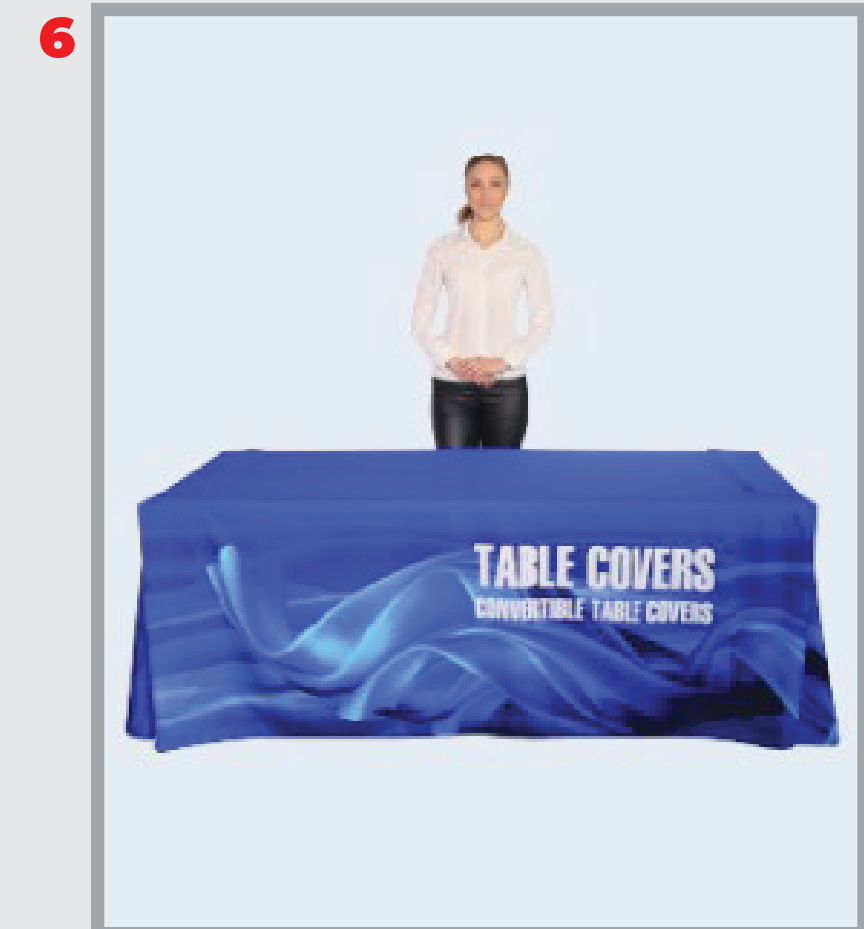

6 Then an 8ft table cover is converted into a 6ft table cover.